

**Графическое описание местоположения границ земель, на которых
располагаются особо защитные участки лесов
«участки лесов с наличием реликтовых и эндемичных растений»,
на территории Северного участка лесничества
Нижнеилимского лесничества Иркутской области**

Приложение № 51 к приказу Рослесхоза
от 10.06.2024 № 434

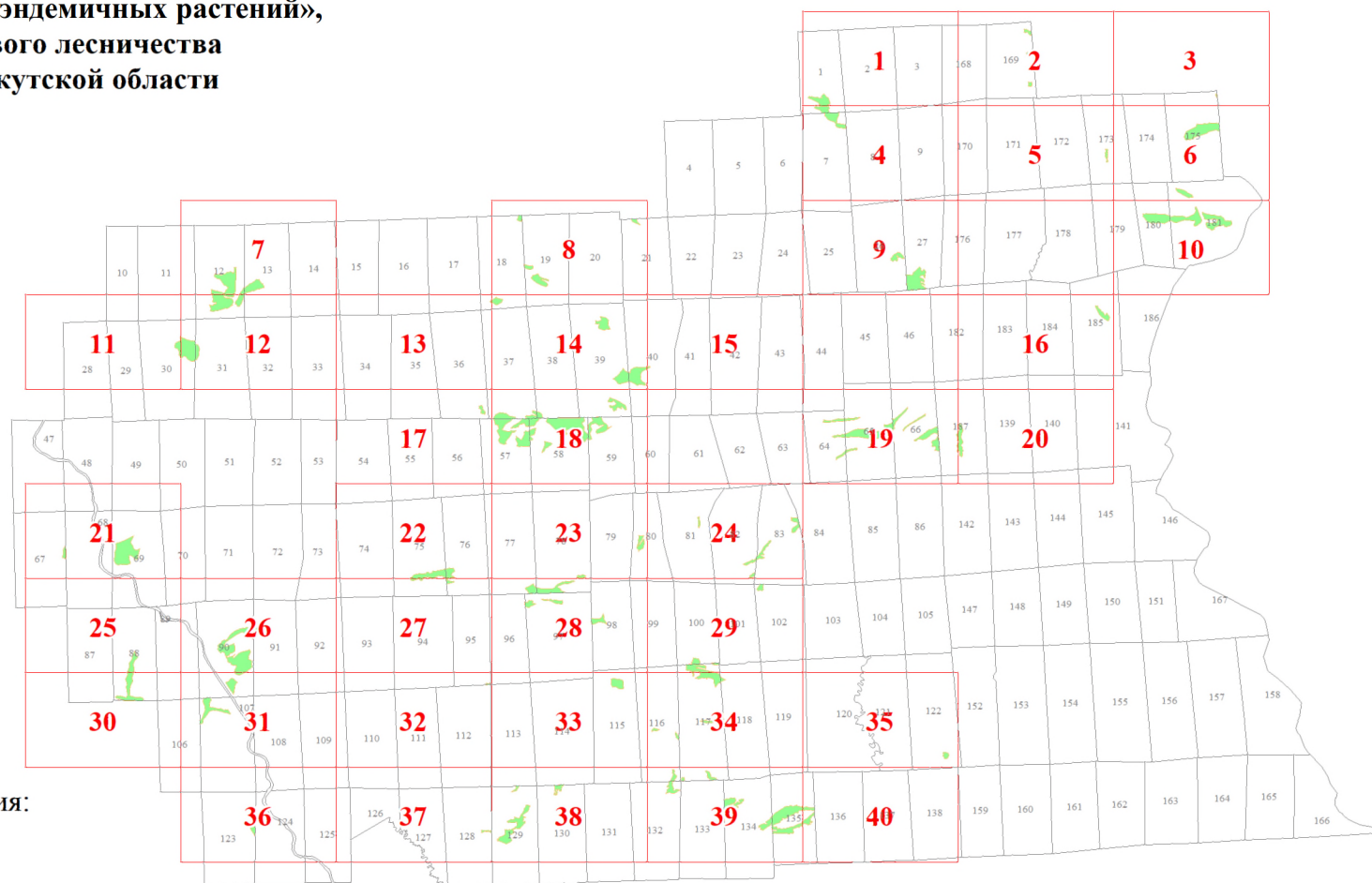

Используемые условные знаки и обозначения:

- 25 Границы и номера лесных кварталов
- 1 Номера участков
- 1• Номера характерных точек границ объекта
- 1 Границы и номера листов
- Границы особо защитных участков лесов
«участки лесов с наличием реликтовых и эндемичных растений»

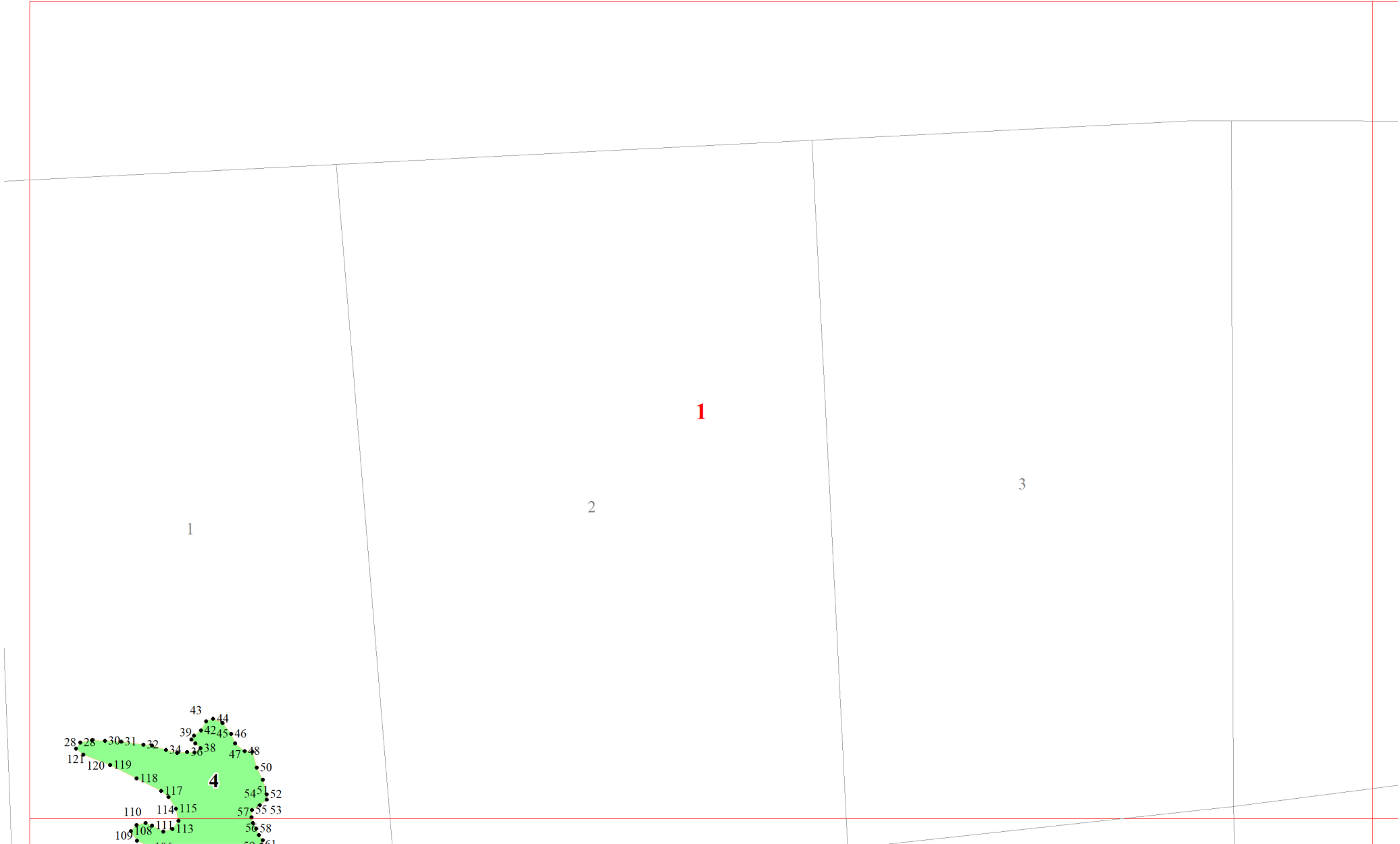

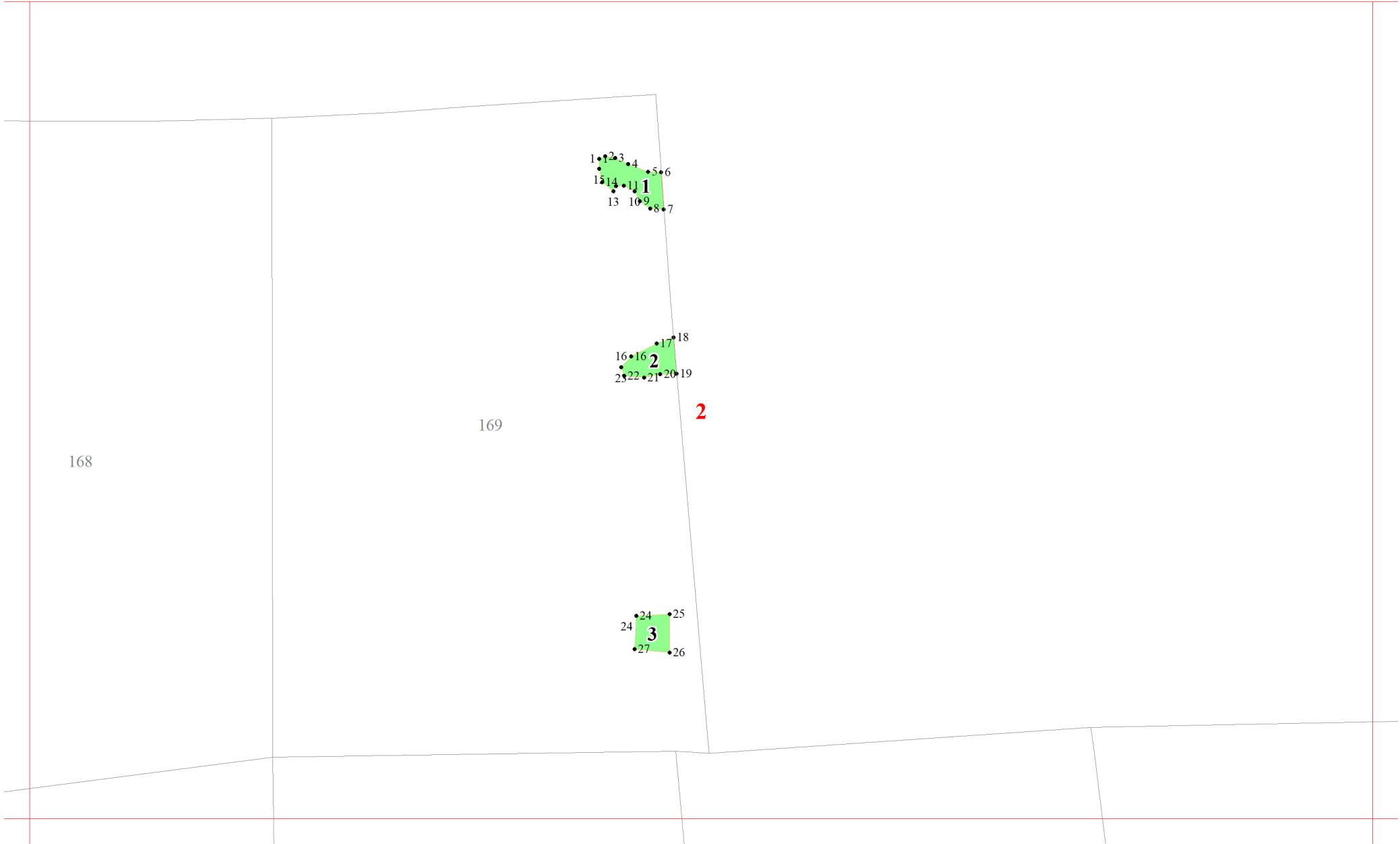

3



3

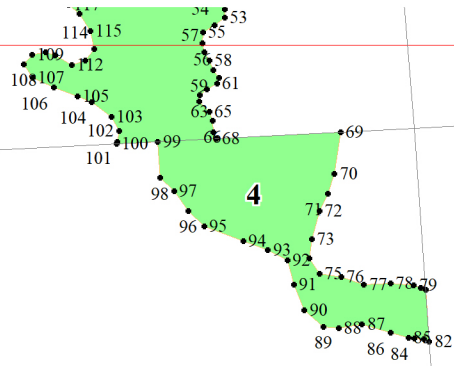

7

4

8

9

170

171

172

173

5

178
177
176
174
173
170
169
159
162
163
164
165
171
167
168

5

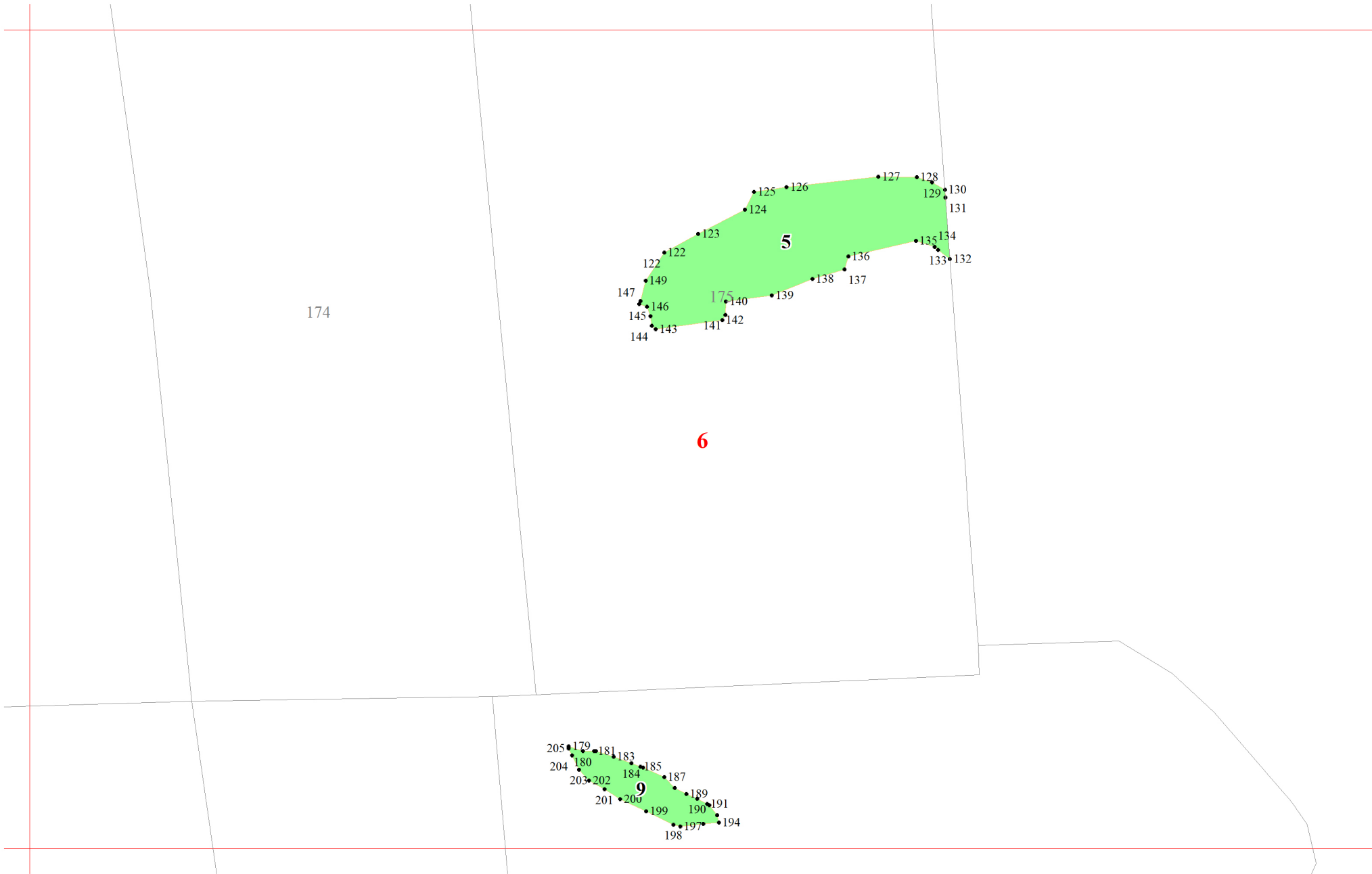

7

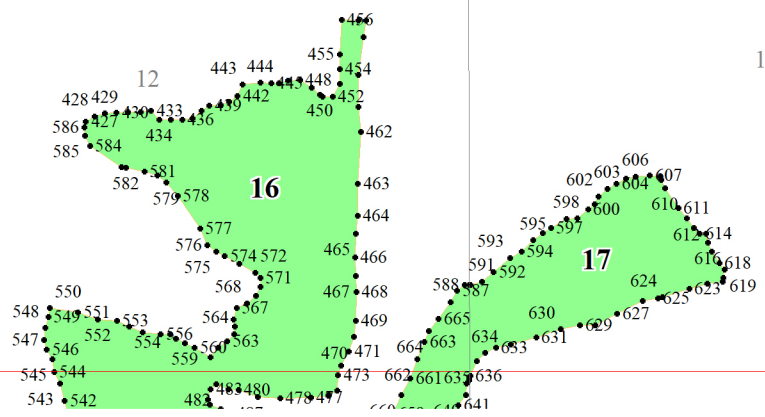

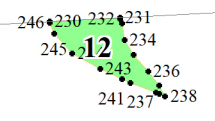
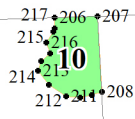

8

18

19

20

21

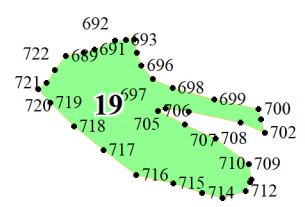
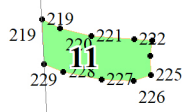

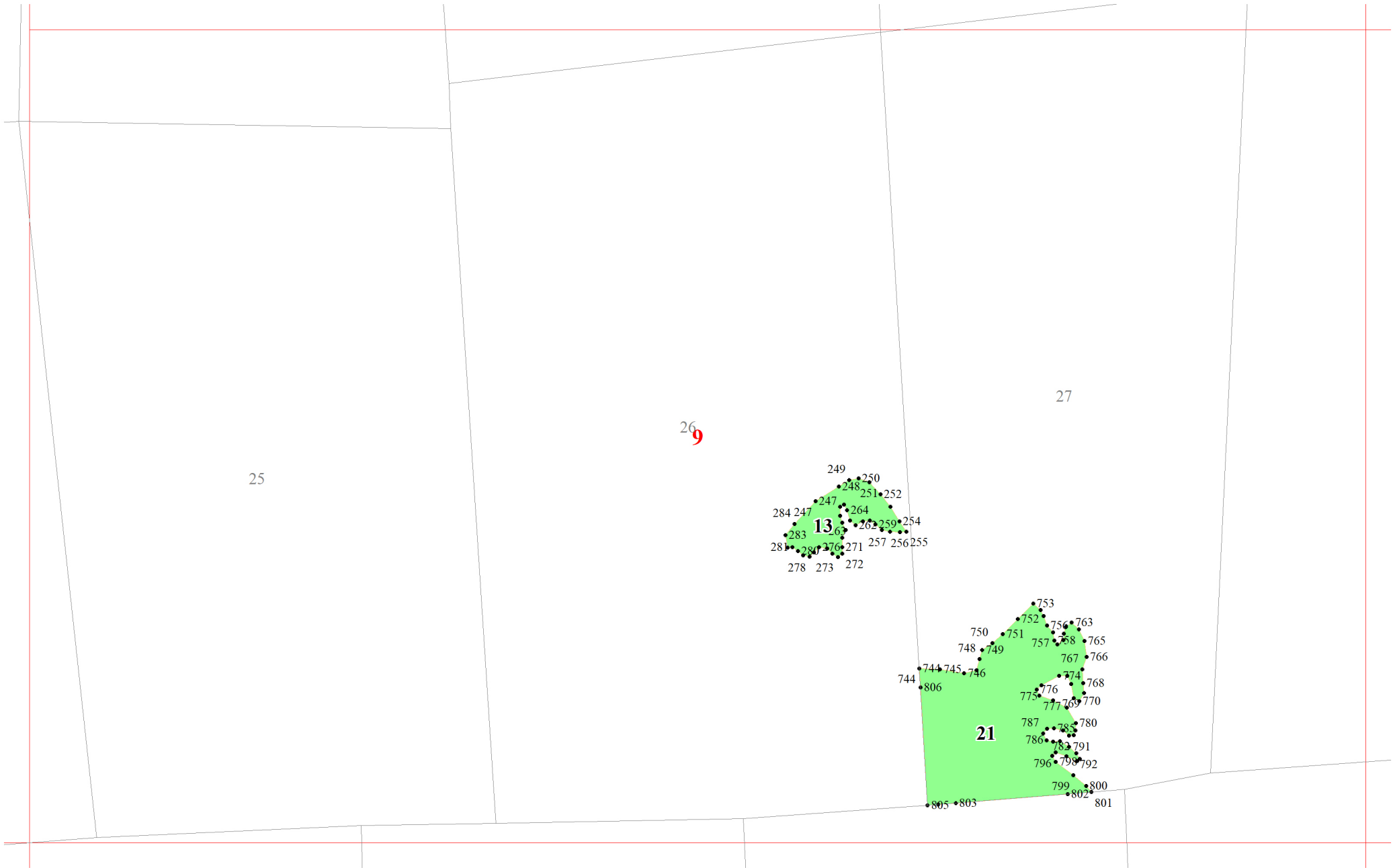

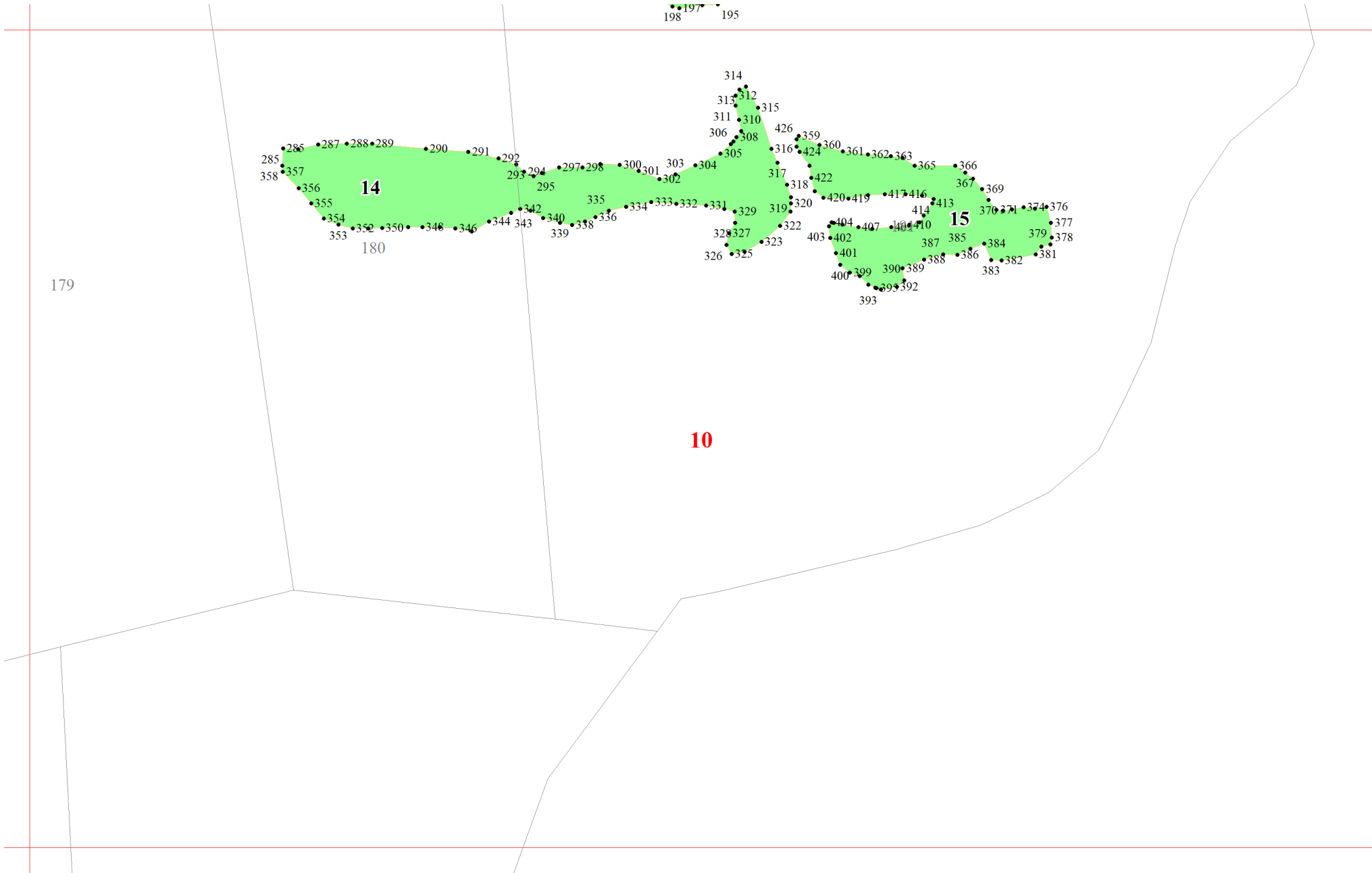

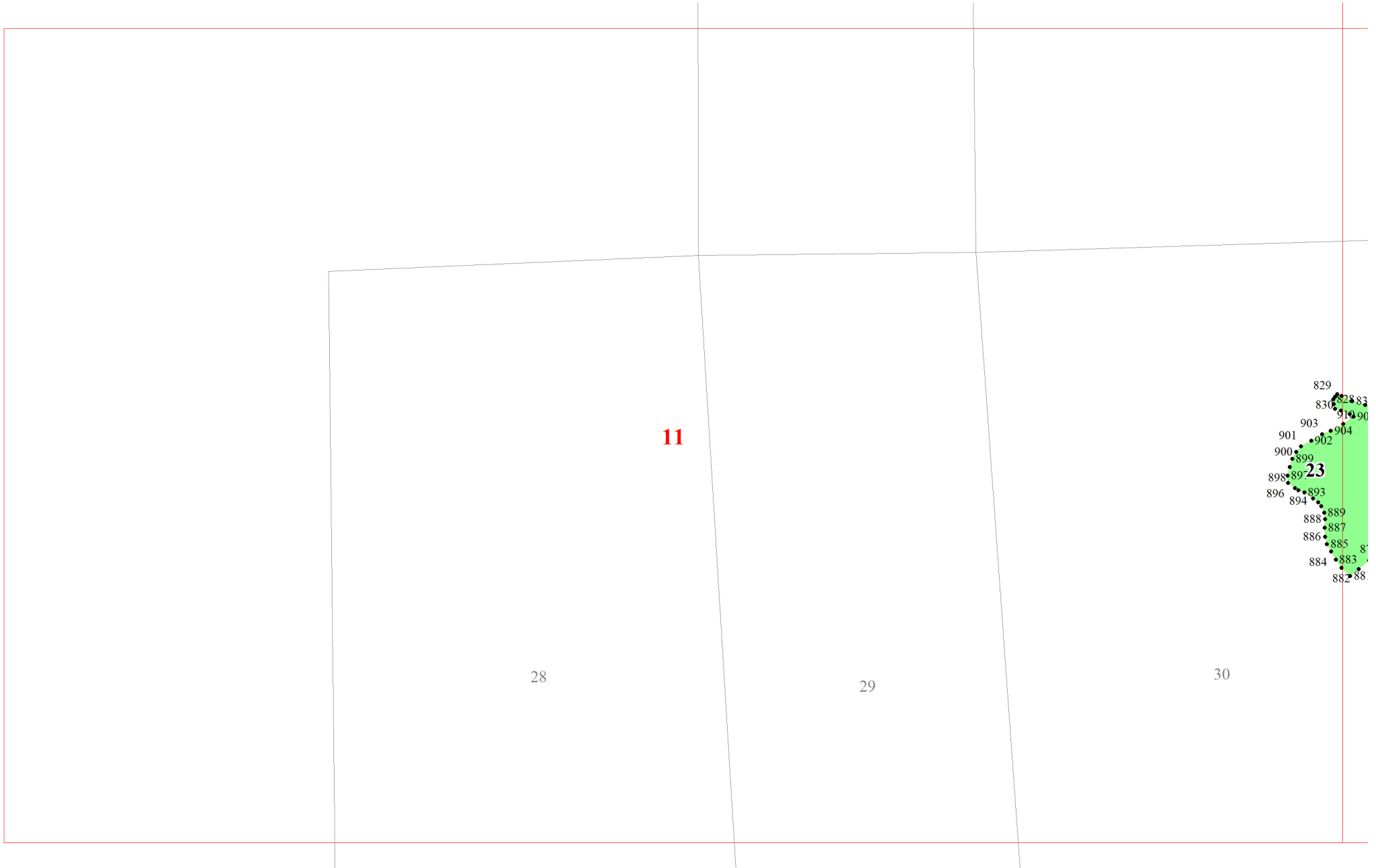

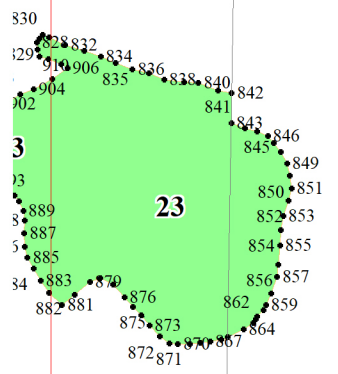
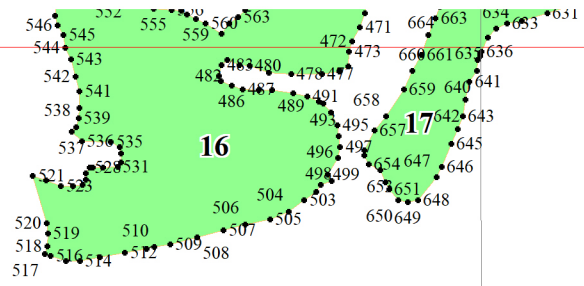

12

31

32

33

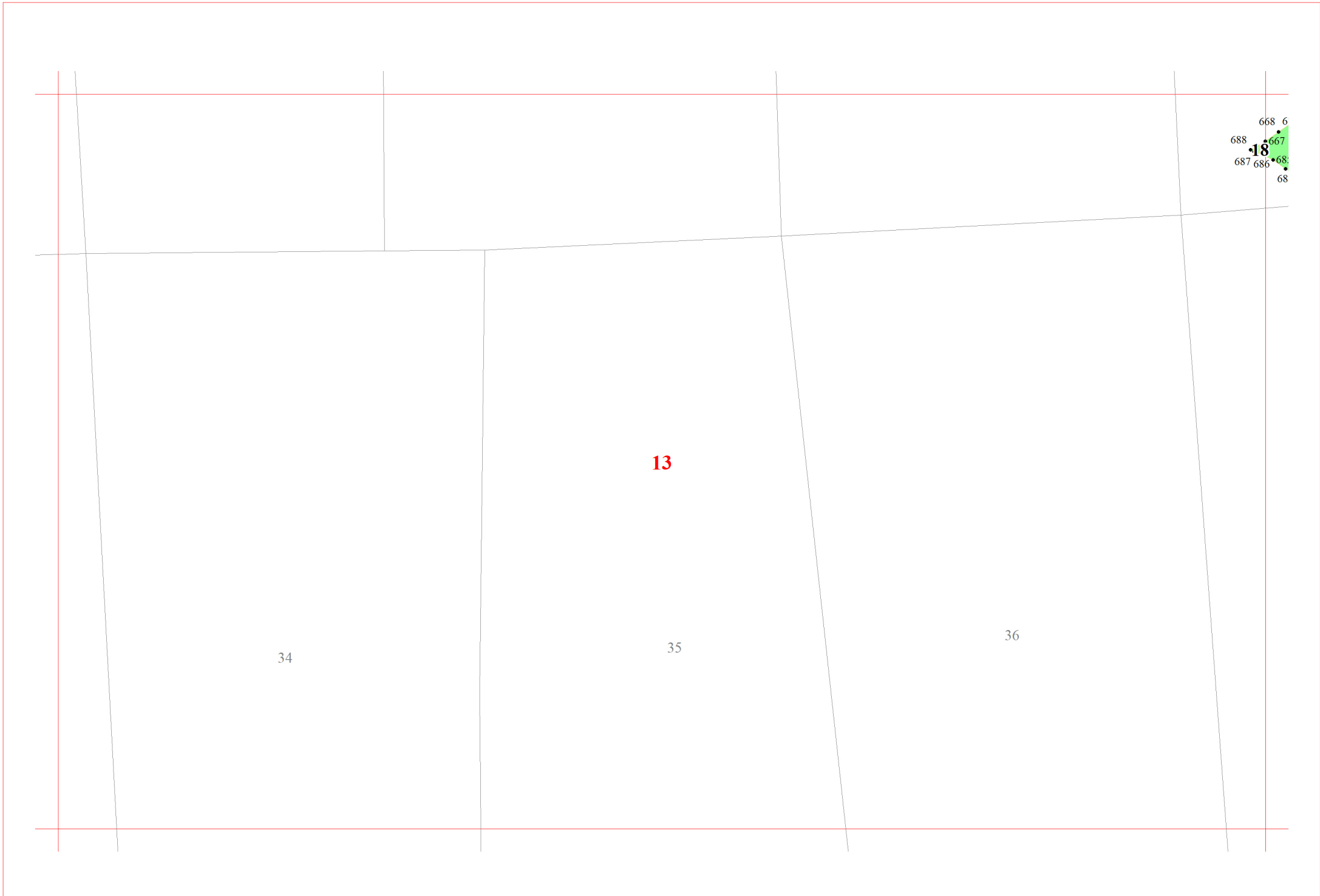

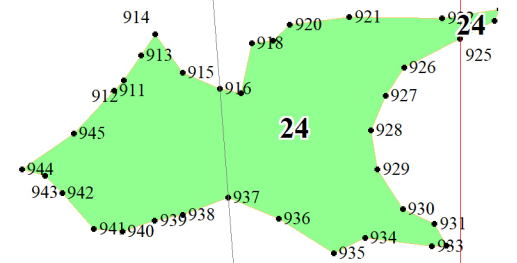
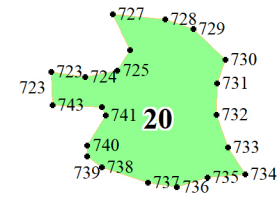
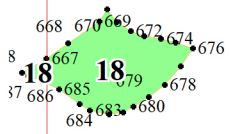

14

37

38

39

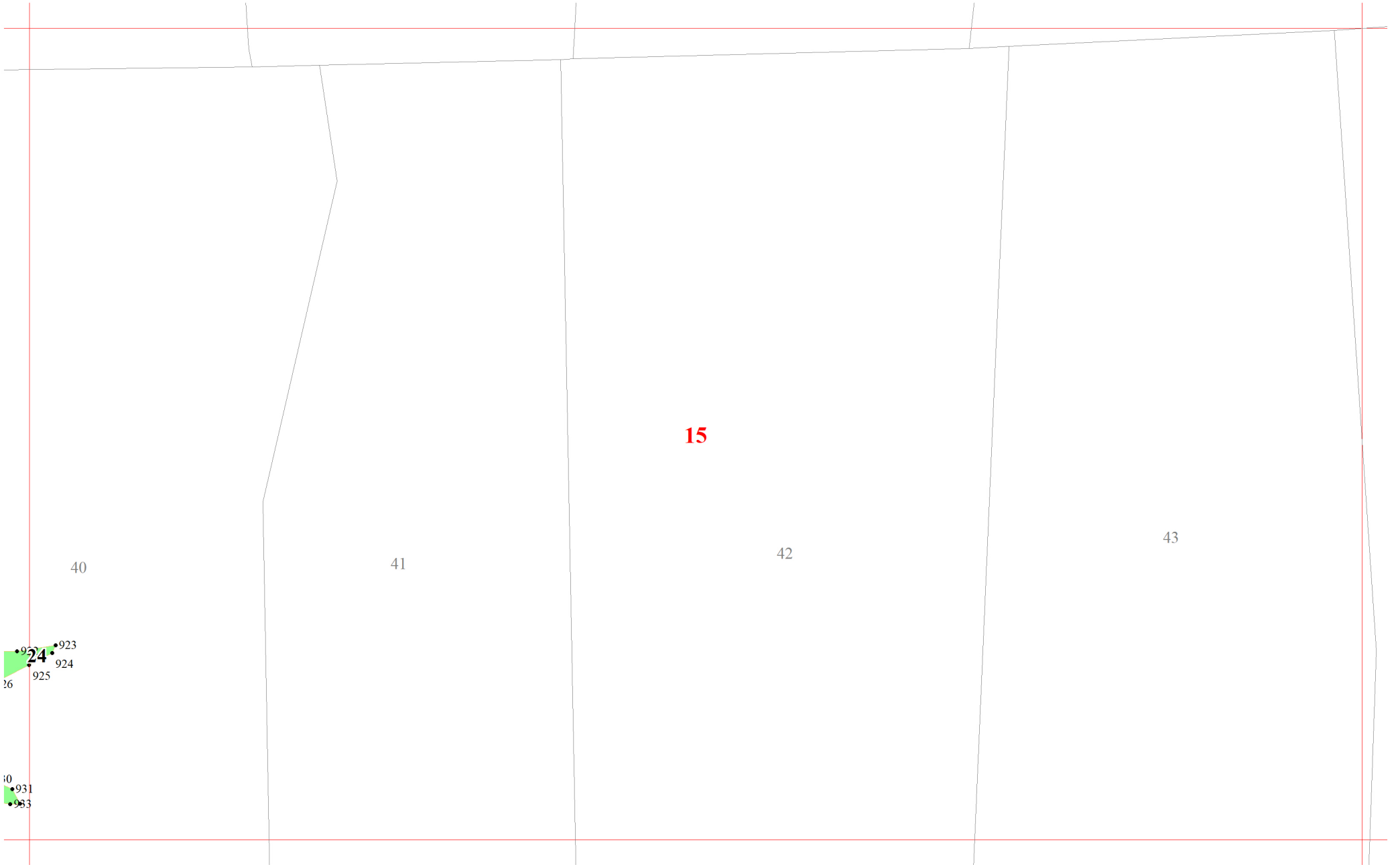

183

184

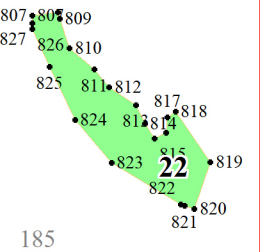

185

182

16

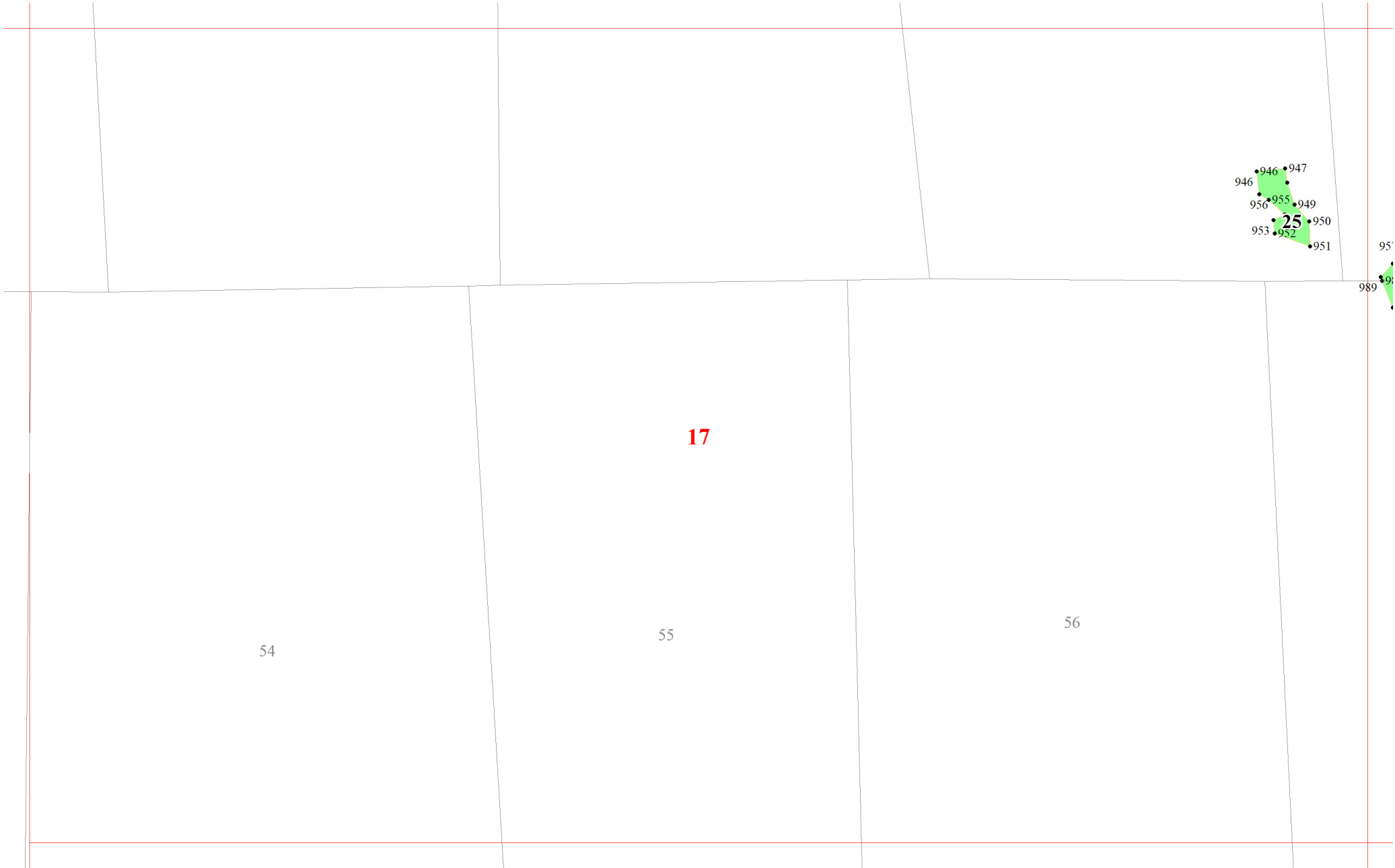

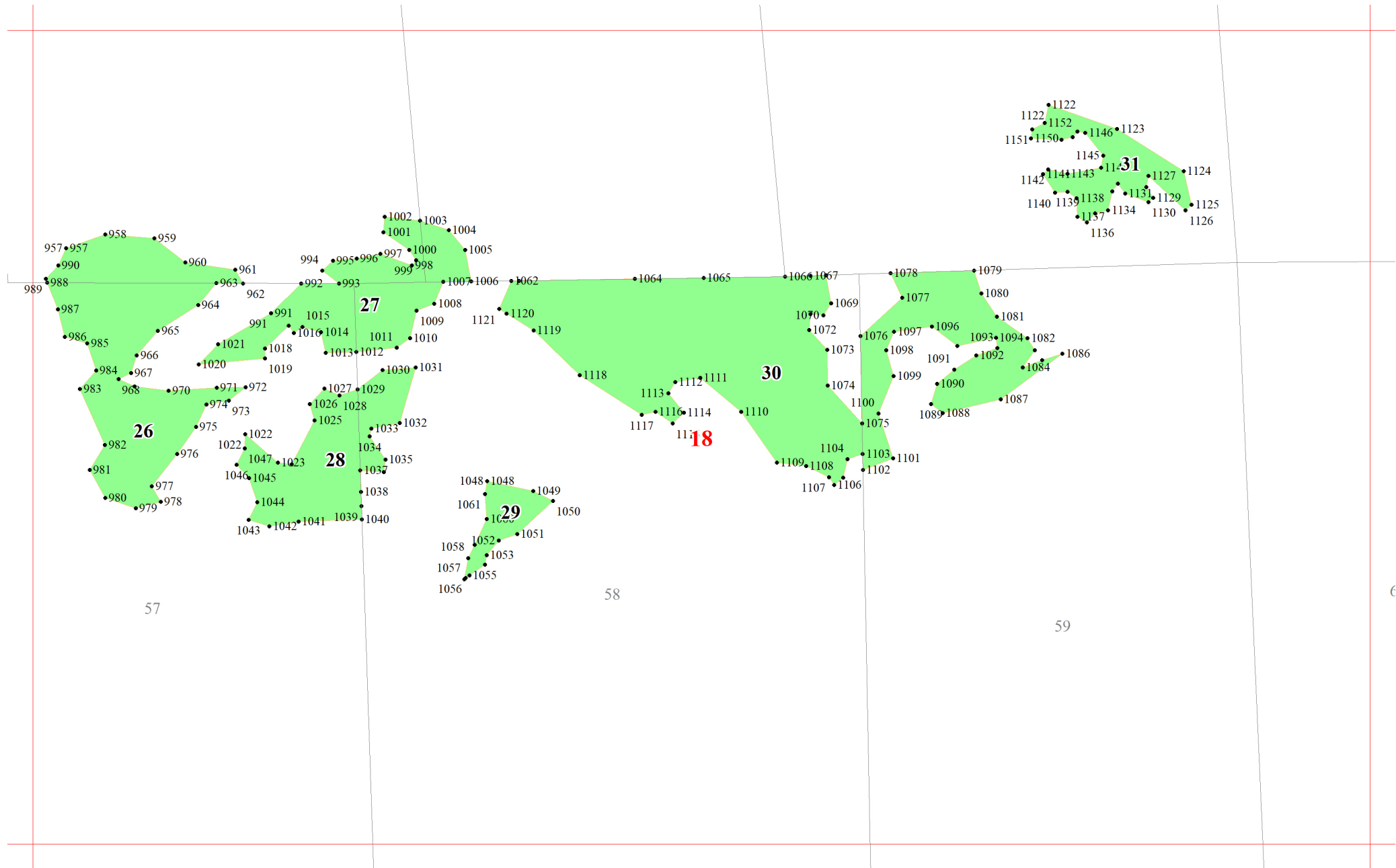

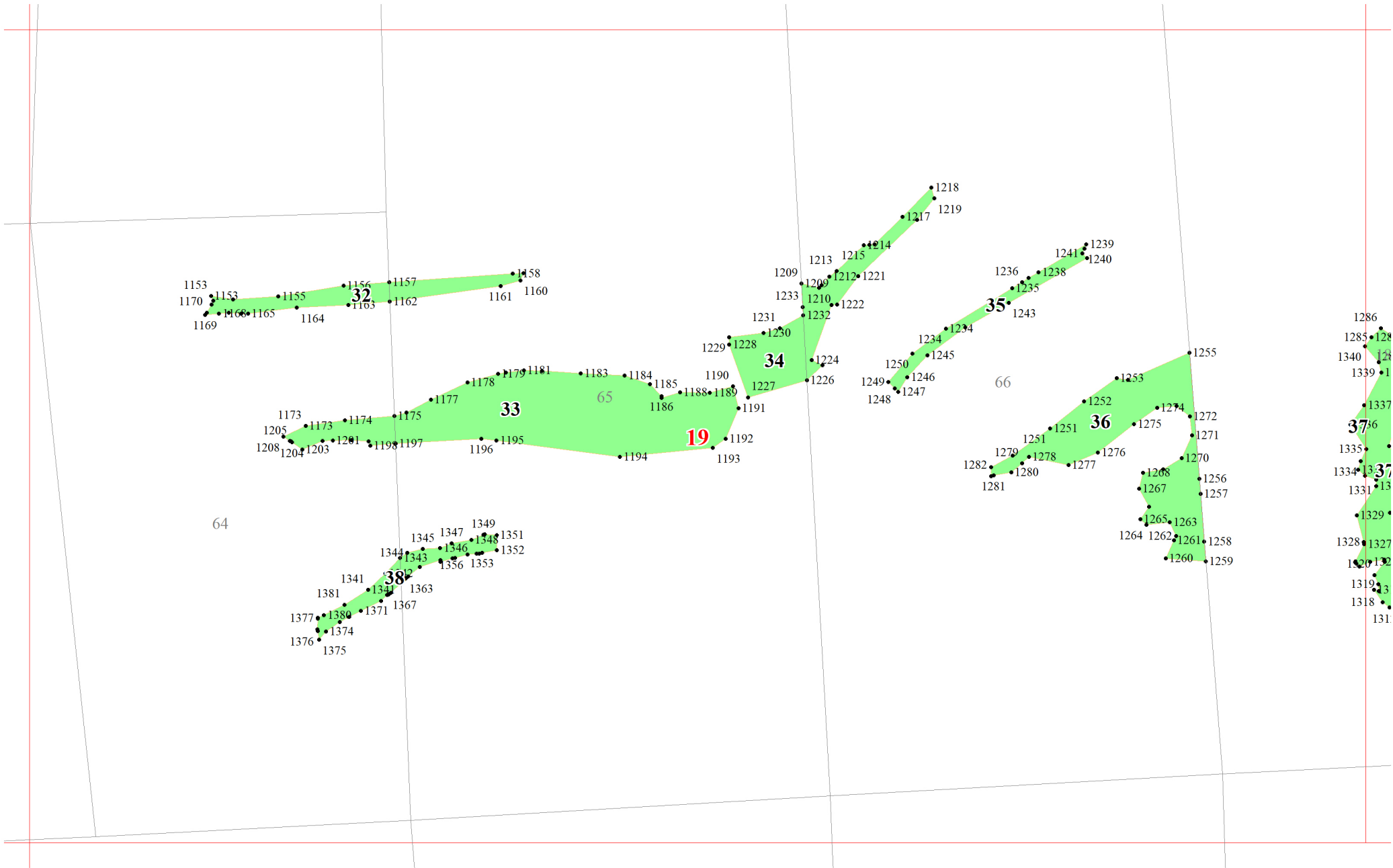

1286
1285
1285
1288
1340
1289
1339
1338
1290
1291
1337
1292
37
1293
1335
1294
334
1337
1331
1330
1296
1329
1299
328
1302
1327
1305
324
1323
1308
1320
1310
1318
1317
1312
1311
1314 1313

139

140

20

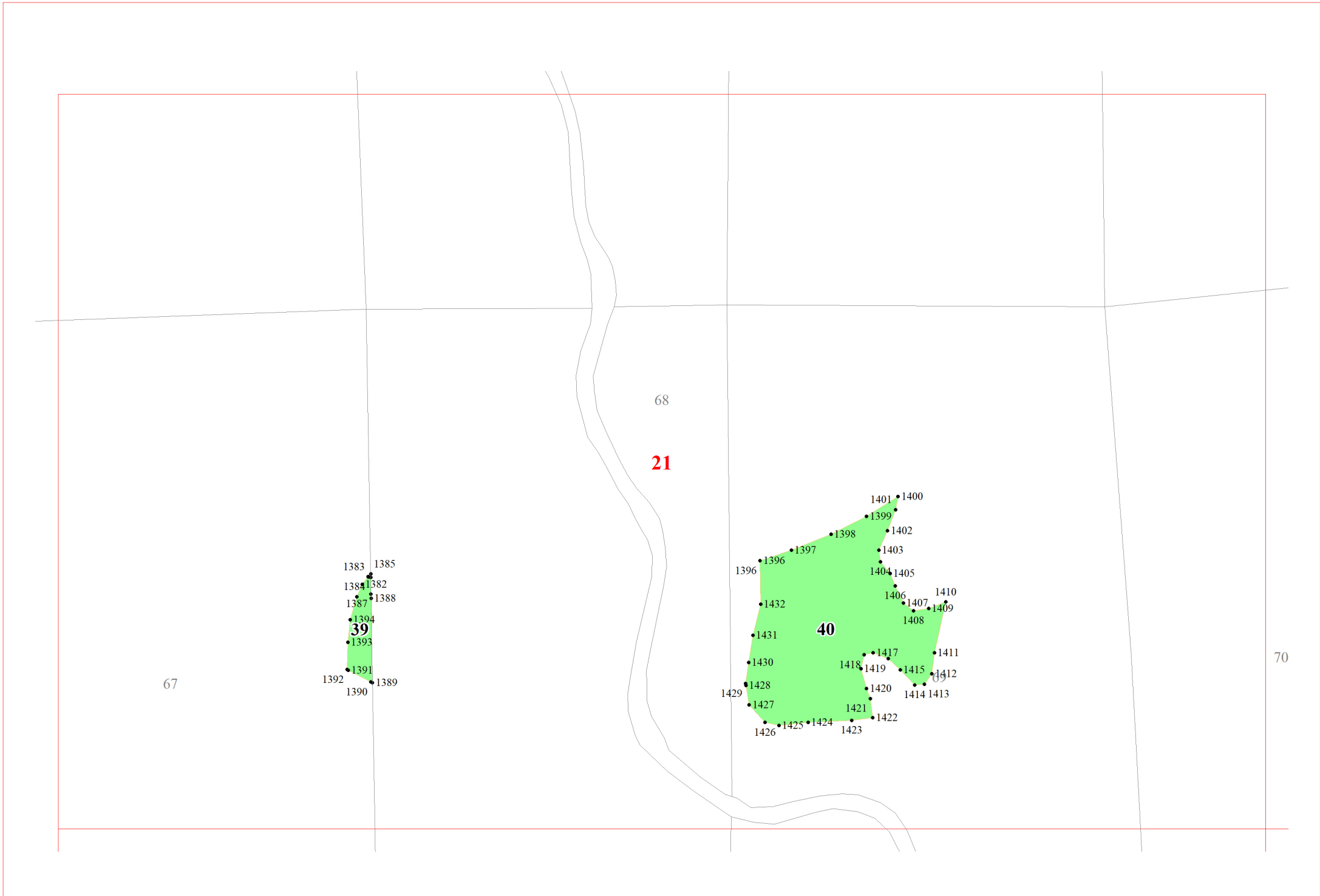

22

74

75

76

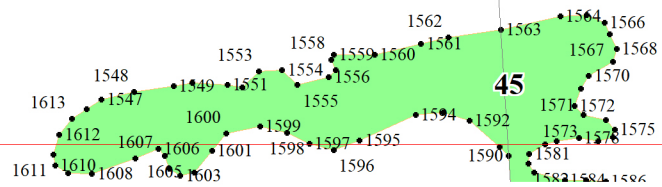

22

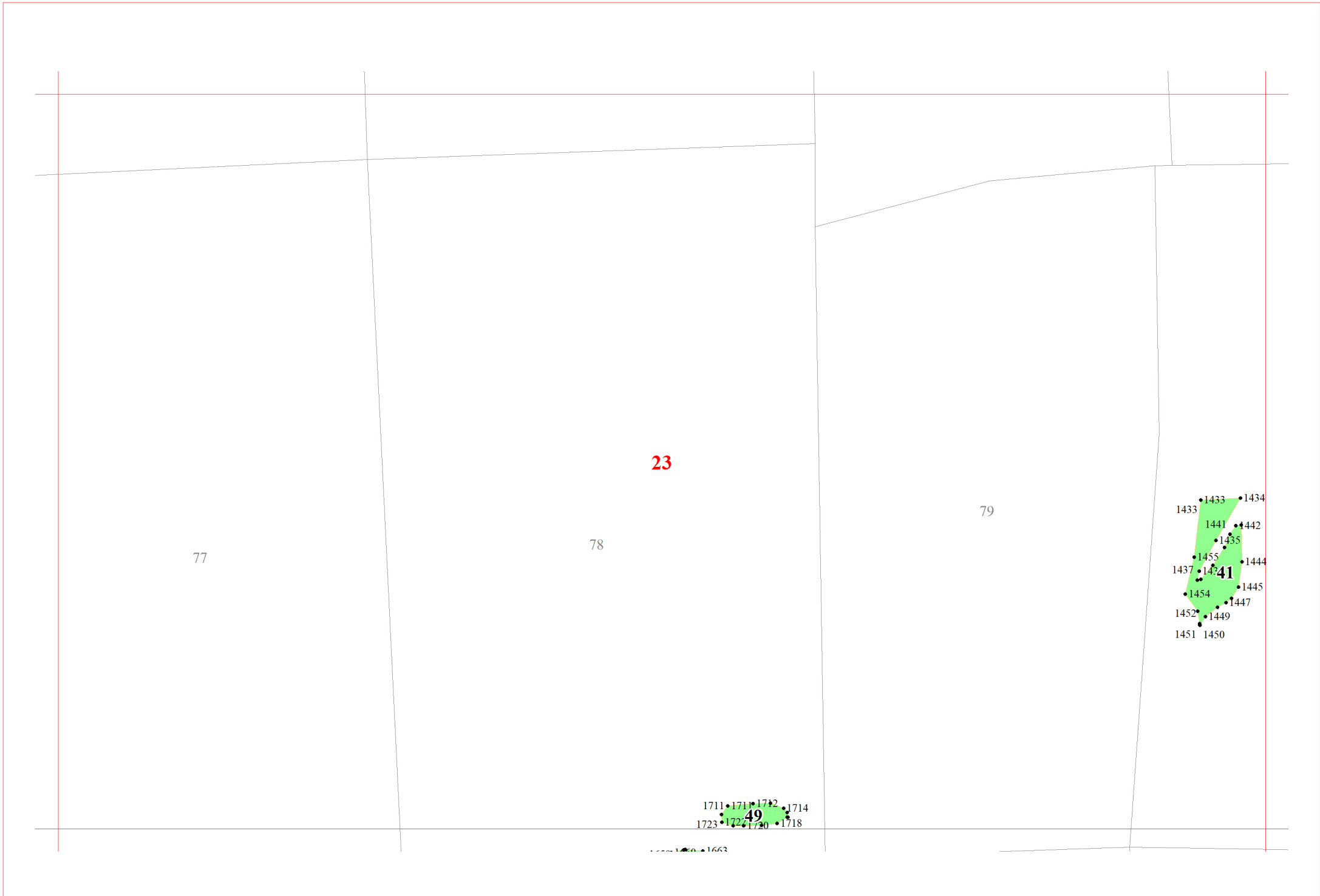

23

1433 1434
1441 1442
1435
1455 1444
1437 1441 1445
1454 1447
1452 1449
1451 1450

1711 1712 1714
1723 1724 1730 1718

1457
1456
1456
1466
1462
1459
1464
1460
1463
1461
1462

24

1520
1545
1541
1540
1520
1521
1522
1523
1537
1535
1534
1524
1533
1527
1528
1531
1530
1529

1434
1441
1444
1445
1446

80

81

82

83

1479 1480
1476 1478
1474 1475 1482
1473 1484
1472 1485
1471 1487
1470 1490
1469 1493
1468 1496
1467 1498
1516 1518 1500
1515 1501 1499
1514 1502
1512 1513 1505
1511 1507 1509
1747 1749
1748
1746 1750
1754 1752
1753

25

87

89

- 1771
- 1772
- 1770
- 1767
- 1769
- 1775
- 1834
- 1766
- 1777
- 1833
- 1832
- 1780
- 1831
- 1781
- 1782
- 1830
- 1829
- 1783
- 1784
- 1828
- 1827
- 1785

53

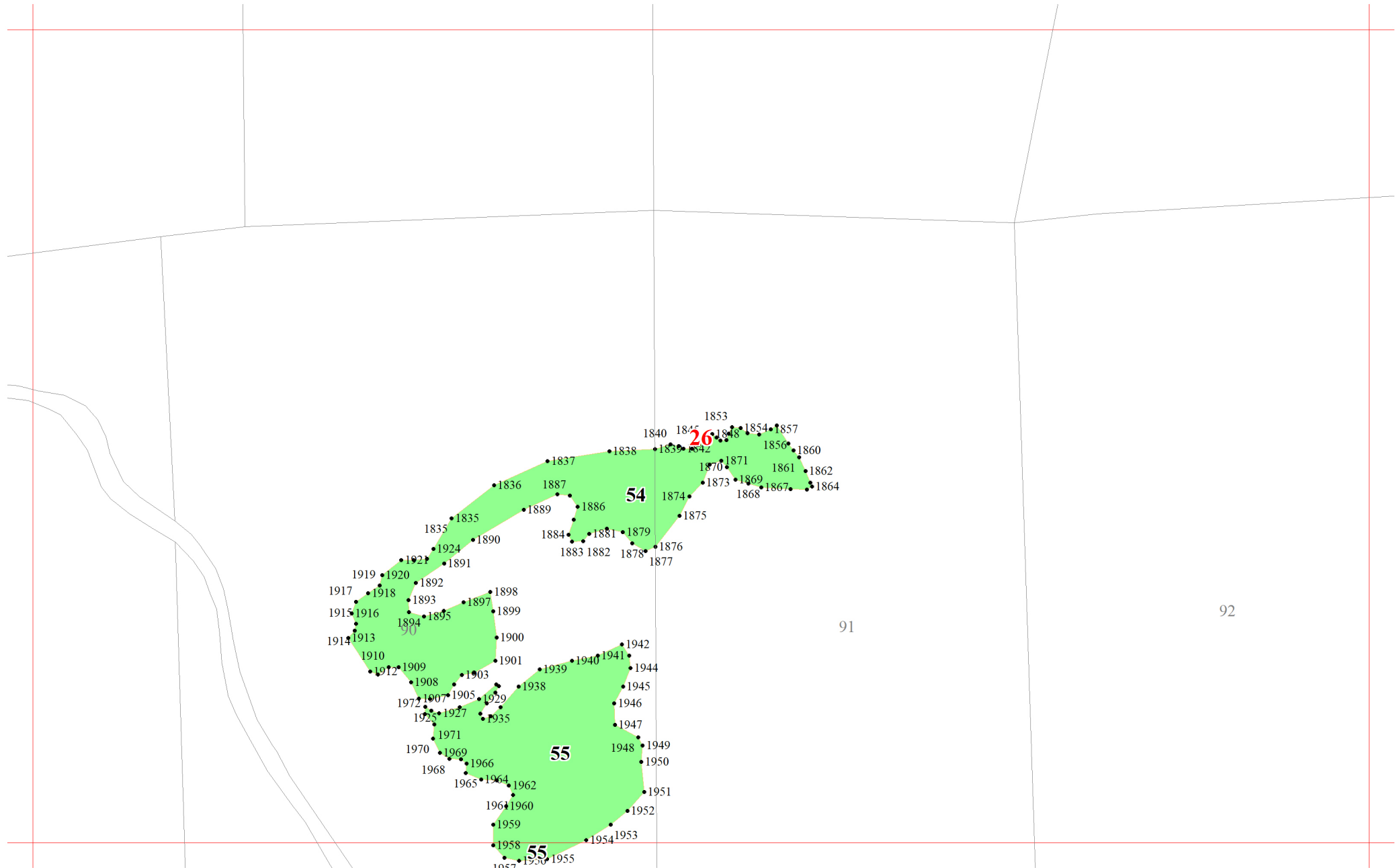

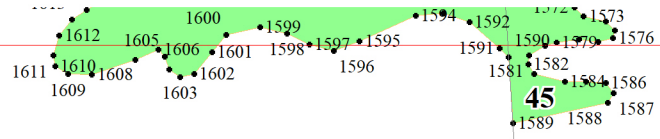

27

93

94

95

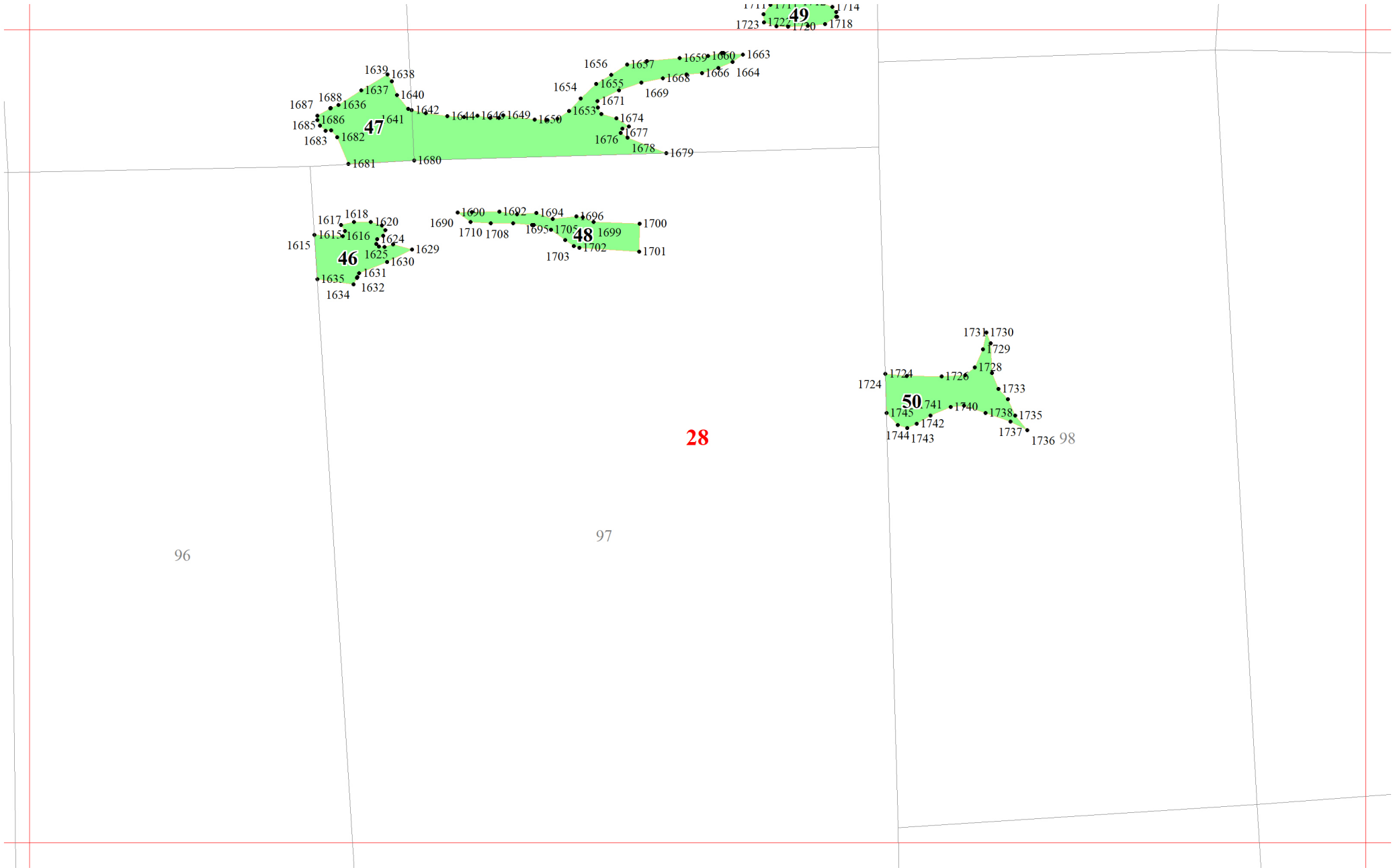

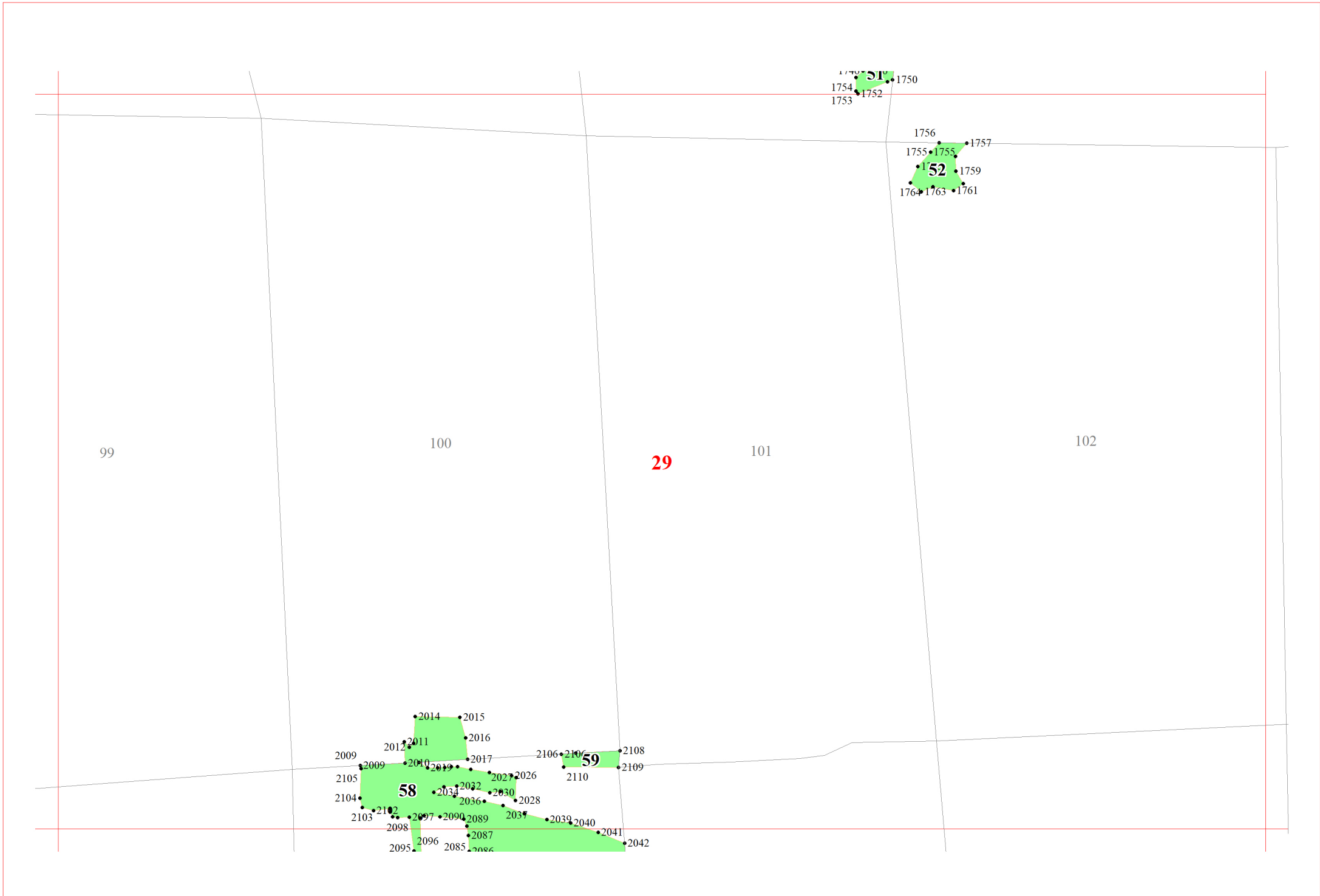

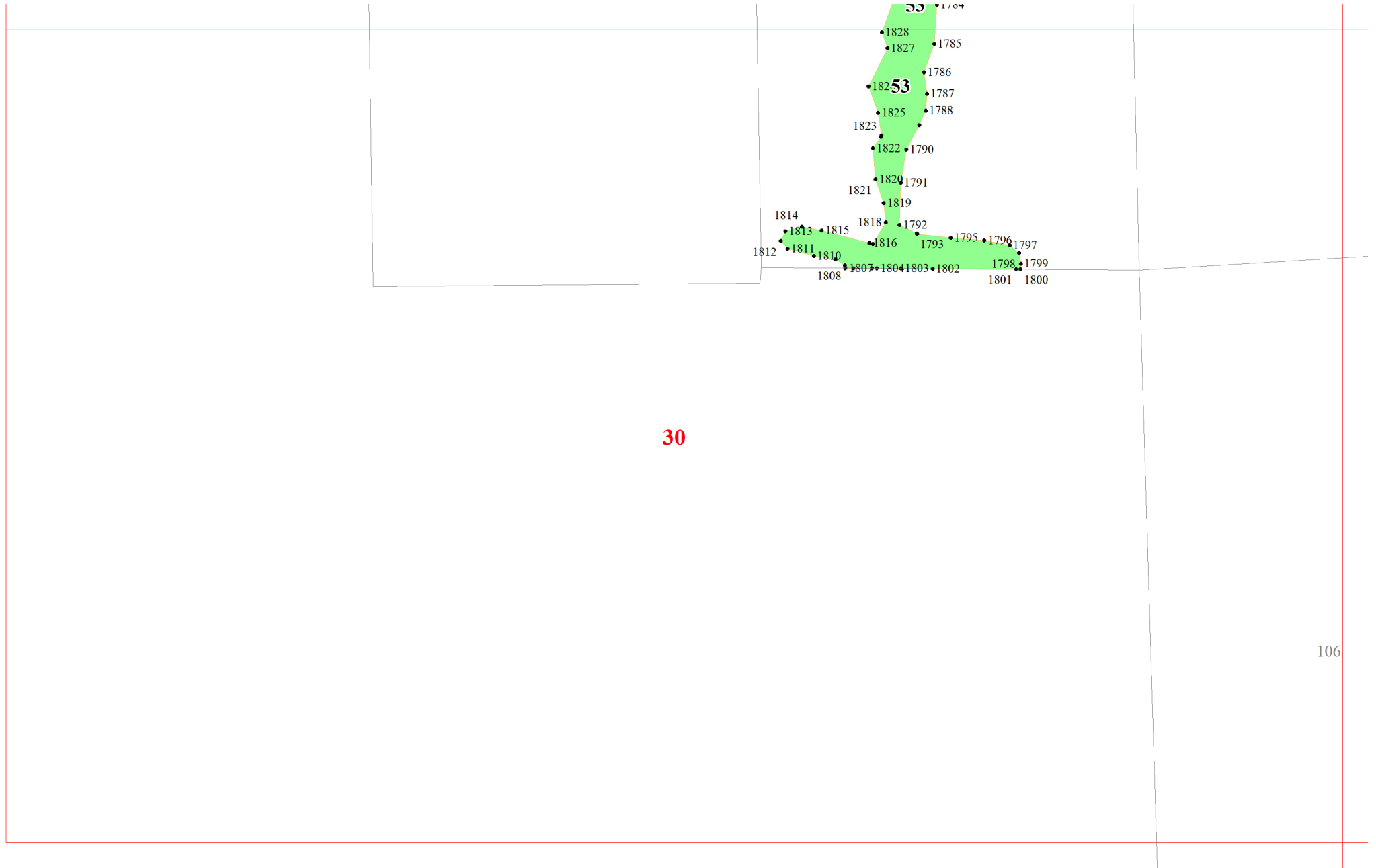

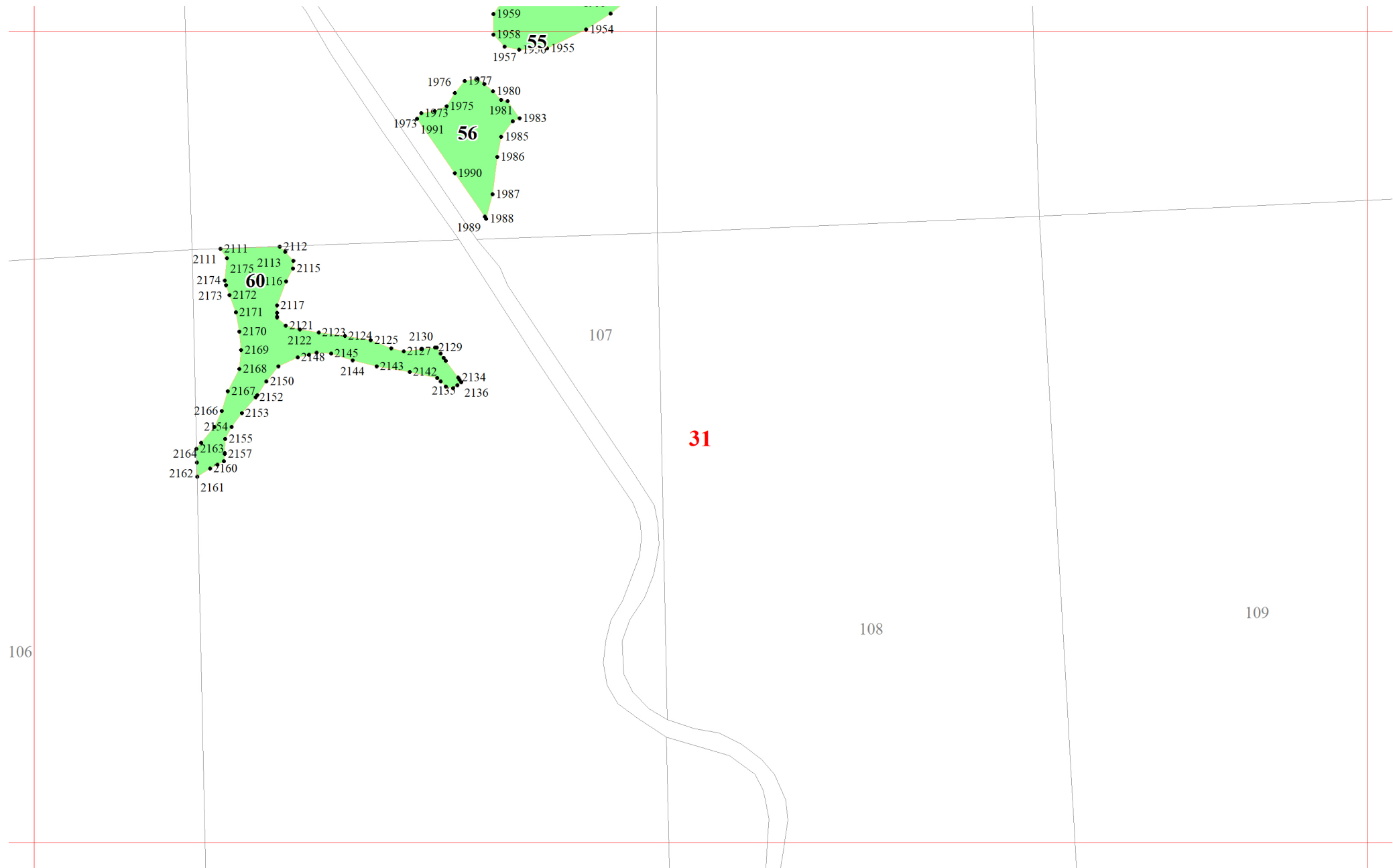

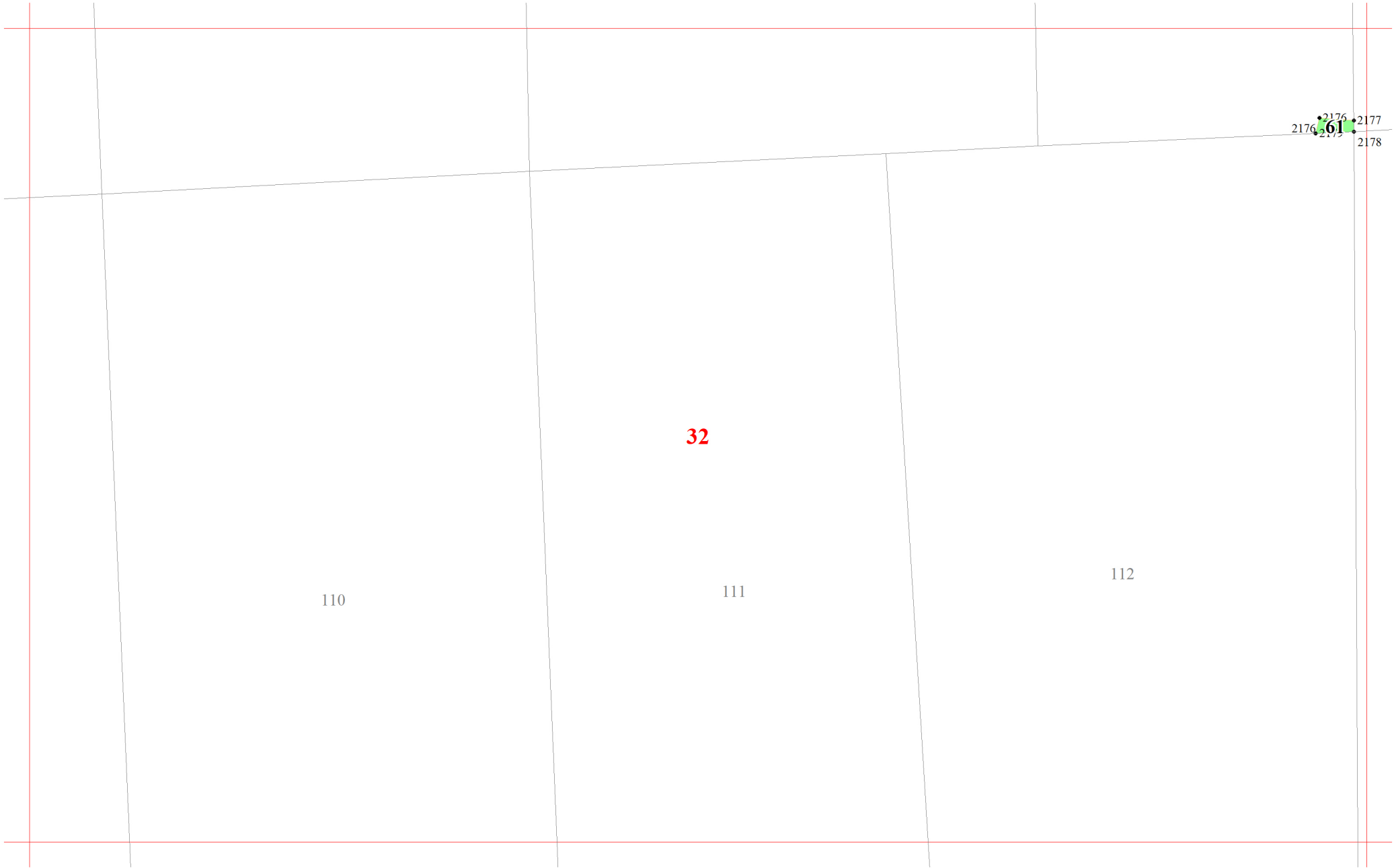

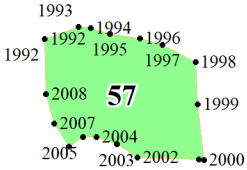
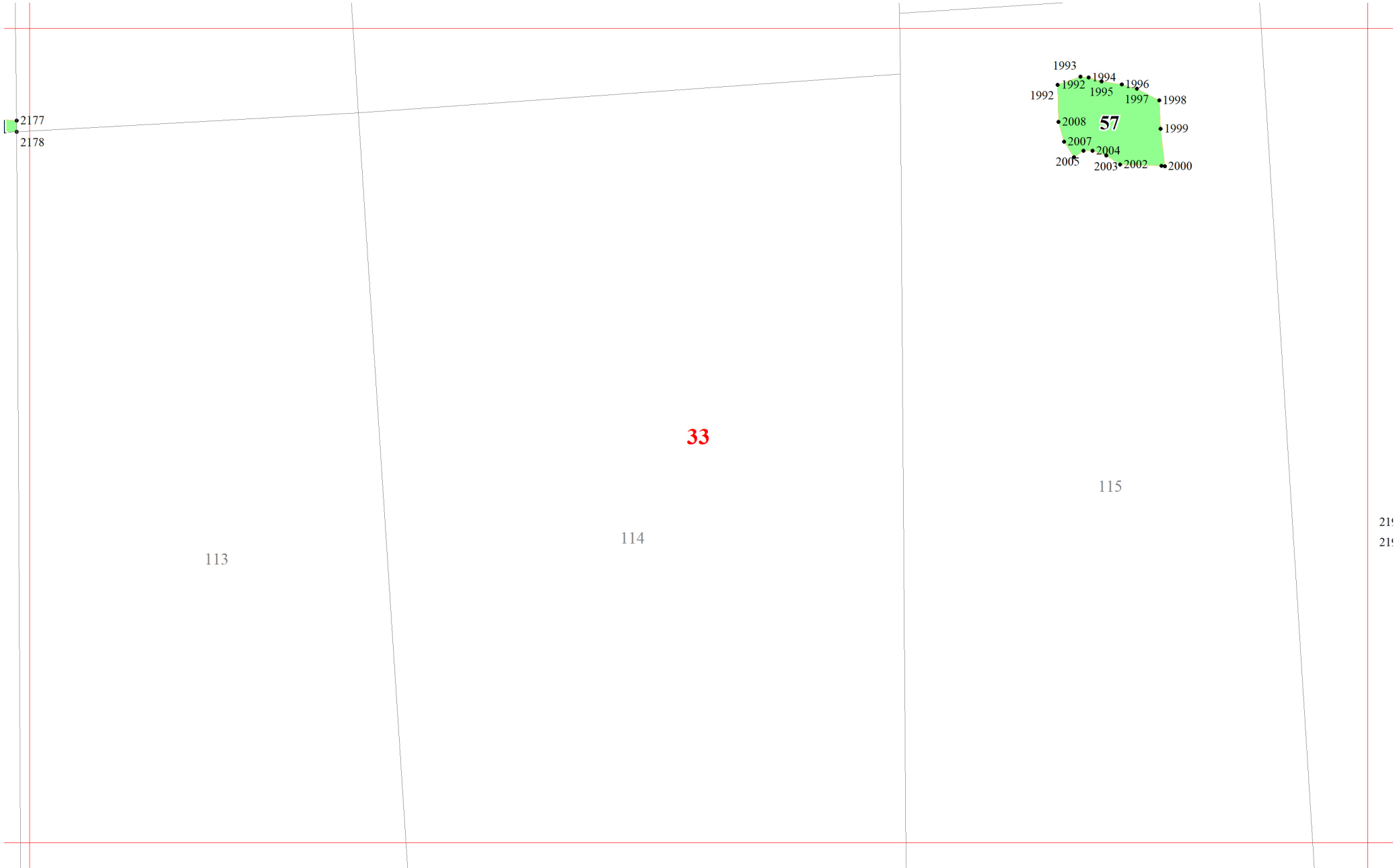

33

113

114

115

21!
21!

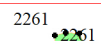
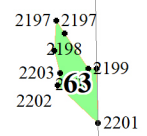
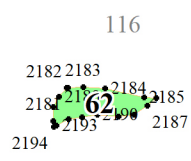
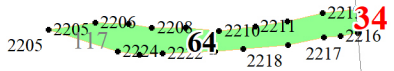
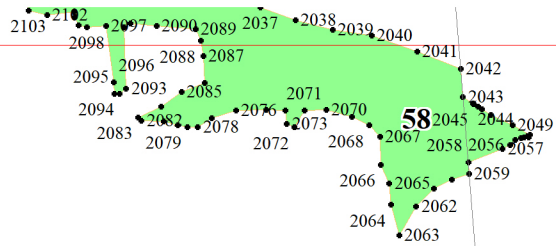

2333

116

118

119

120

121

122

35

2360 • 2360 • 2362
2374 • 2373 • 2364
2372 • 2371 • 2365
2369 • 2368

70

35

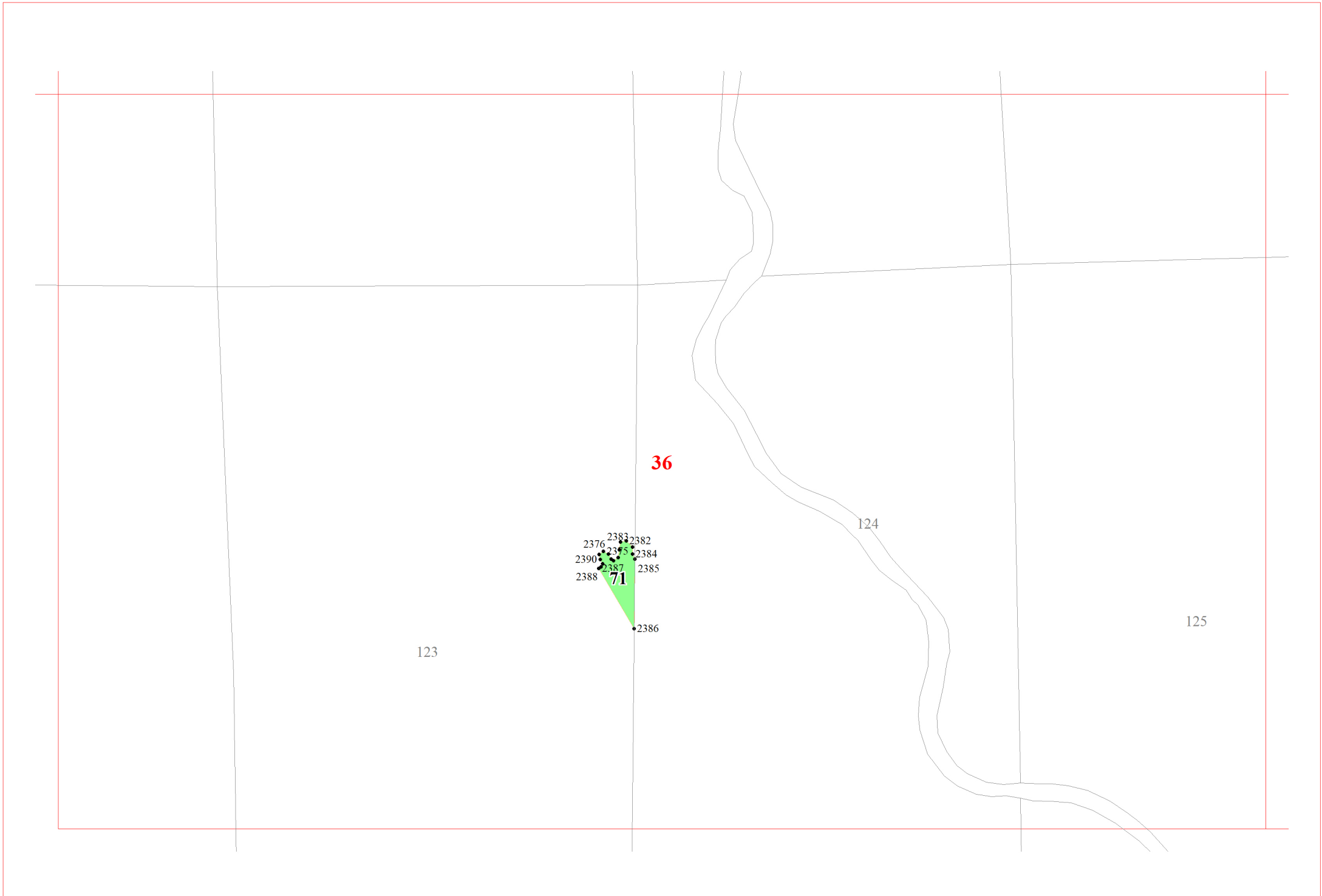

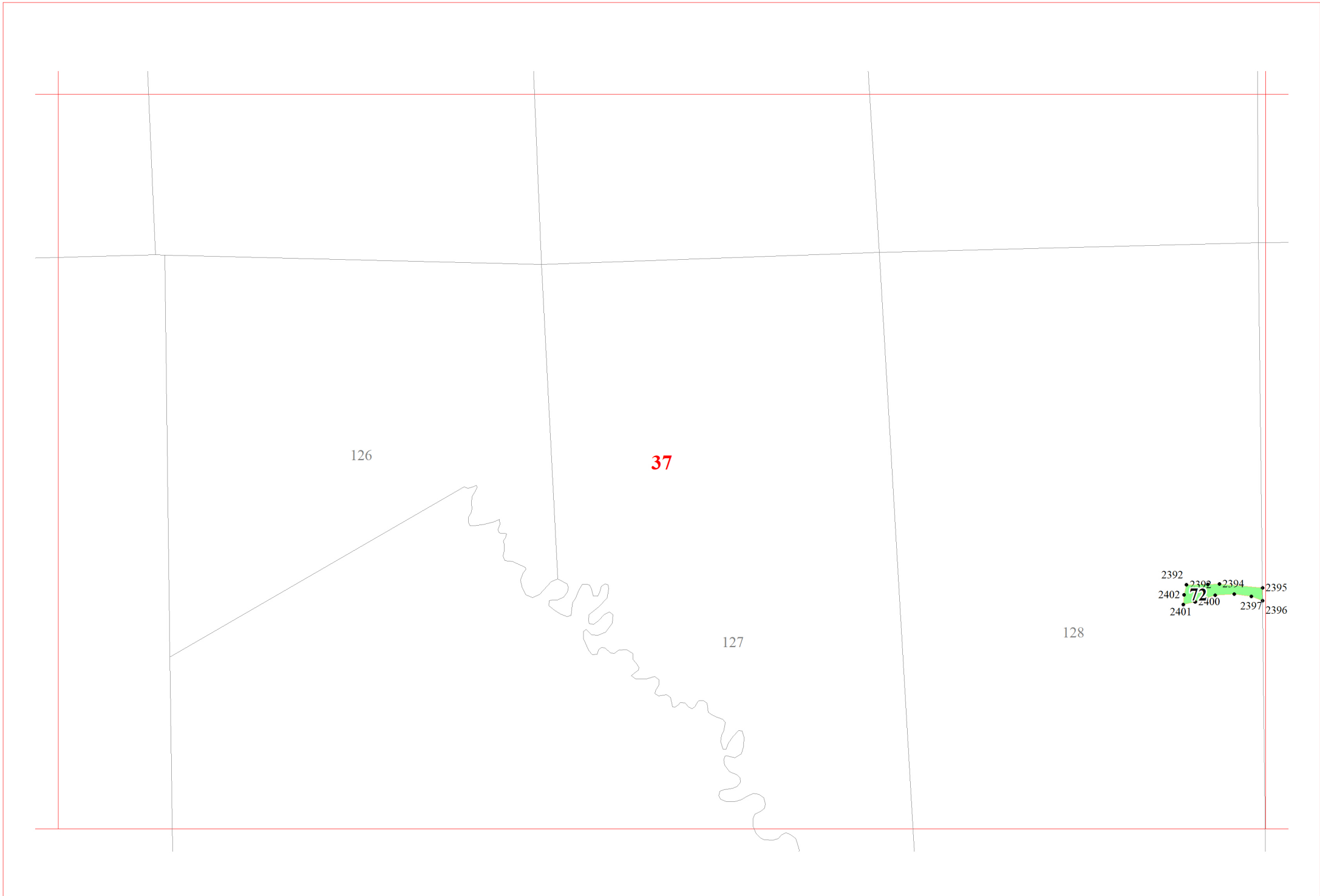

2234
2225
2226
2232
2227
2231
2228
2230
2229
65

2235
2235
2236
2260
2259
66
2238
2237
2244
2242
2258
2254
2243
2239
2253
2251

398
2395
2396

2422
2423
2424
2420
2421
2418
2419
2427
2416
2417
2428
2414
2415
2429
2413
2433
2409
2408
2411
2438
2404
2404
2406
2407
2438
2501
2498
2497
2495
2439
2440
2500
2498
2494
2445
2447
2444
2494
2492
2445
2447
2487
2489
2491
2454
2451
2449
2486
2488
2450
2485
2455
2457
2483
2484
2460
2461
129
2479
2482
2463
2474
2478
2465
2464
2472
2466
2473
2471
2470
2466
2469
2468

38

130

131

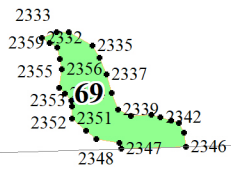
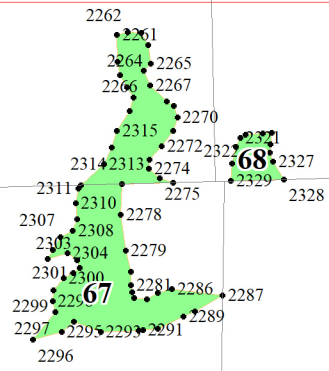

68

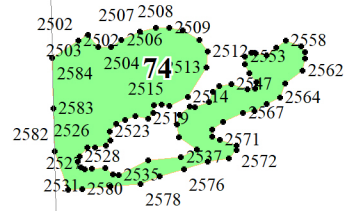

39

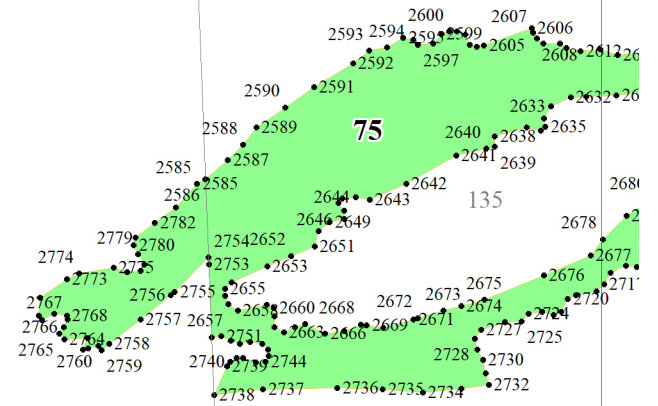

132

133

134

