

**Графическое описание местоположения границ
земель, на которых располагаются ценные леса
(лесостепные леса),
на территории Кандринского участкового
лесничества Туймазинского лесничества
Республики Башкортостан**

Приложение № 62 к приказу Рослесхоза
от 27.02.2023 № 201

- Условные обозначения:**
- 1 номера листов
 - 3 номера участков
 - 61 номера лесных кварталов
 - границы лесных кварталов
 - границы листов
 - границы категорий защитных лесов
 - 45 номера характерных точек границ
 объекта

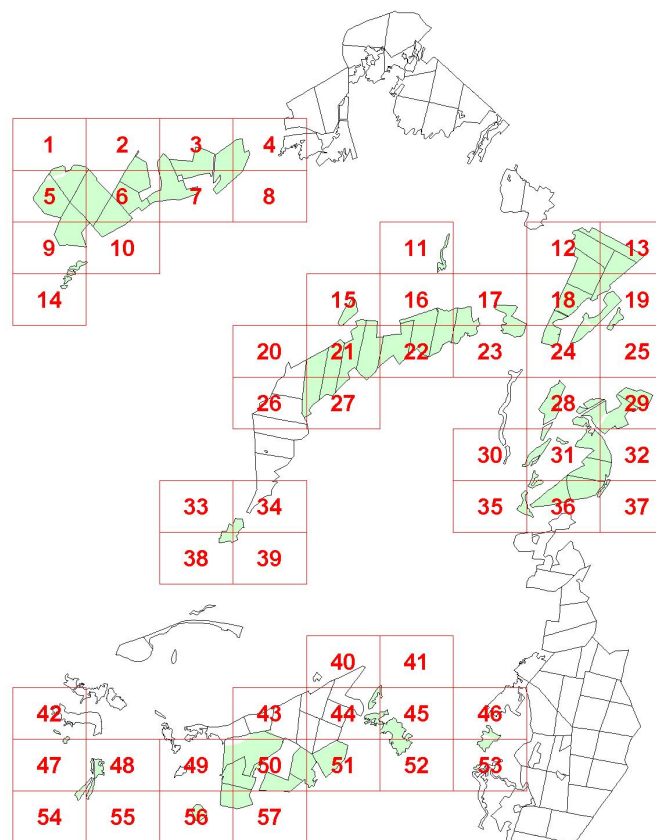

1

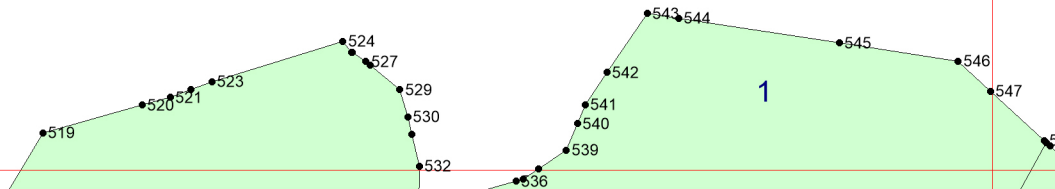

2

2

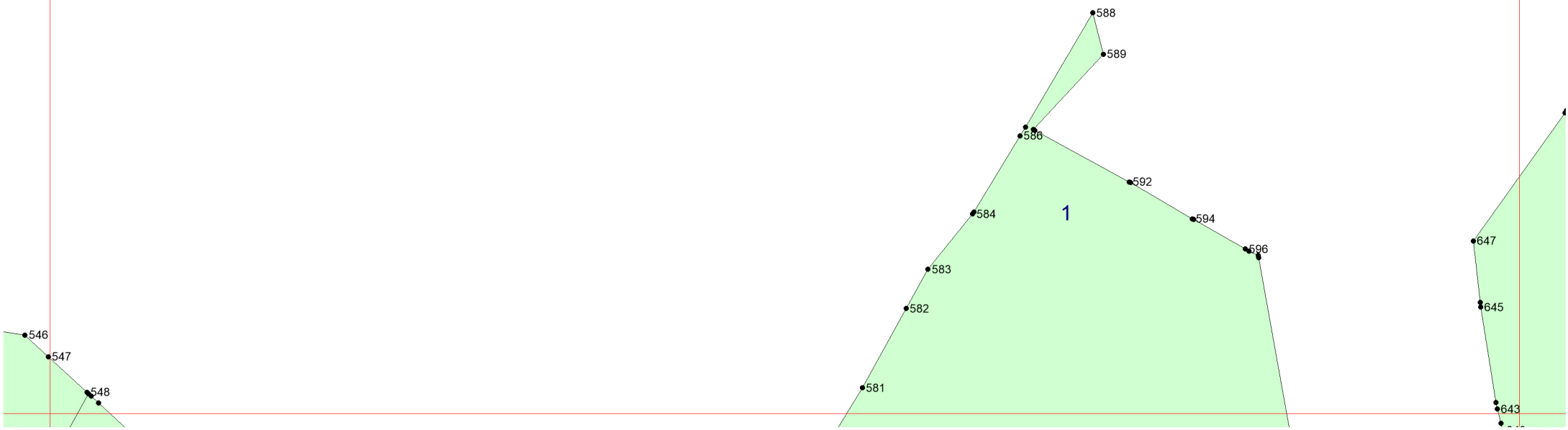

3

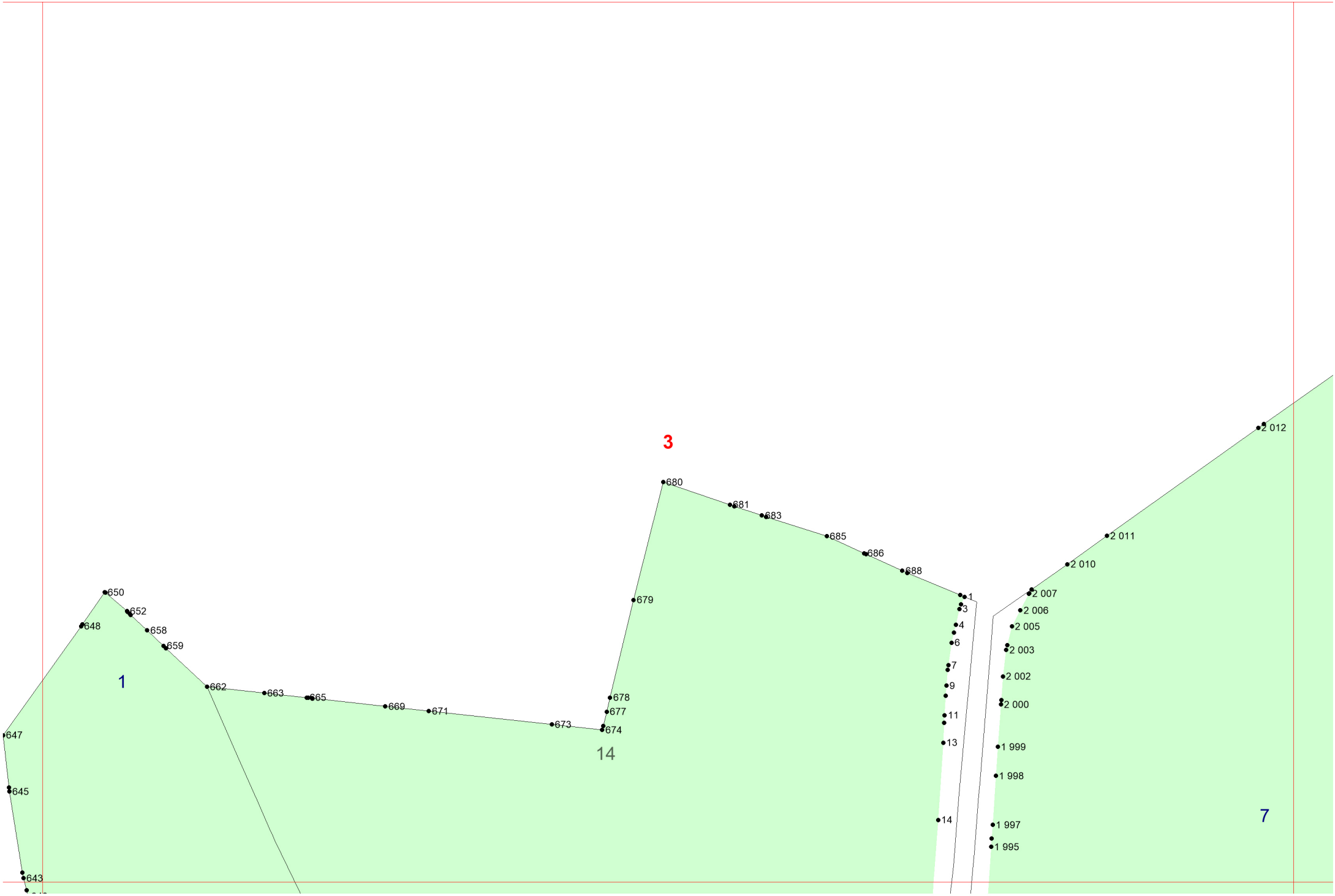

1

3

14

7

4

647
645
643
648
650
652
658
659
662
663
665
669
671
673

678
677
674
679
680
681
683
685
686
688

1
3
4
6
7
9
11
13
14

2007
2006
2005
2003
2002
2000
1999
1998
1997
1995
2010
2011
2012

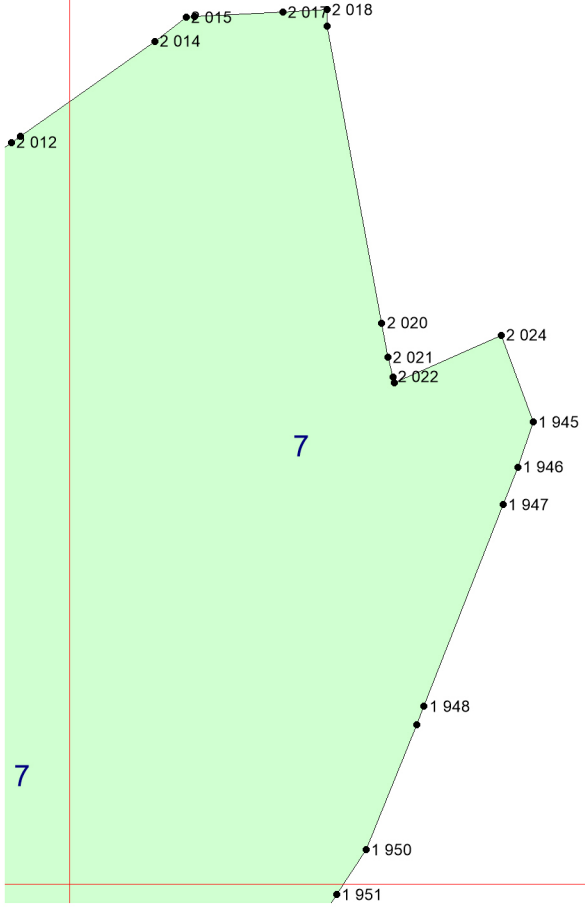

4

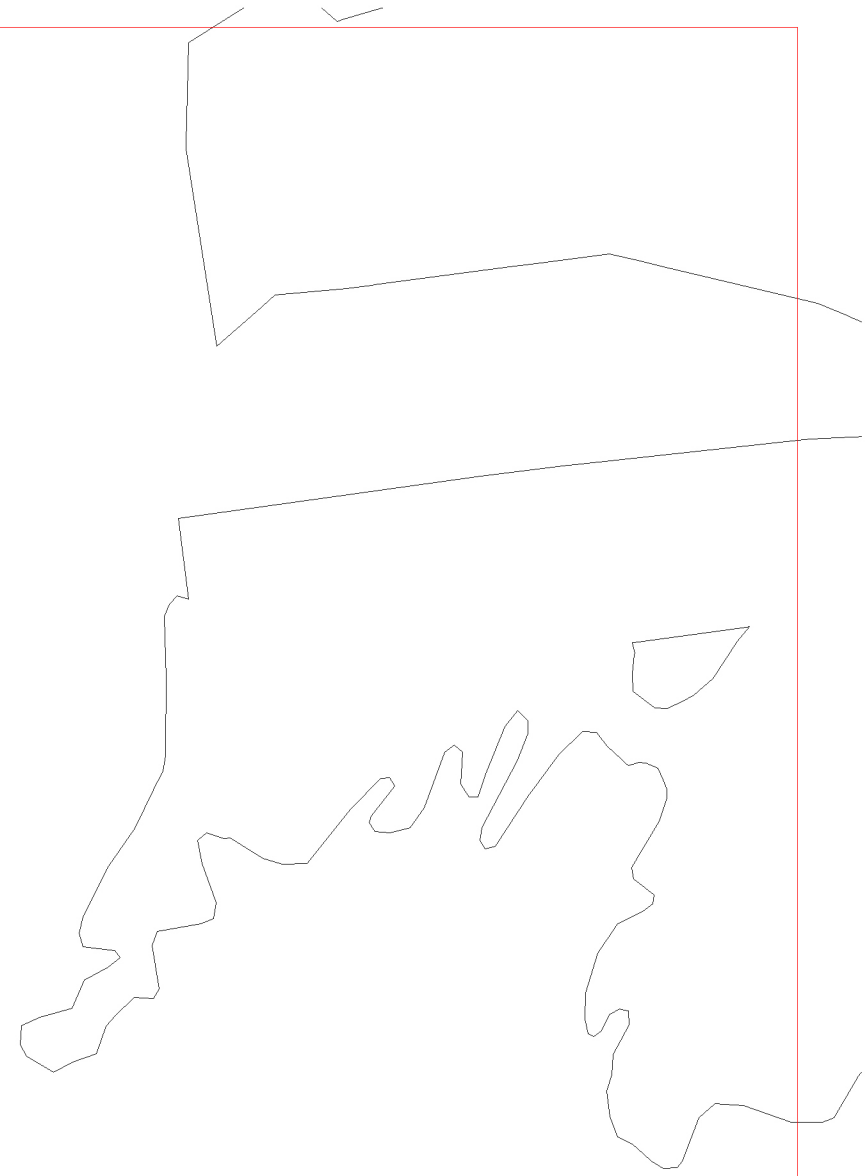

5

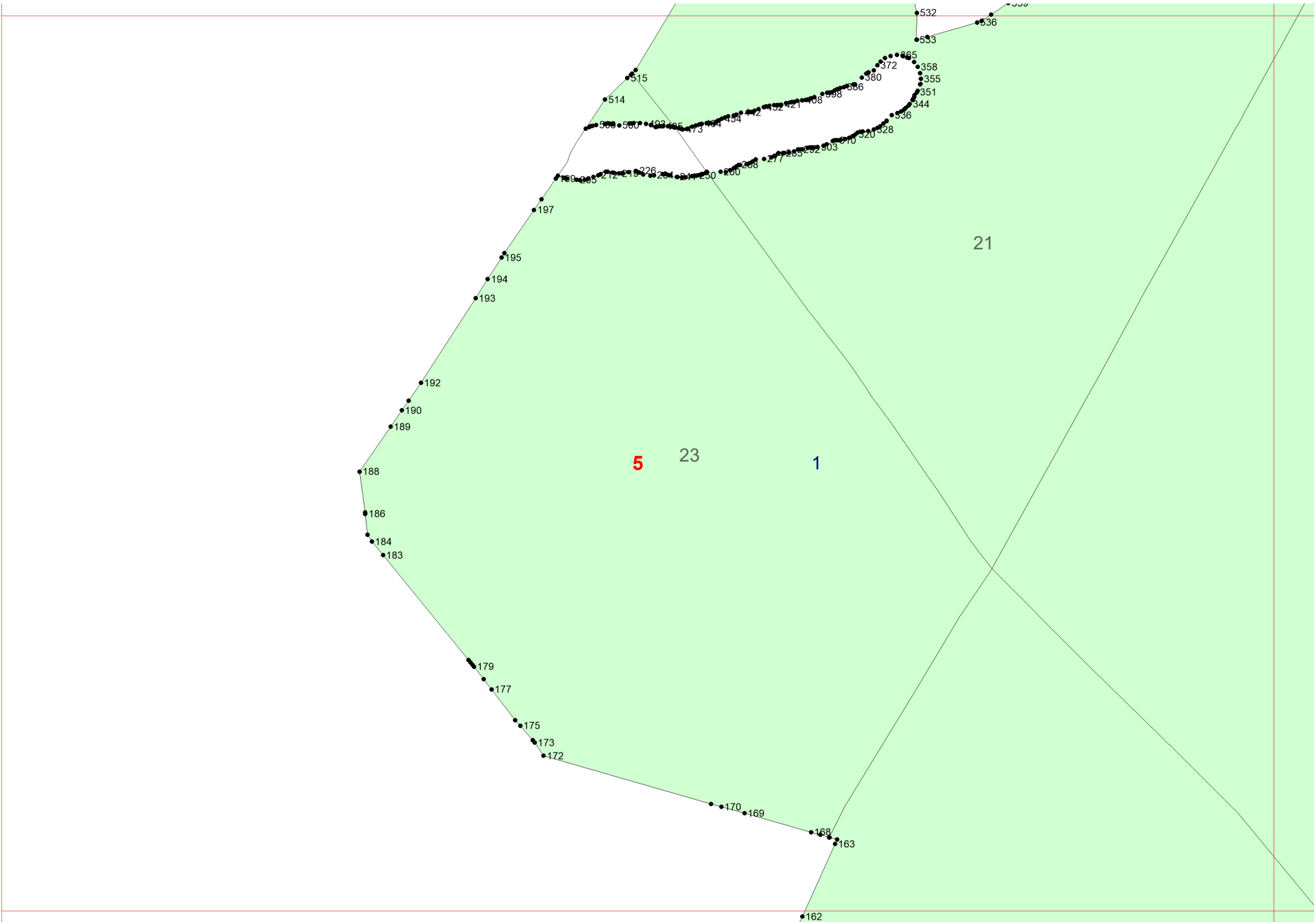

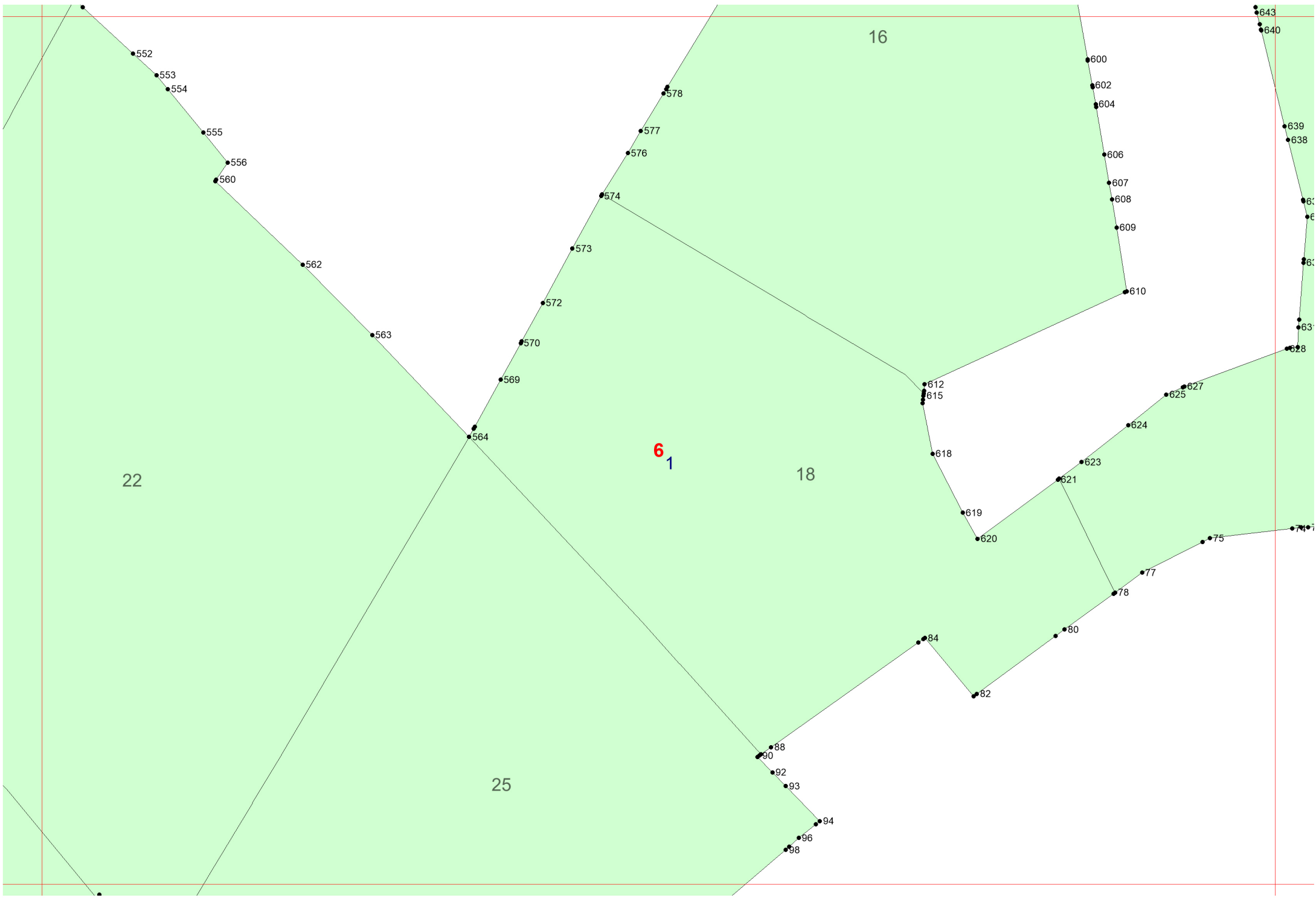

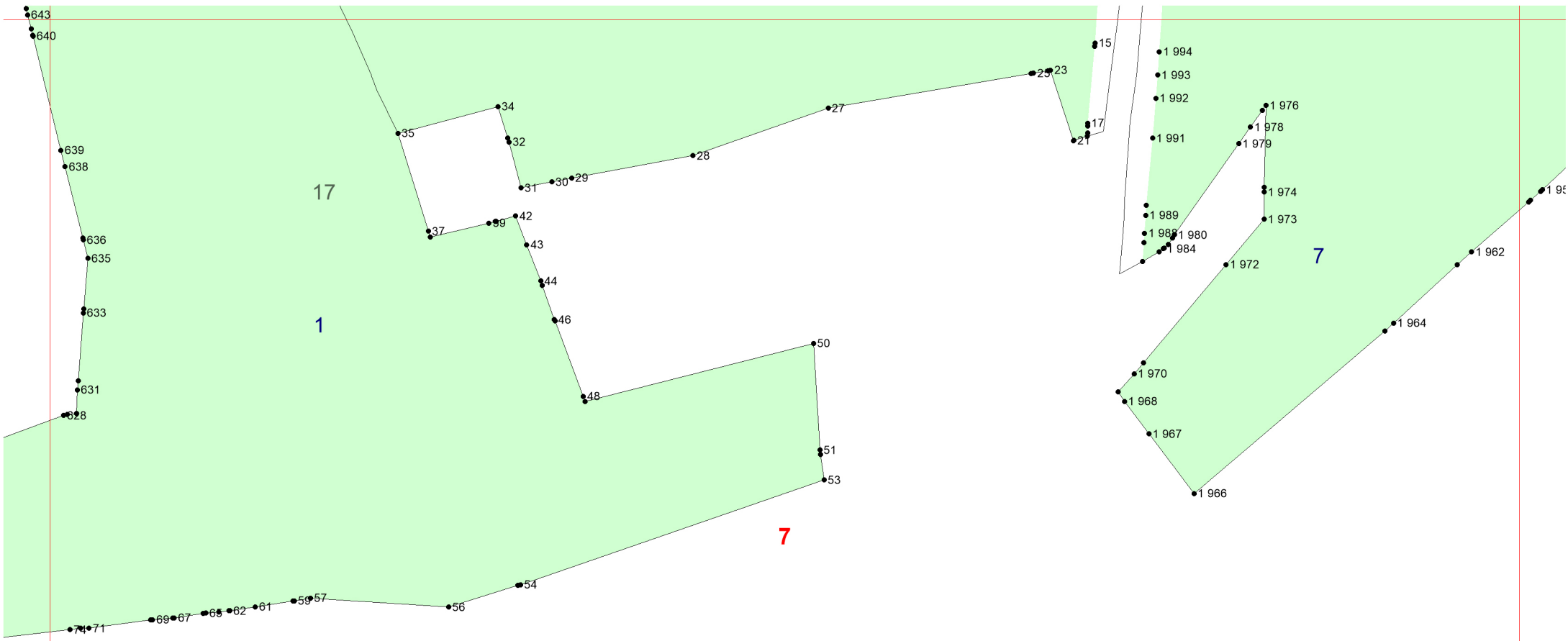

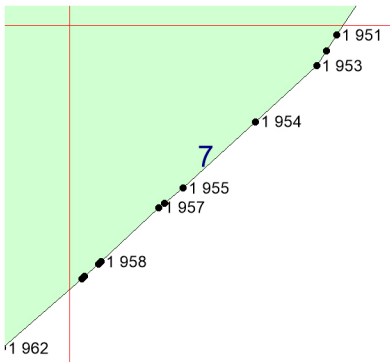

8

9

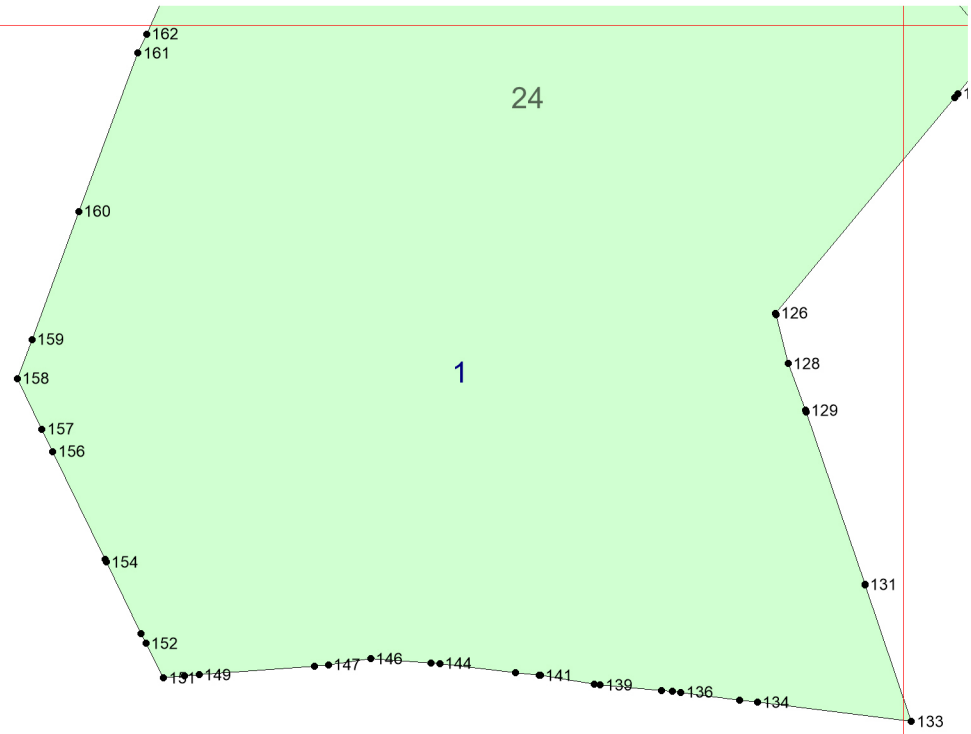

9

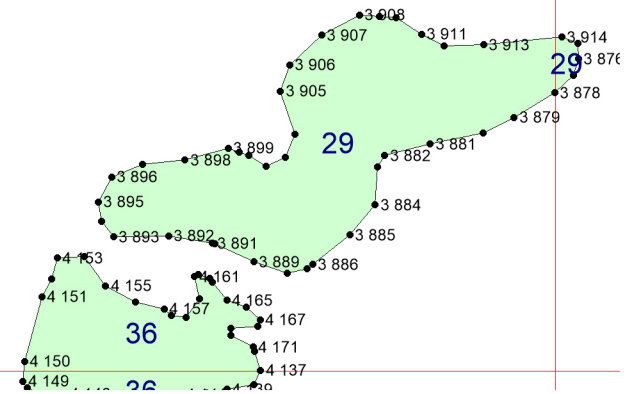

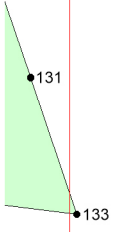
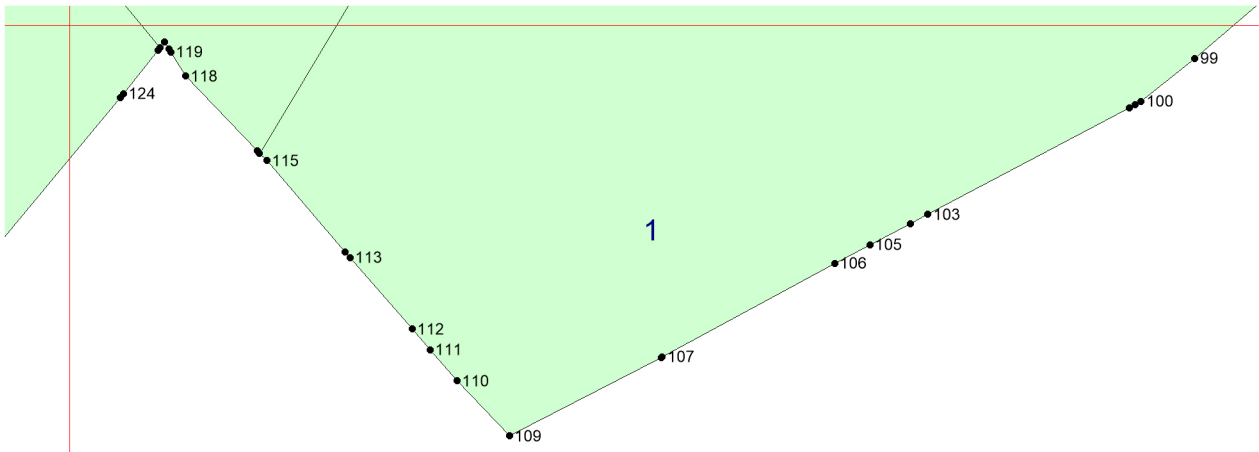

10



11

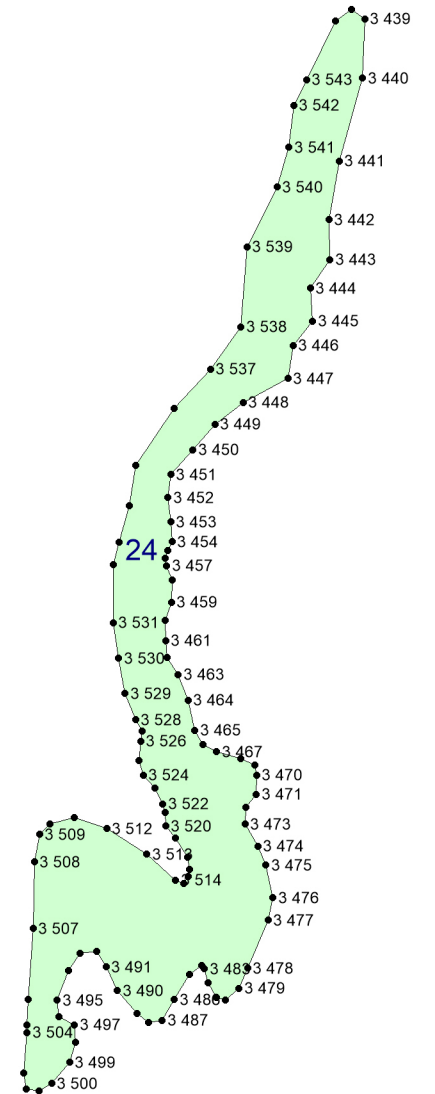

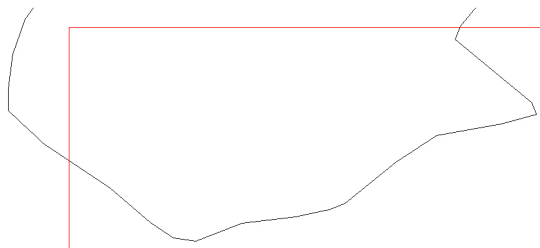

12

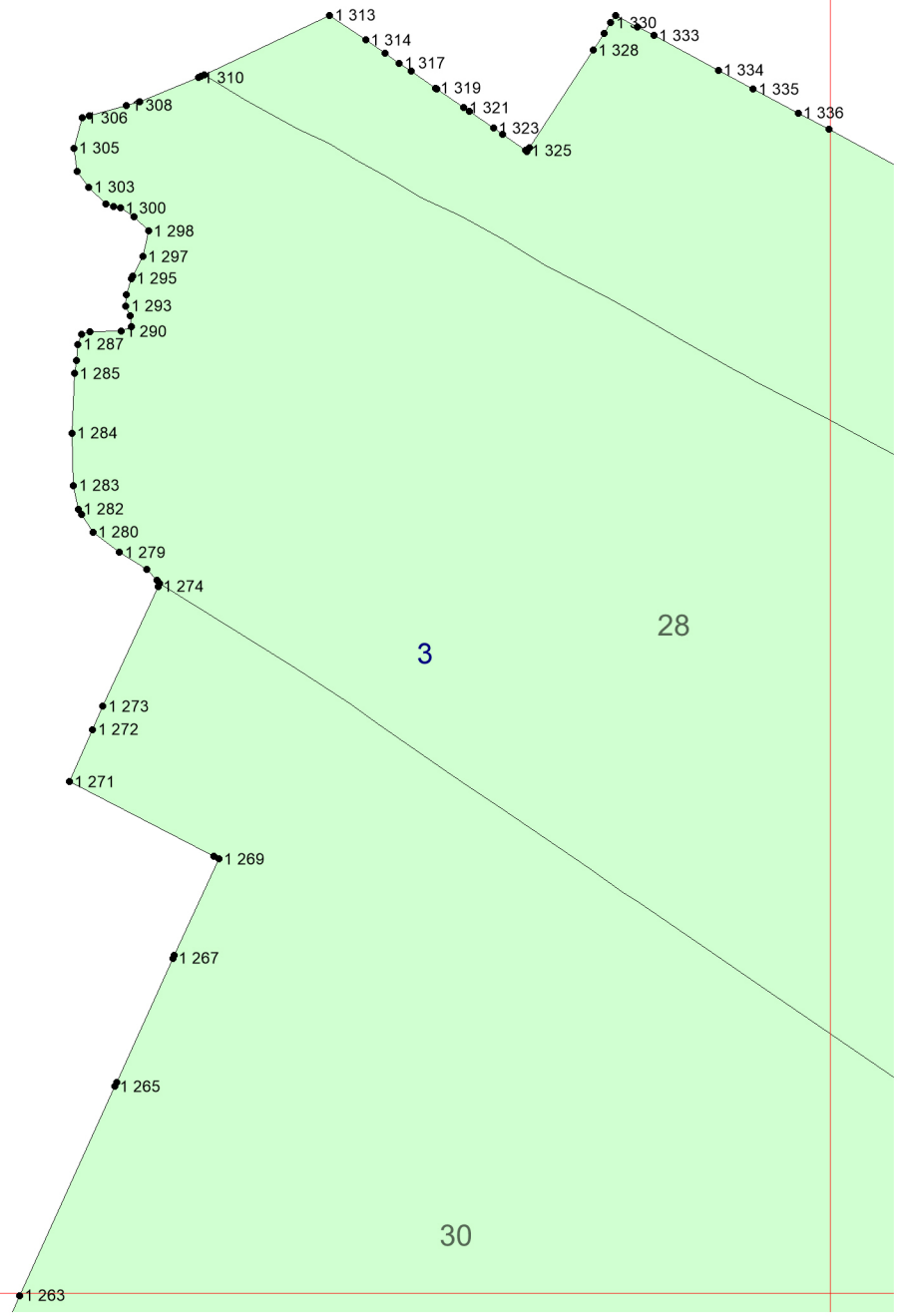

13

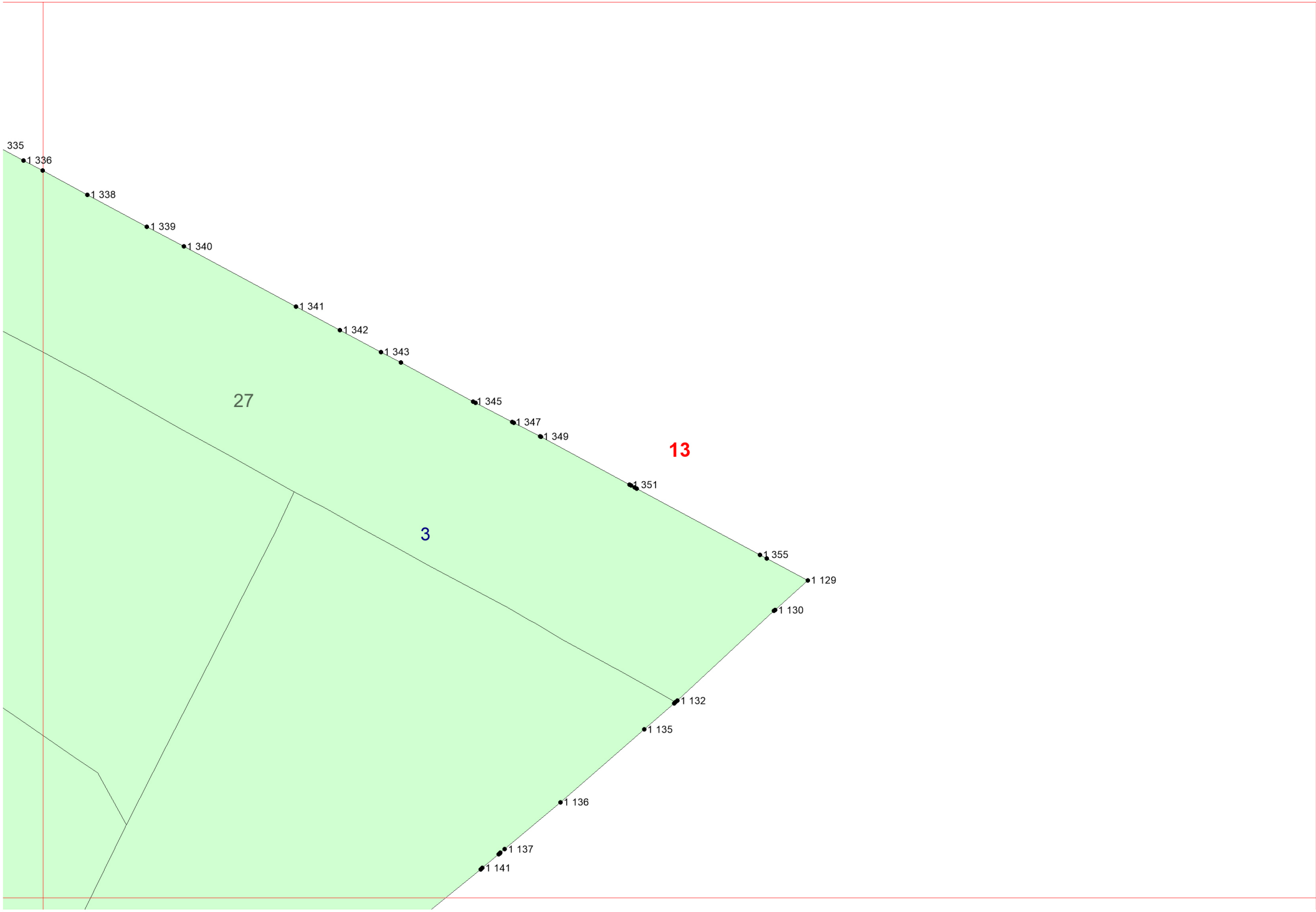

27

3

13

14

335

1 336

1 338

1 339

1 340

1 341

1 342

1 343

1 345

1 347

1 349

1 351

1 355

1 129

1 130

1 132

1 135

1 136

1 137

1 141

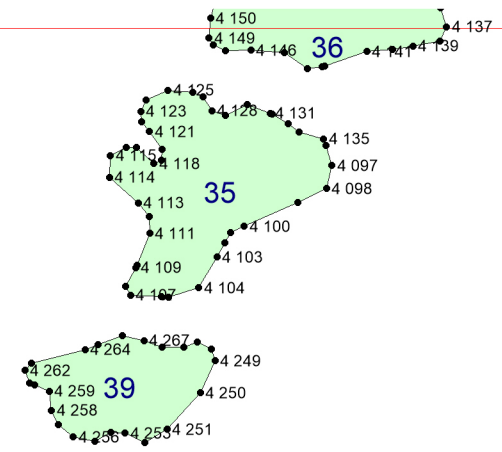

14

15

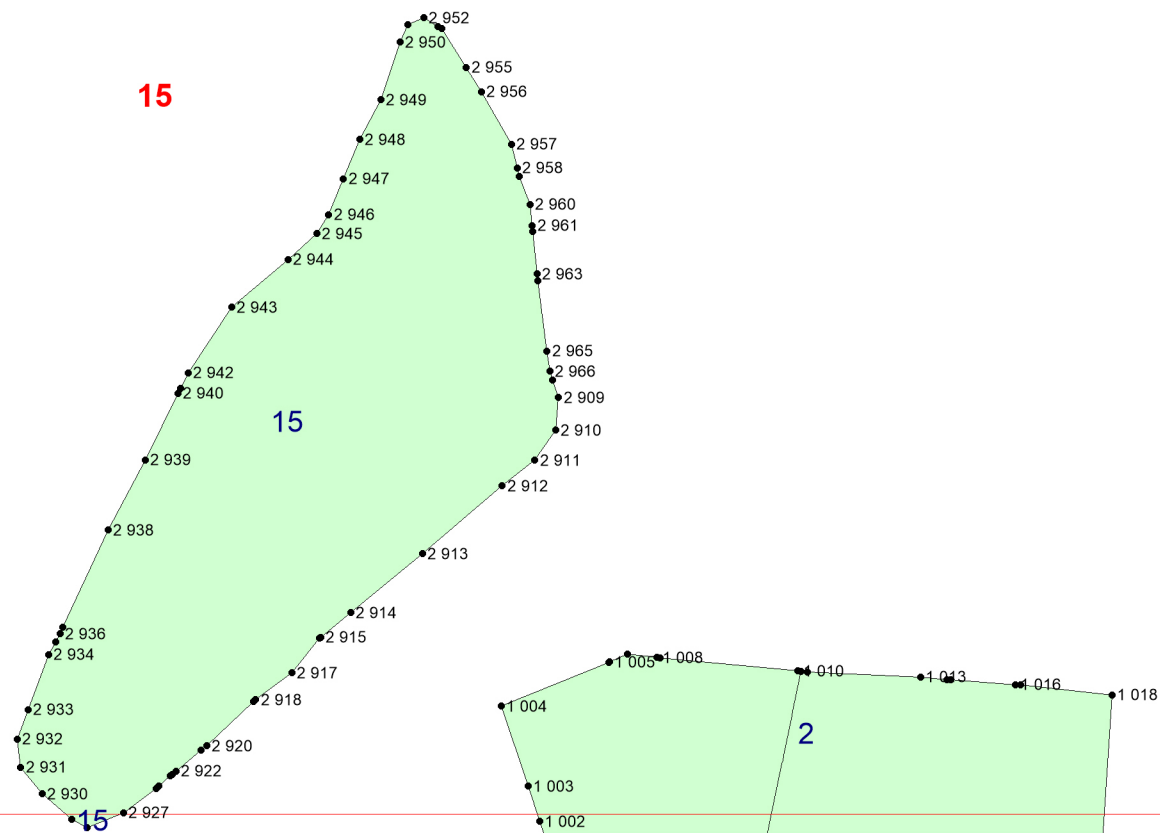

16

16

2

p1 018

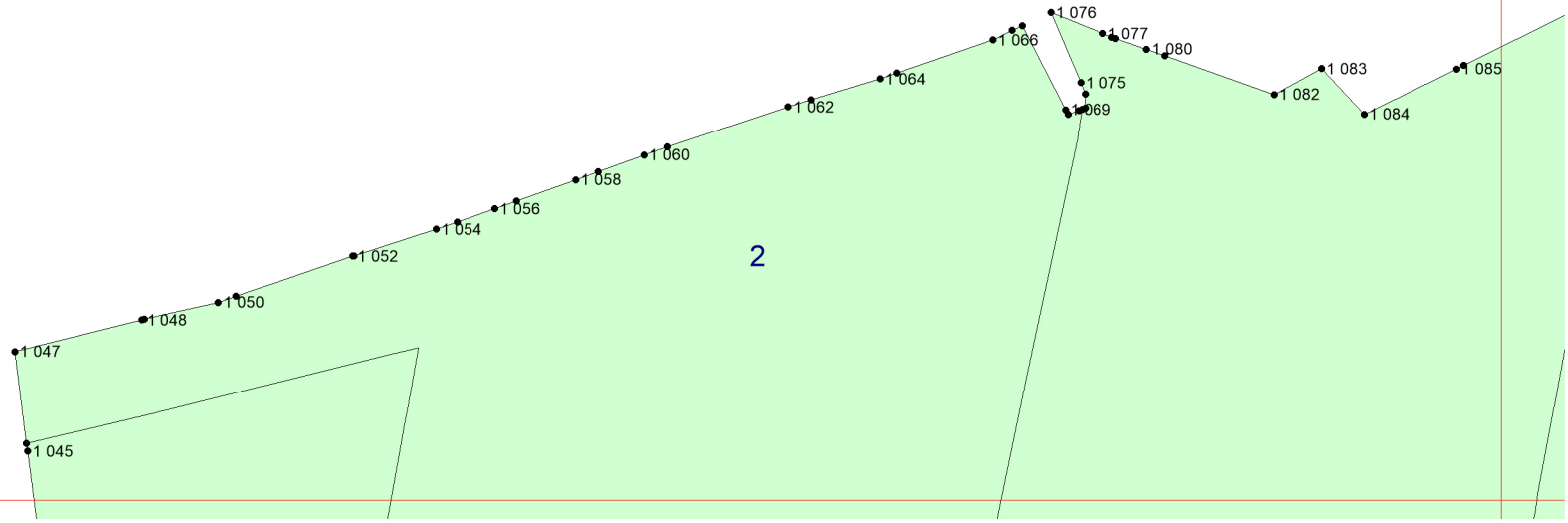

17

17

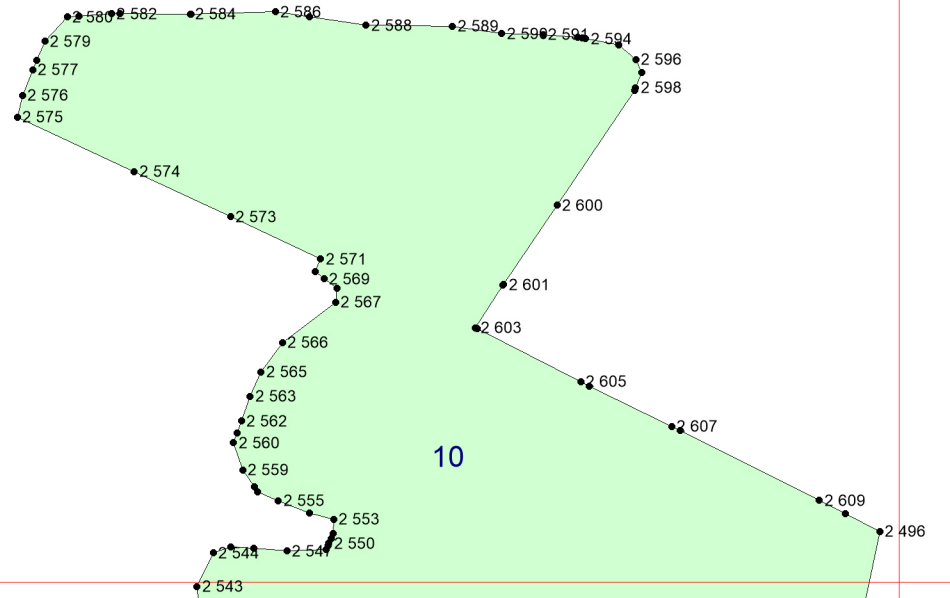
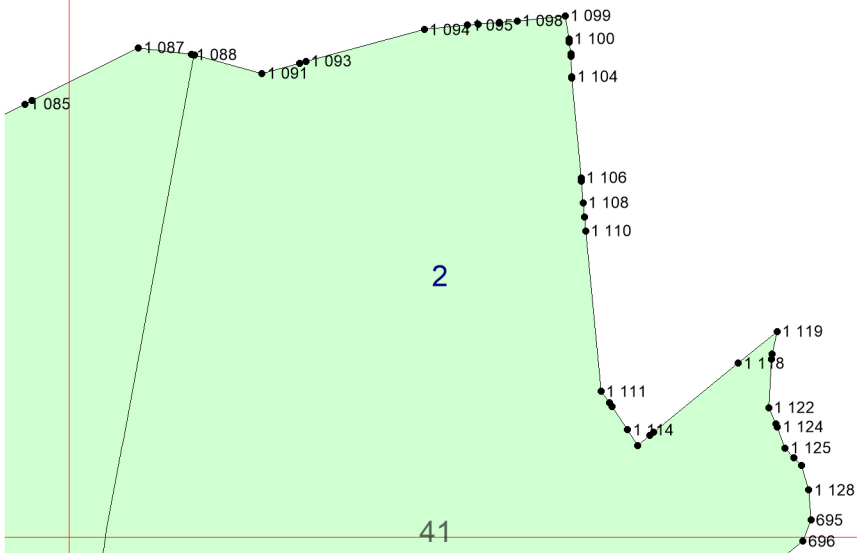

18

20

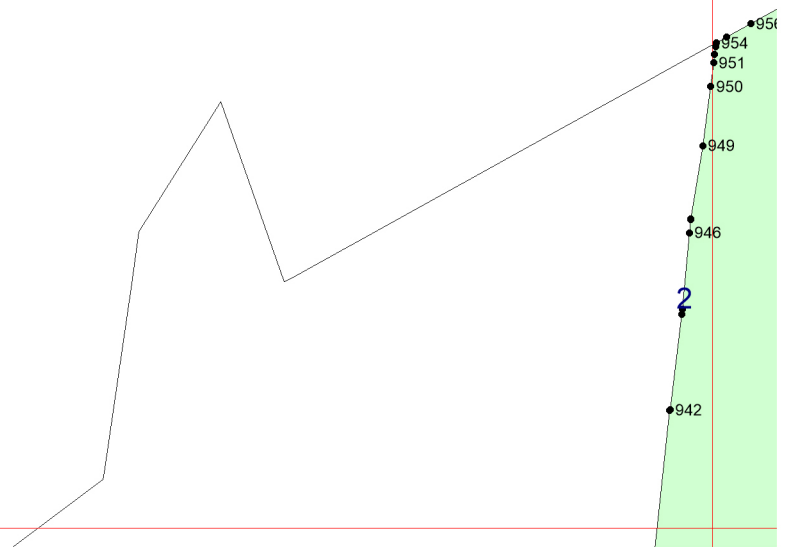

21

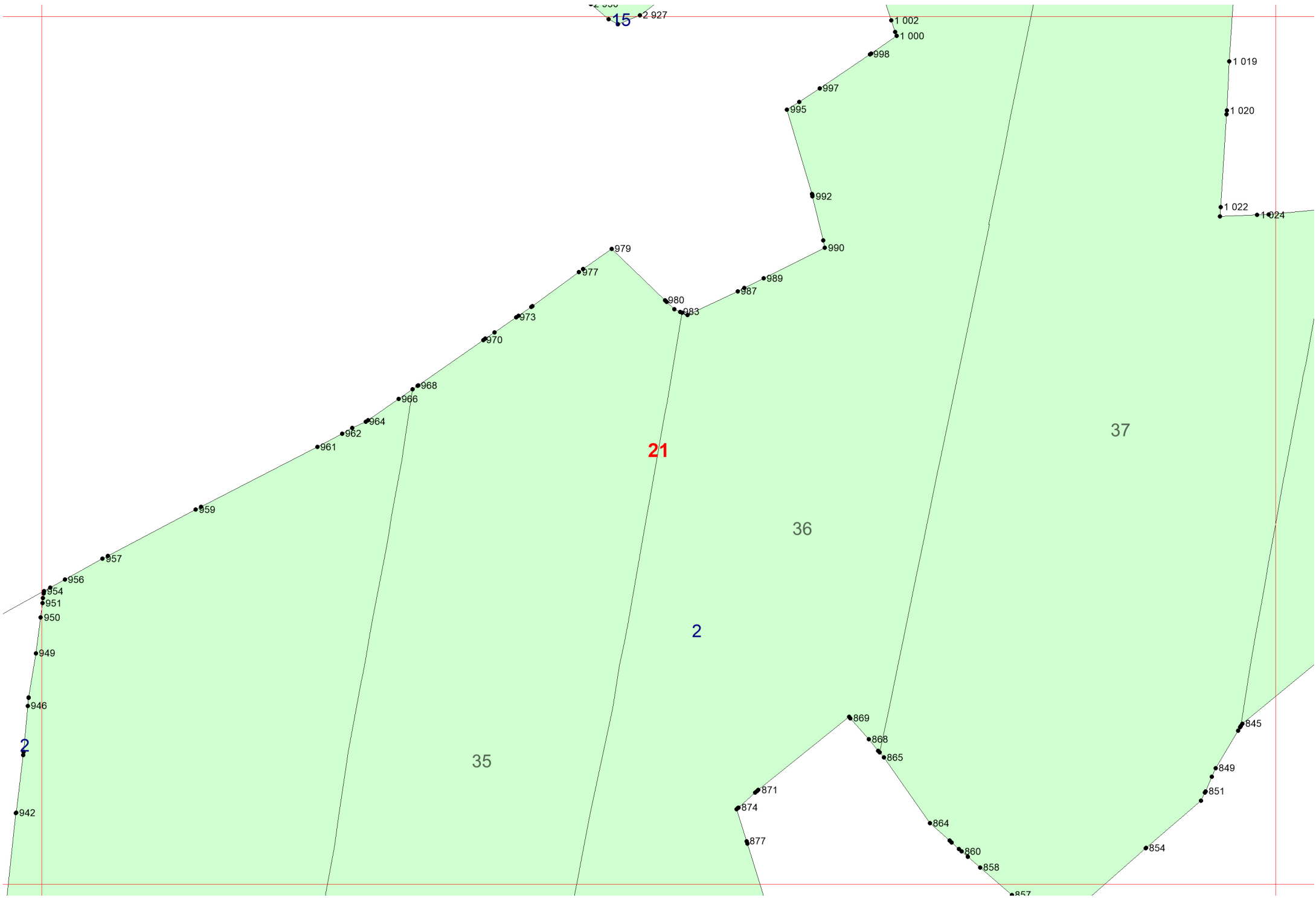

15

2.927

1002

1000

998

997

995

1019

1020

1022

1024

979

977

980

983

987

989

990

973

970

968

966

964

962

961

959

957

956

954

951

950

949

946

946

946

946

946

946

946

946

946

946

946

946

946

946

946

946

946

946

946

946

946

946

946

946

946

946

946

946

946

946

946

946

946

946

946

946

946

946

946

946

946

946

946

946

946

946

946

946

946

946

946

946

946

946

946

946

946

946

946

946

946

946

946

946

946

946

946

946

946

946

946

946

946

946

946

946

946

946

946

946

946

946

946

946

946

946

946

946

946

946

946

946

946

946

946

946

946

946

946

946

946

946

946

946

946

946

946

946

946

946

946

946

946

946

946

946

946

946

946

946

946

946

946

946

946

946

946

946

946

946

946

946

946

946

946

946

946

946

946

946

946

946

946

946

946

946

946

946

946

946

946

946

946

946

946

946

946

946

946

946

946

946

946

946

946

946

946

946

946

946

946

946

946

946

946

946

946

946

946

946

946

946

946

946

946

946

946

946

946

946

946

946

946

946

946

946

946

946

946

946

946

946

946

946

946

946

946

946

946

946

946

946

946

946

946

946

946

946

946

946

946

946

946

946

946

946

946

946

946

946

946

946

946

946

946

946

946

946

946

946

946

946

946

946

946

946

946

946

946

946

946

946

946

946

946

946

946

946

946

946

946

946

946

946

946

946

946

946

946

946

946

946

946

946

946

946

946

946

946

946

946

946

946

946

946

946

946

946

946

946

946

946

946

946

946

946

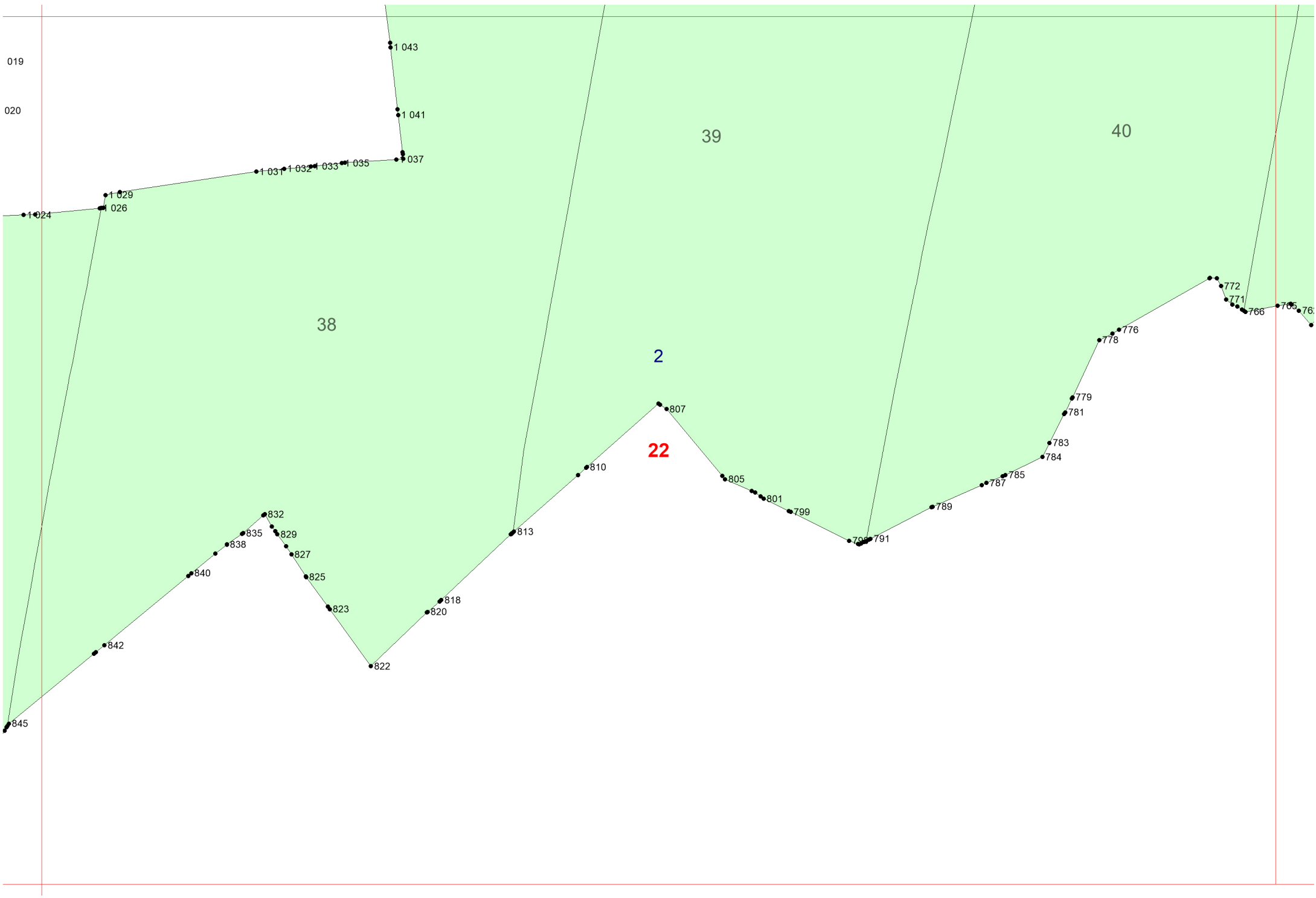

41

2

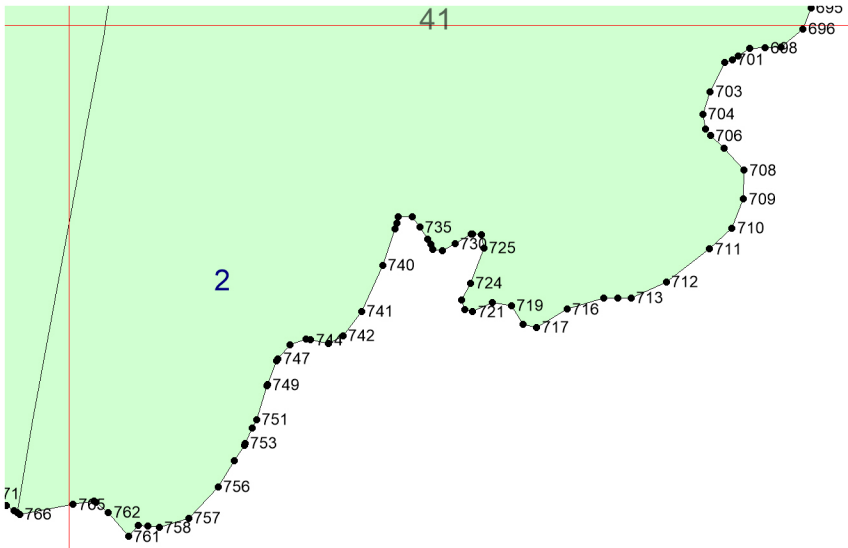

10

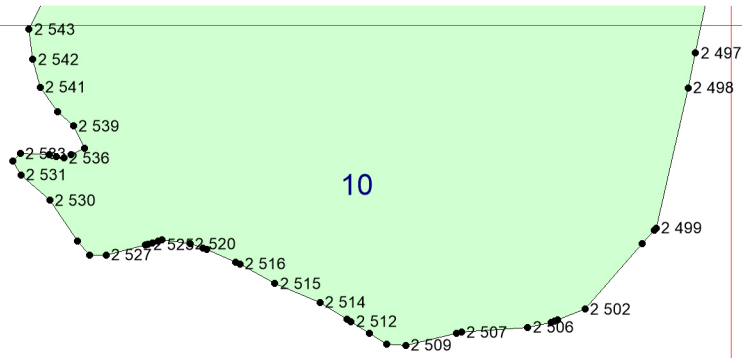

23

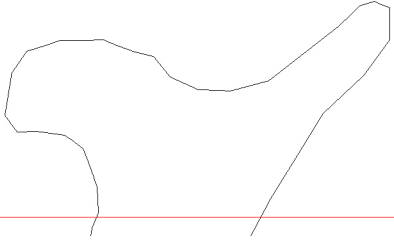

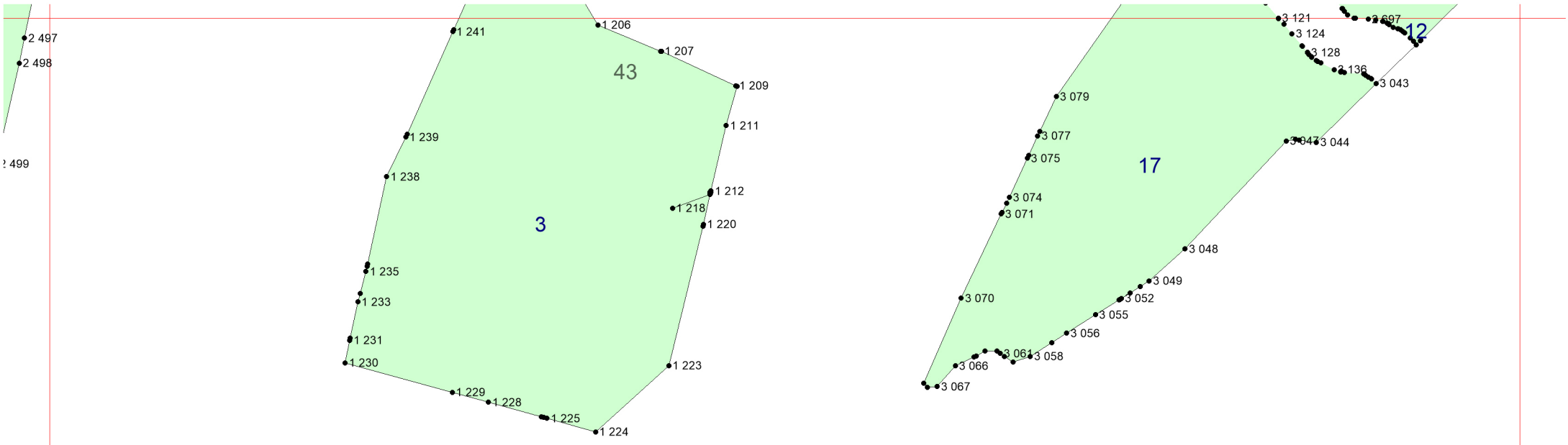

24

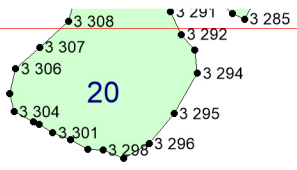

25

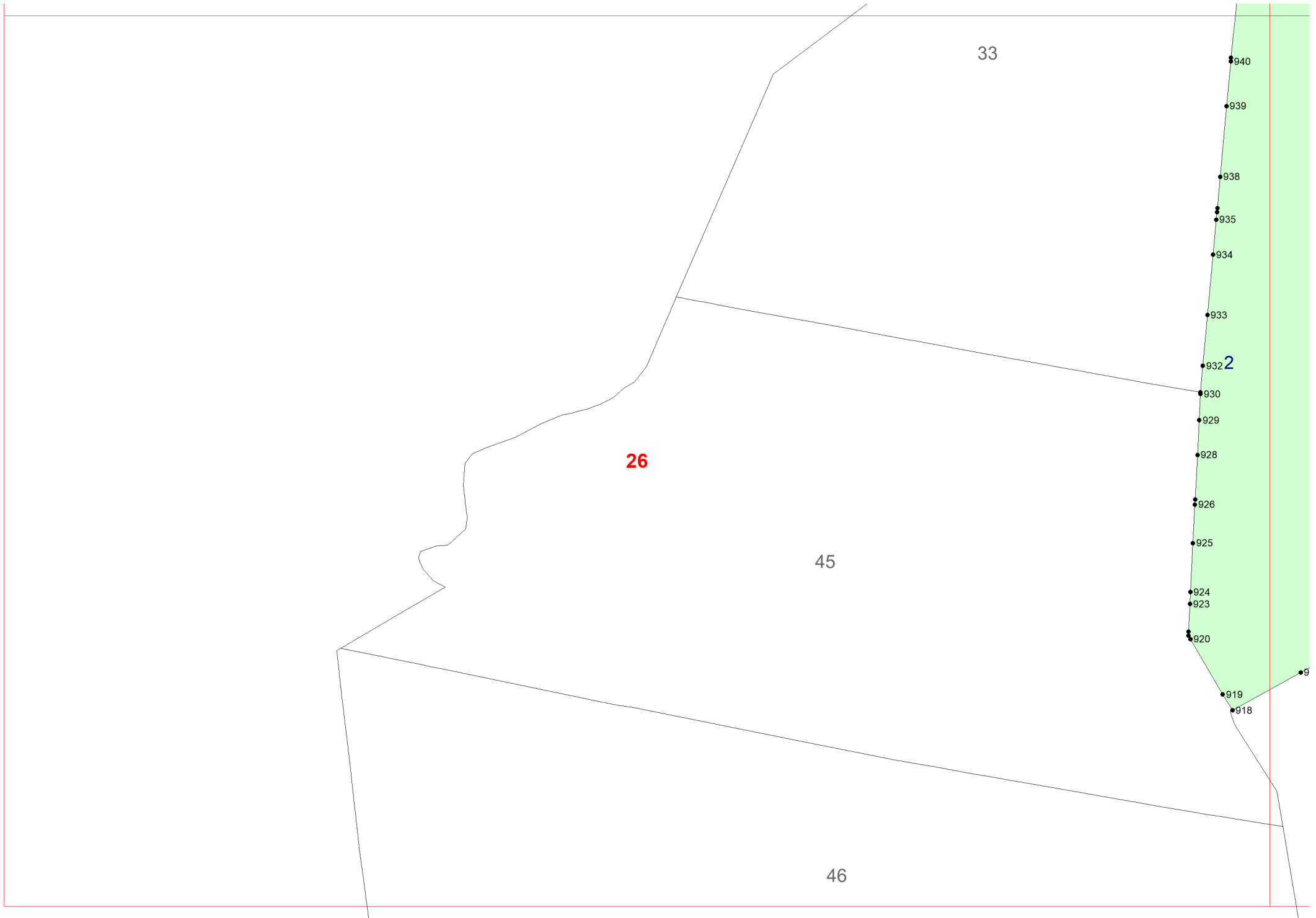

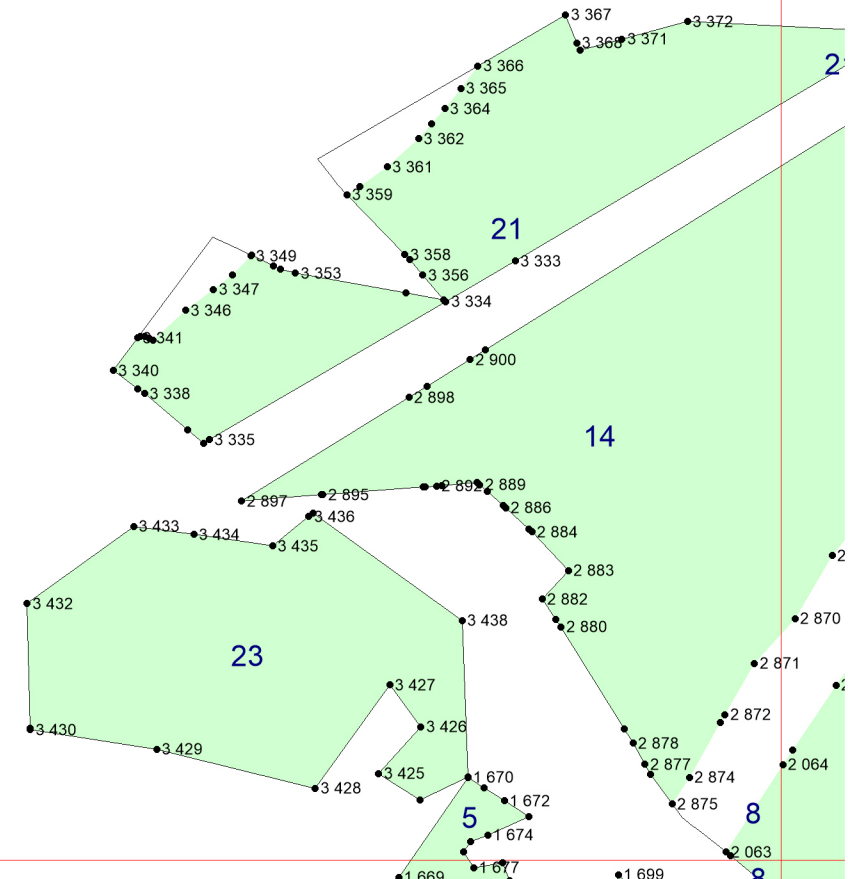
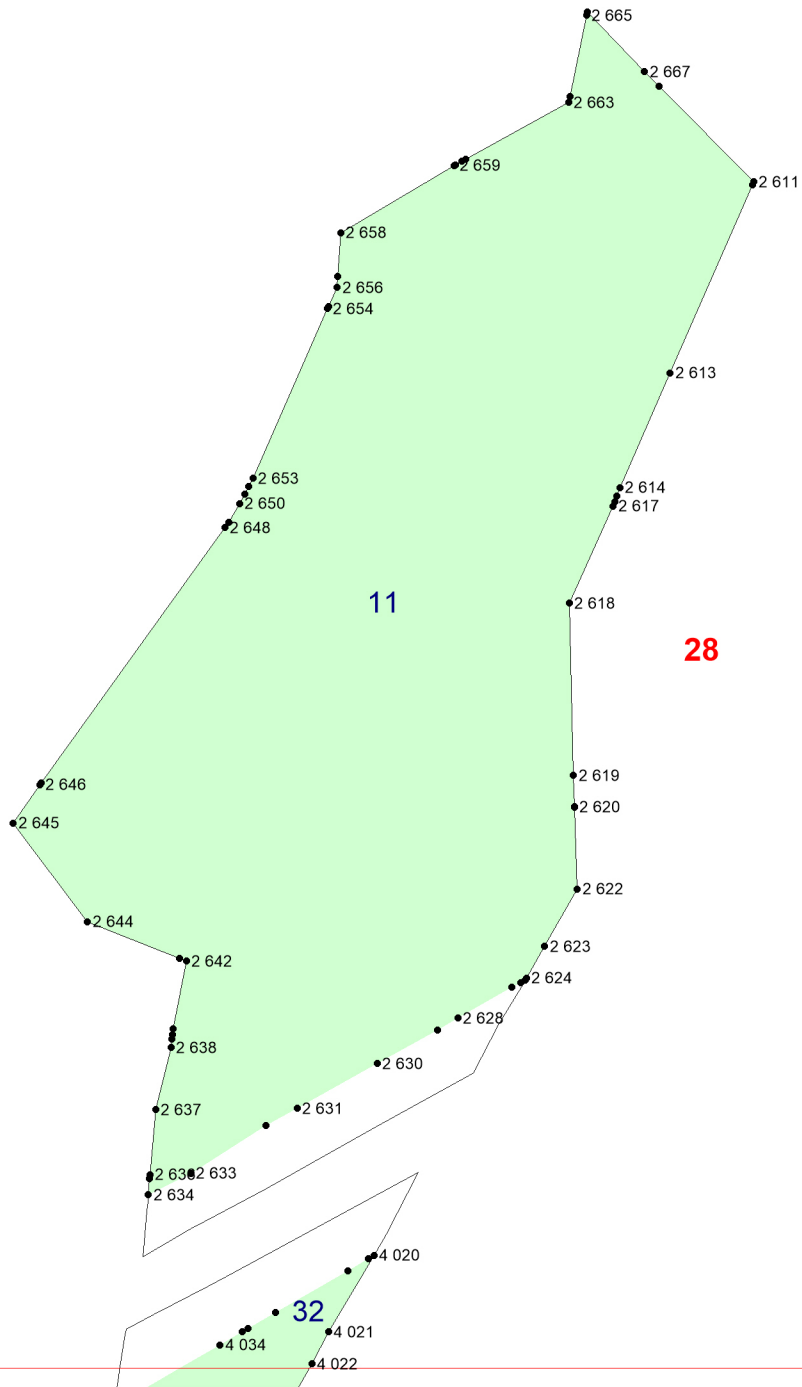

30

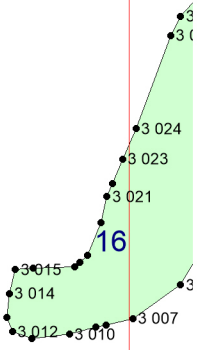
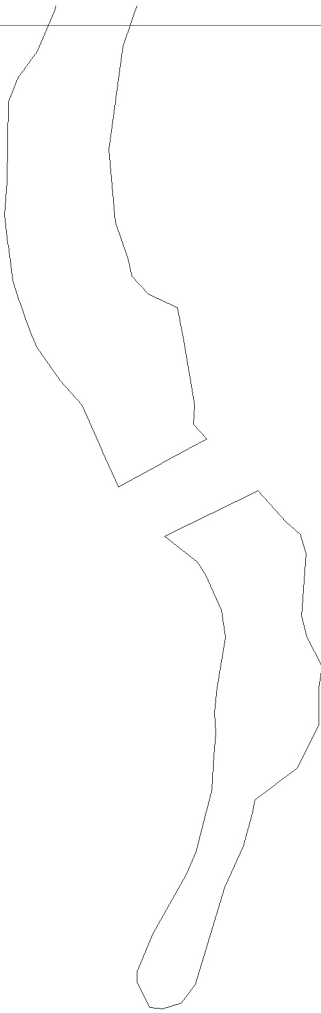

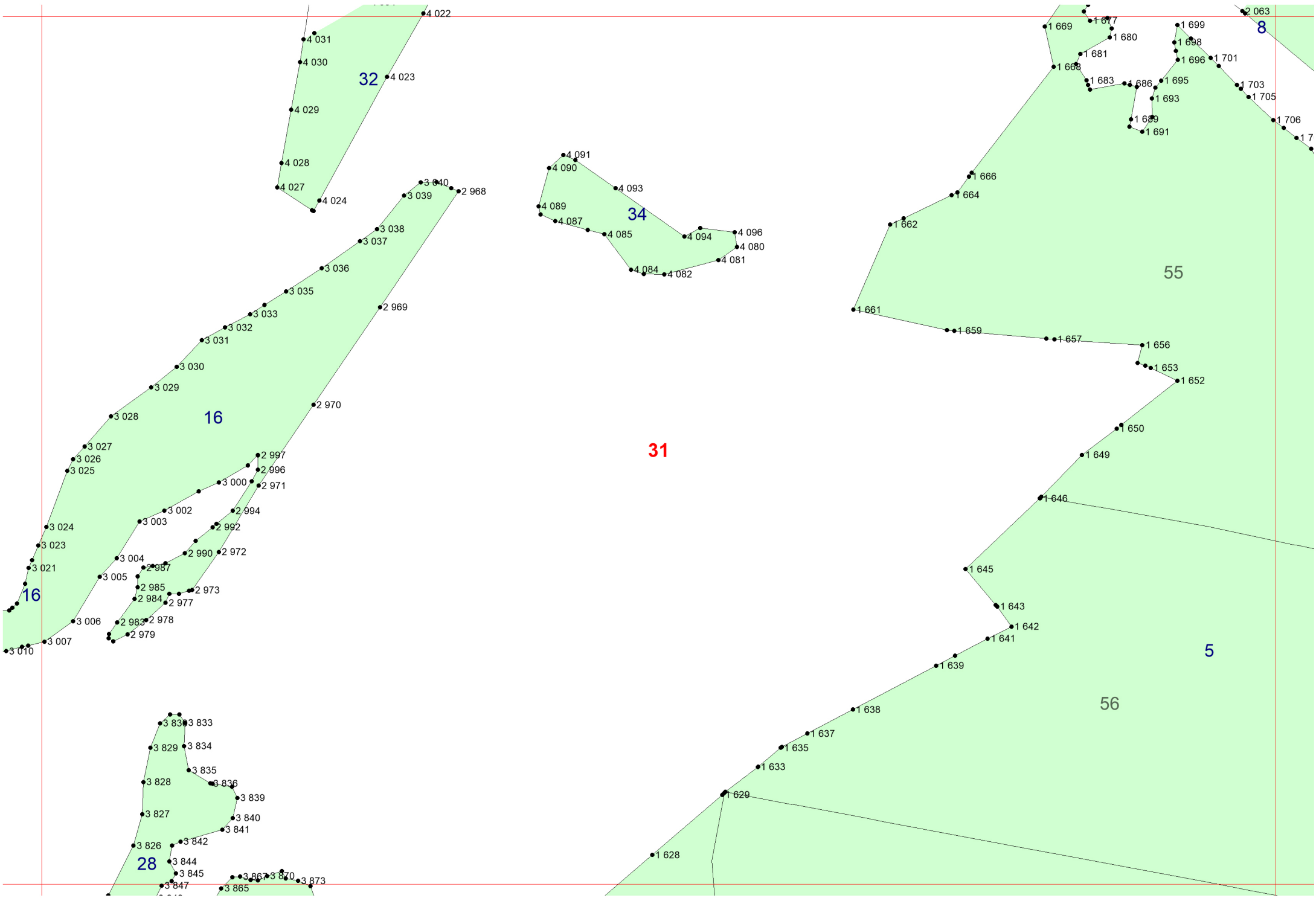

16

16

28

32

34

31

55

5

56

8

32

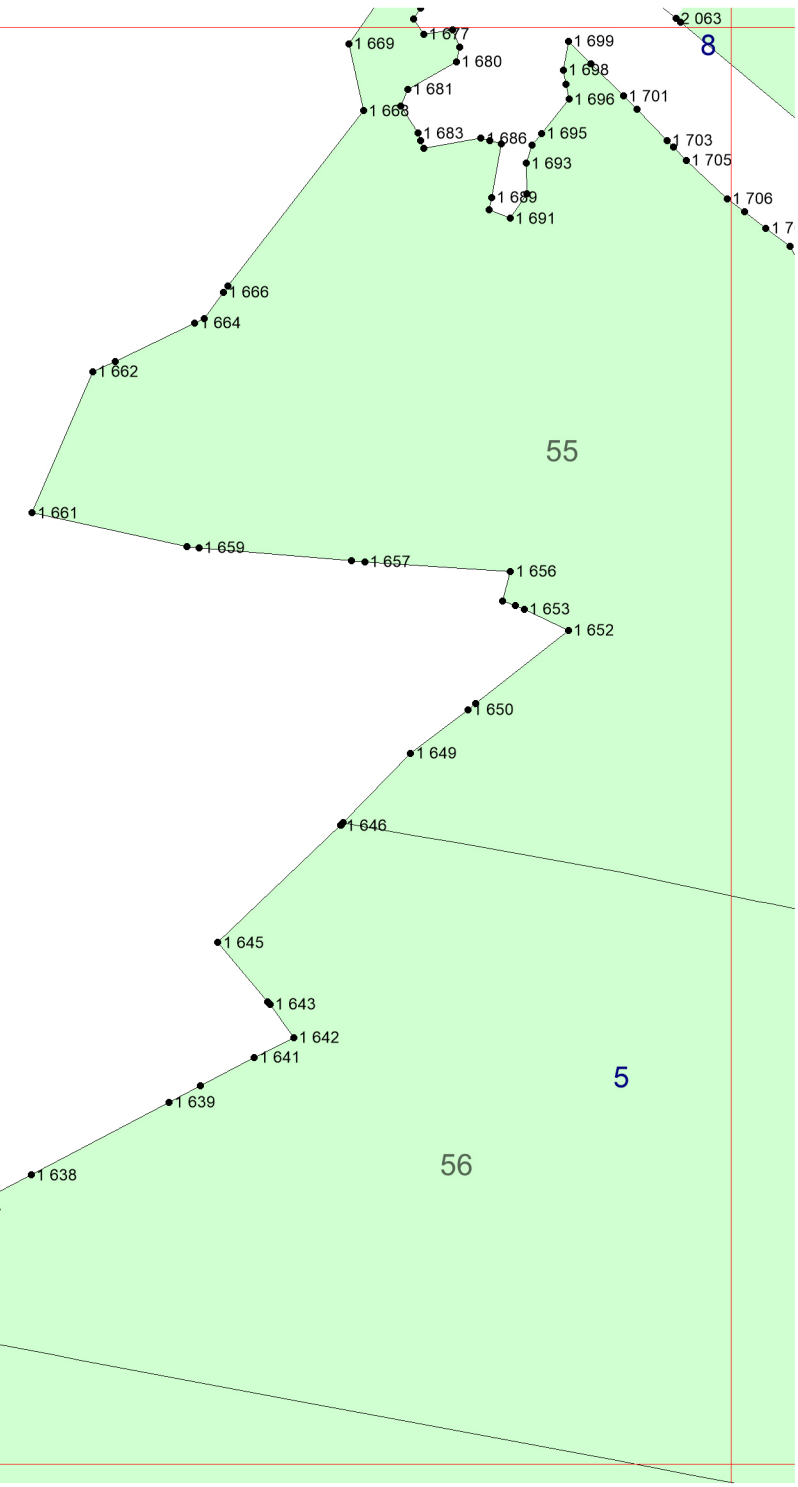
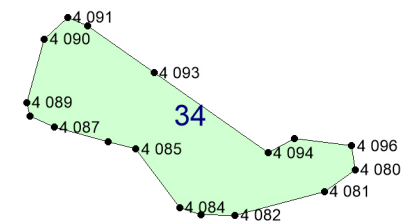
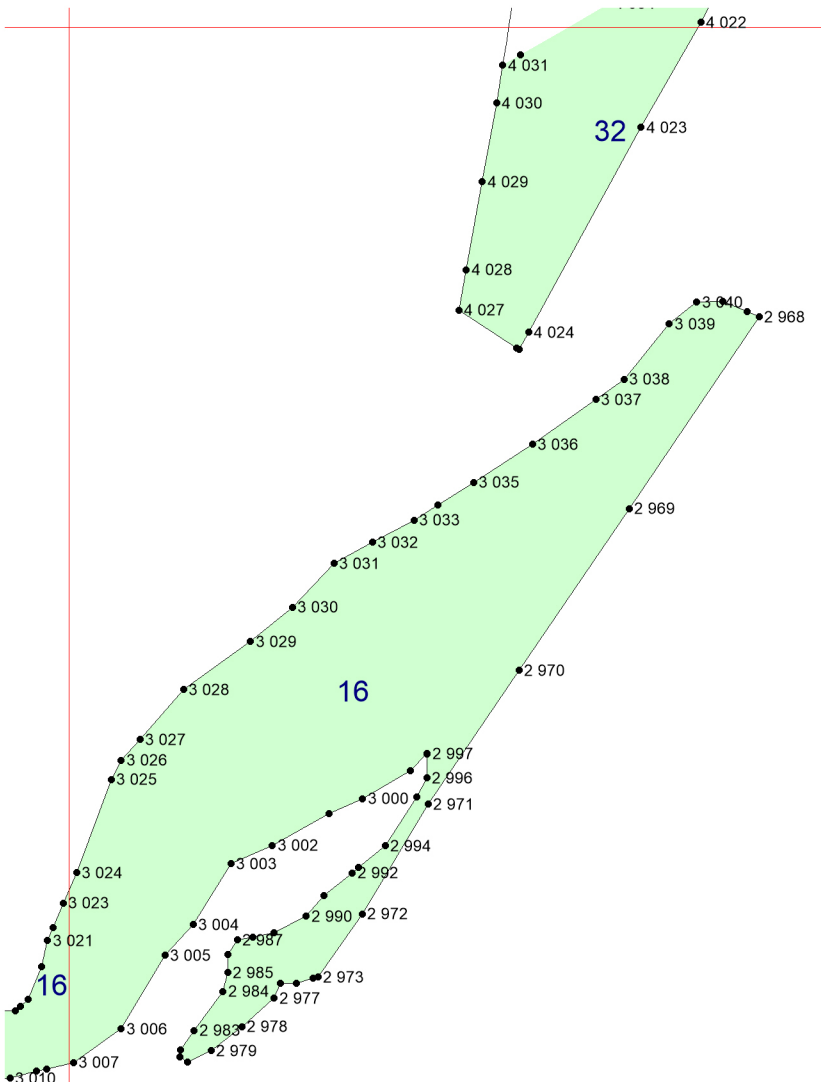

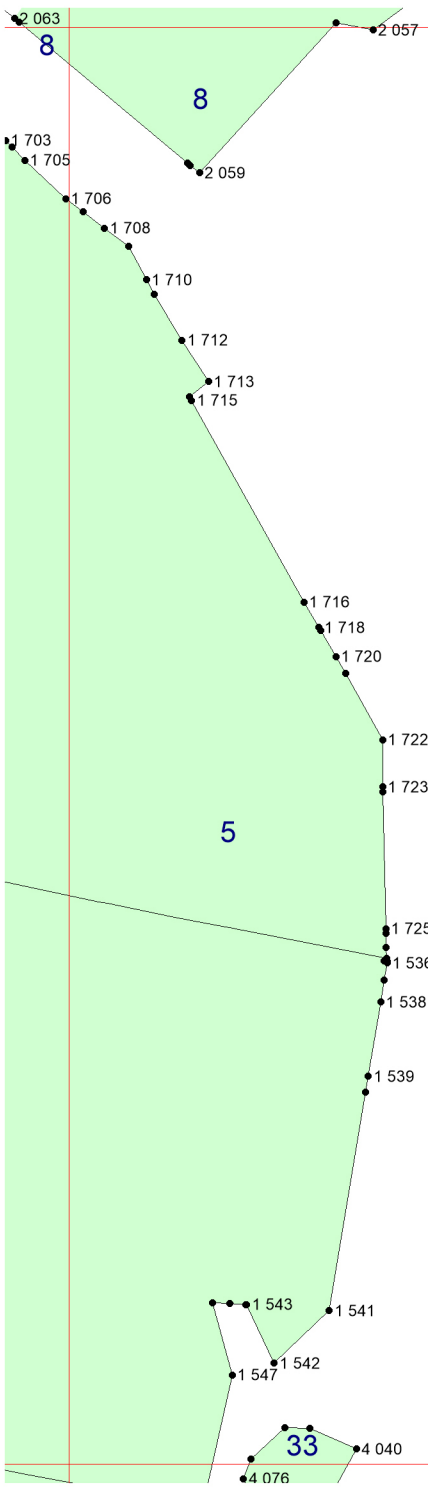

32

33

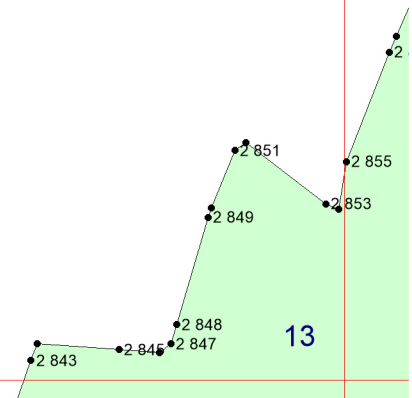

34

48

34

13

13

35

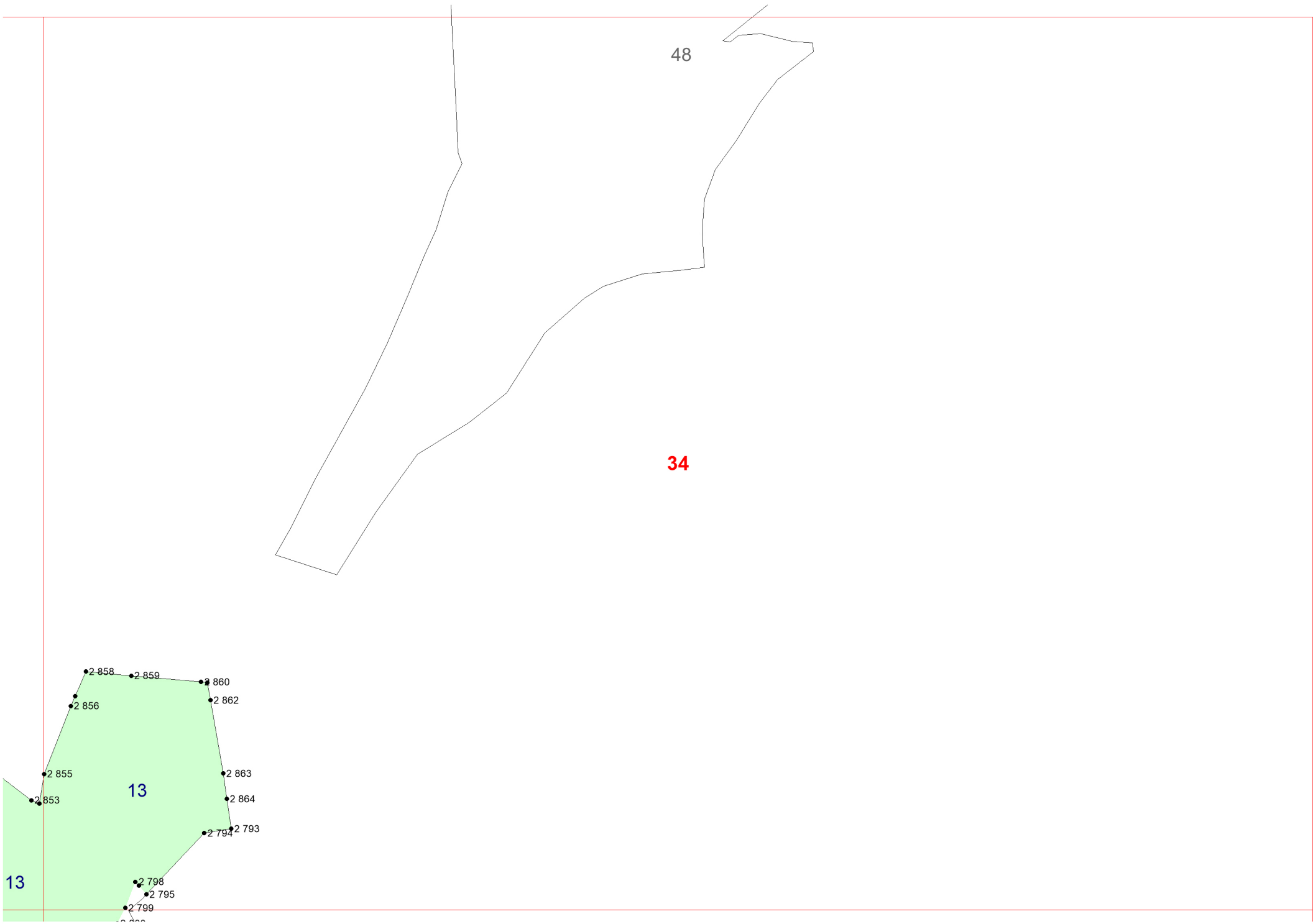

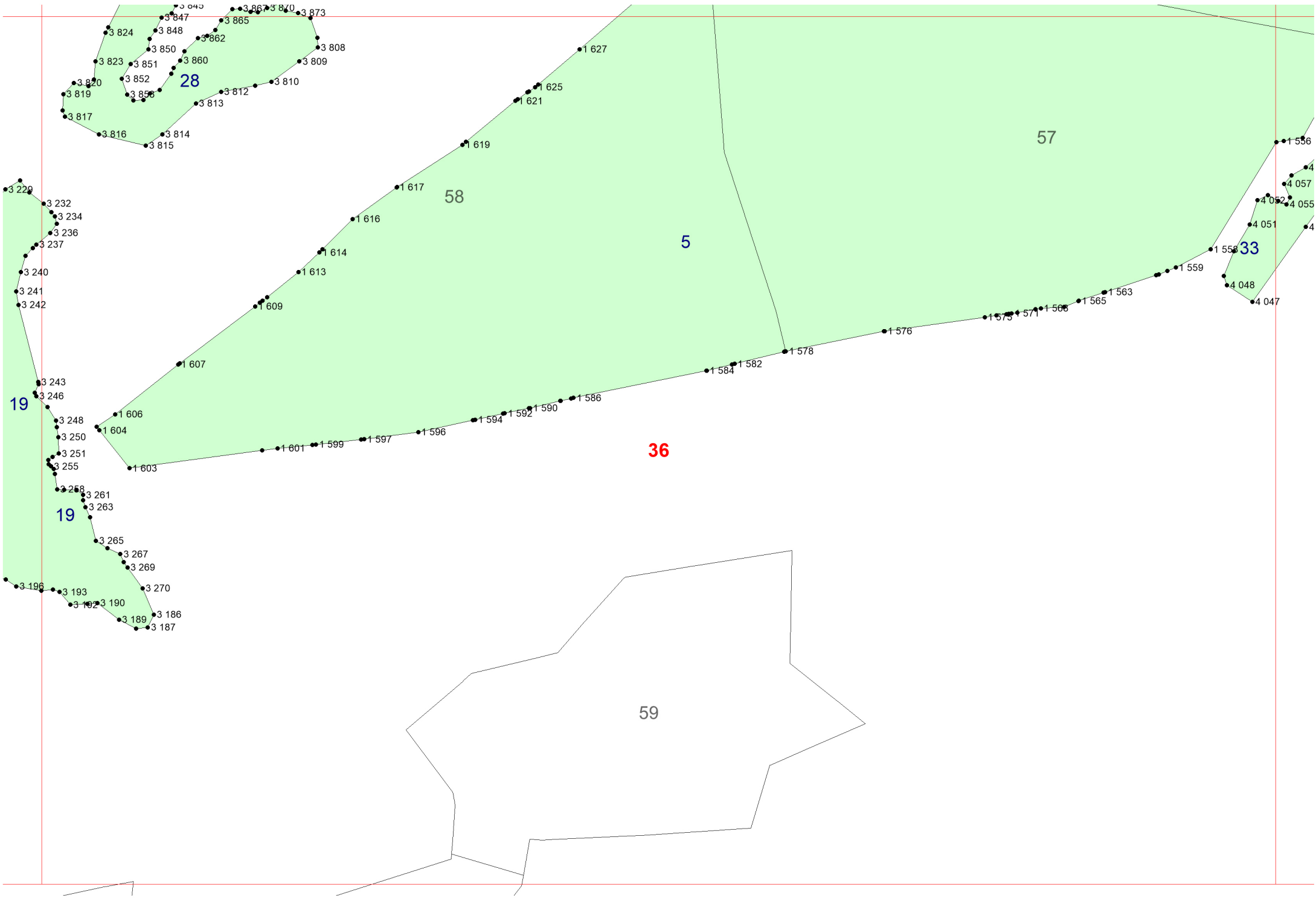

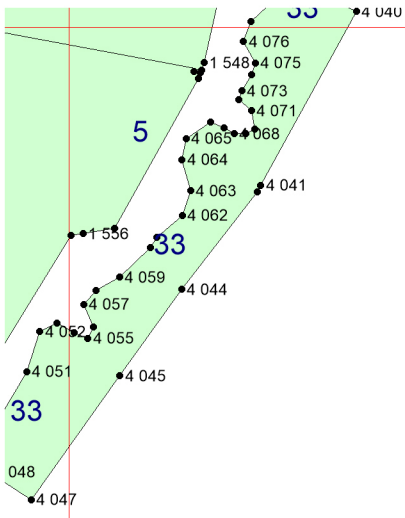

37

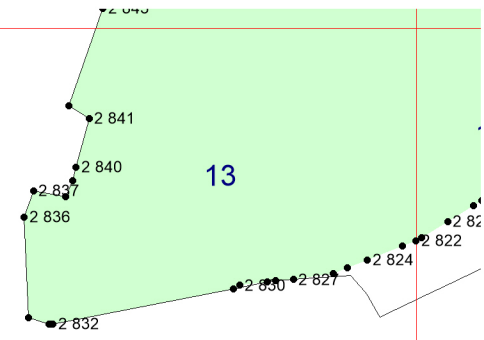

38

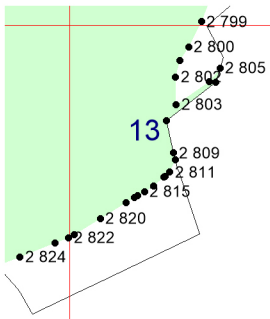

39

40

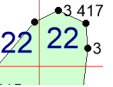
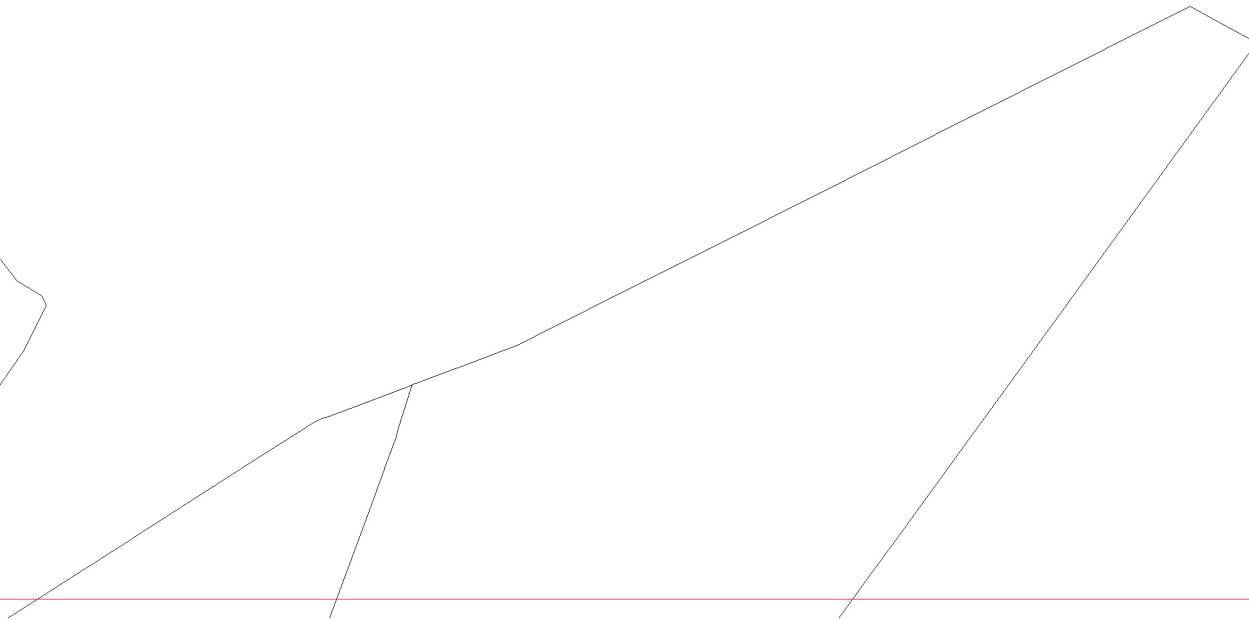
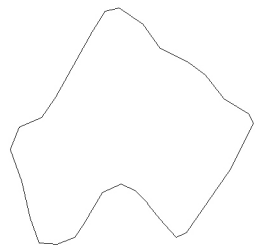

41

41

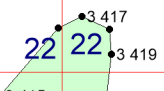

42

42

69

70

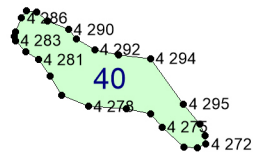

43

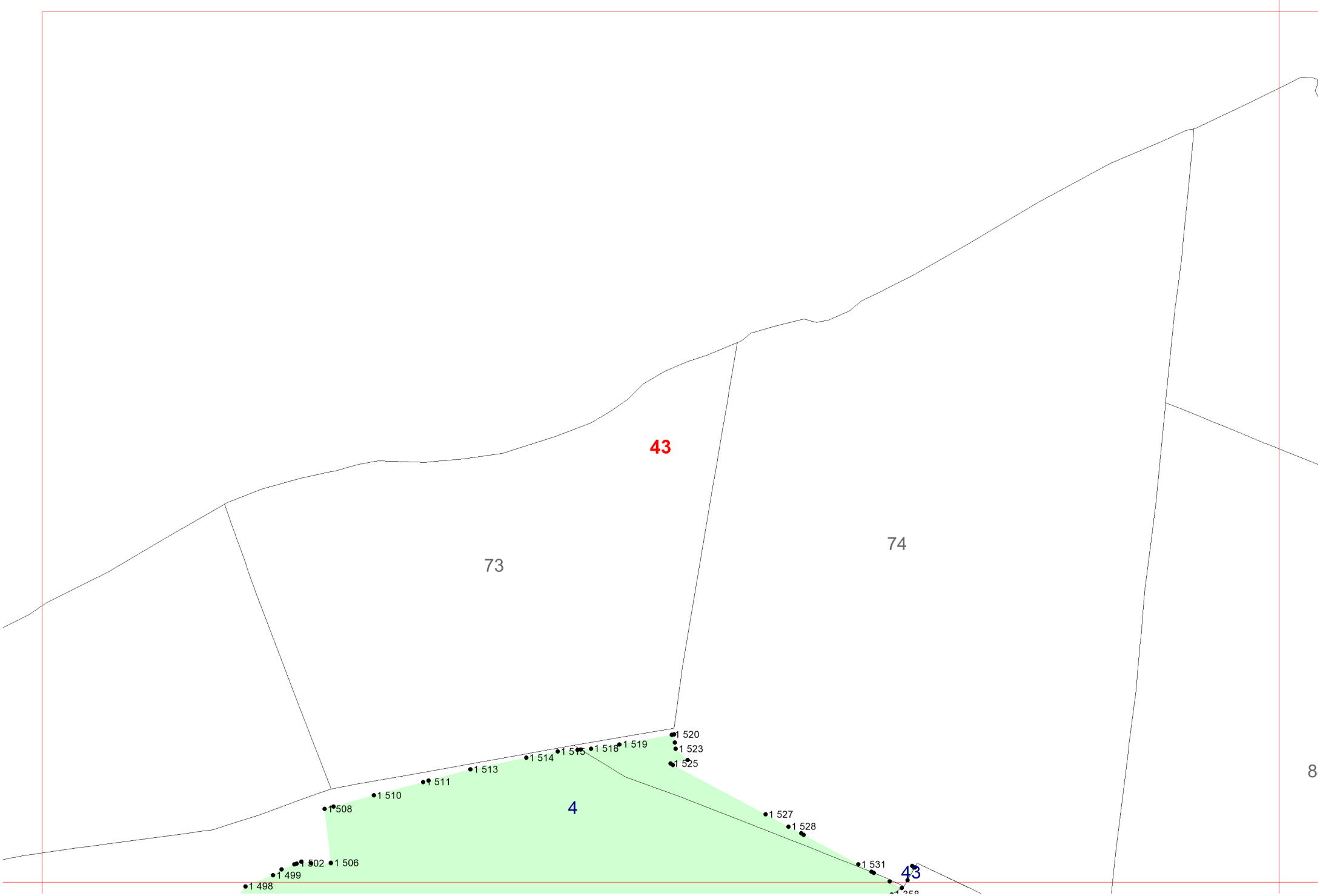

43

73

74

4

43

44

8

1 498

1 499

1 502

1 506

1 508

1 510

1 511

1 513

1 514

1 515

1 518

1 519

1 520

1 523

1 525

1 527

1 528

1 531

1 532

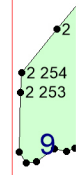
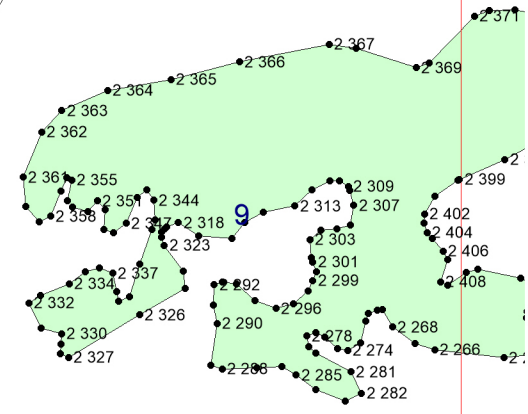
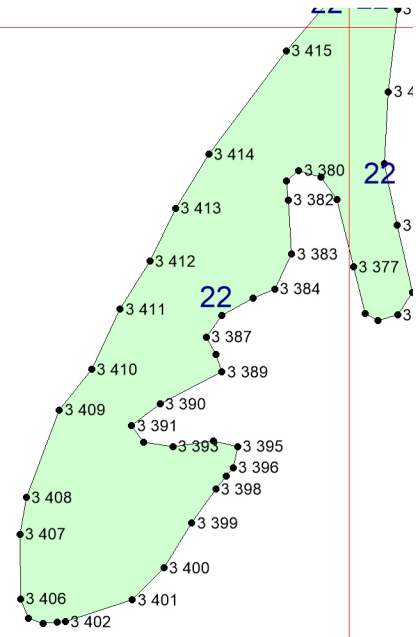
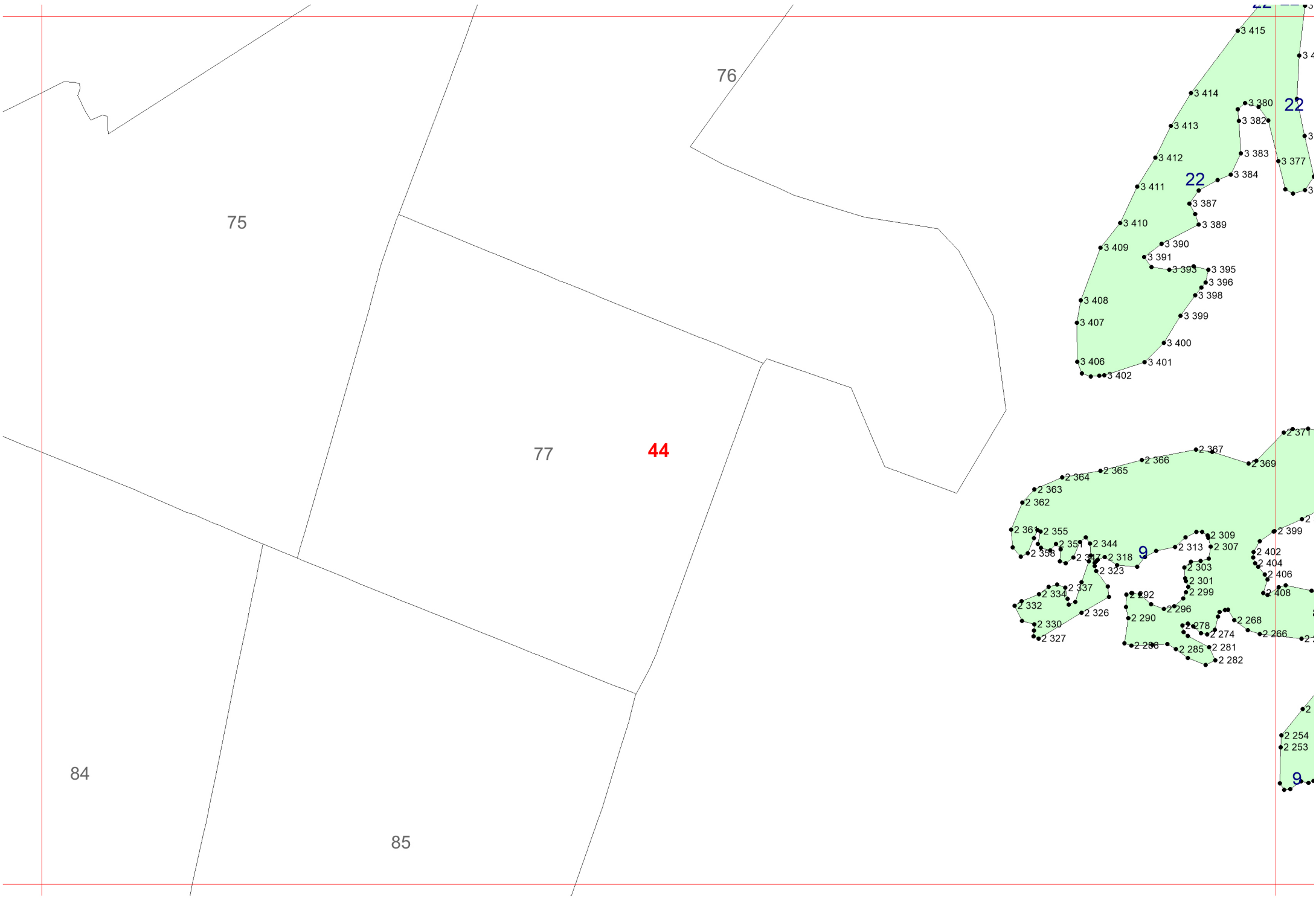

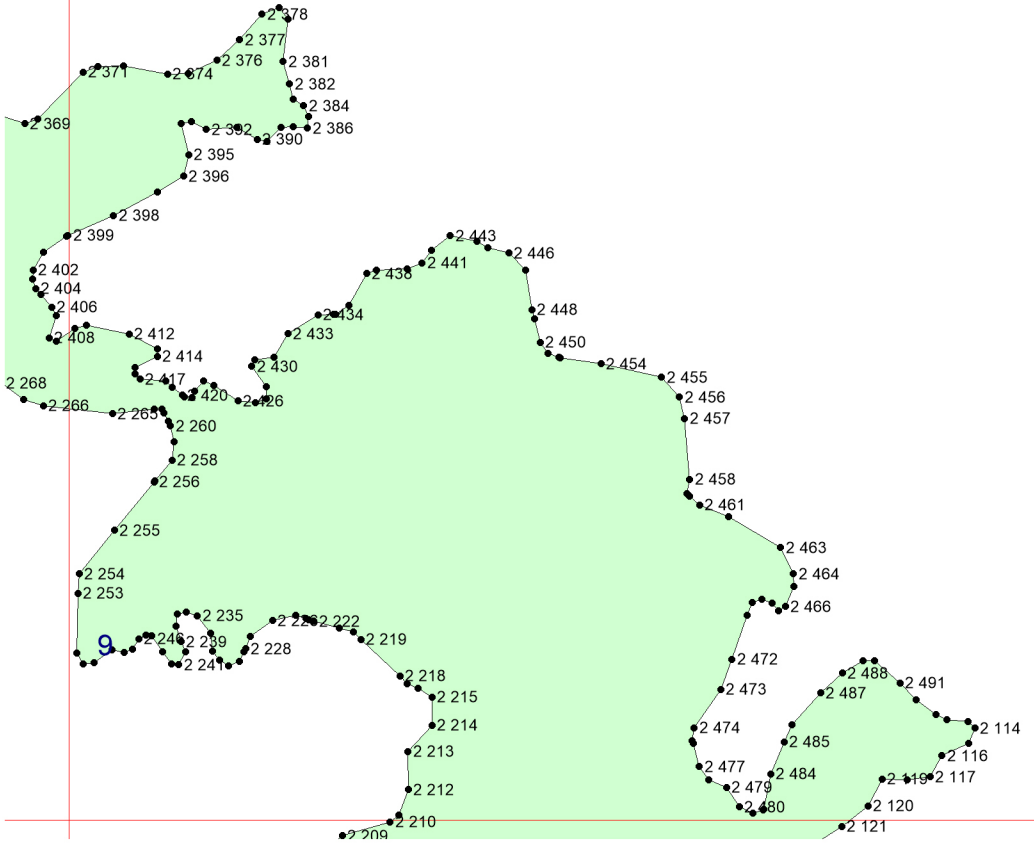
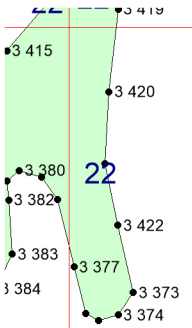

45

46

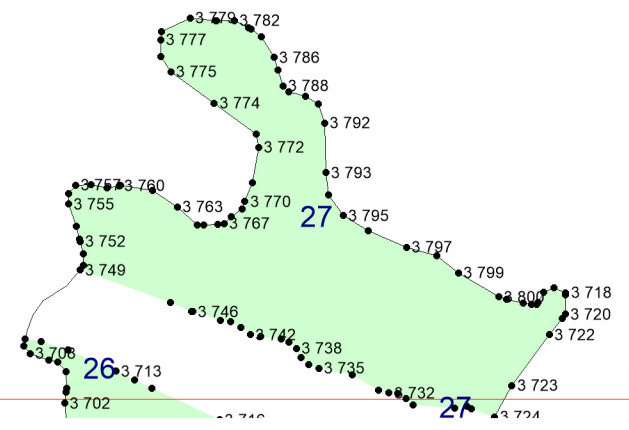
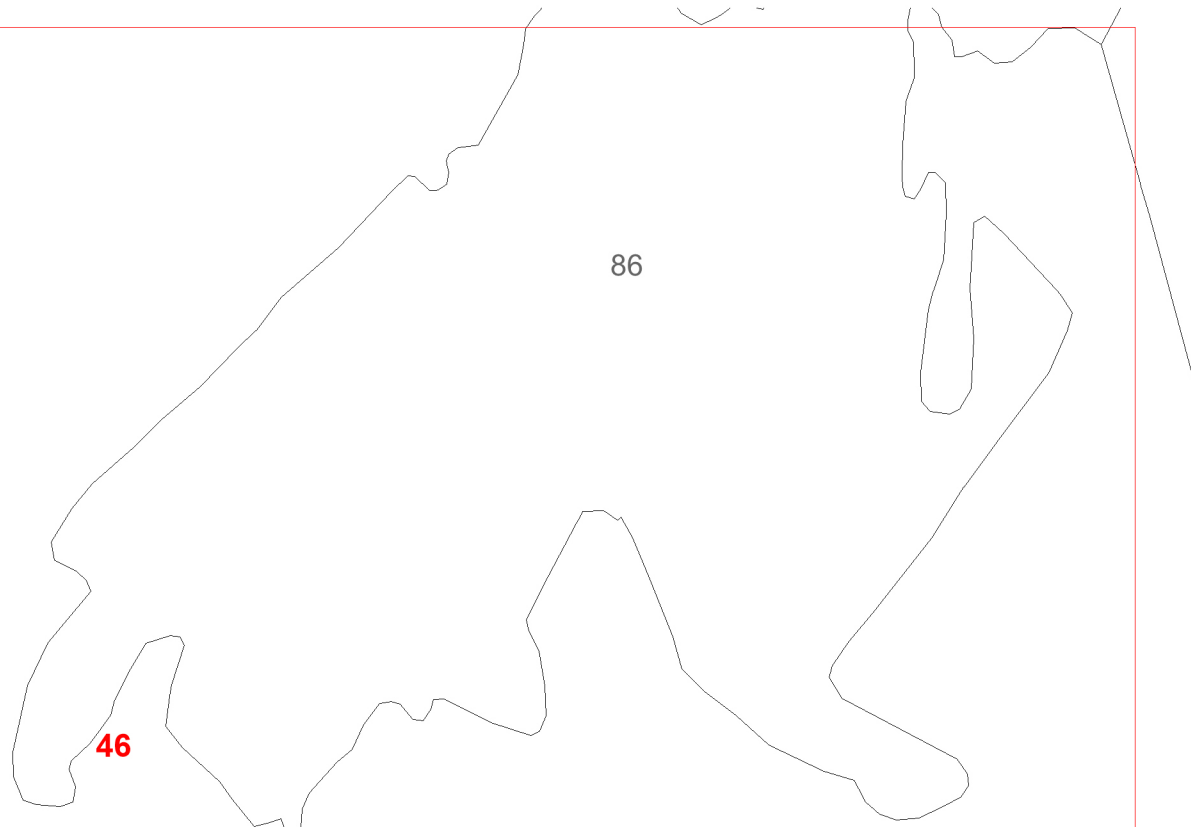

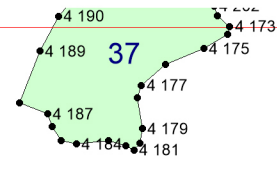

47

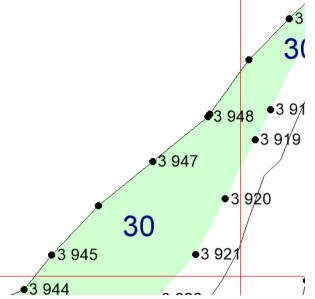

48

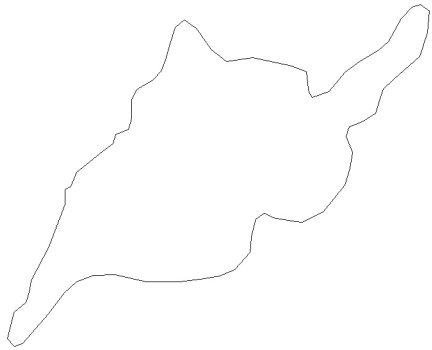
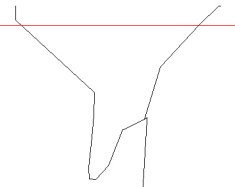
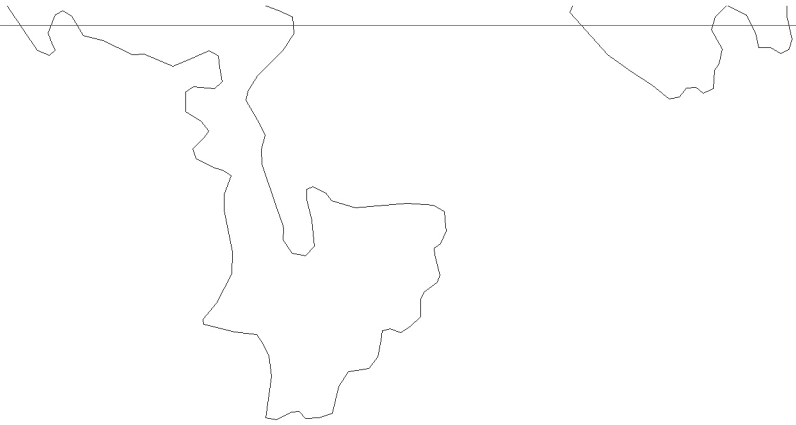

49

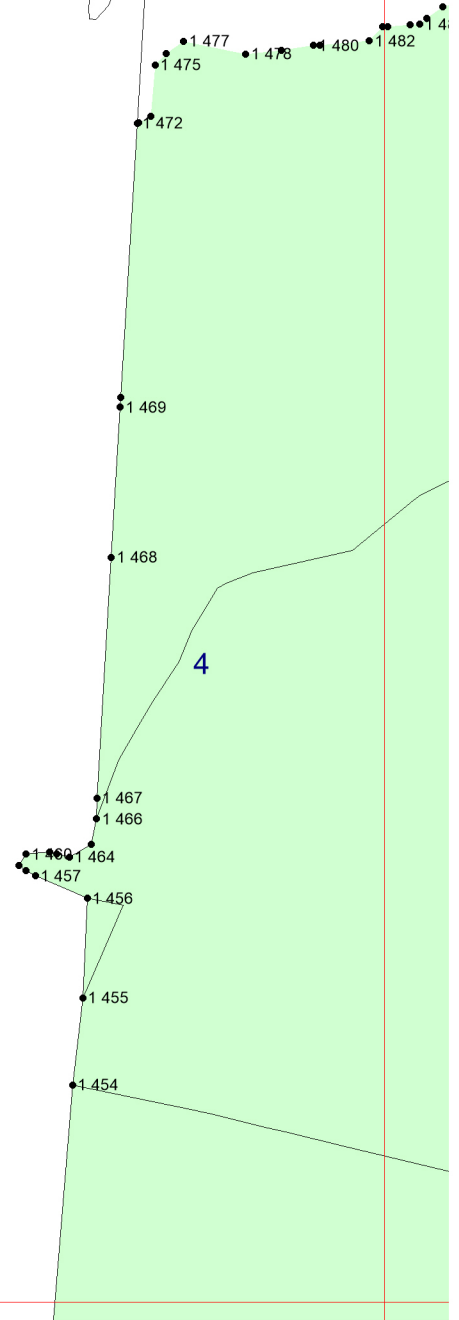

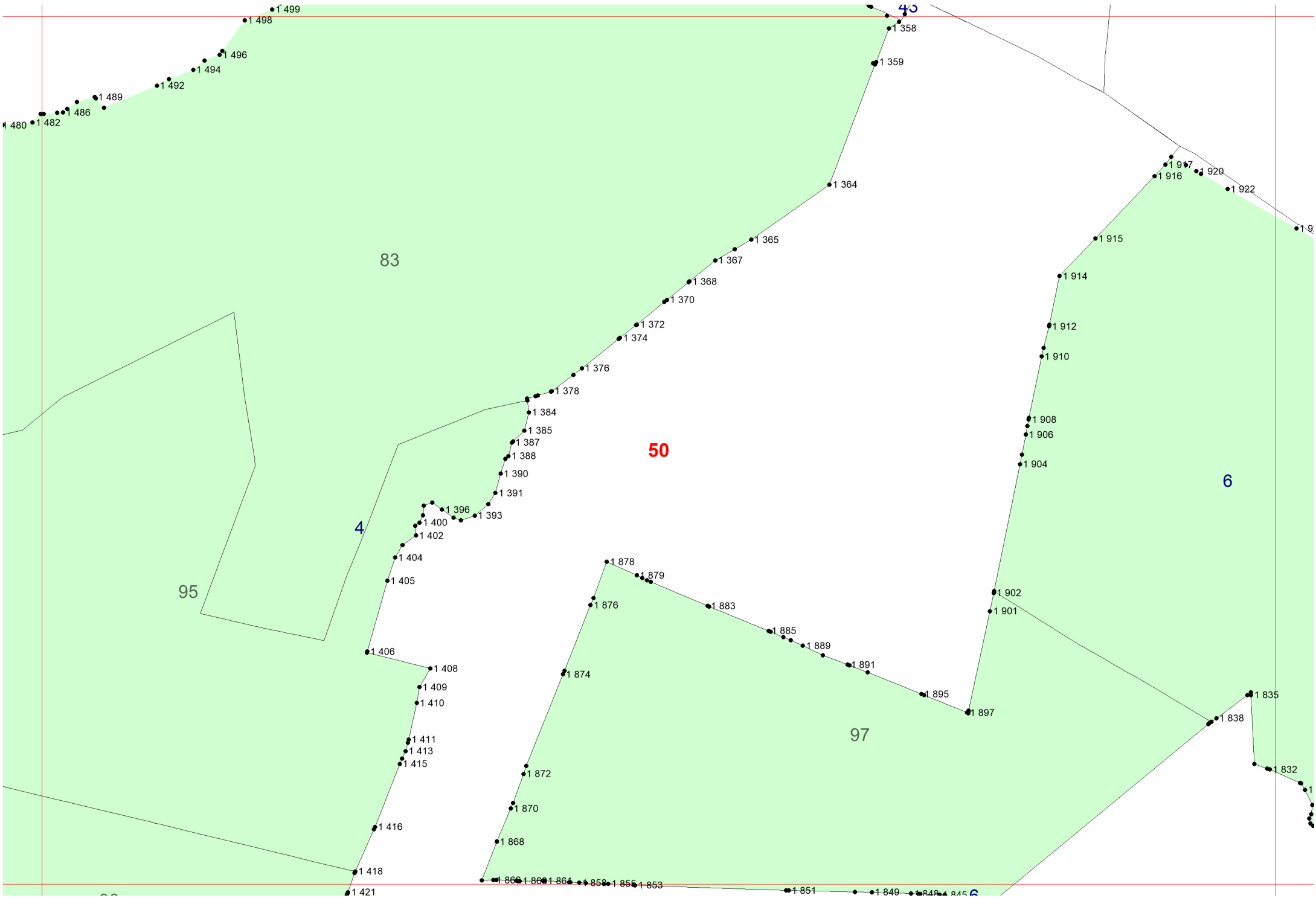

83

50

6

4

95

97

51

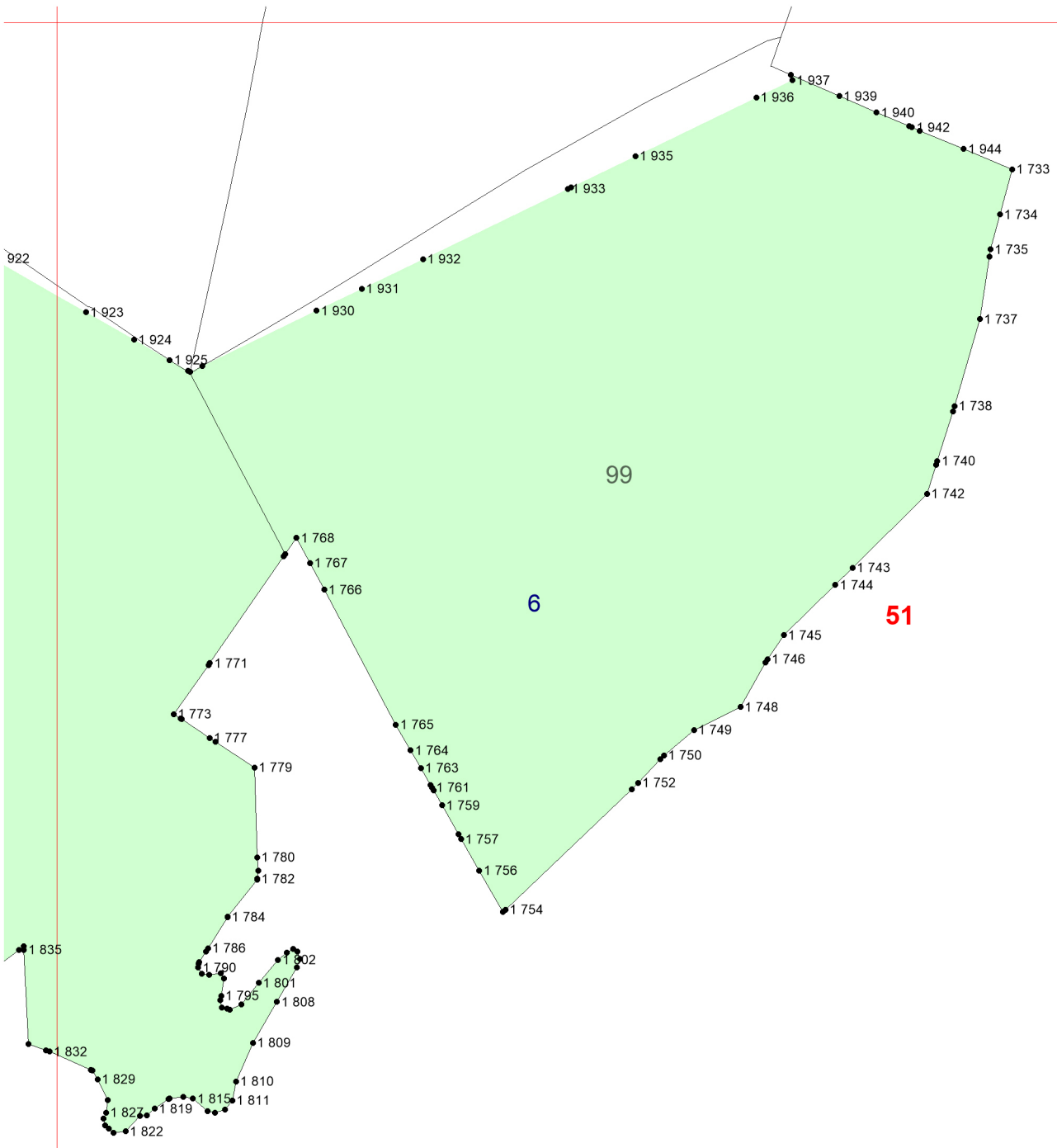

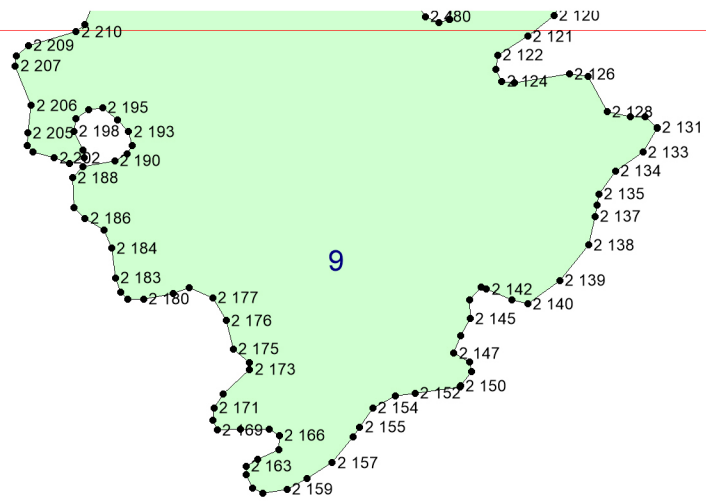

52

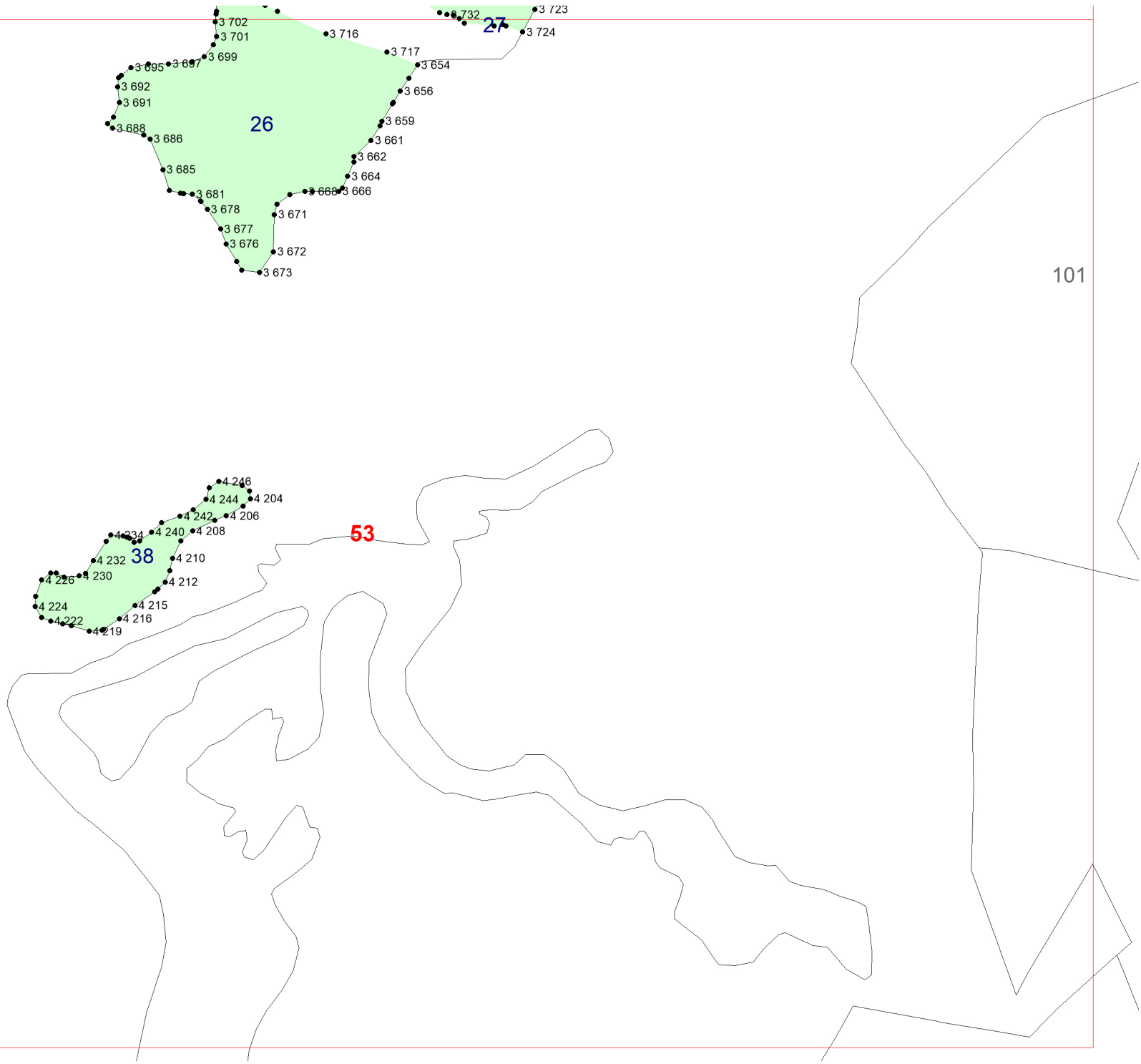

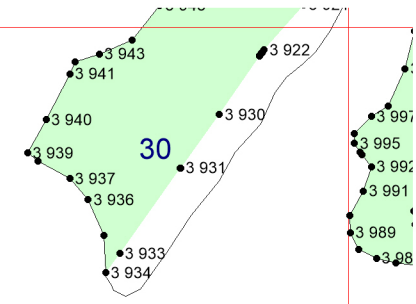

54

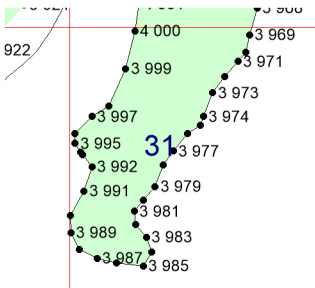

55

