

**Графическое описание местоположения границ земель,
на которых располагаются особо защитные участки
лесов «берегозащитные участки лесов»,
на территории
Юрминского участкового лесничества
Туймазинского лесничества
Республики Башкортостан**

Приложение № 391 к приказу Рослесхоза

от 27.02.2023

№ 201

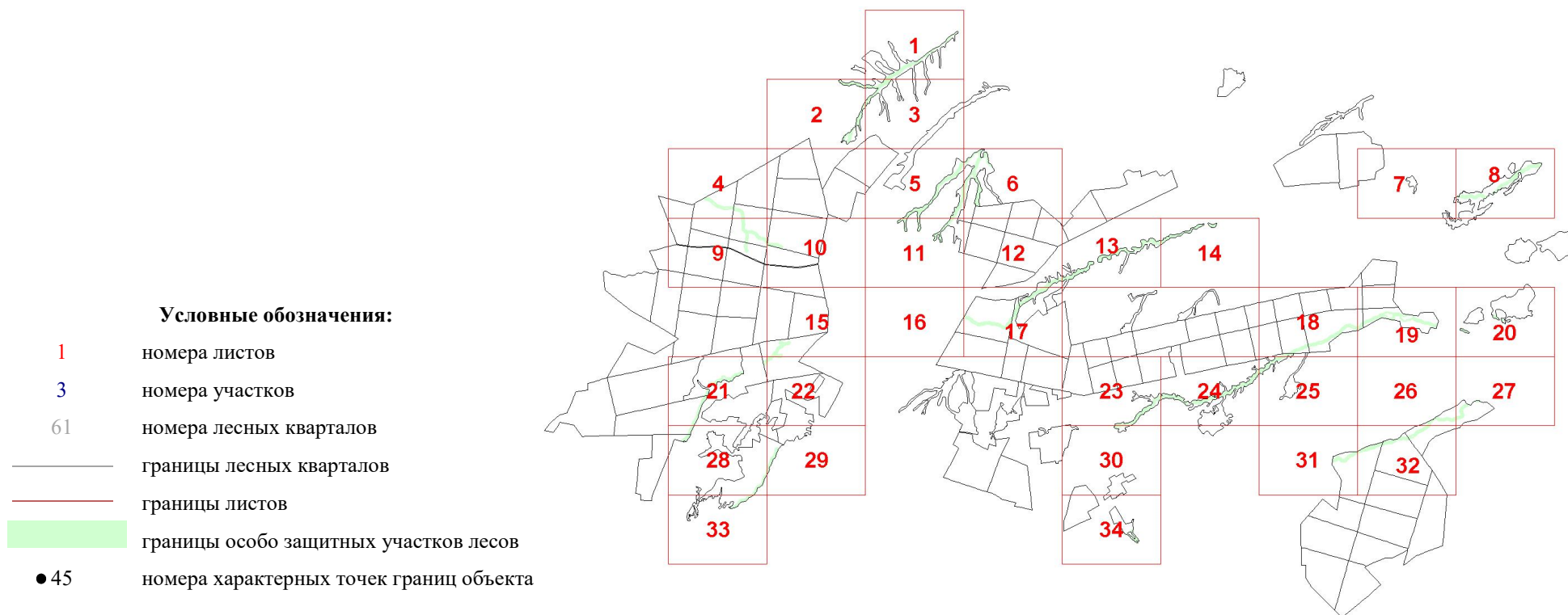

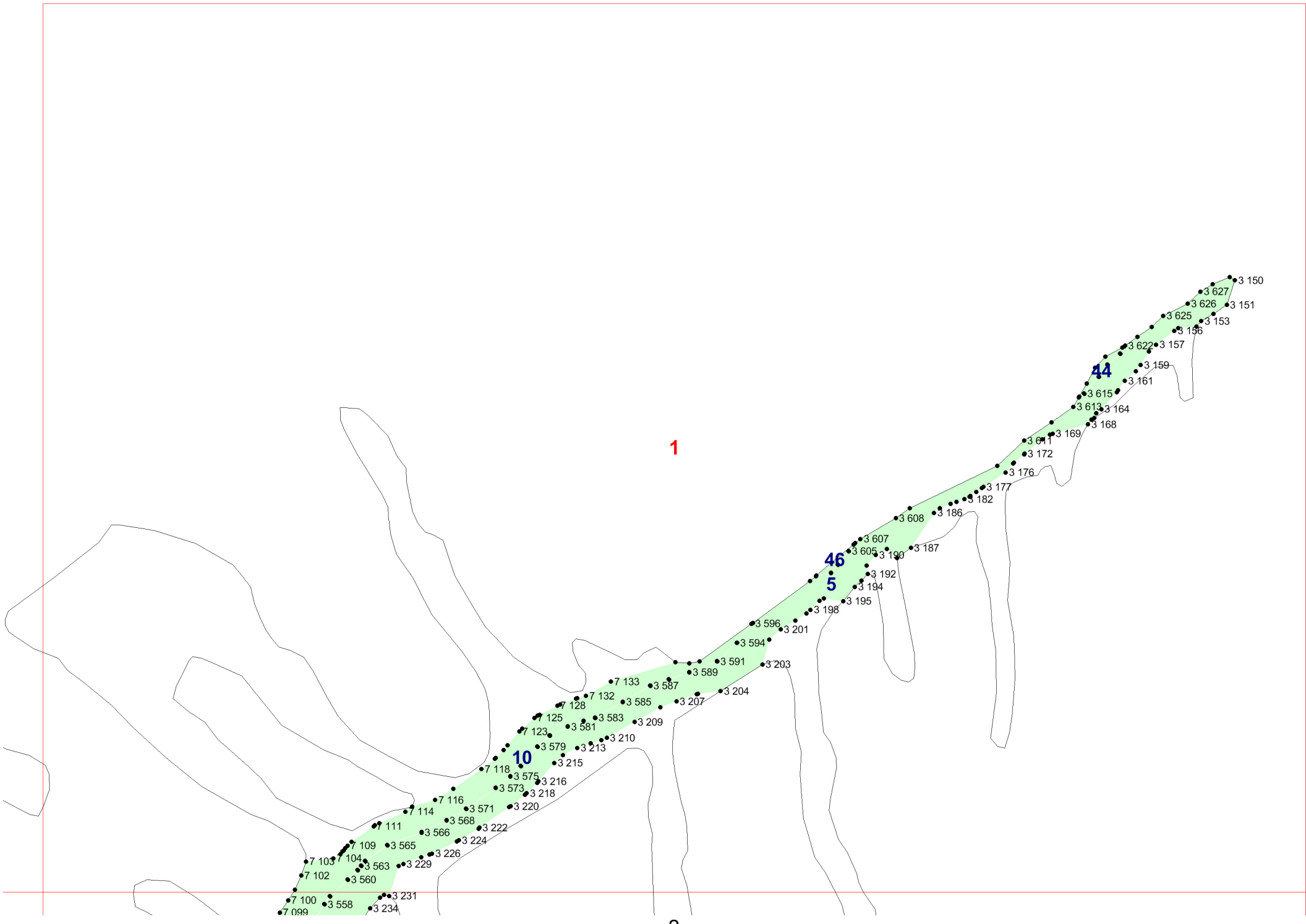

2

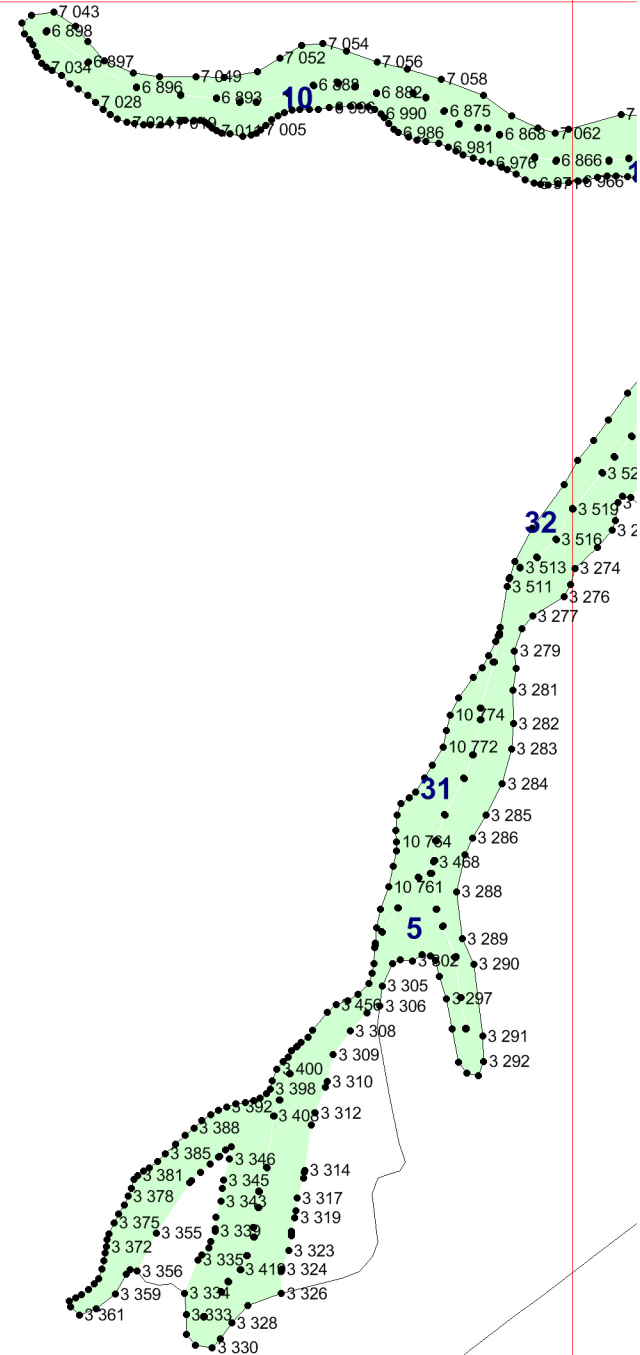

3

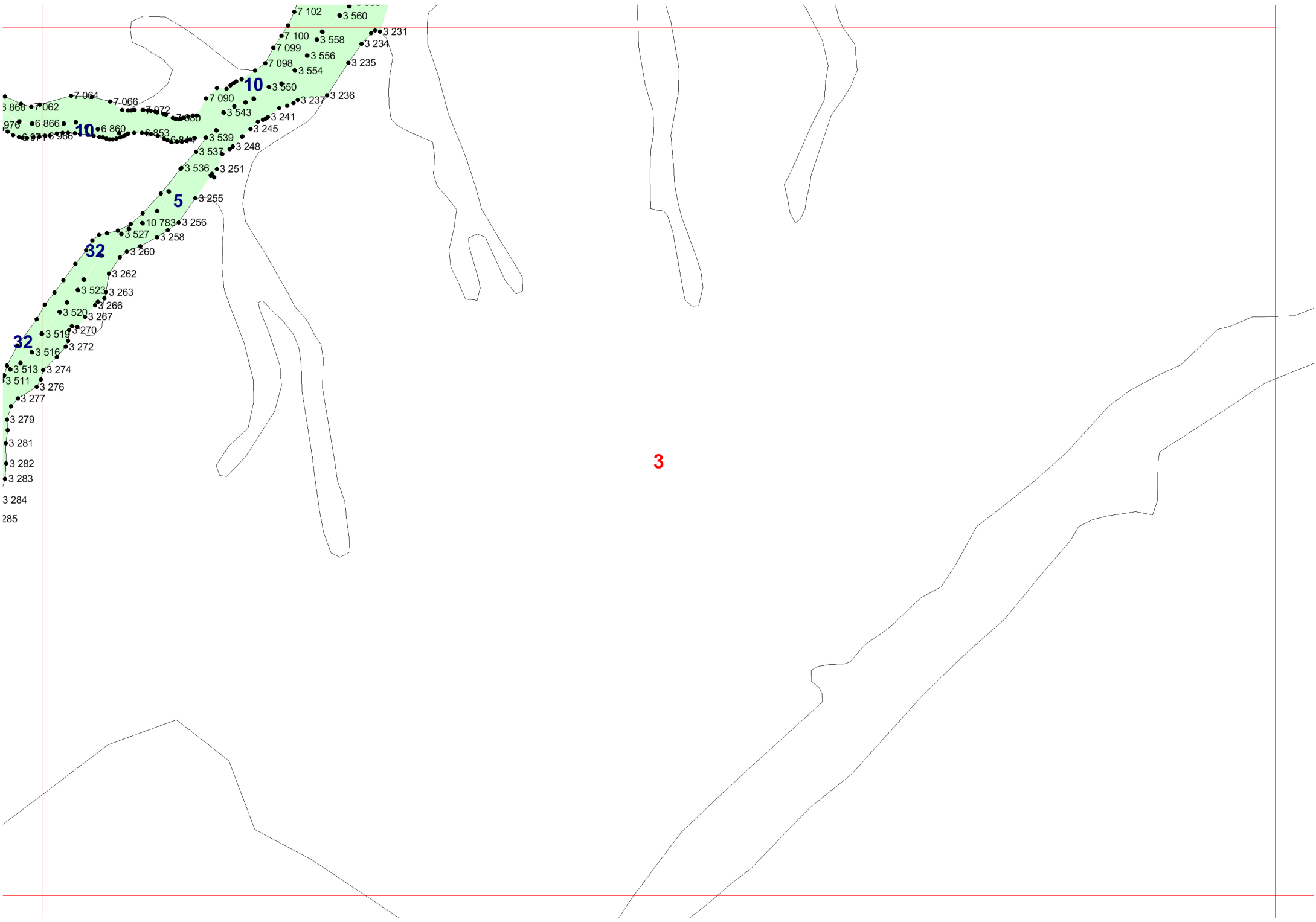

3 868 7 062 7 064 7 066 7 072 7 080 7 090 7 098 7 100 7 102 3 560 3 231 3 234 3 235 3 554 3 556 3 550 3 237 3 236 3 866 6 860 6 853 3 543 3 241 3 245 3 539 3 248 3 537 3 248 3 536 3 251 3 255 10 783 3 256 3 527 3 258 3 260 3 262 3 523 3 263 3 266 3 520 3 267 3 519 3 270 3 518 3 272 3 513 3 274 3 511 3 276 3 277 3 279 3 281 3 282 3 283 3 284 285

3

4

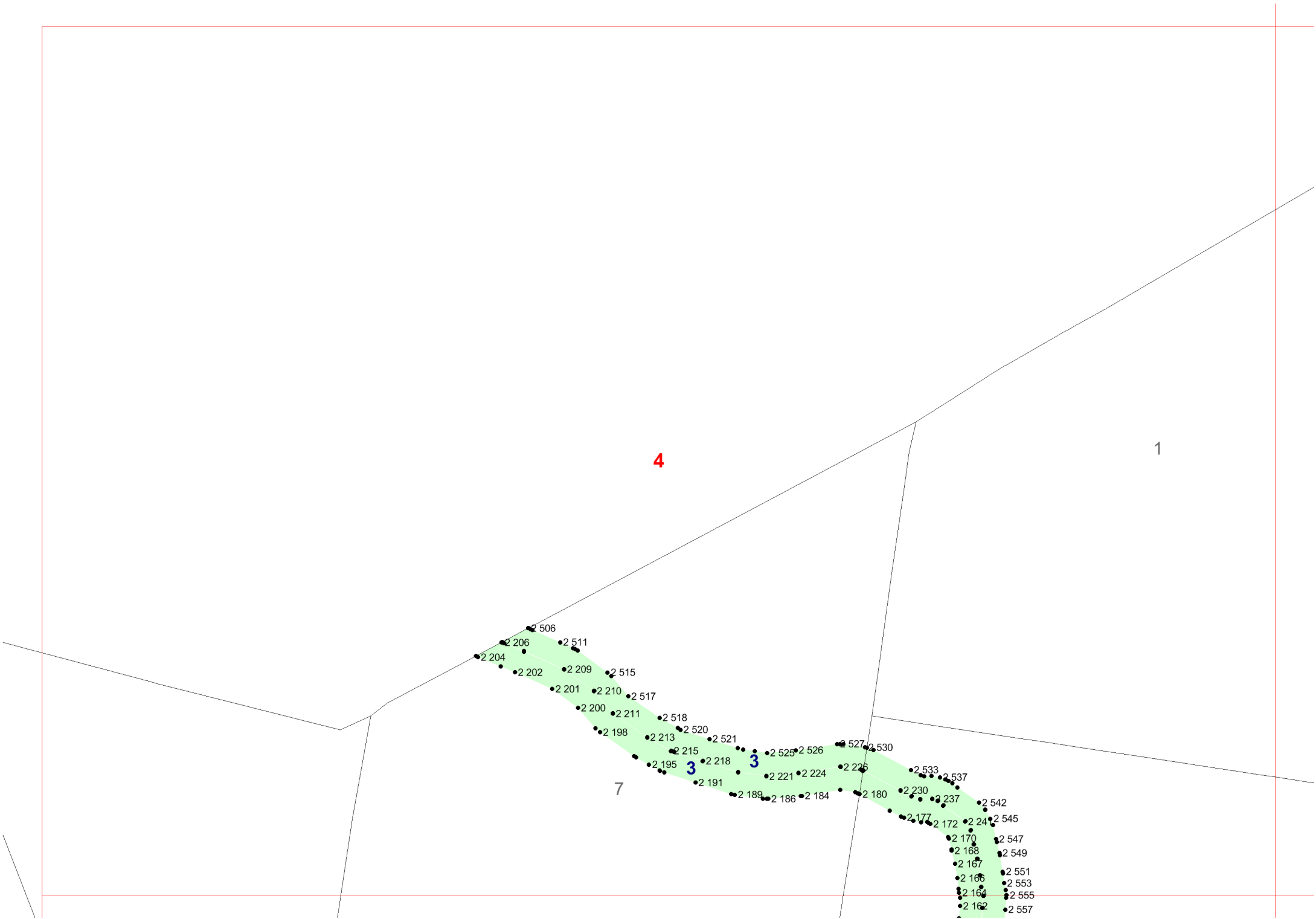

3

5

6

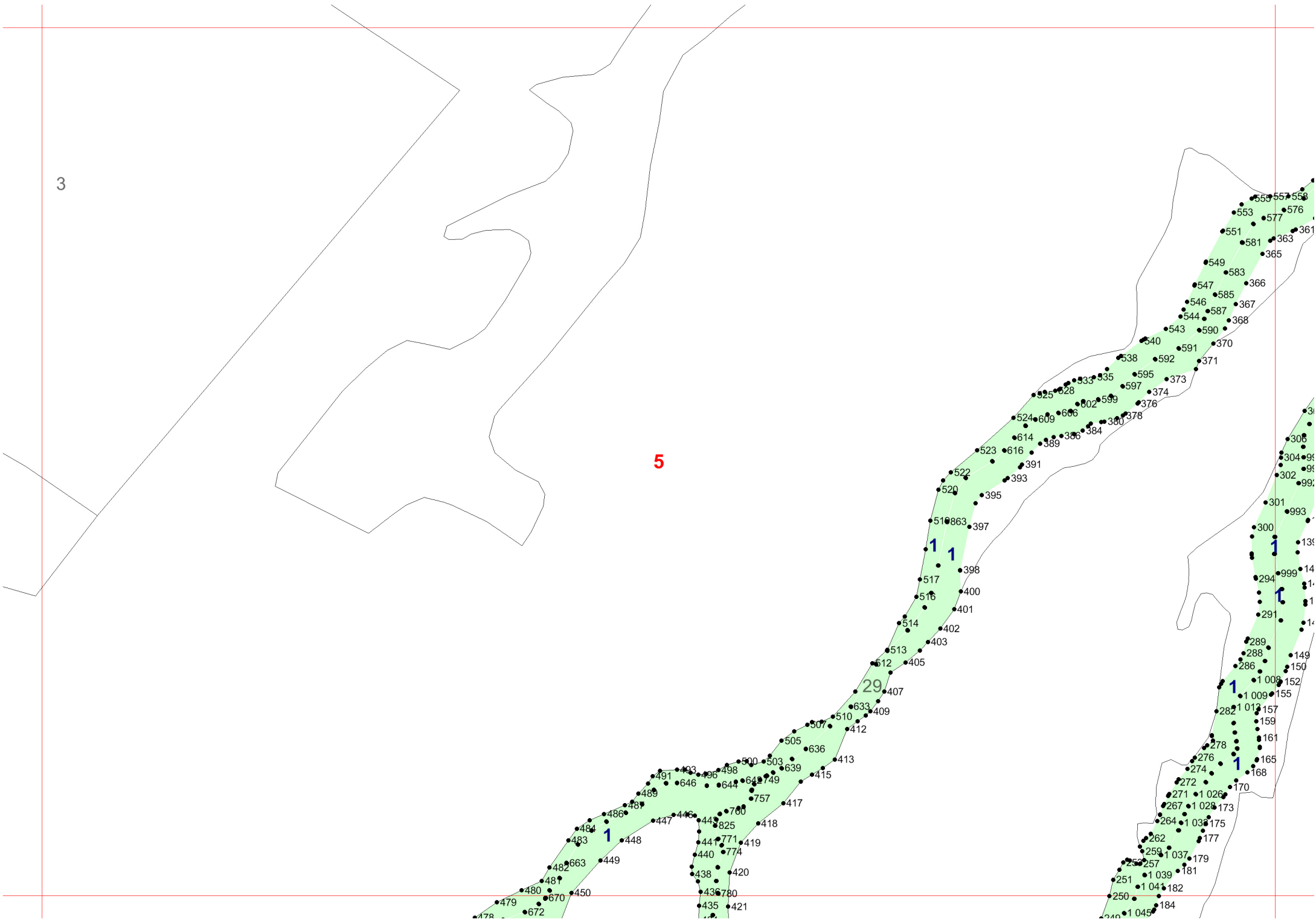

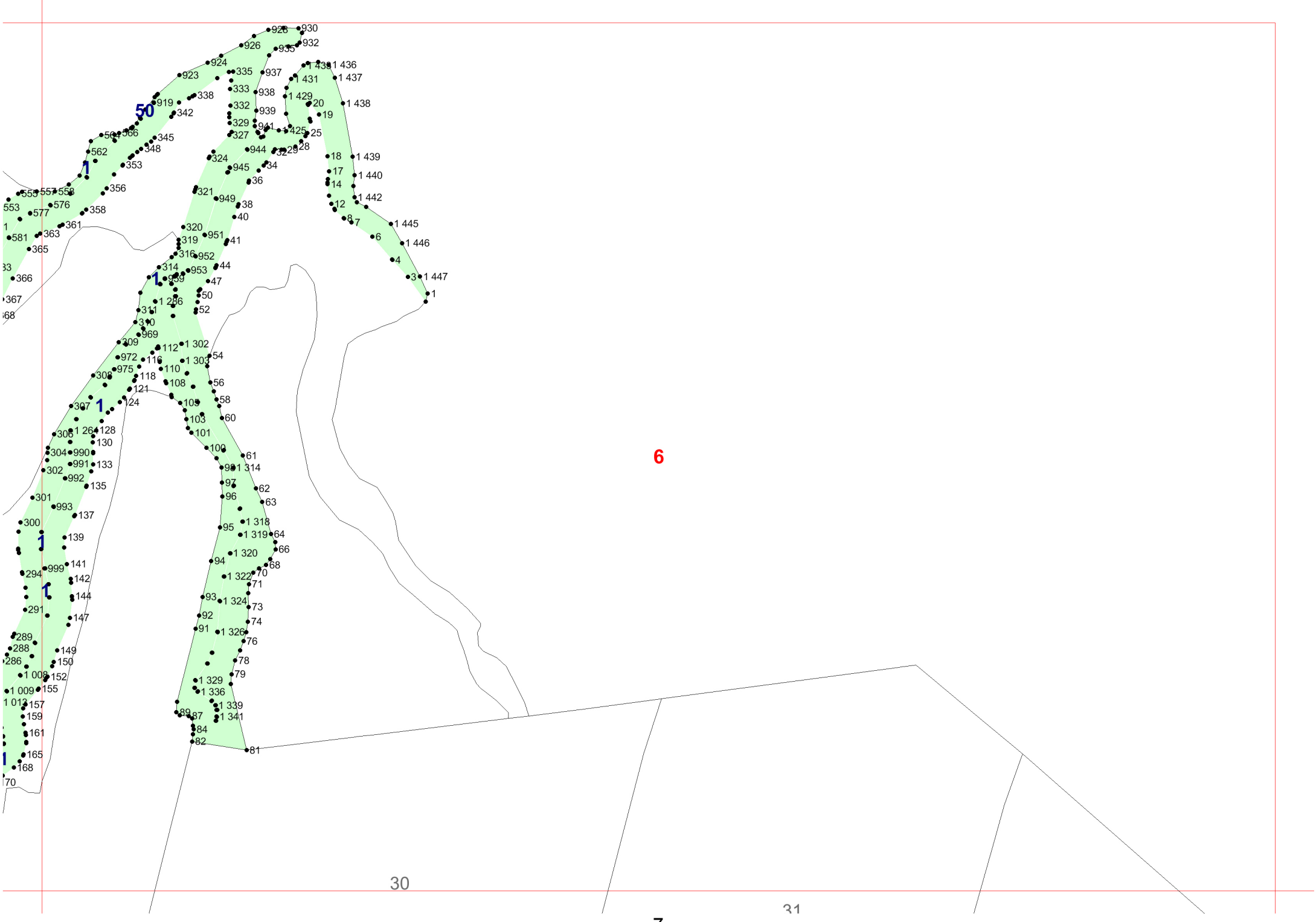

37

7

24 991'

8

6

8

9

10

11

10

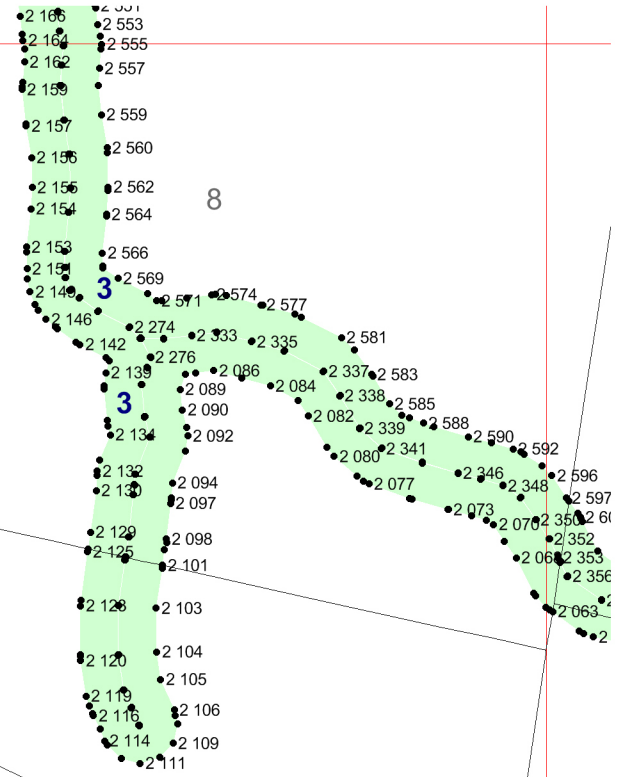

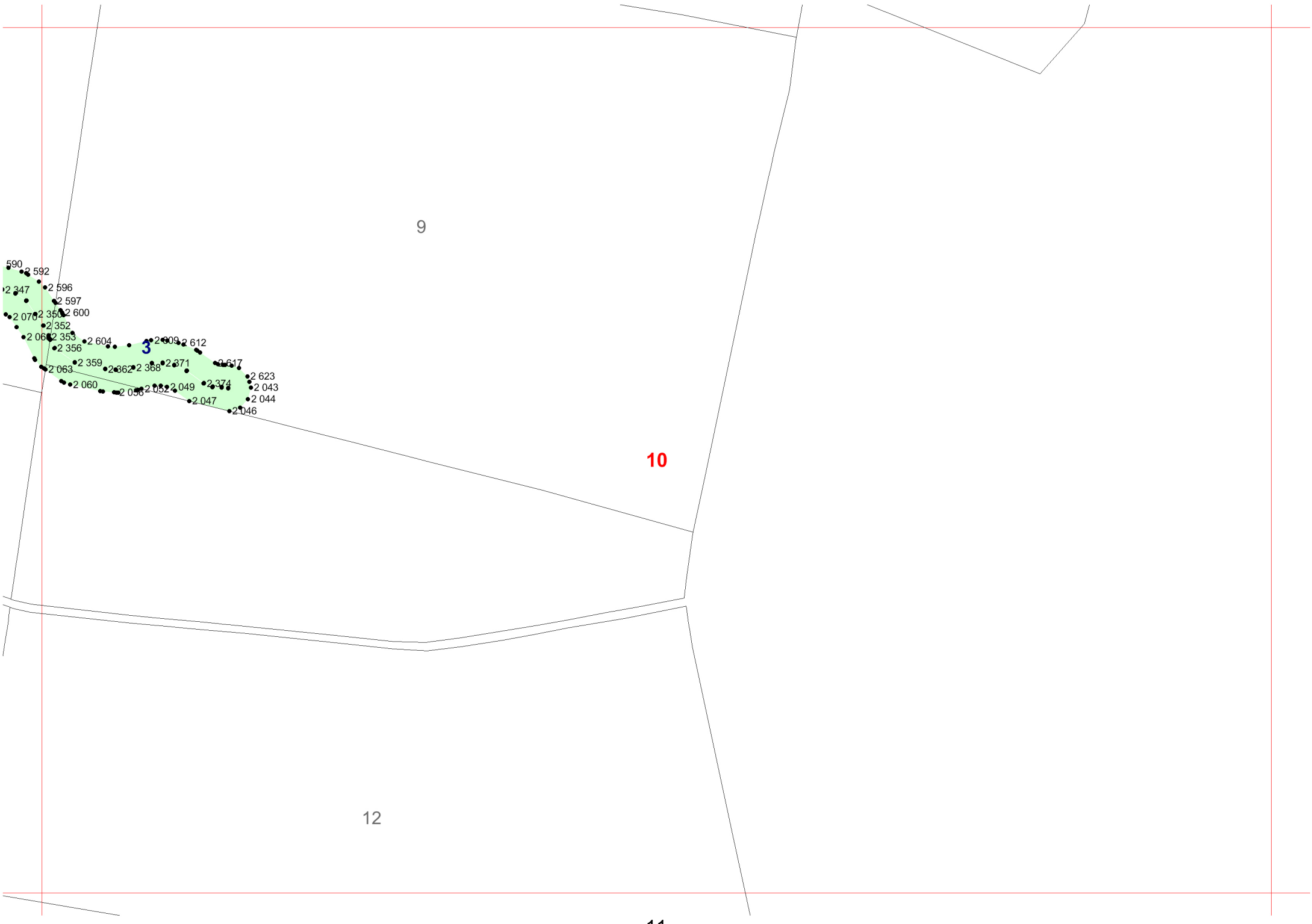

- 590
- 2.347
- 2.070
- 2.066
- 2.063
- 2.060
- 2.056
- 2.347
- 2.592
- 2.596
- 2.597
- 2.350
- 2.352
- 2.353
- 2.356
- 2.359
- 2.063
- 2.060
- 2.056
- 2.604
- 2.609
- 2.612
- 2.617
- 2.623
- 2.043
- 2.044
- 2.047
- 2.046
- 2.371
- 2.374
- 2.374
- 2.617
- 2.623
- 2.043
- 2.044
- 2.047
- 2.046

9

10

12

11

3

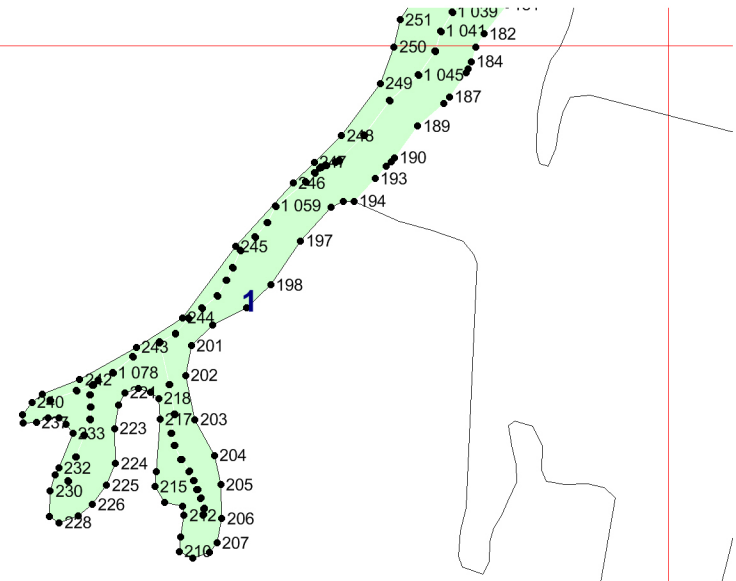
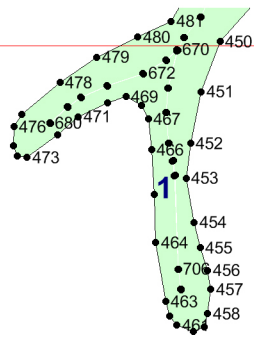

11

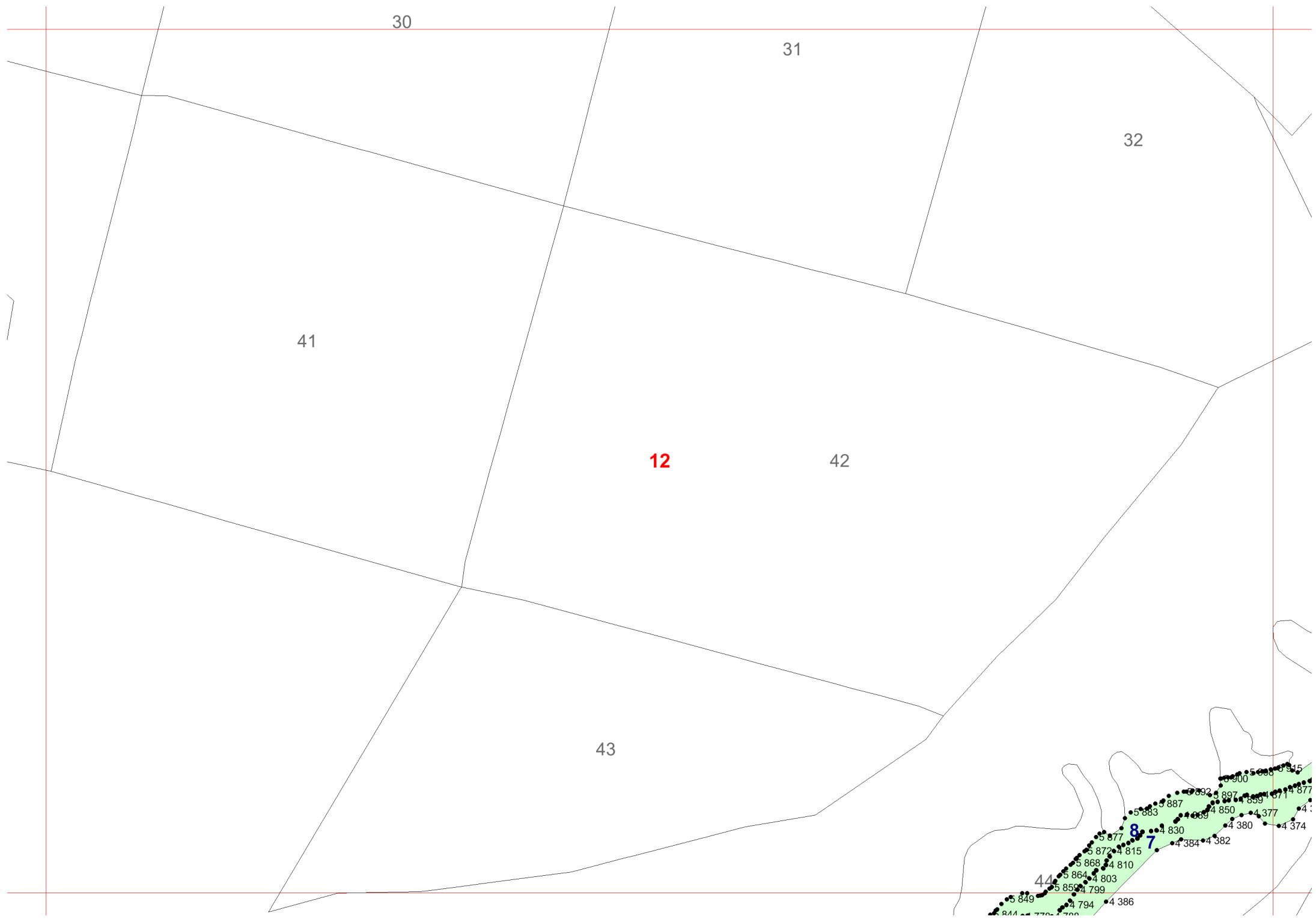

30

31

32

41

12

42

43

13

8

7

44

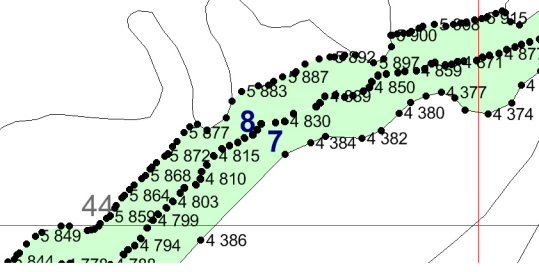

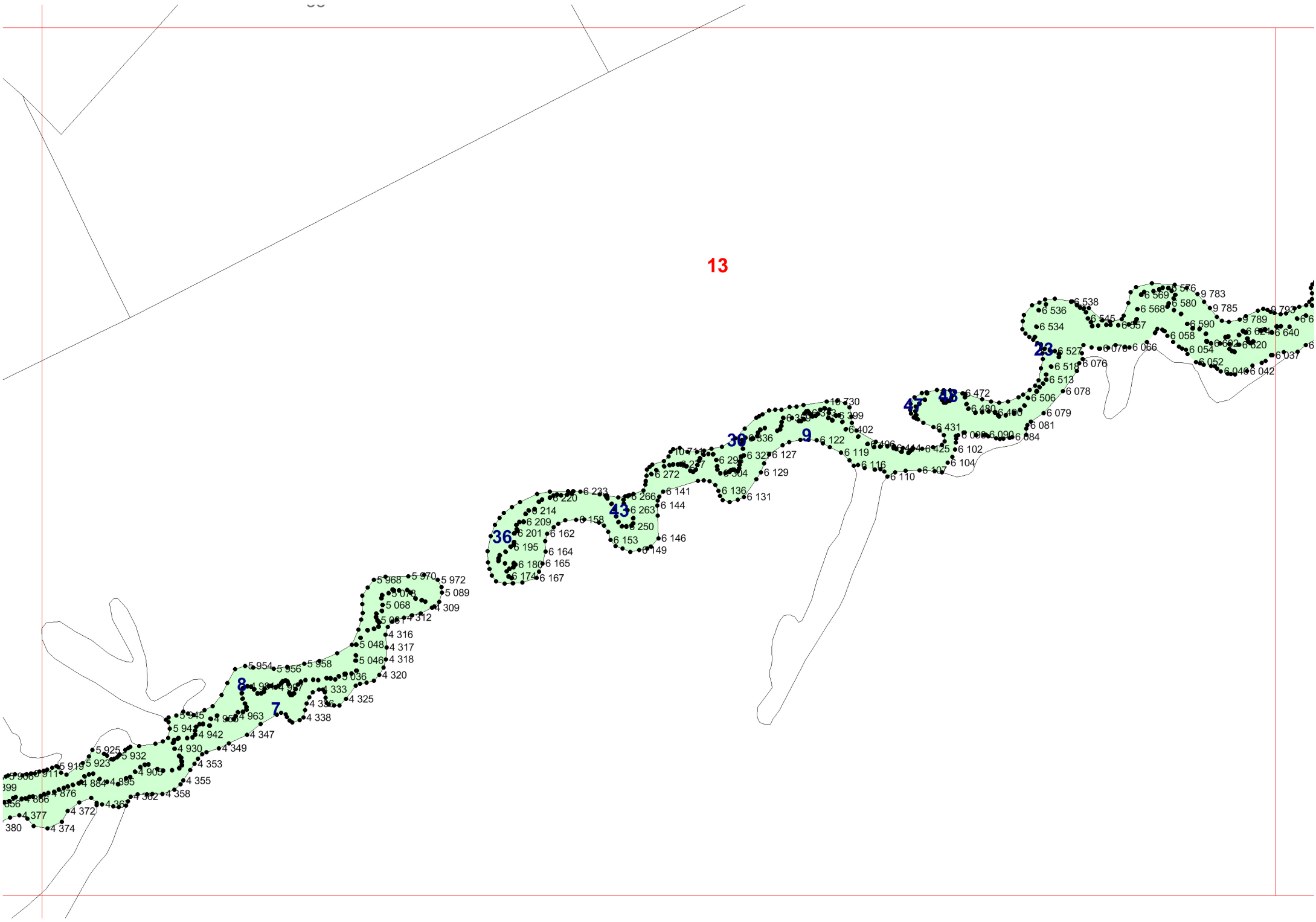

13

14

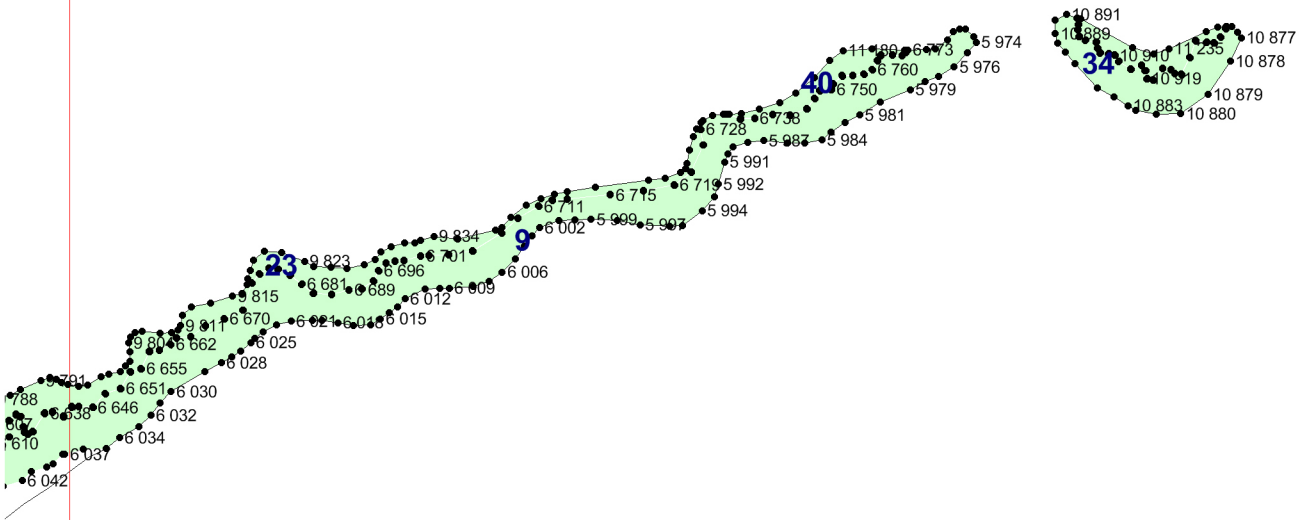

14

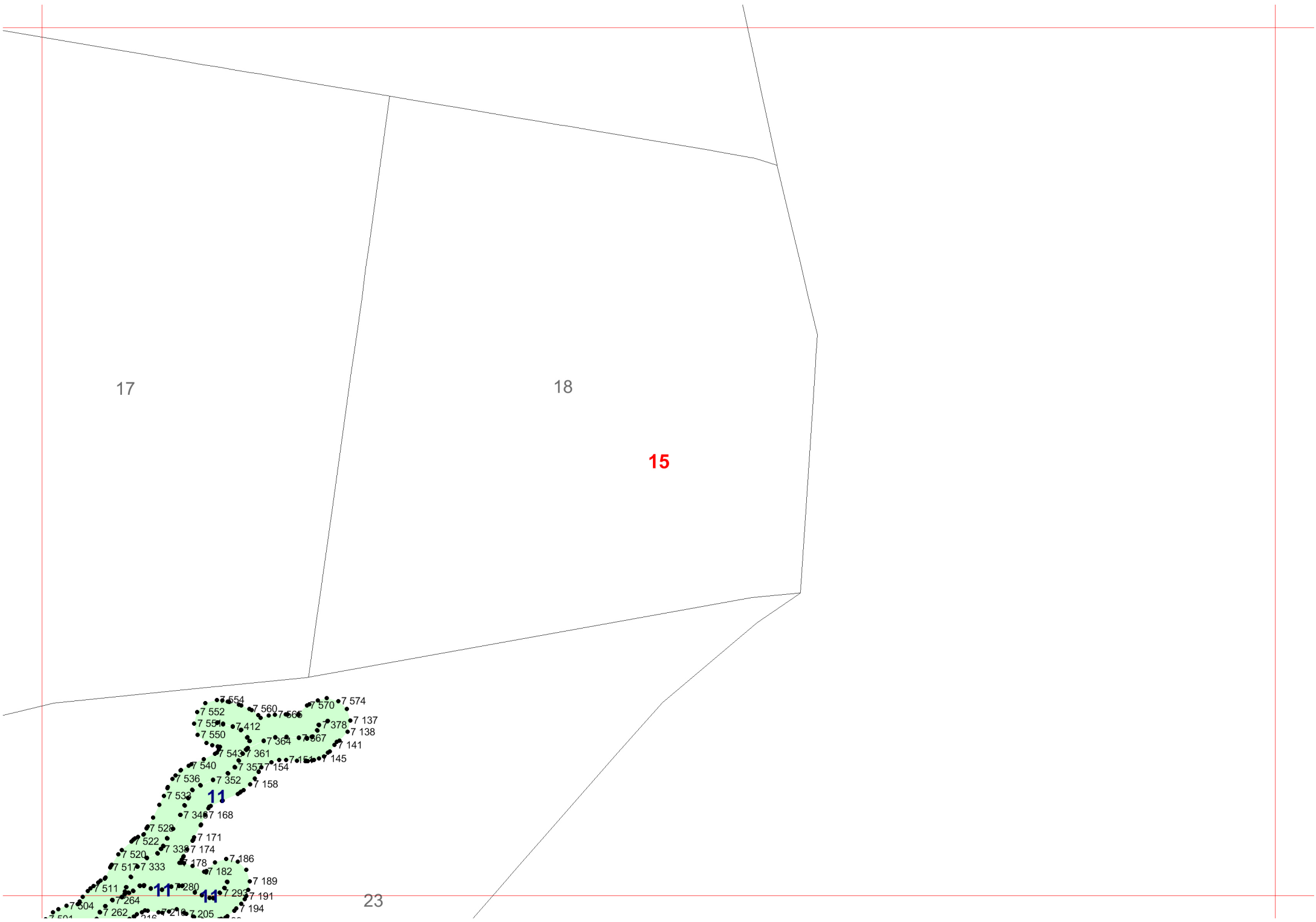

17

18

15

23

16

16

67
4 527 4
4 524

17

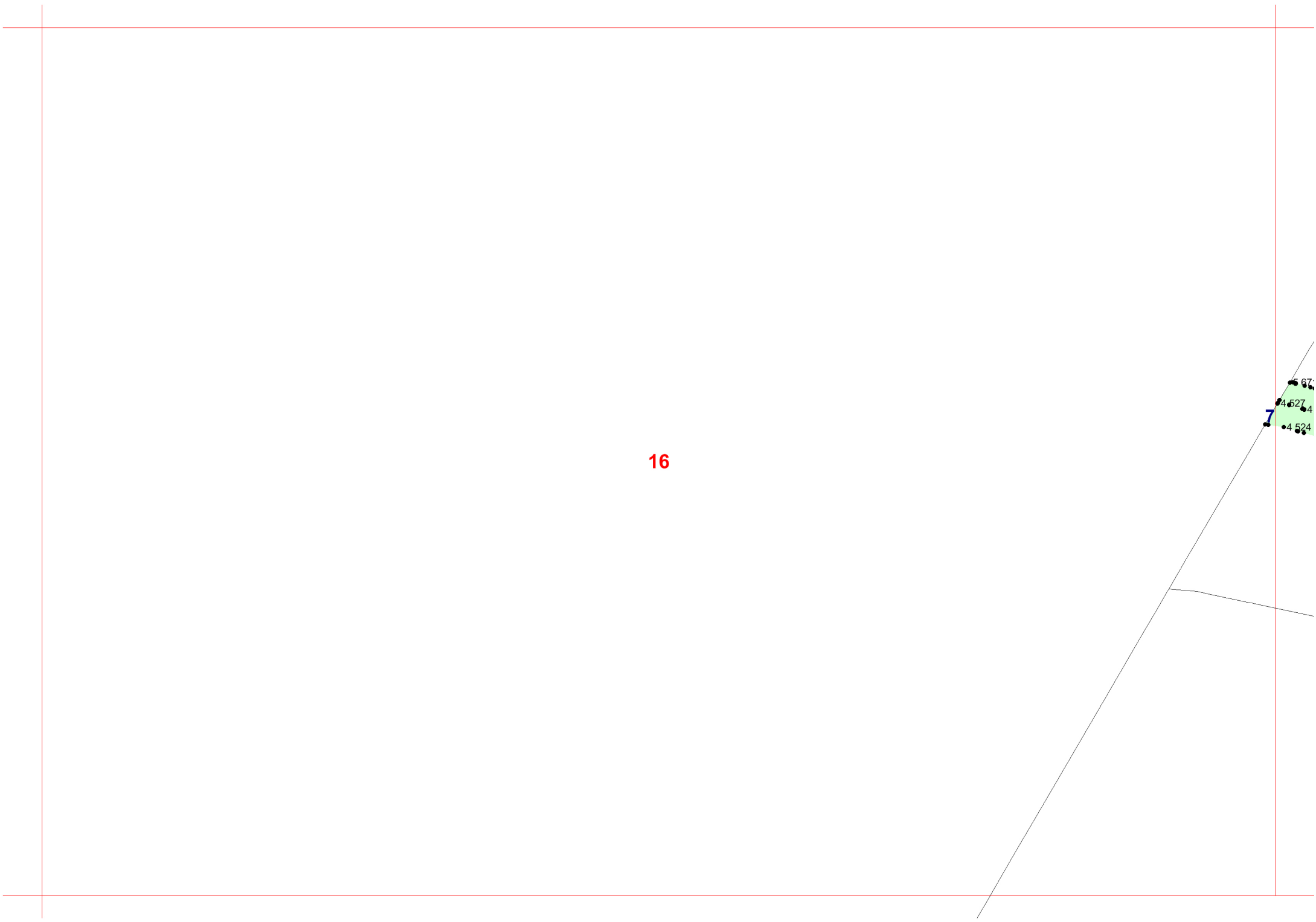

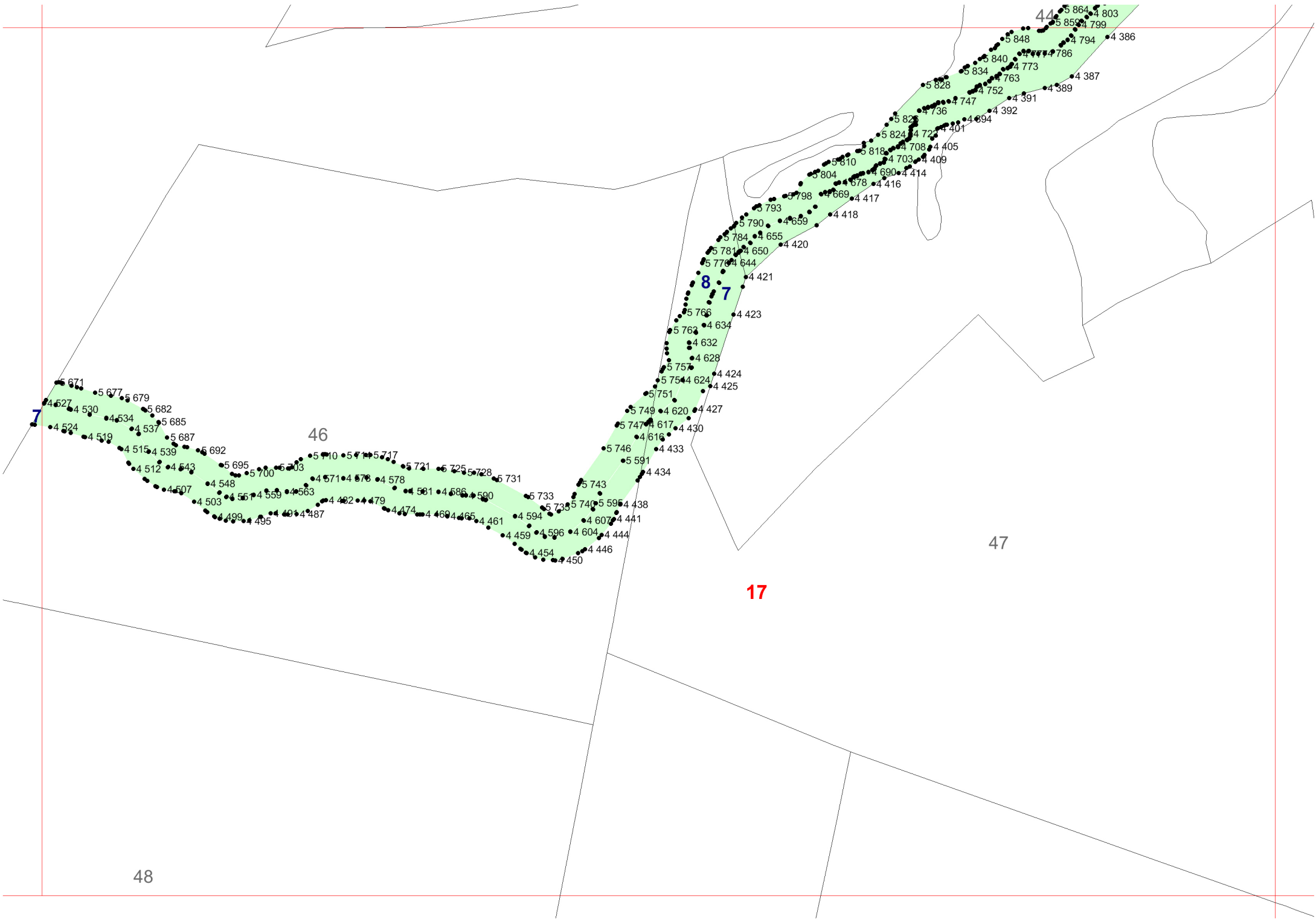

7

46

8

7

44

47

17

48

18

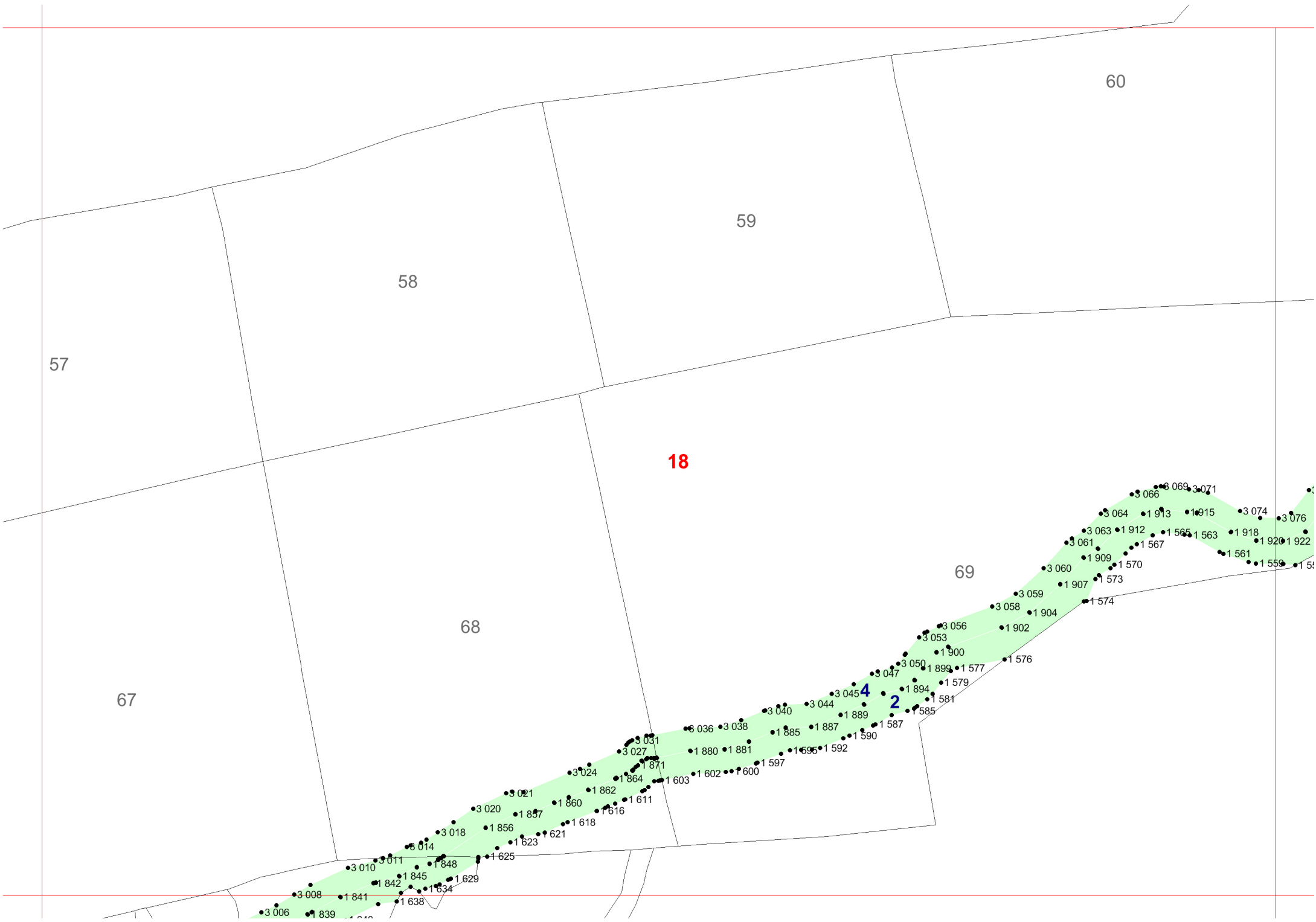

18

19

57

58

59

60

67

68

69

4

2

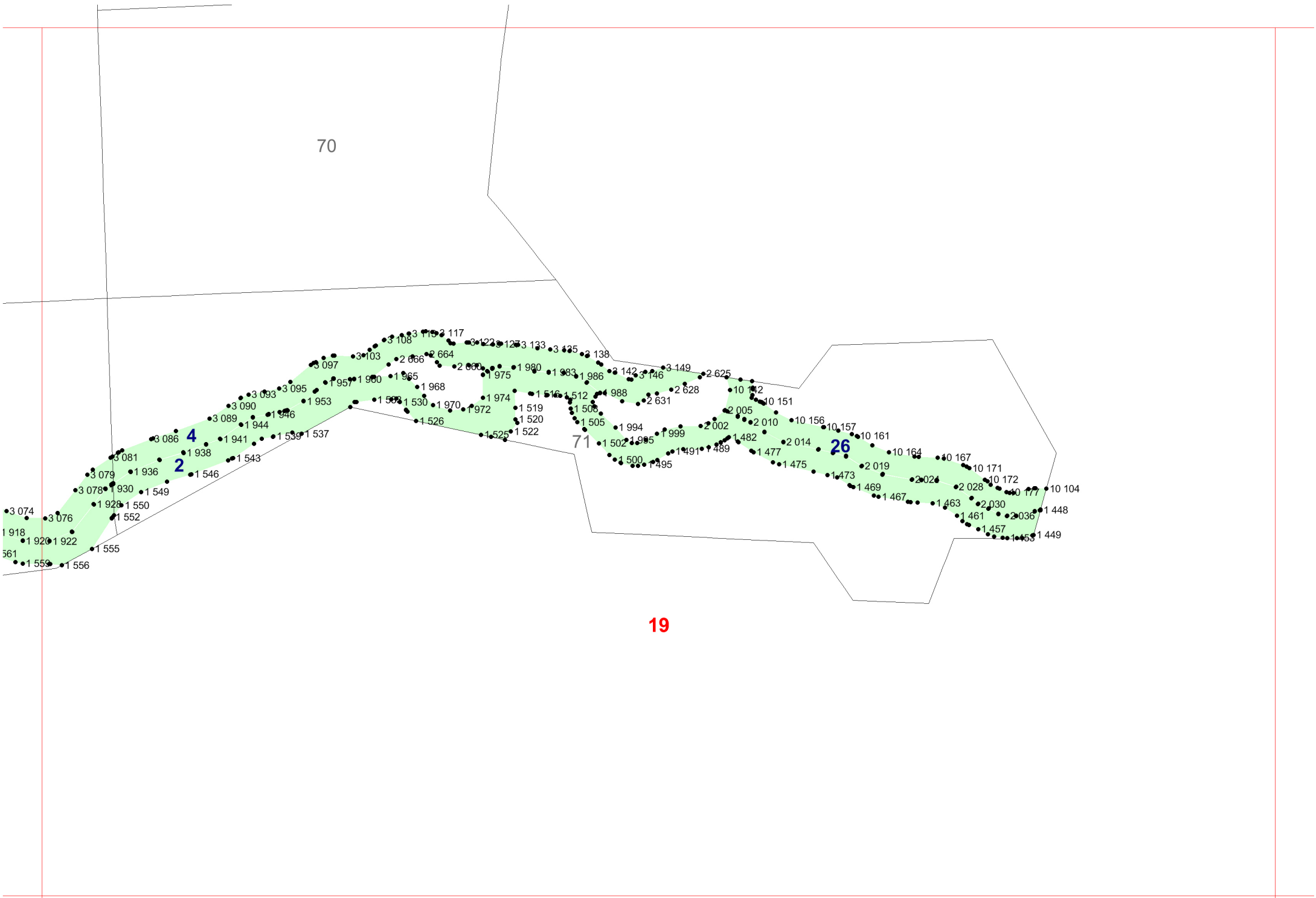

70

19

20

4

2

71

26

3 074
1 918
561
1 555

3 076
1 920
1 922
1 556

1 928
1 550
1 552
1 555

1 930
1 549
1 546

3 079
1 936
1 543

3 081
1 938
1 546

3 086
1 941
1 543

3 089
1 944
1 537

3 093
1 946
1 537

3 095
1 953
1 537

3 097
1 960
1 537

3 103
1 965
1 537

3 108
1 968
1 537

3 117
1 970
1 537

3 122
1 972
1 537

3 133
1 974
1 537

3 145
1 980
1 537

3 152
1 986
1 537

3 158
1 992
1 537

3 164
1 998
1 537

3 170
2 004
1 537

3 176
2 010
1 537

3 182
2 016
1 537

3 188
2 022
1 537

3 194
2 028
1 537

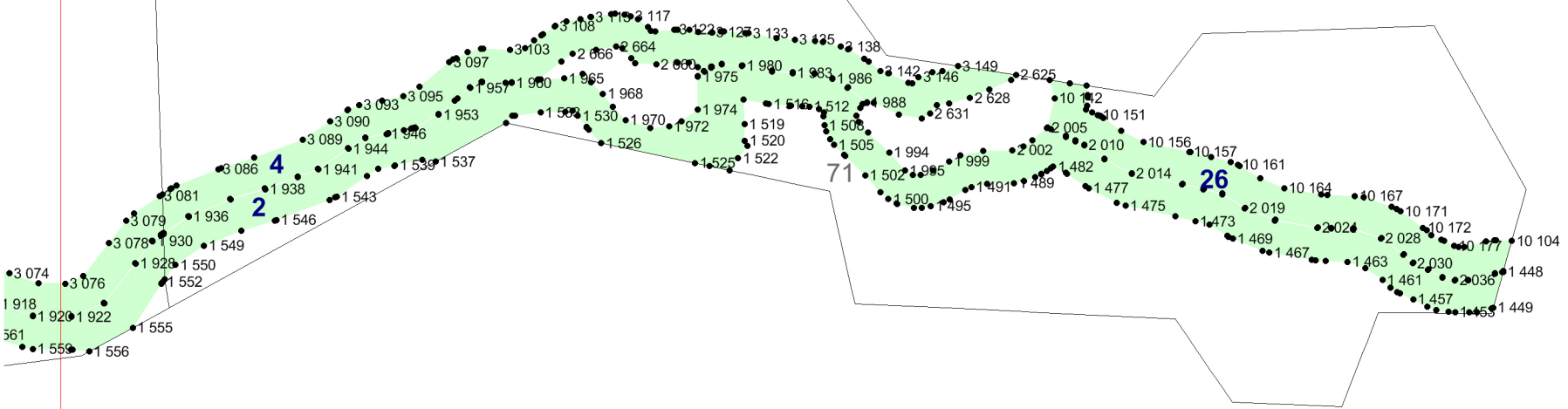

3 074
1 918
561
1 555

3 076
1 920
1 922
1 556

1 928
1 550
1 552
1 555

1 930
1 549
1 546

3 079
1 936
1 543

3 081
1 938
1 546

3 086
1 941
1 543

3 089
1 944
1 537

3 093
1 946
1 537

3 095
1 953
1 537

3 097
1 960
1 537

3 103
1 965
1 537

3 108
1 968
1 537

3 117
1 970
1 537

3 122
1 972
1 537

3 133
1 974
1 537

3 145
1 980
1 537

3 152
1 986
1 537

3 158
1 992
1 537

3 164
1 998
1 537

3 170
2 004
1 537

3 176
2 010
1 537

3 182
2 016
1 537

3 188
2 022
1 537

3 194
2 028
1 537

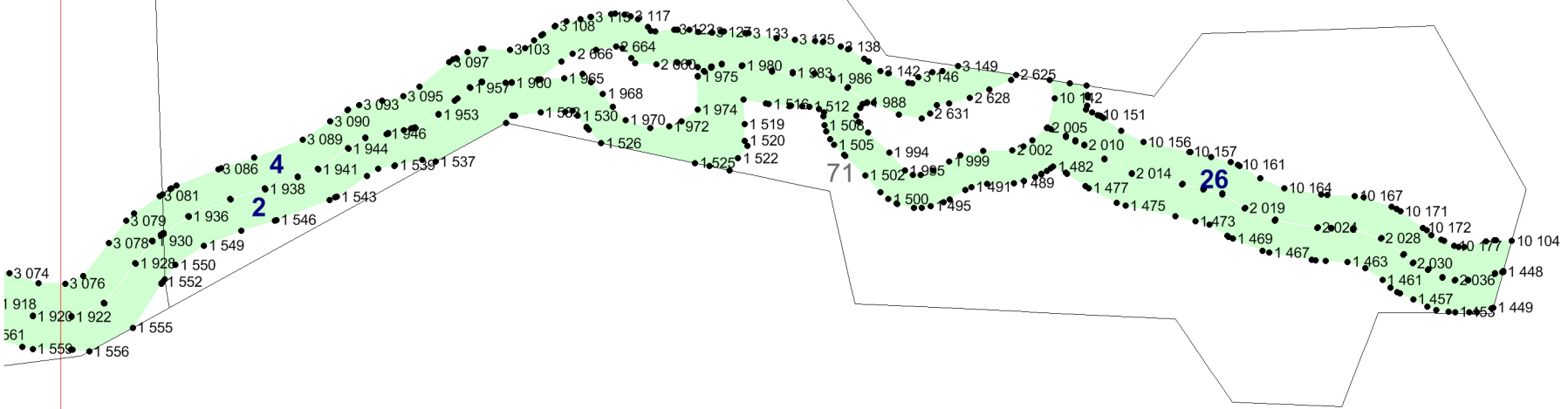

3 074
1 918
561
1 555

3 076
1 920
1 922
1 556

1 928
1 550
1 552
1 555

1 930
1 549
1 546

3 079
1 936
1 543

3 081
1 938
1 546

3 086
1 941
1 543

3 089
1 944
1 537

3 093
1 946
1 537

3 095
1 953
1 537

3 097
1 960
1 537

3 103
1 965
1 537

3 108
1 968
1 537

3 117
1 970
1 537

3 122
1 972
1 537

3 133
1 974
1 537

3 145
1 980
1 537

3 152
1 986
1 537

3 158
1 992
1 537

3 164
1 998
1 537

3 170
2 004
1 537

3 176
2 010
1 537

3 182
2 016
1 537

3 188
2 022
1 537

3 194
2 028
1 537

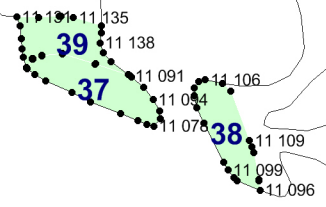
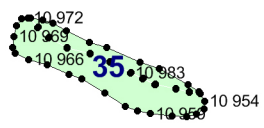
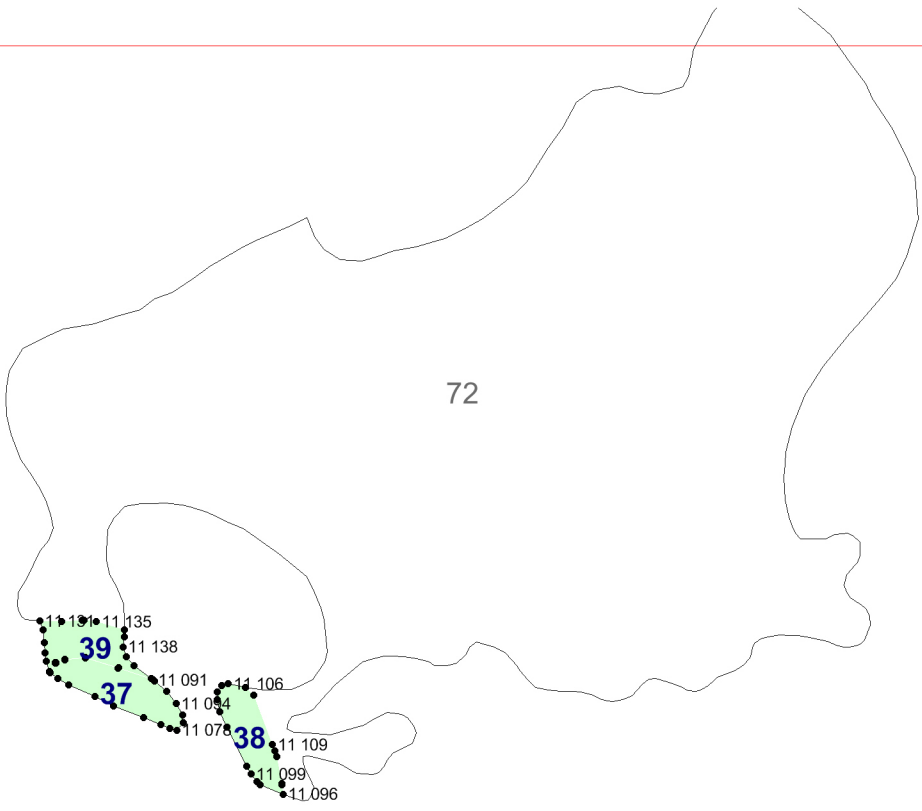
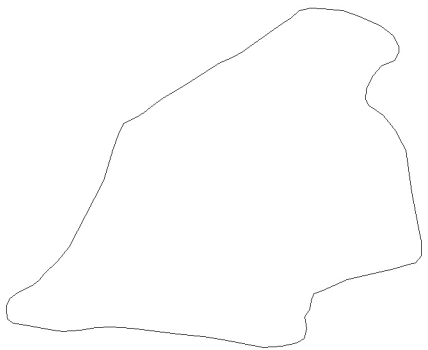

20

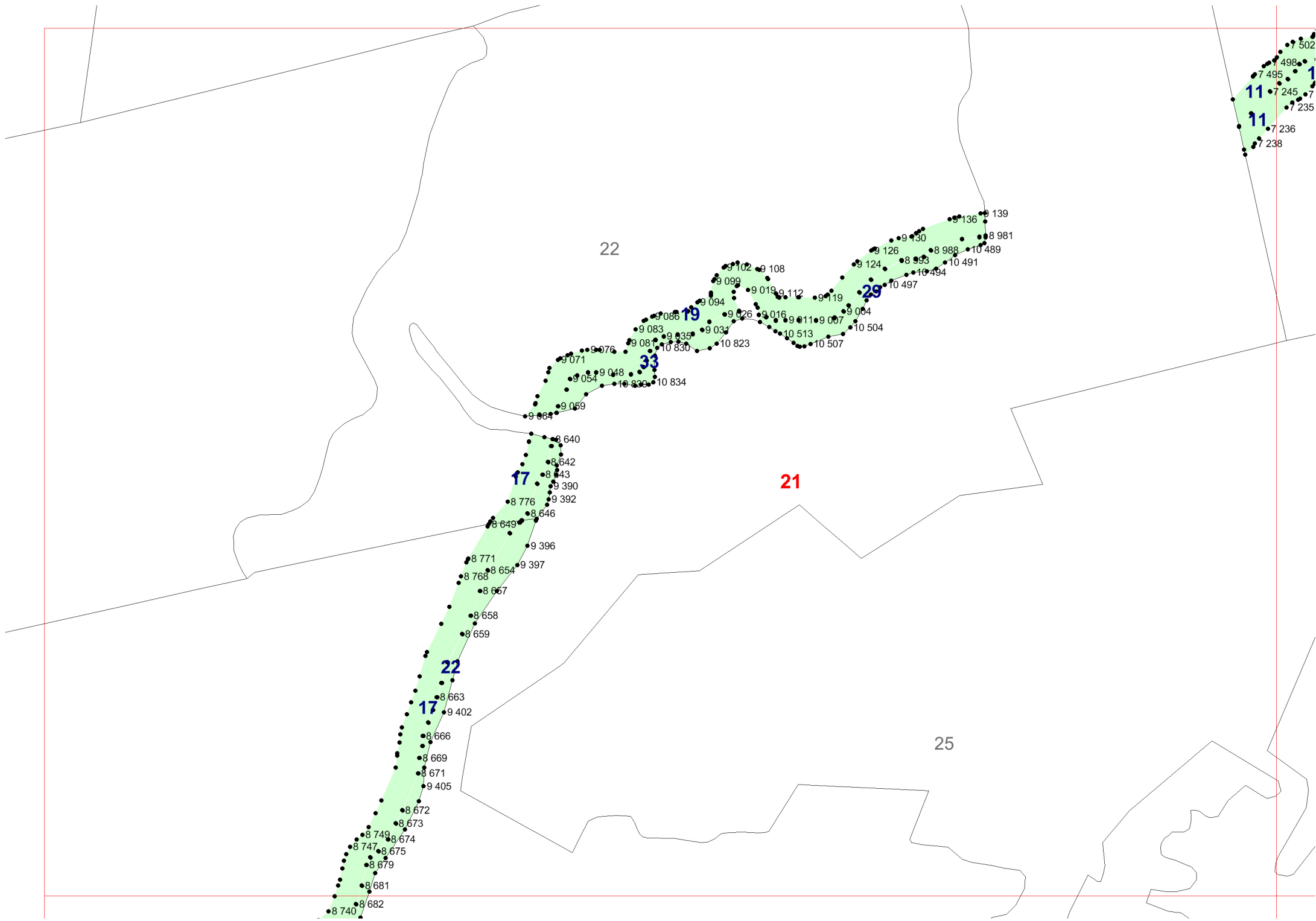

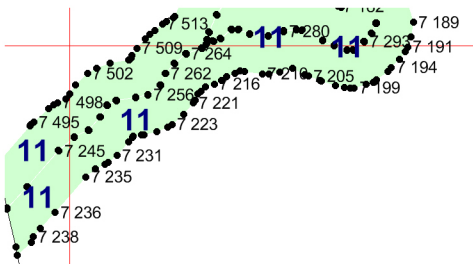

23

22

26

23

51

62

63

64

23

75

24

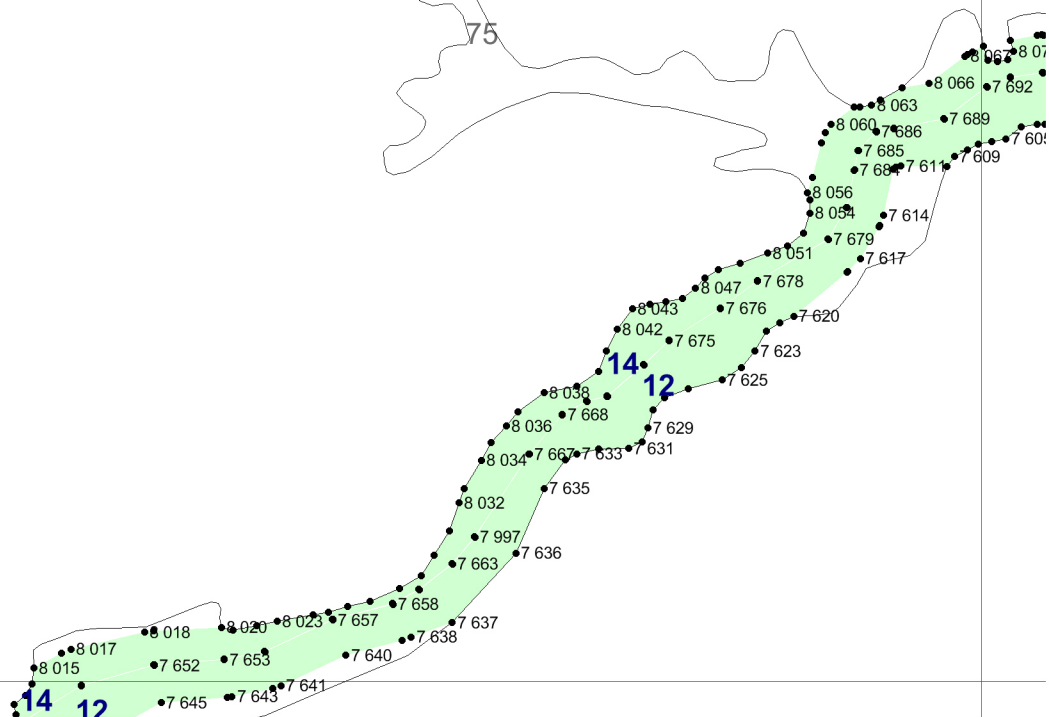

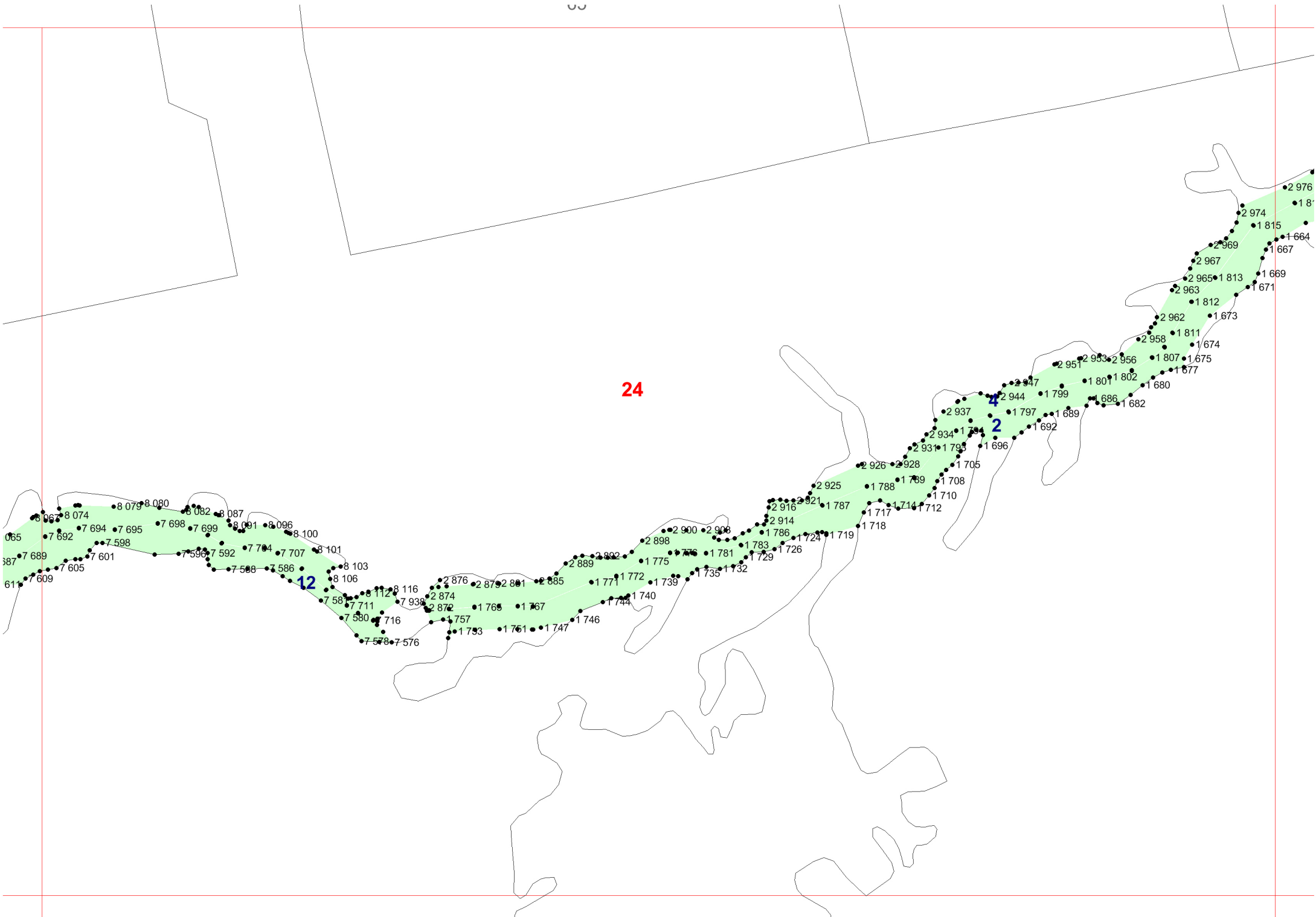

24

12

4

2

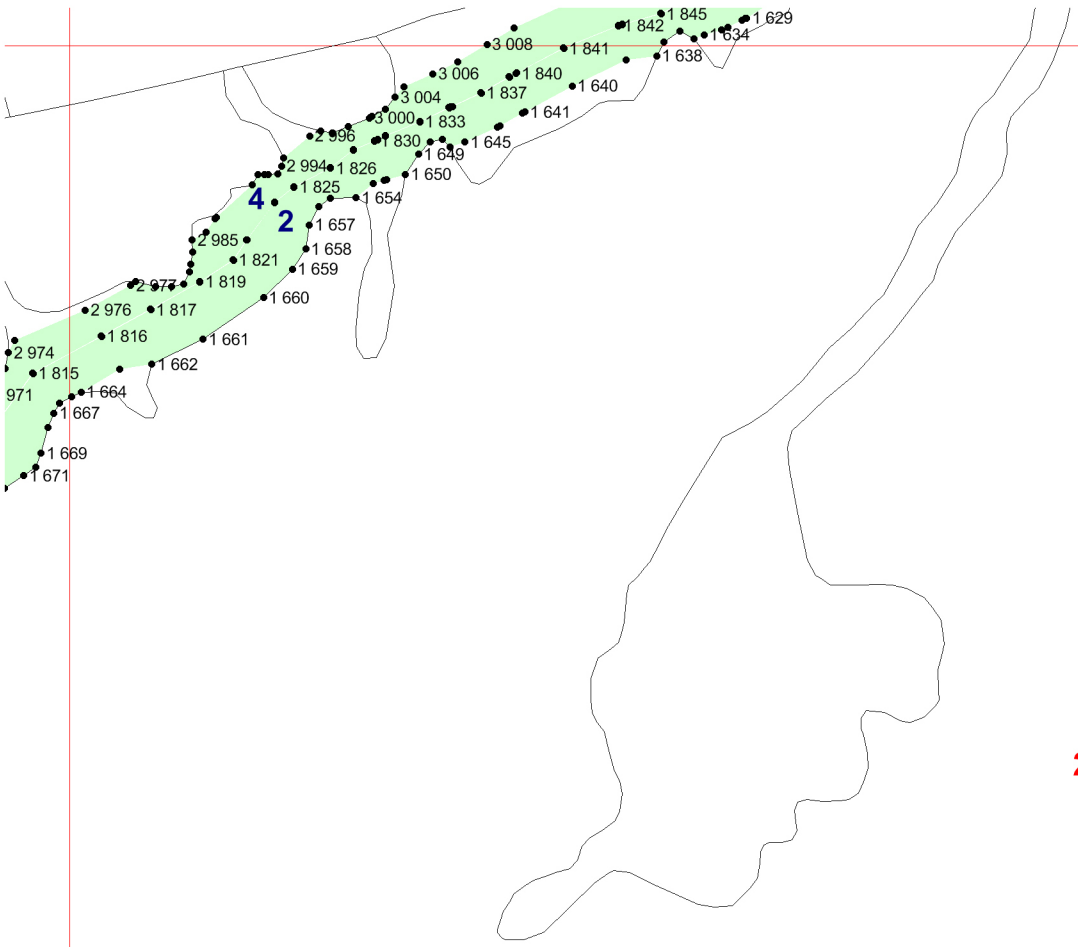

25

26

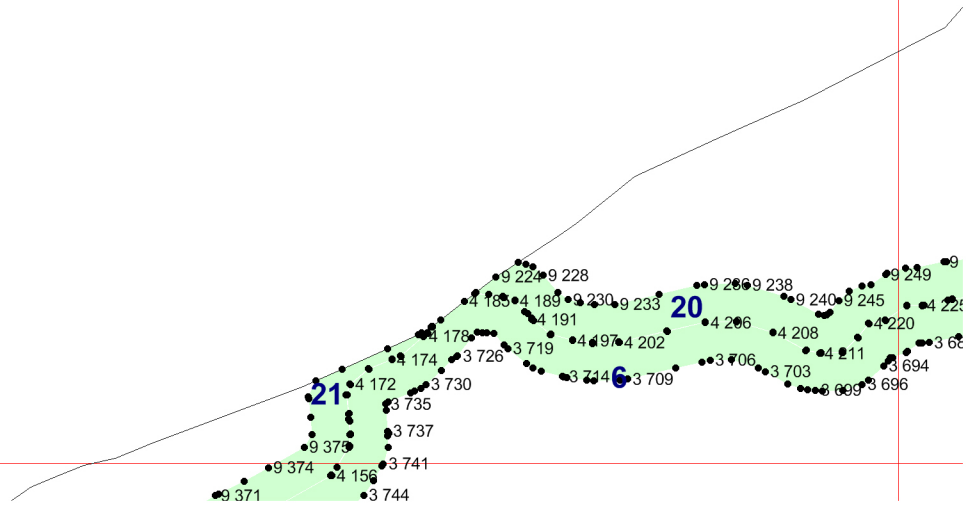

27

27

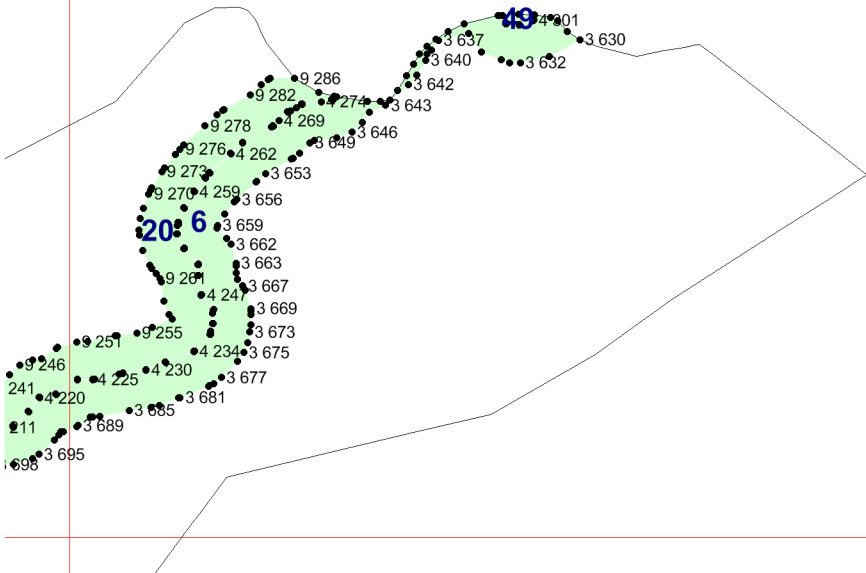

28

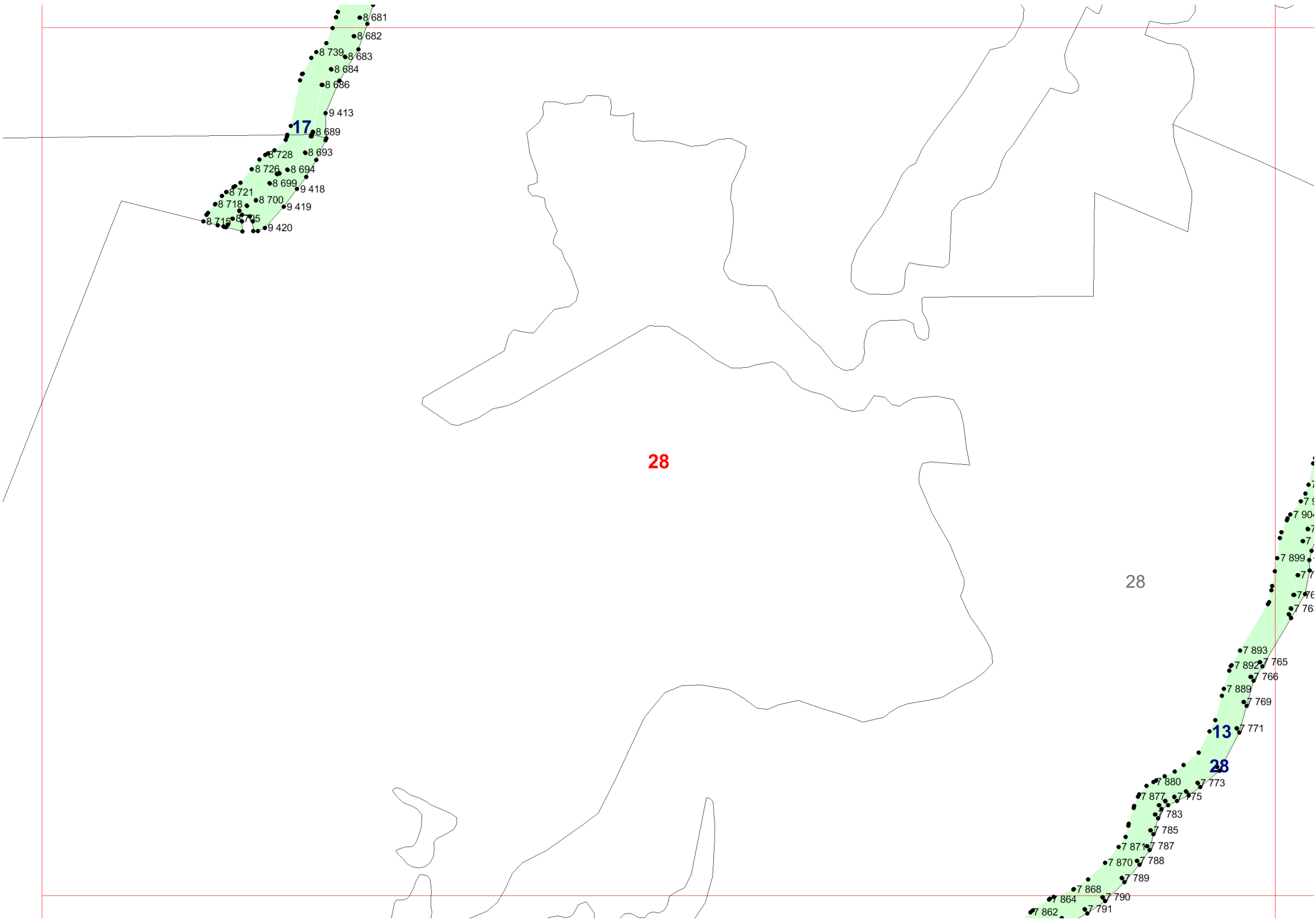

28

17

13

28

28

29

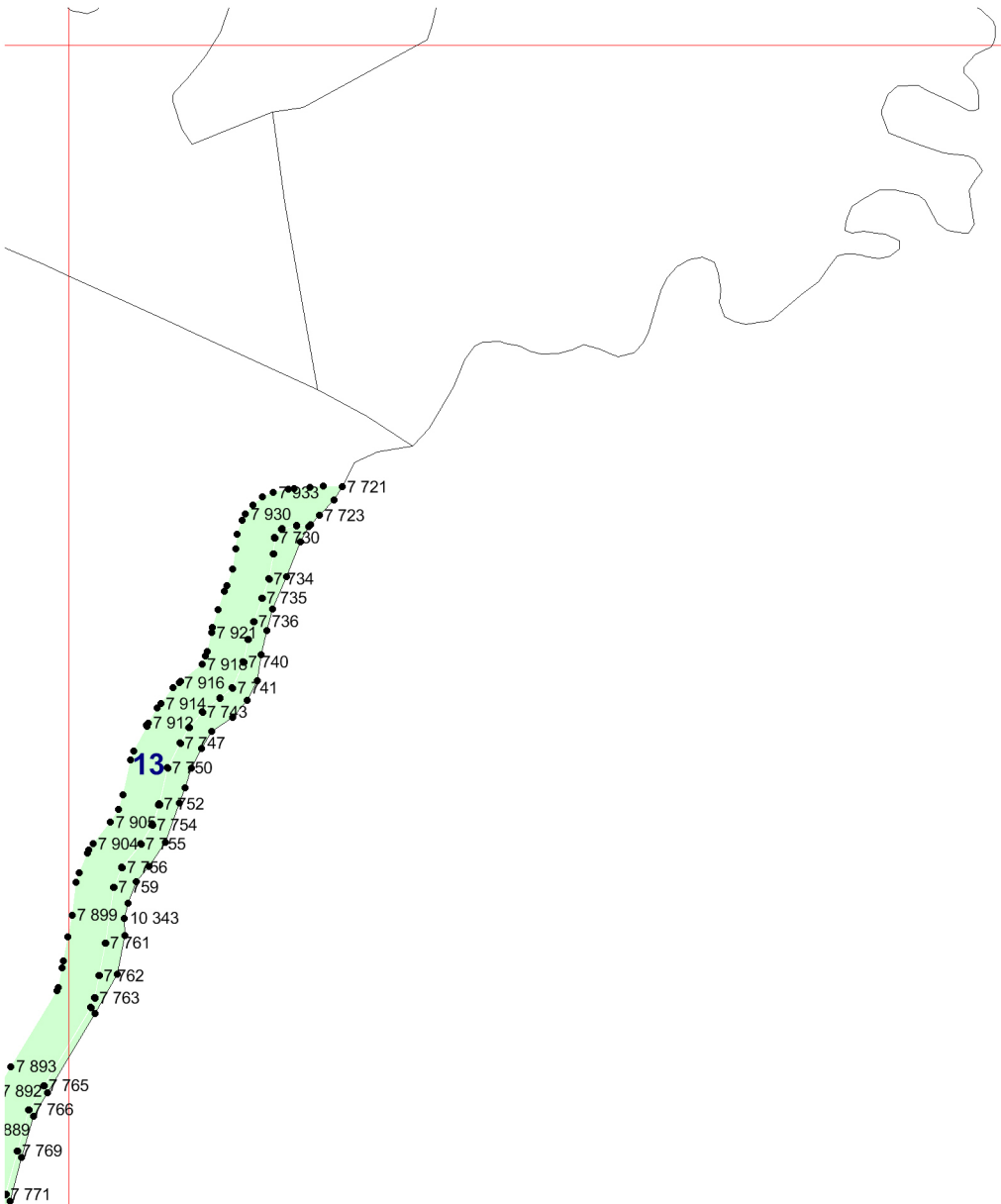

29

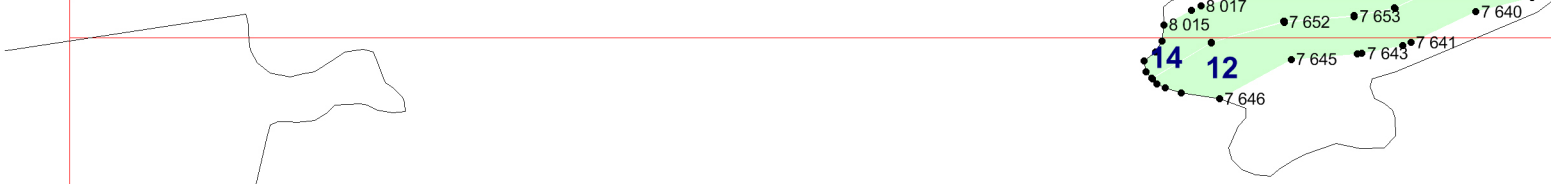

30

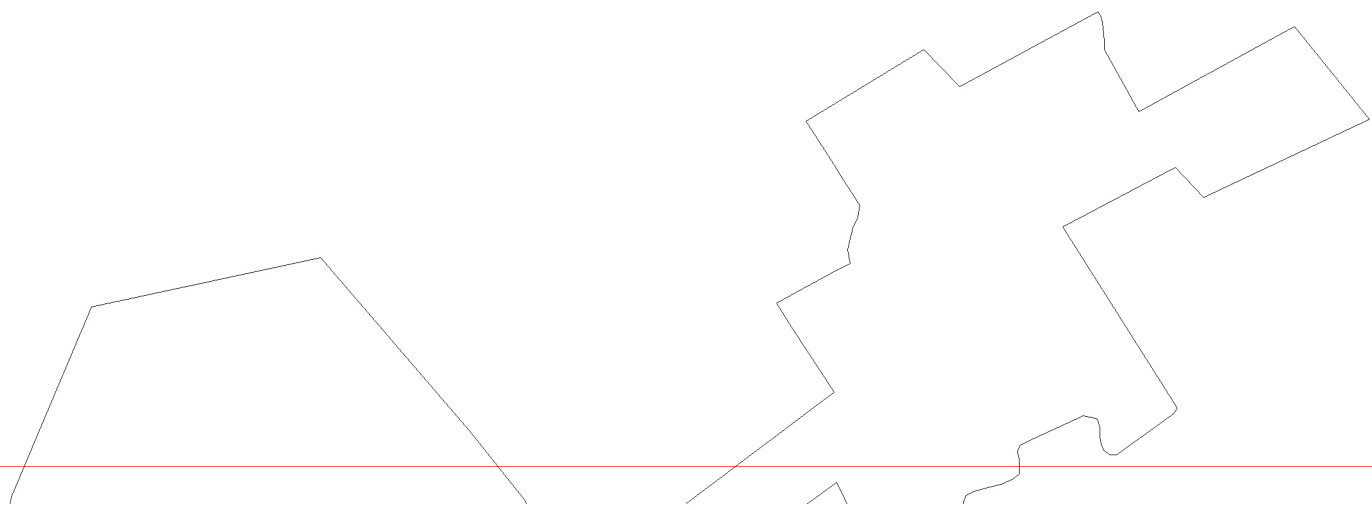

31

31

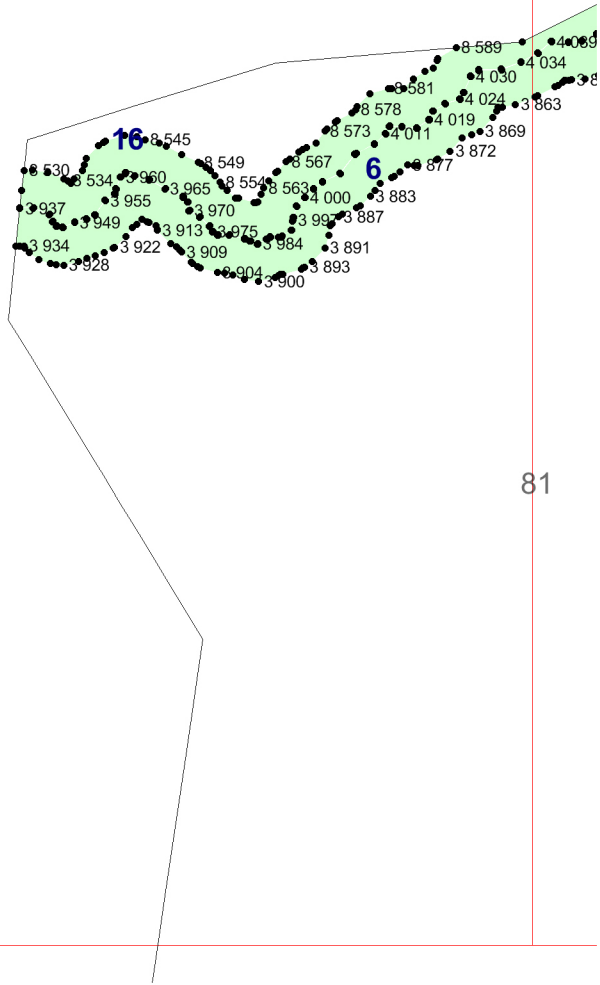

81

32

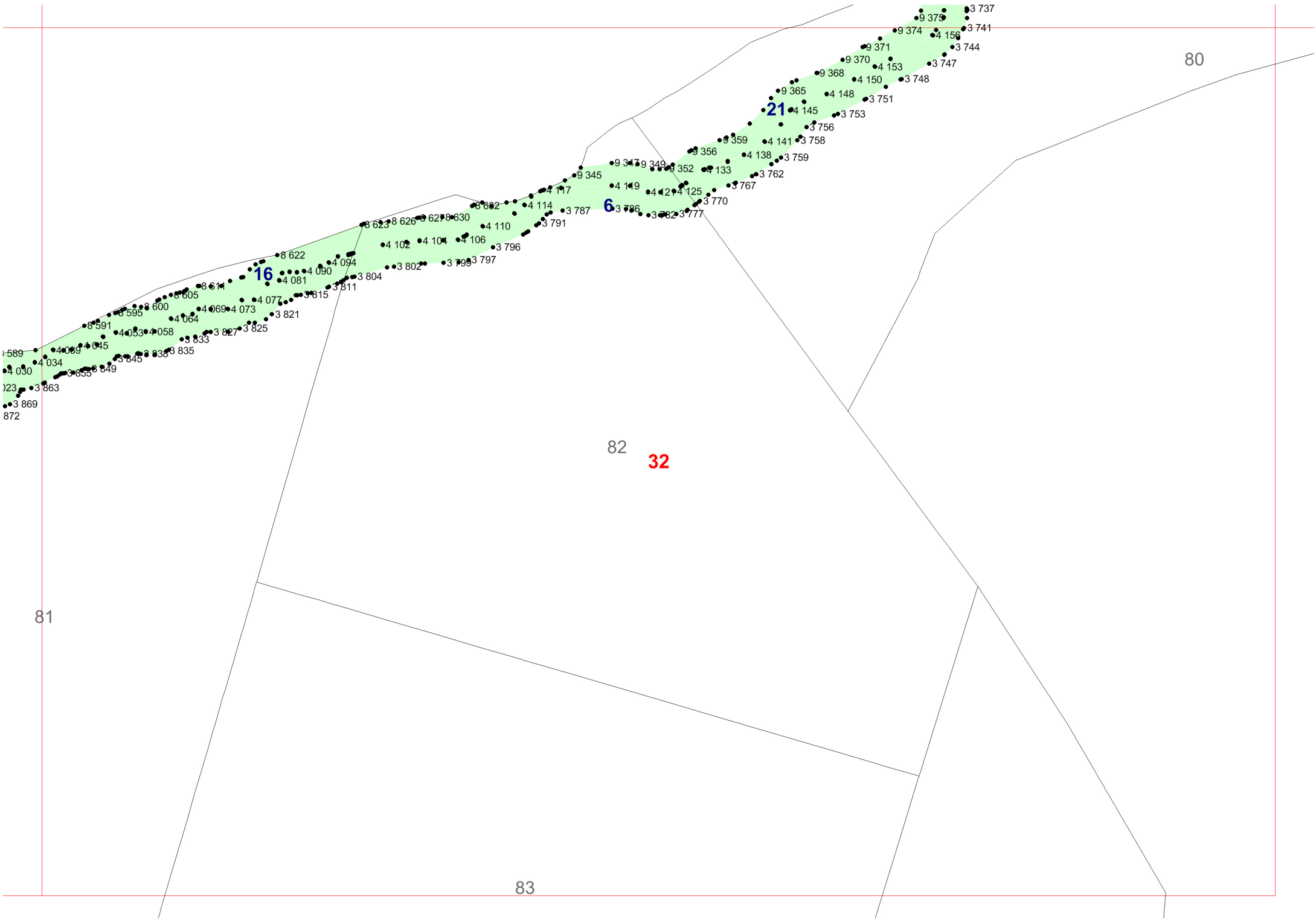

589
4030
223
3869
872

81

83

16

6

82

32

21

80

33

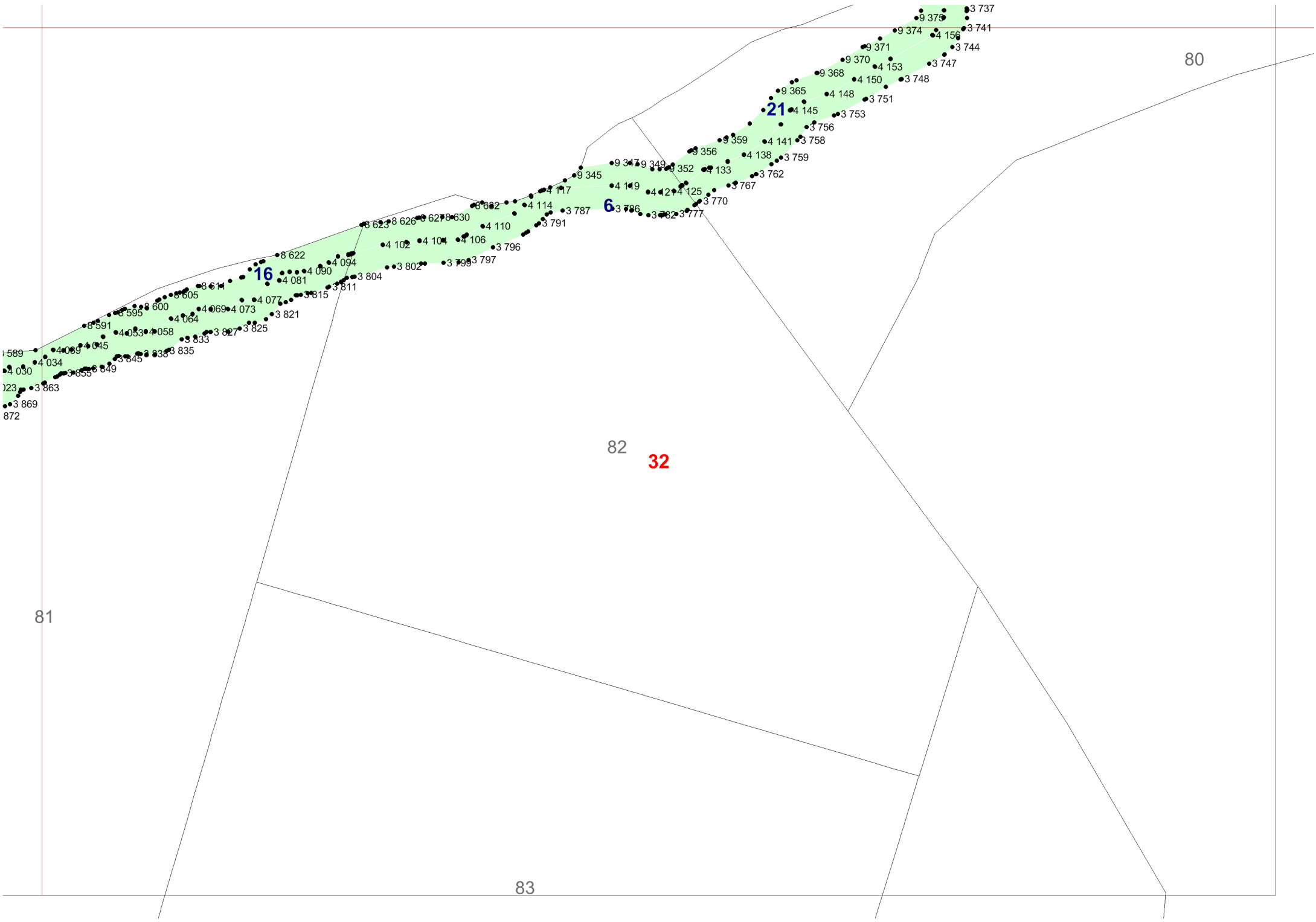

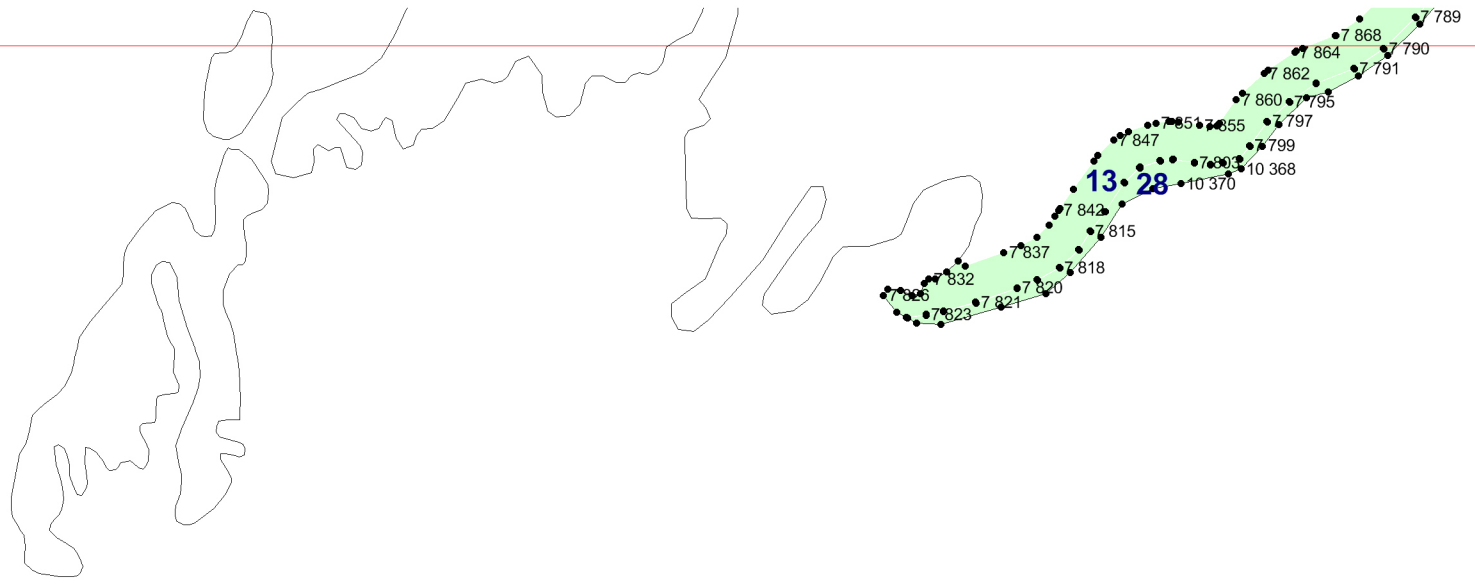

33

