

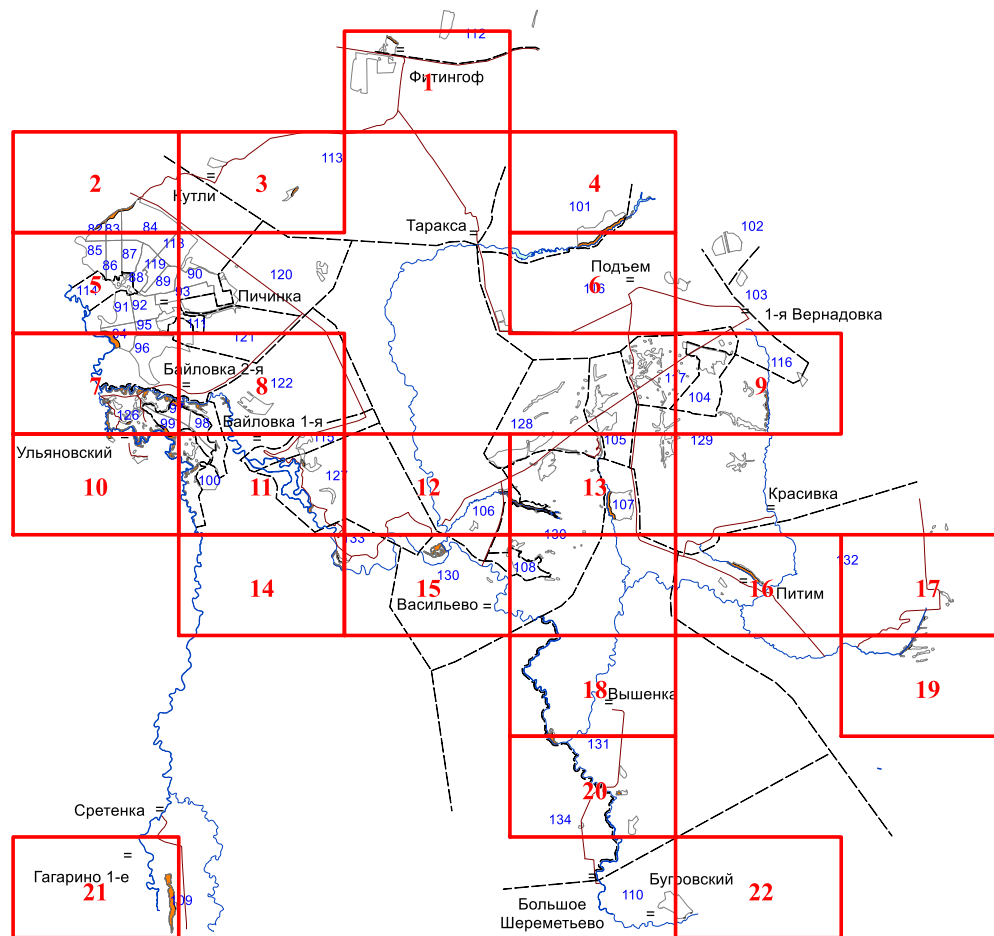





**Графическое описание местоположения границ земель,
на которых располагаются леса, расположенные в
водоохранных зонах,
на территории
Пичаевского участкового лесничества
Вернадского лесничества
Тамбовской области**



Условные обозначения:

-  - лесной квартал
-  - лист формата
- - населенные пункты
-  - реки
-  - дороги
-  - леса, расположенные в водоохранных зонах

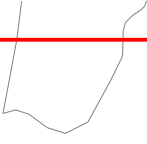

1
69 12 4 3 5
65 53 52 6 7 8
63 54 50 51 3 4 10
46 37 35 36 12
35 29 30 17
27 20 18

112

113

1

2

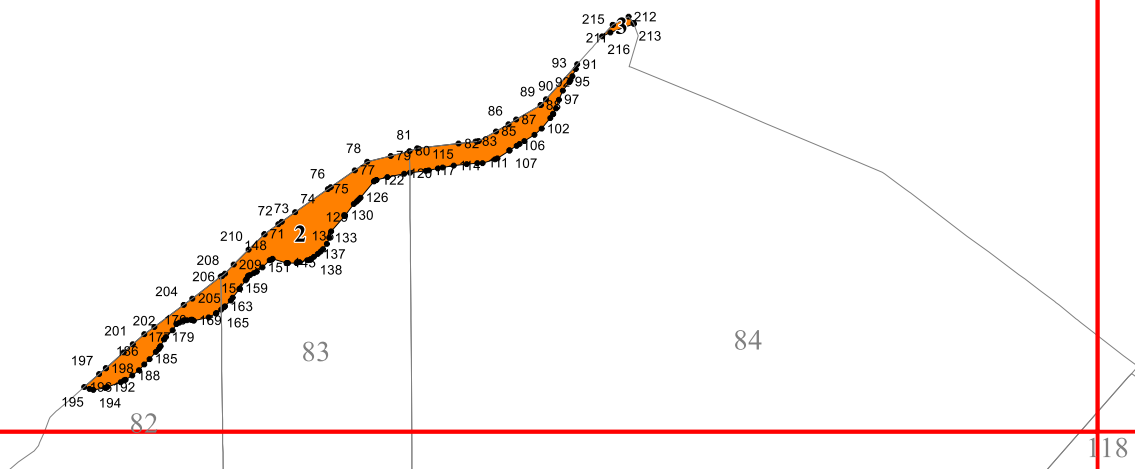

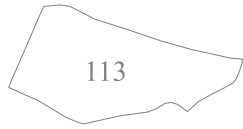

3

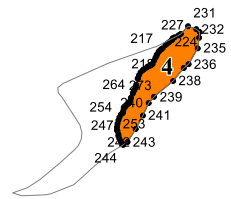

84

118

4

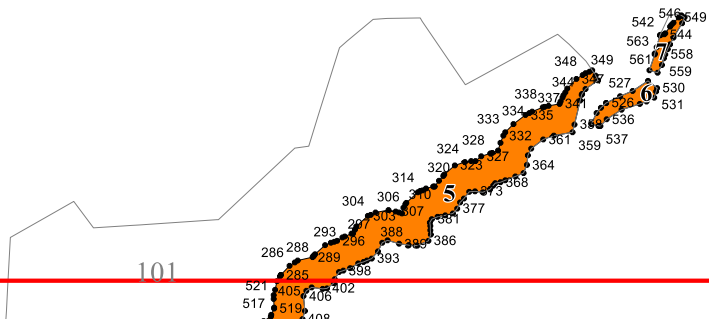

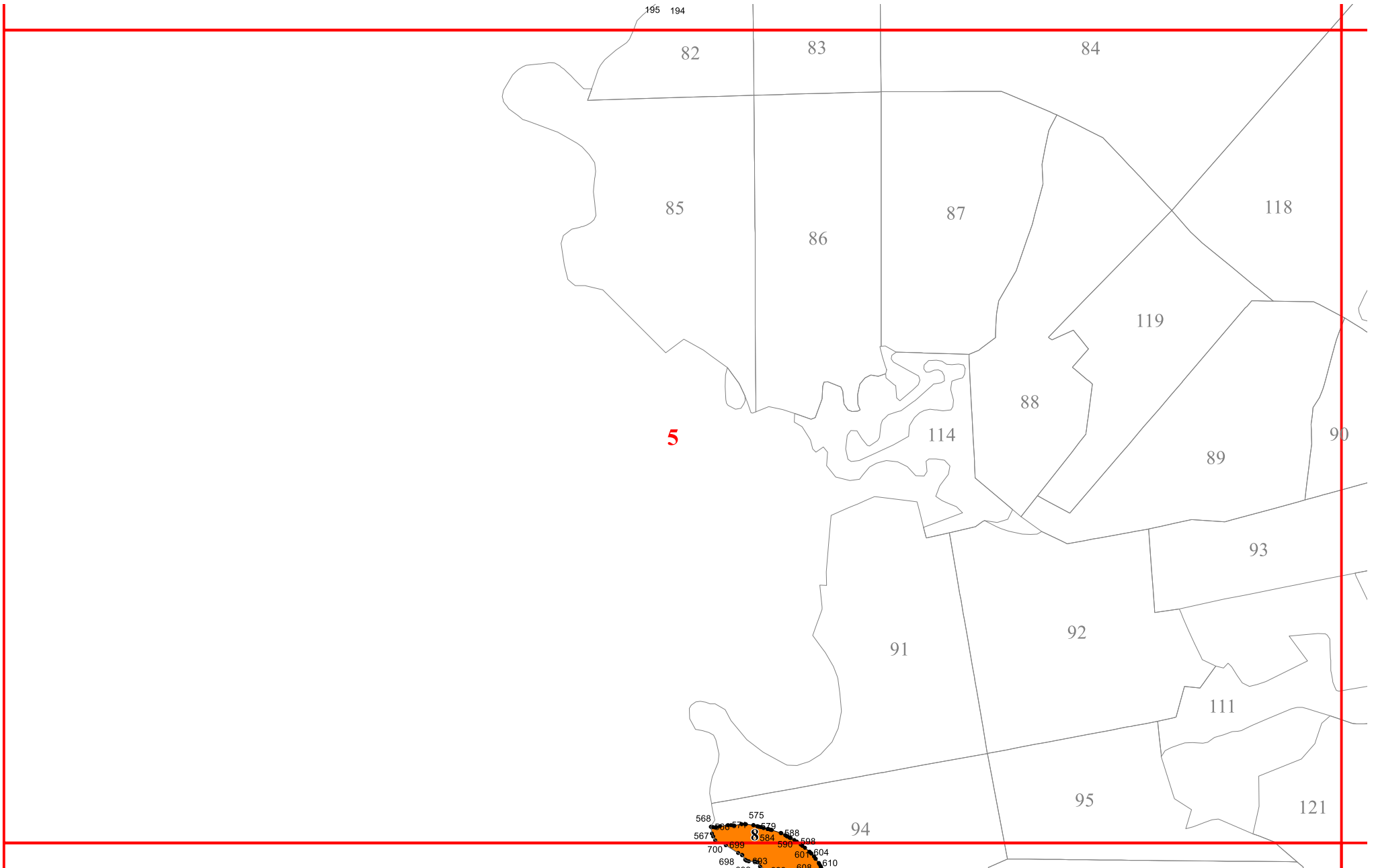

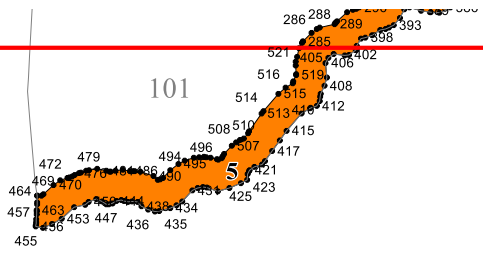
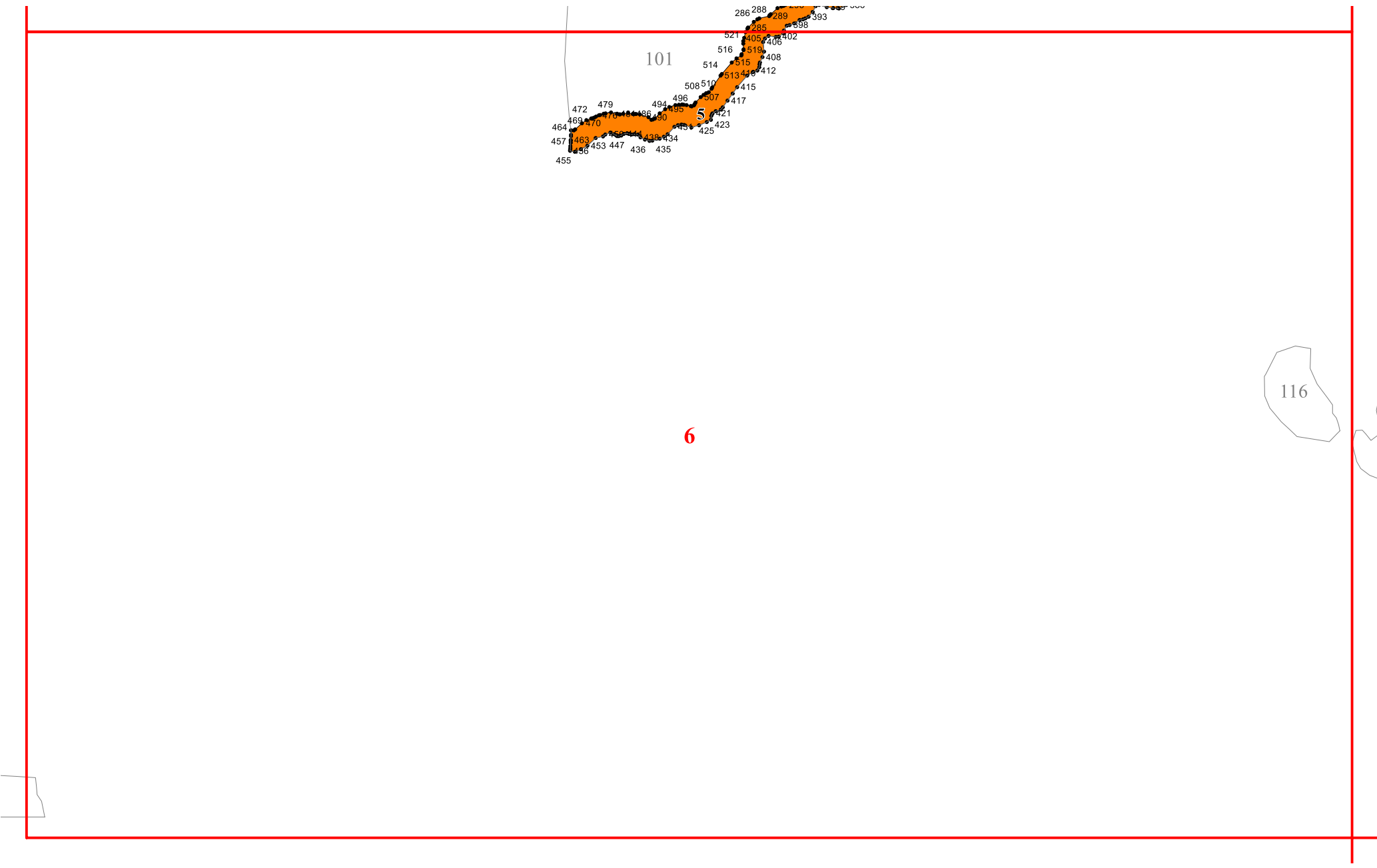

6

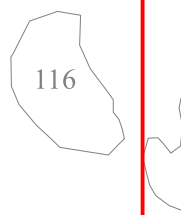

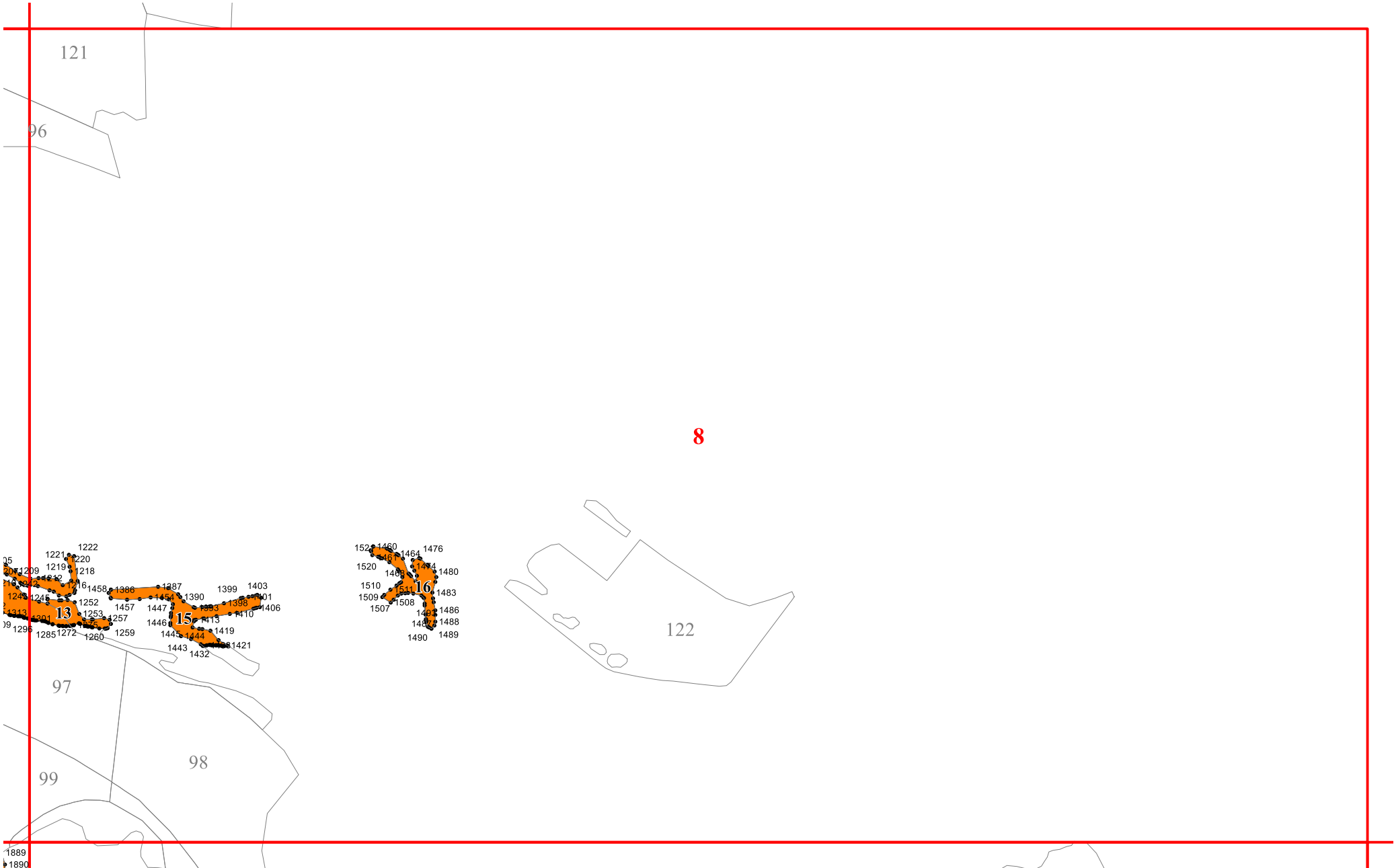

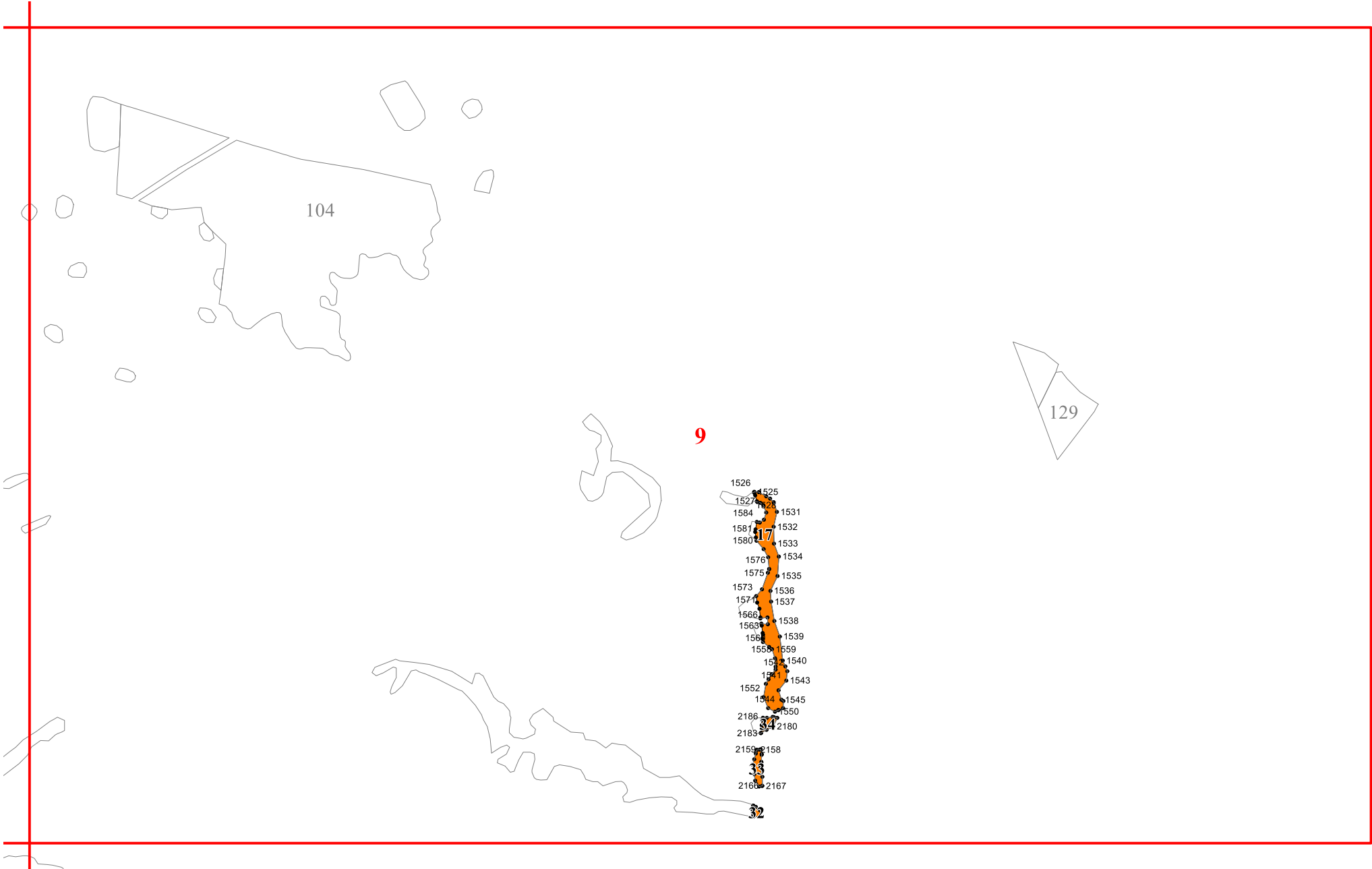

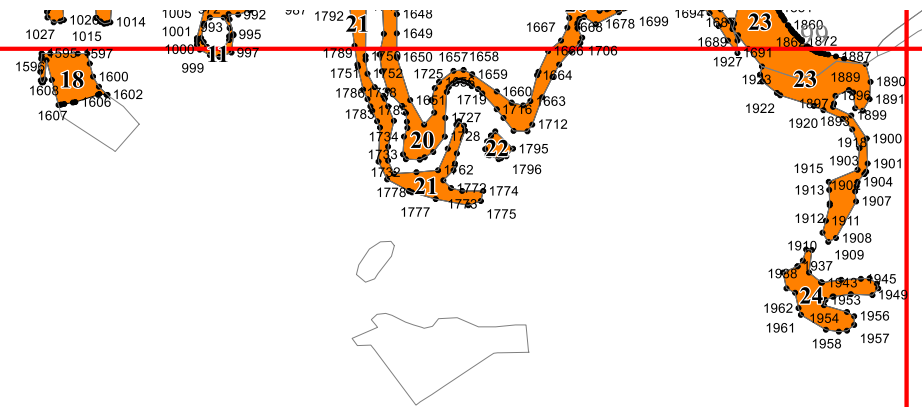

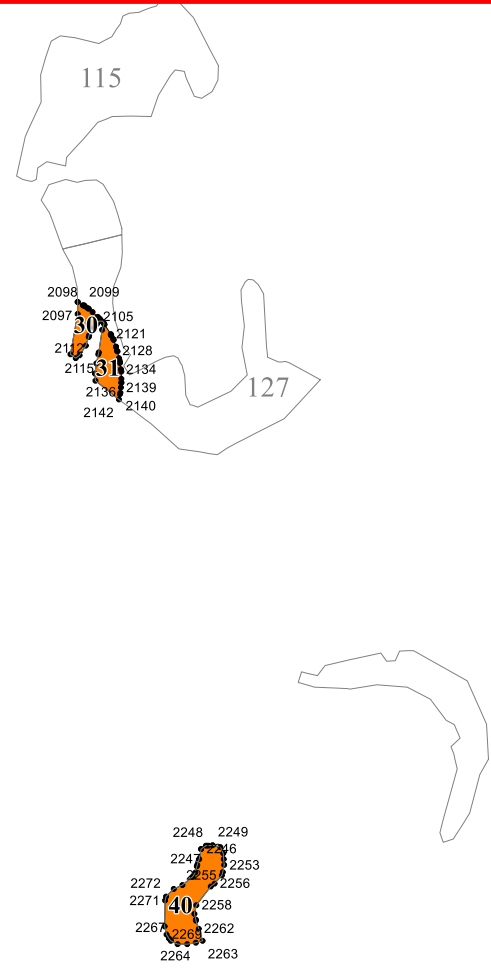
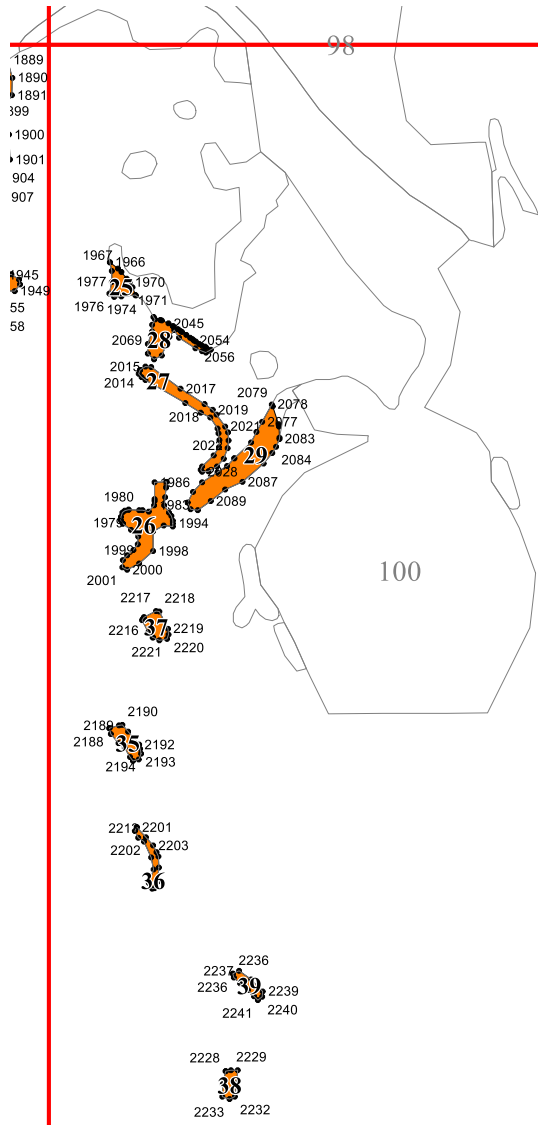

12

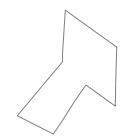
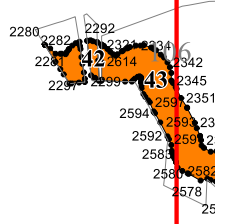
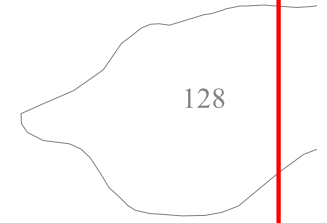

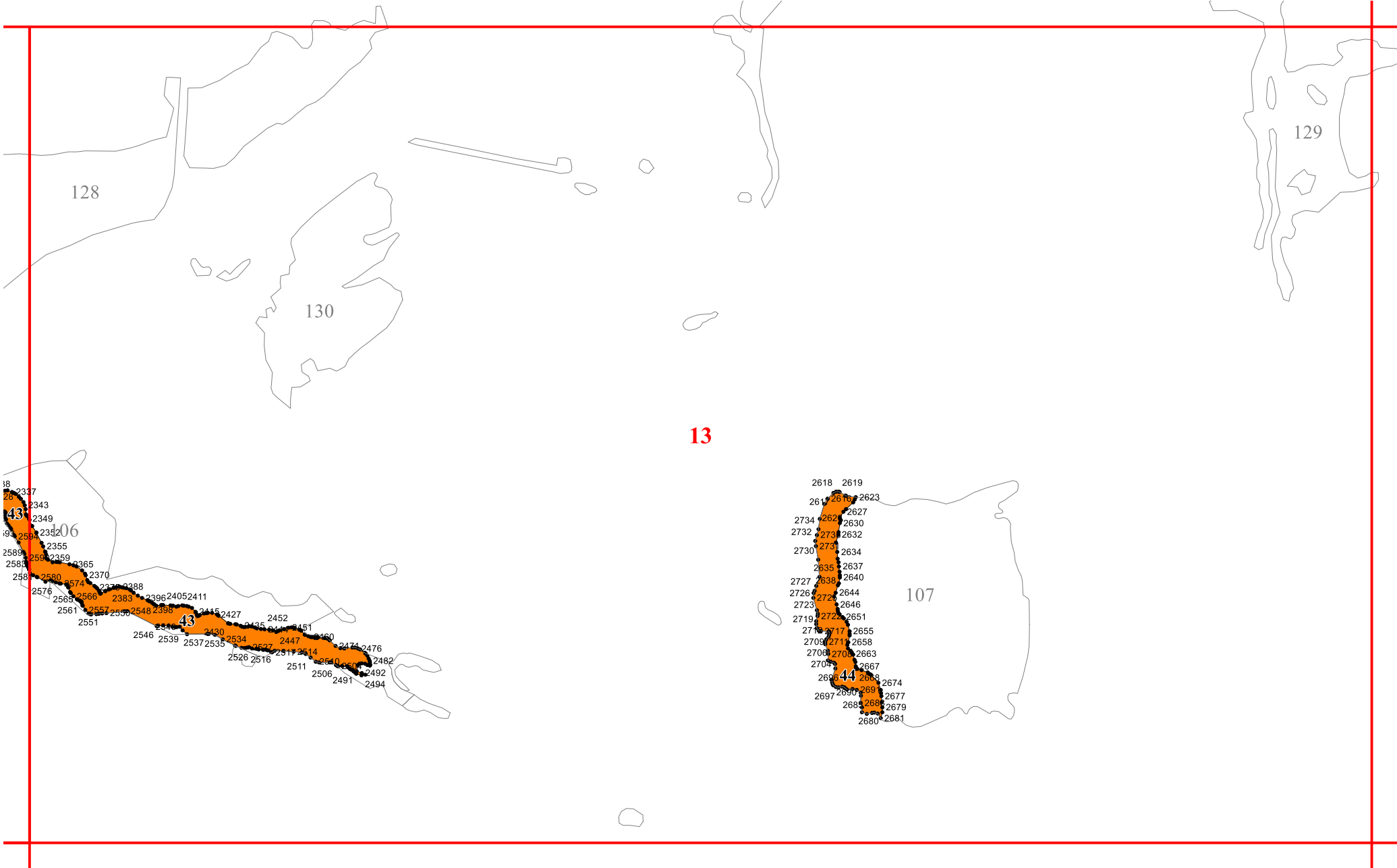

2738 2739
2795 2737
2789 2745
2801 2802 2749
2796 2797 2754
2798 2755 2759
2764 2764
2764 2775 2828
2860 2804 2780 2780
2805 2806 2809 2812 2840
2856 2814 2841
2844 2843
2844 2847
2848

69 2825
27 2831
11 2846
26 2841
28 2843
28 2847
48

2897 2899 2901
2894 2896 2903
2890 2893 2906
2887 2889 2901 2906
2885 2886 2909
2884 2901 2906 2909
2861 2861 2883 3011 2912
2862 2970 2863 2882 2906 2913
2967 2964 2965 2973 2923
2966 2964 2965 2929
2964 2967 2936 2932
2963

108

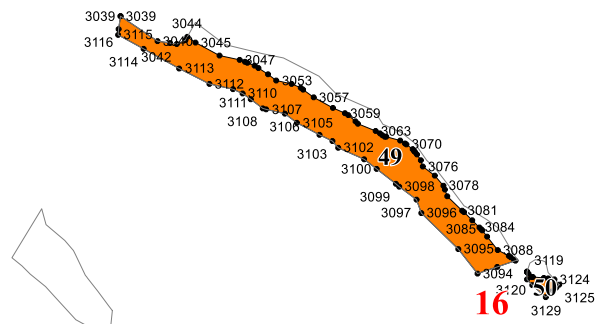

17

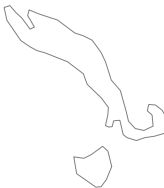

3302 3301
3300 3309
3334 3318
3325 3322
3327 3328
3330 3329
3273 3272
3295 3287
3292 3284
3291
3274 3216
3267 3217
3266 3213 3219

3340 3341
3436 3342
335 3346
3429 3430 3358
3427 3367 3367
3426 3367 3378
3425 3424 3363 3394
342 3399

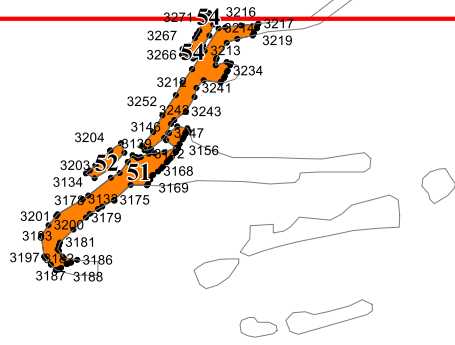

3427 3374
3426 57 3375 3382
3425 3424 3398
342 57 3400
3420 3401 3402
3417 3403 3407
3415 3410 3409

20

3438 3444
3437 3442 3454
3470 58 3460
3467 3461 3463

131

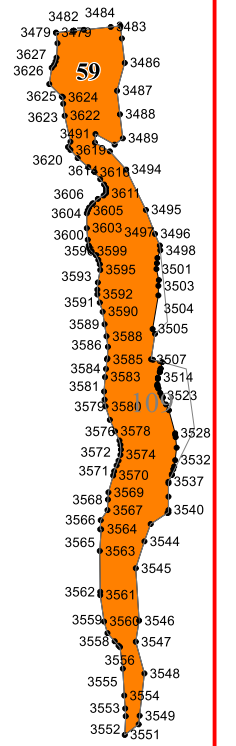

22

