

**Графическое описание местоположения границ  
земель, на которых располагаются  
эксплуатационные леса,  
на территории Присюньского участкового  
лесничества Туймазинского лесничества  
Республики Башкортостан**

Приложение № 146 к приказу Рослесхоза

от 27.02.2023

№ 201

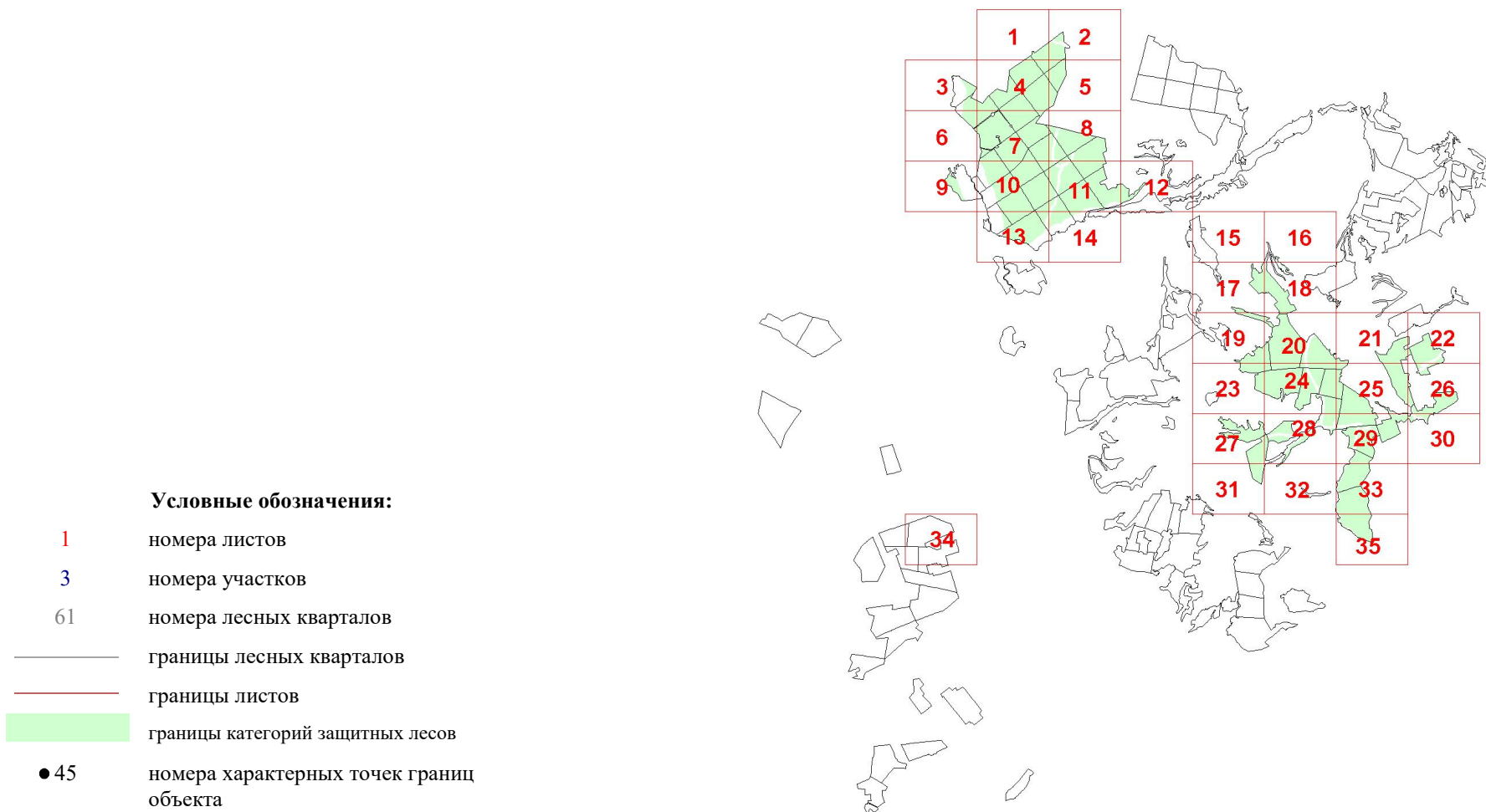

1

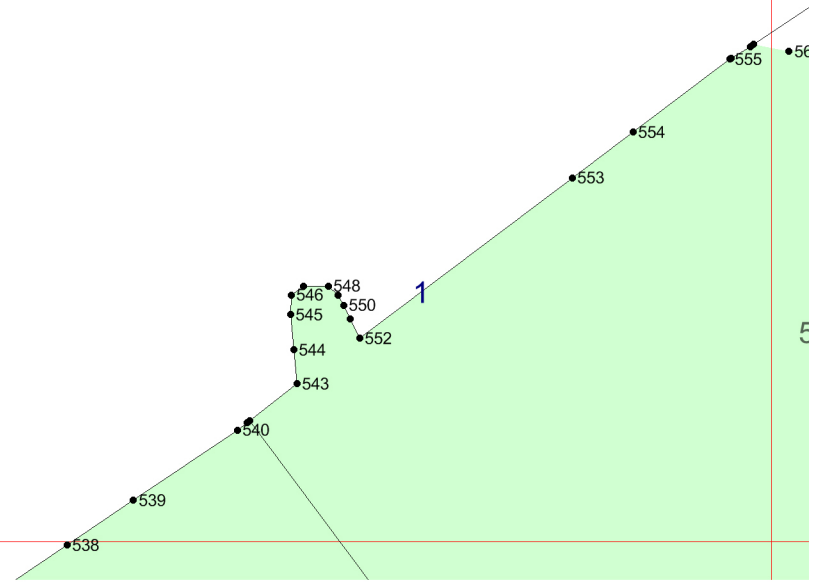

2

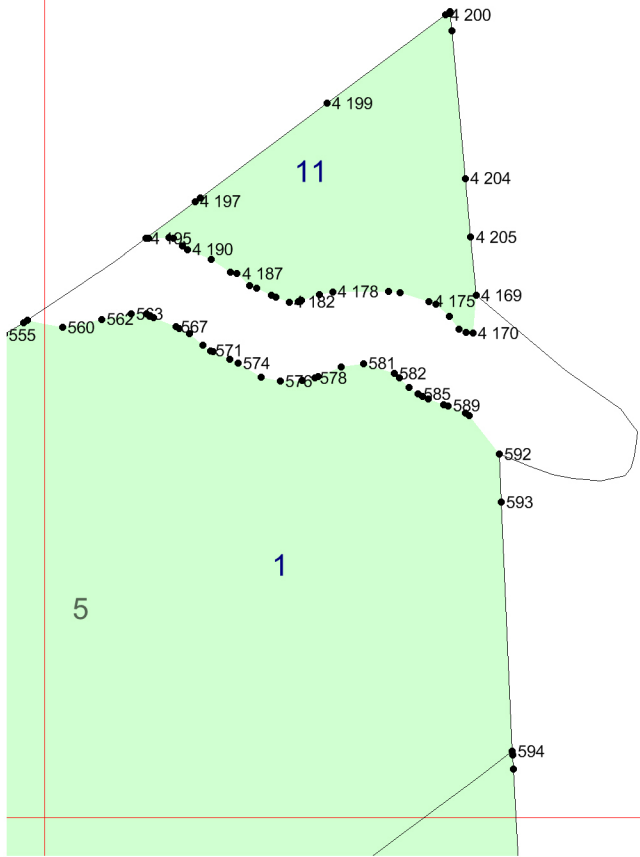

2

3

3

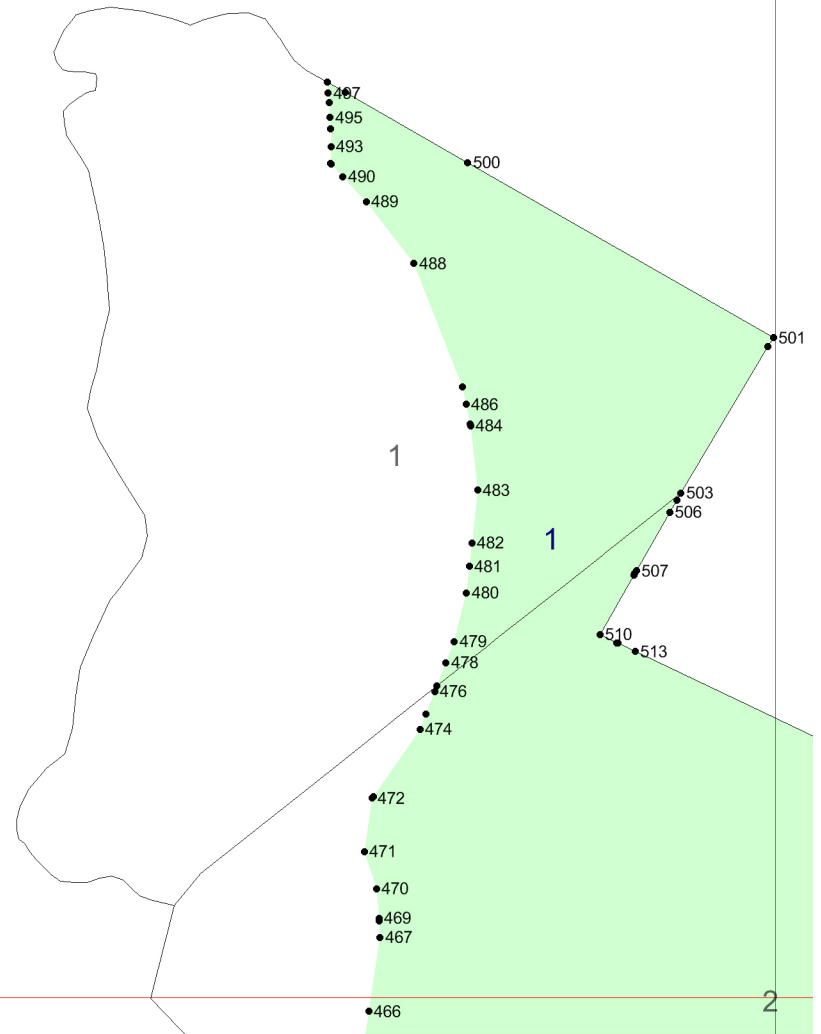

4

2

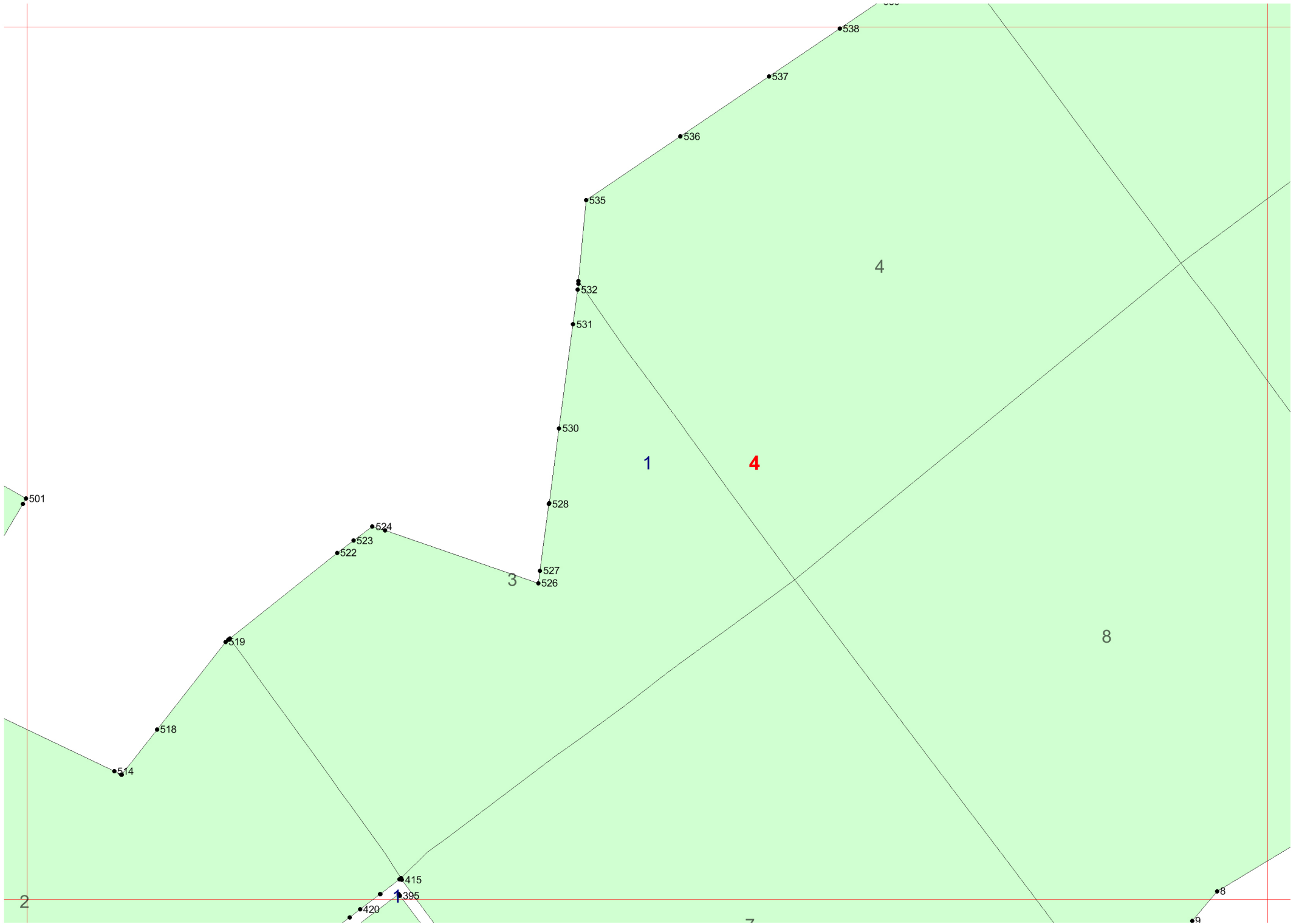

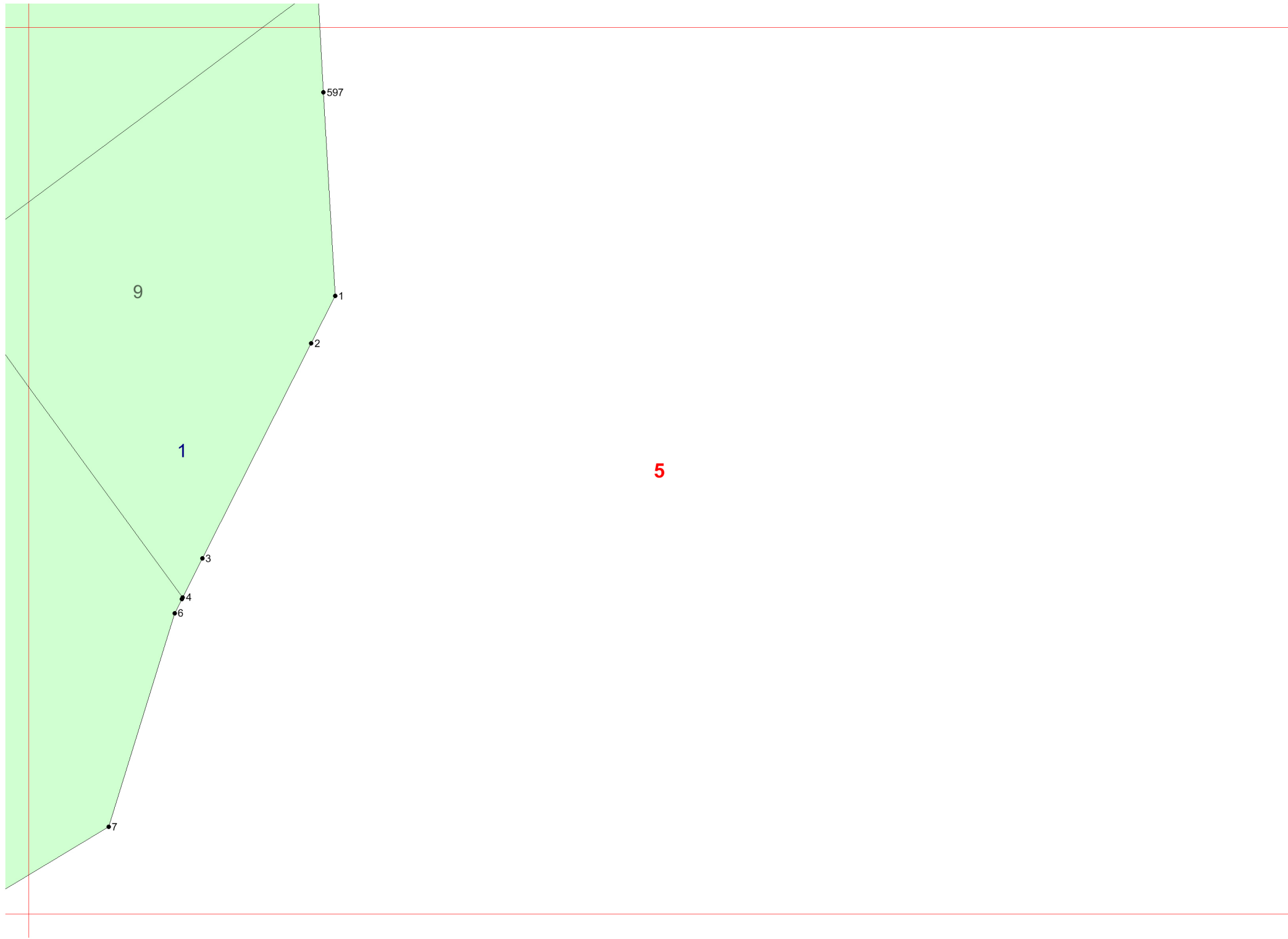

6

7

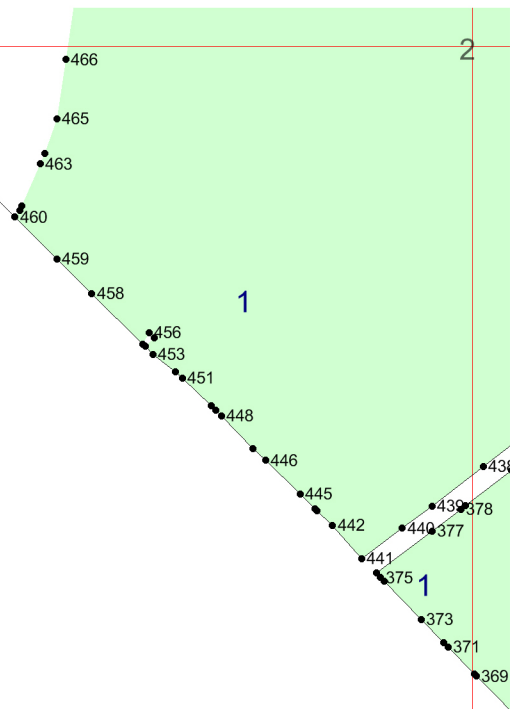

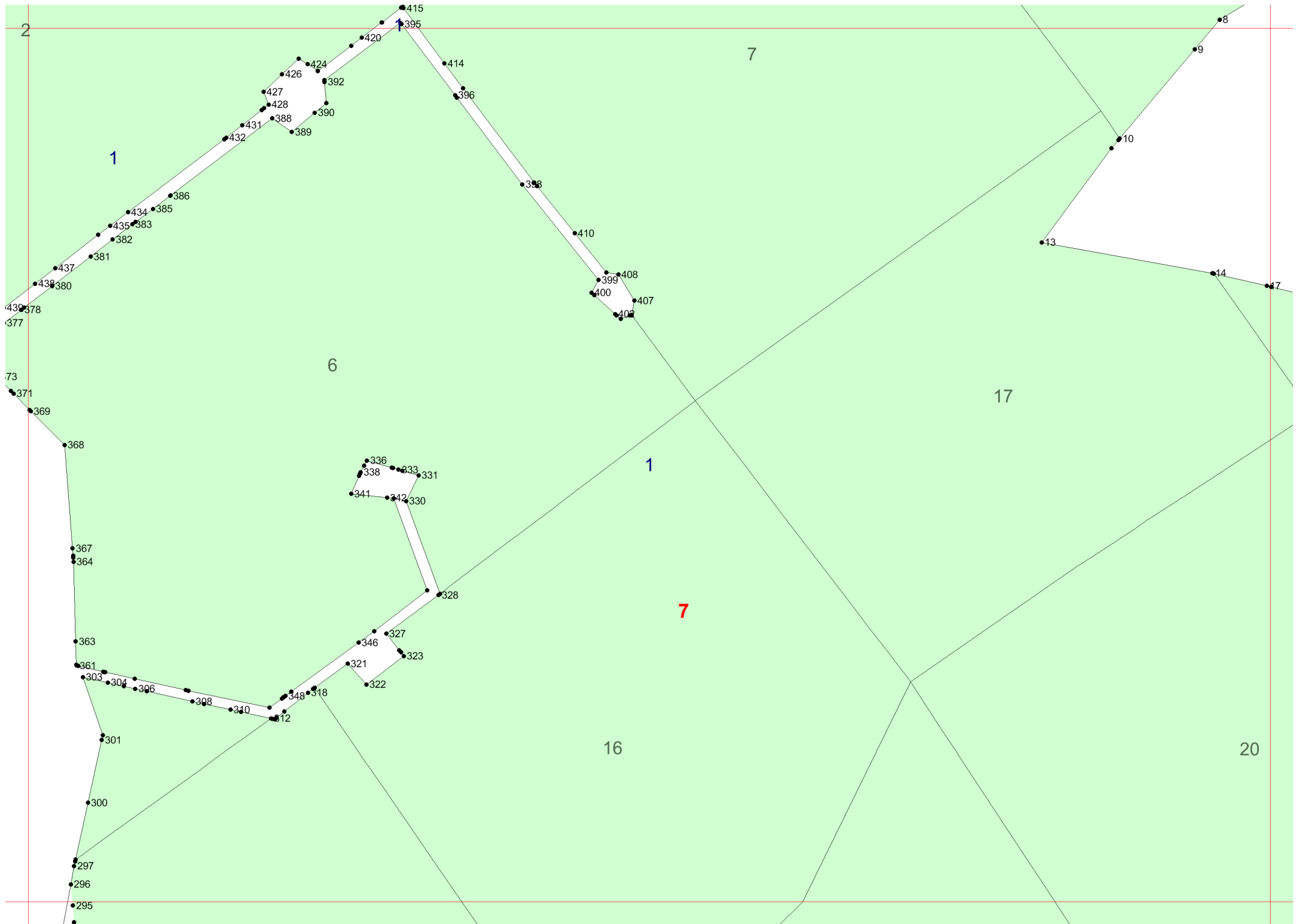

1

6

1

7

16

17

20

7

8

2

439 378  
377

73 371

369

368

367  
364

363

361

303 304

301

300

297

296

295

432

434 385

435 383

382

381

437 380

438 378

431

427

428

388

389

426

424

392

390

420

415

395

414

396

410

408

400

407

409

398

414

415

395

414

396

410

408

400

407

409

398

414

415

395

414

396

410

408

400

407

409

398

414

415

395

414

396

410

408

400

407

409

398

414

415

395

414

396

410

408

400

407

409

398

414

415

395

414

396

410

408

400

407

409

398

414

415

395

414

396

410

408

400

407

409

398

414

415

395

414

396

410

408

400

407

409

398

414

415

395

414

396

410

408

400

407

409

398

414

415

395

414

396

410

408

400

407

409

398

414

415

395

414

396

410

408

400

407

409

398

414

415

395

414

396

410

408

400

407

409

398

414

415

395

414

396

410

408

400

407

409

398

414

415

395

414

396

410

408

400

407

409

398

414

415

395

414

396

410

408

400

407

409

398

414

415

395

414

396

410

408

400

407

409

398

414

415

395

414

396

410

408

400

407

409

398

414

415

395

414

396

410

408

400

407

409

398

414

415

395

414

396

410

408

400

407

409

398

414

415

395

414

396

410

408

400

407

409

398

414

415

395

414

396

410

408

400

407

409

398

414

415

395

414

396

410

408

400

407

409

398

414

415

395

414

396

410

408

400

407

409

398

414

415

395

414

396

410

408

400

407

409

398

414

415

395

414

396

410



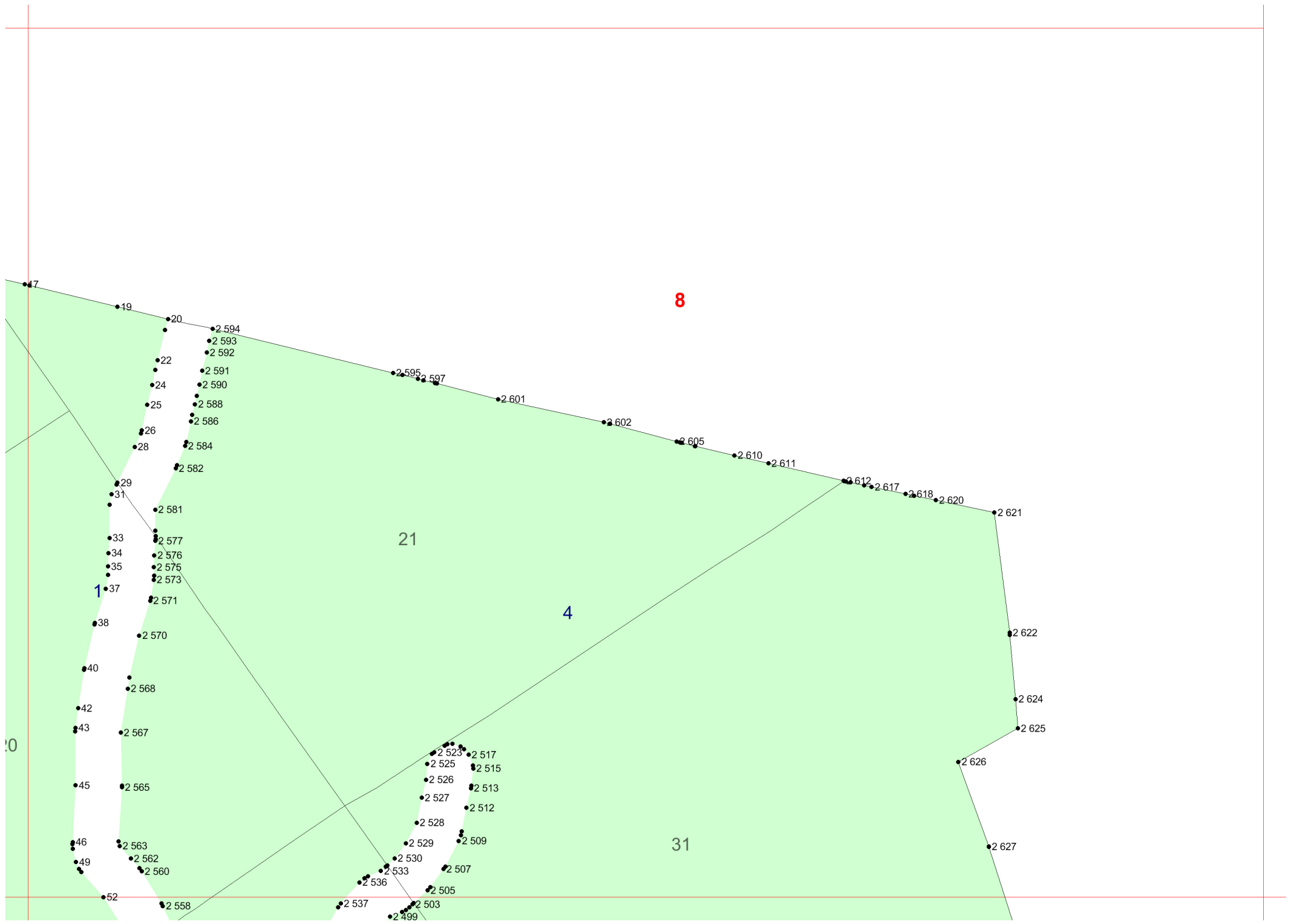

8

21

4

31

9

1

10

7

19

20

22

24

25

26

28

29

31

33

34

35

37

38

40

42

43

45

46

49

52

2594

2593

2592

2591

2590

2588

2586

2584

2582

2581

2577

2576

2575

2573

2571

2570

2568

2567

2565

2563

2562

2560

2558

2537

2536

2533

2530

2529

2528

2527

2526

2525

2523

2517

2515

2513

2512

2509

2507

2505

2503

2499

2595

2597

2601

2602

2605

2610

2611

2612

2617

2618

2620

2621

2622

2624

2625

2626

2627

9

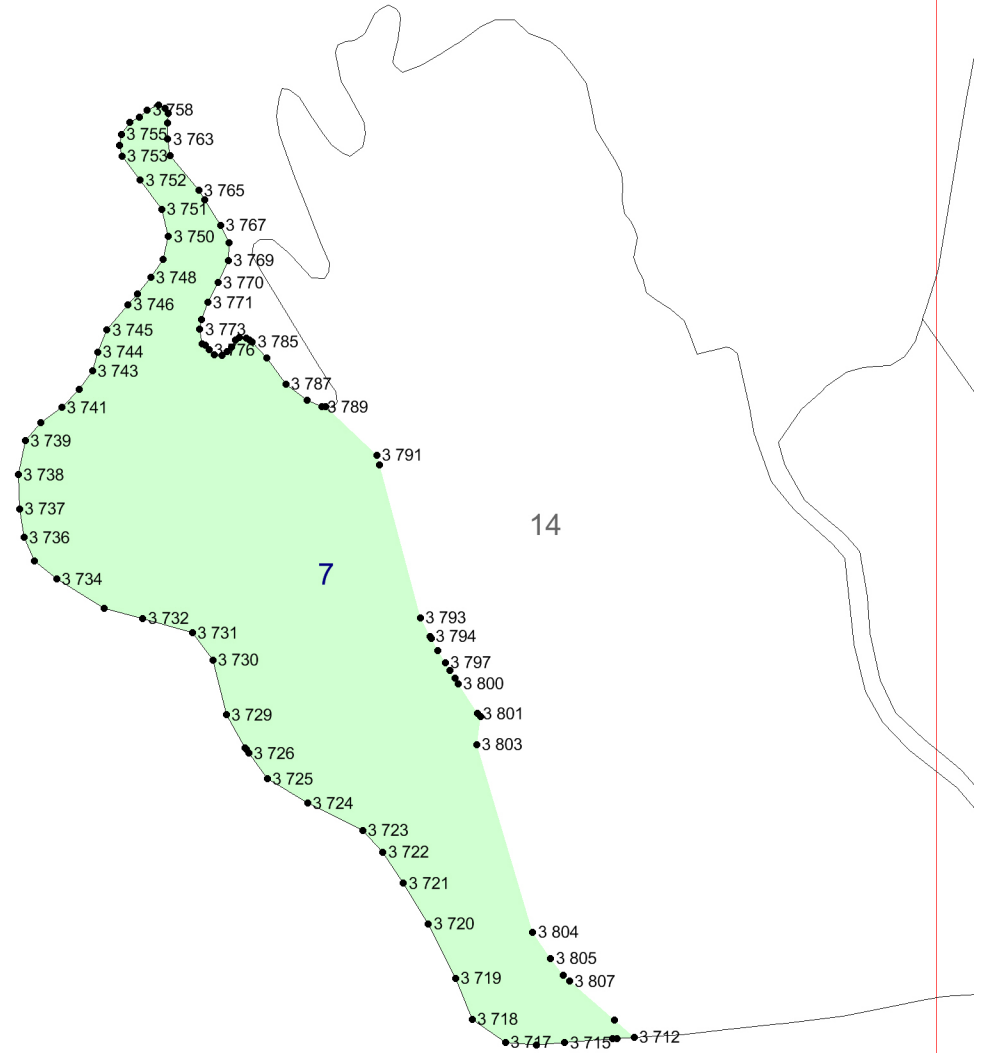

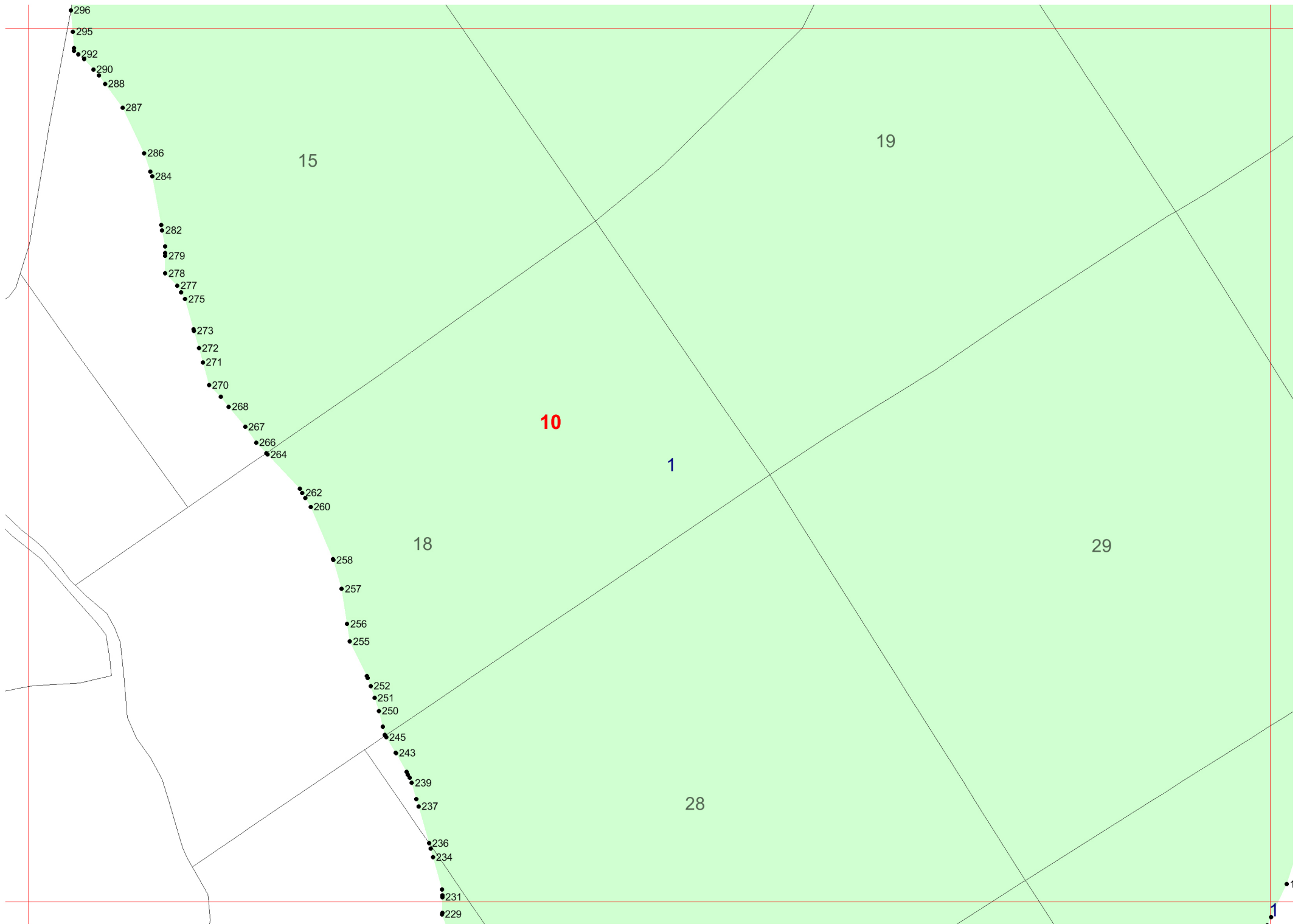

296

295

292

290

288

287

286

284

282

279

278

277

275

273

272

271

270

268

267

266

264

262

260

258

257

256

255

252

251

250

245

243

239

237

236

234

231

229

15

19

10

1

18

29

28

11

1

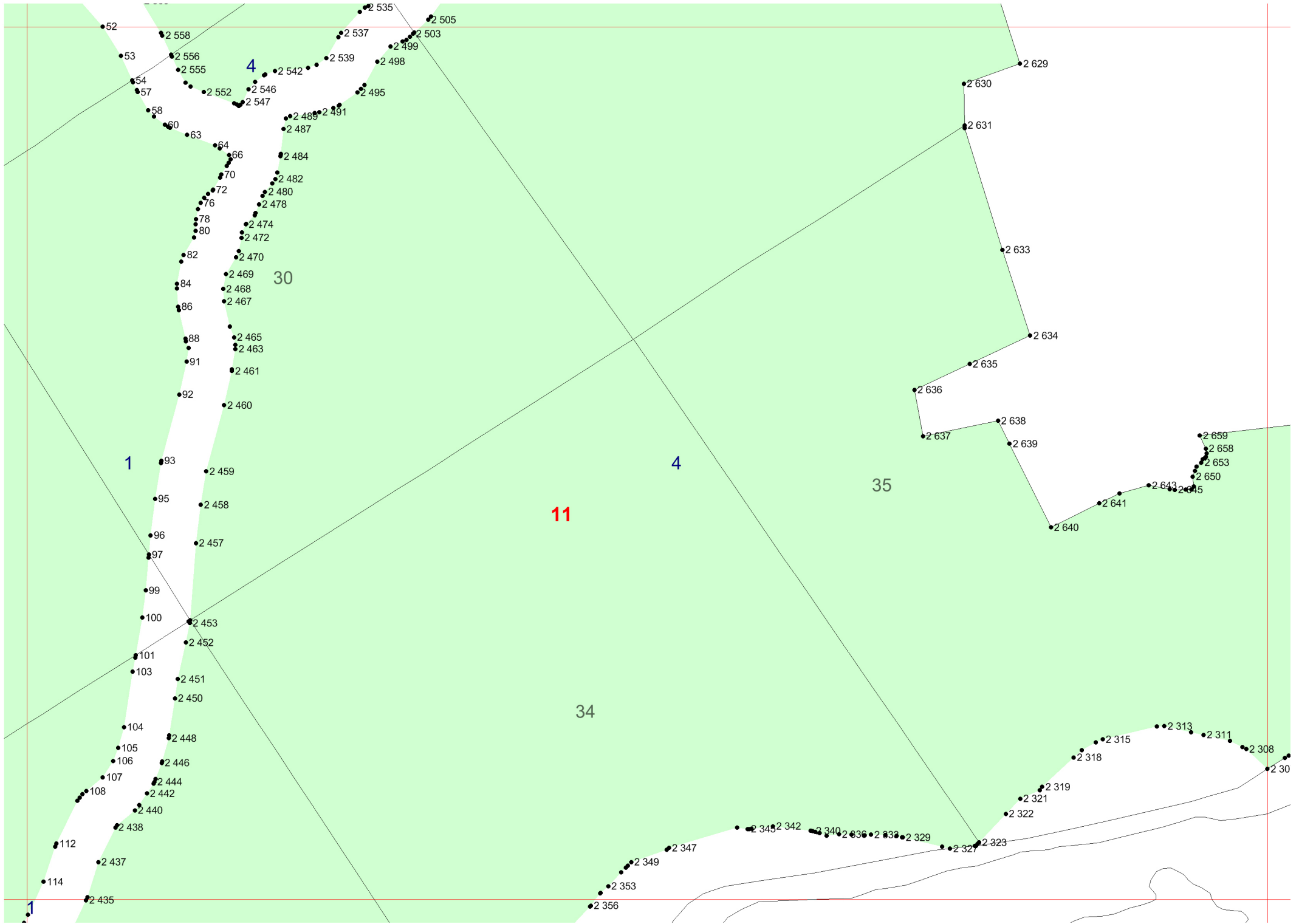

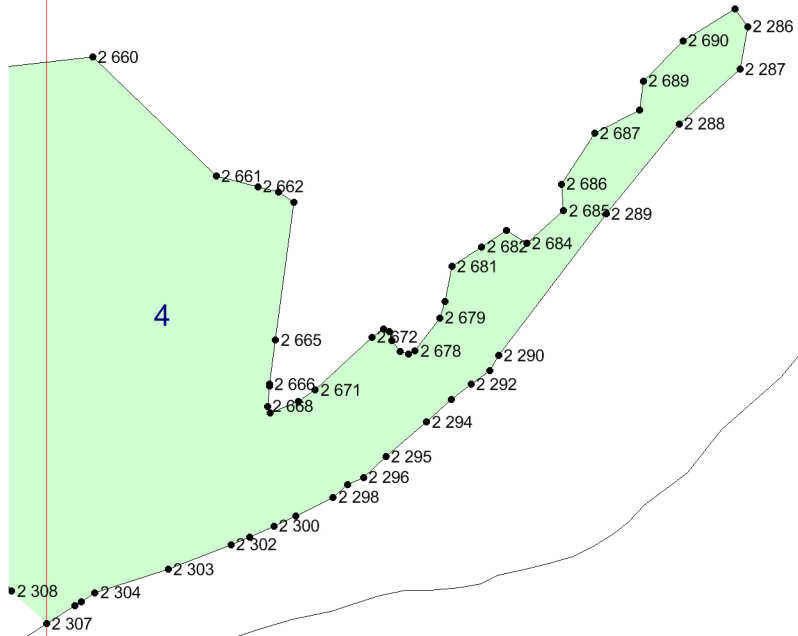
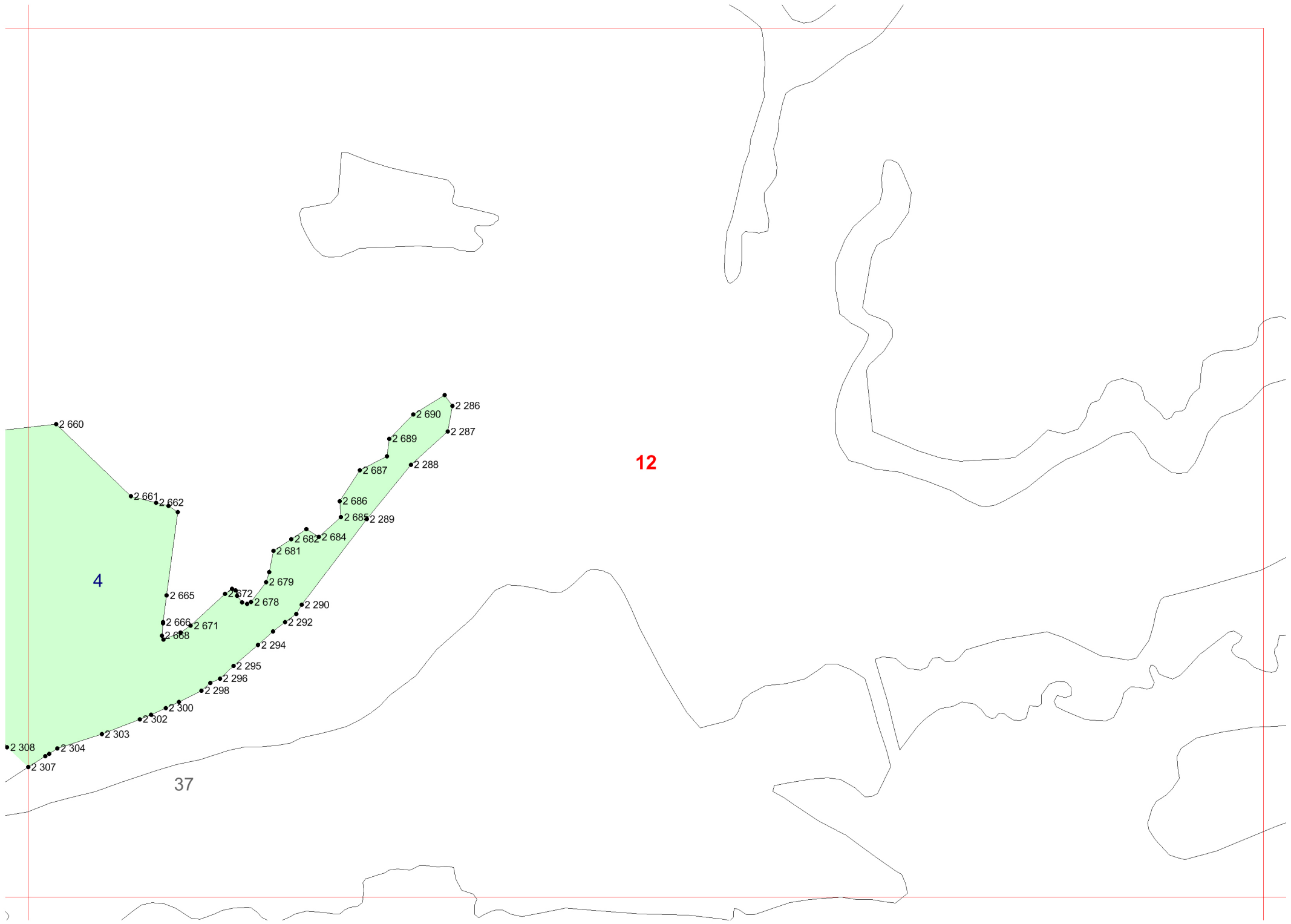

12

37

13

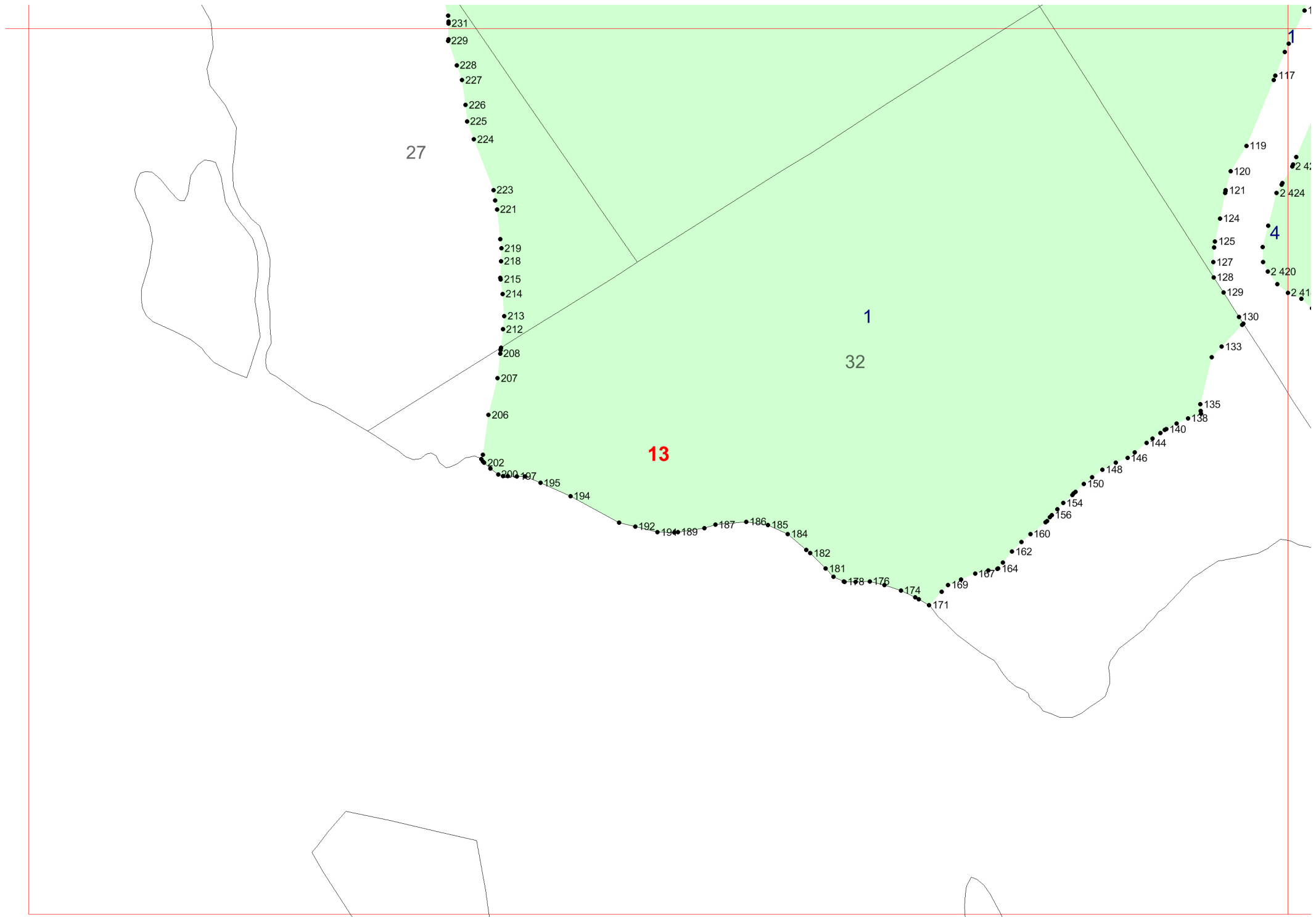

27

1

32

13

4

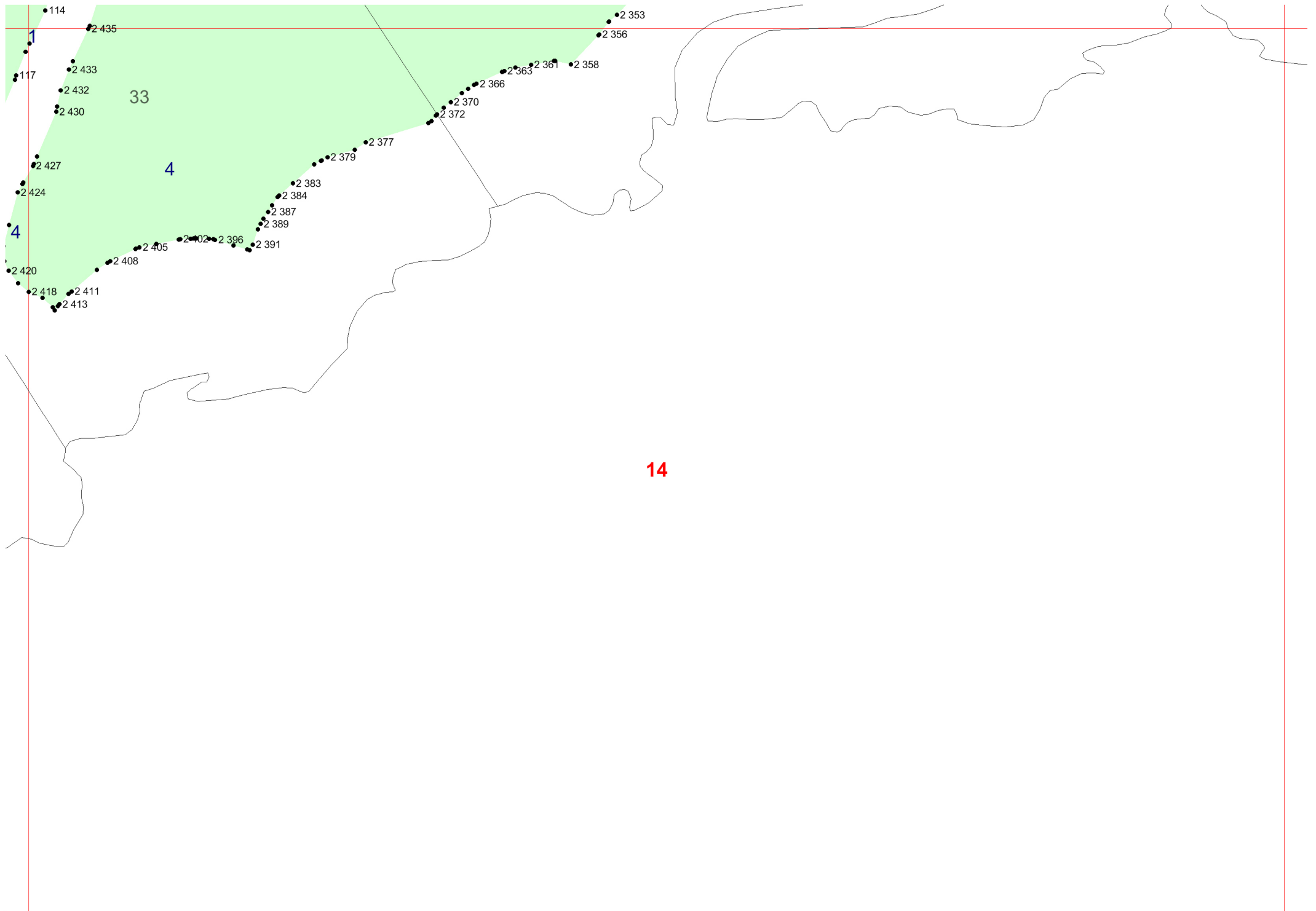

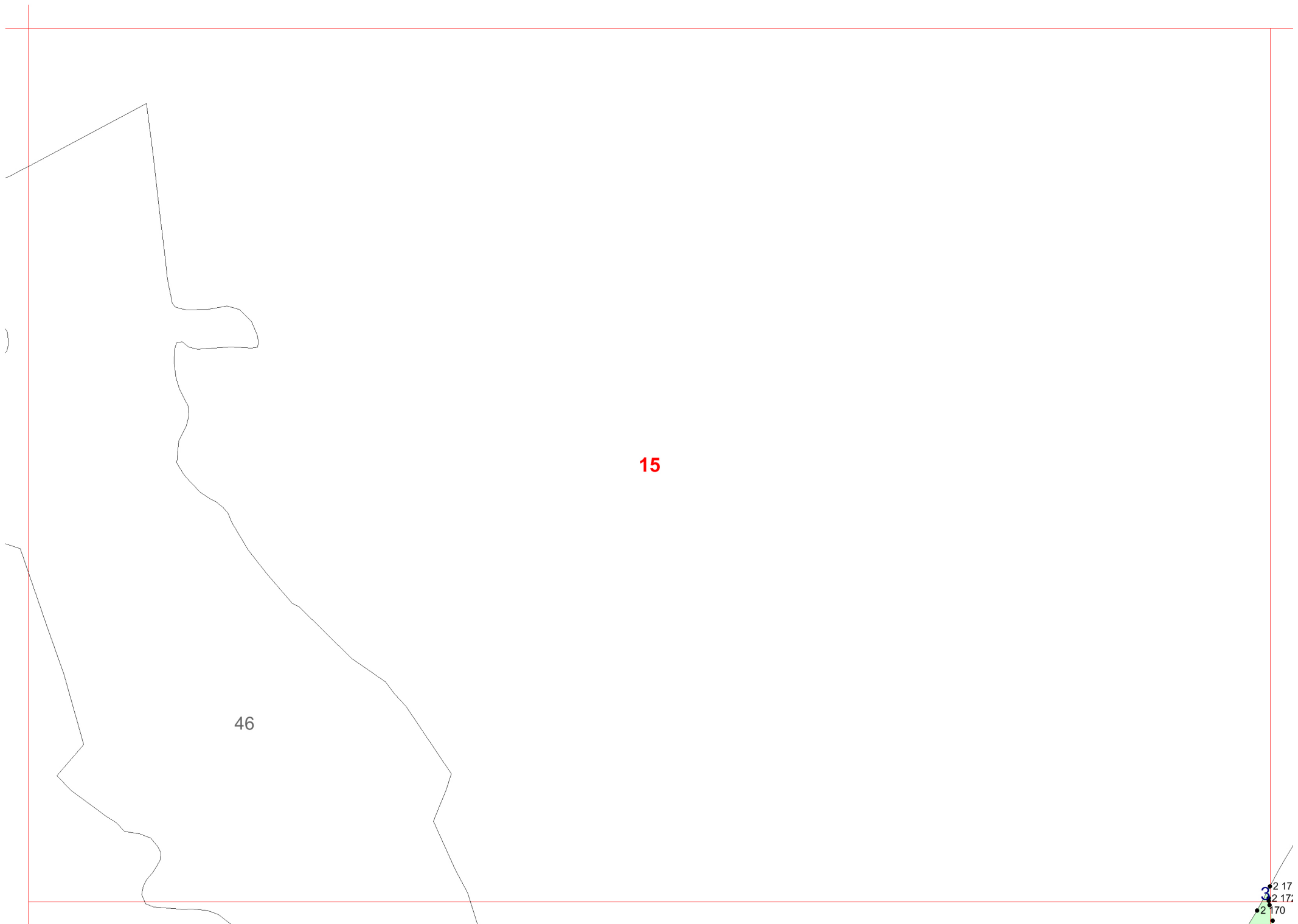

15

46

16

2 17  
2 17  
2 170



16

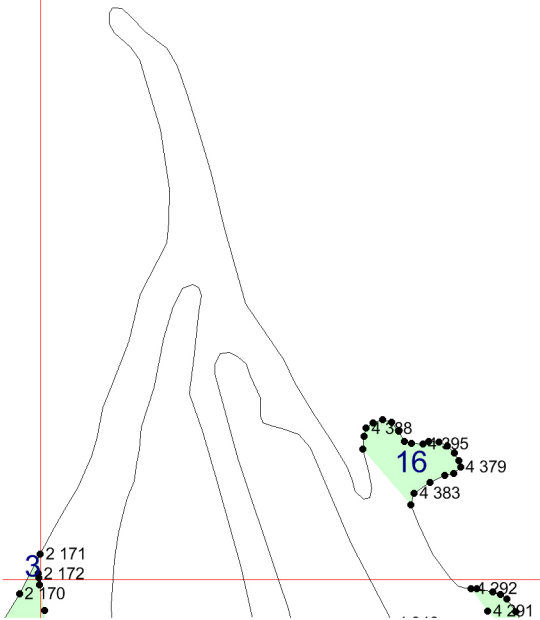

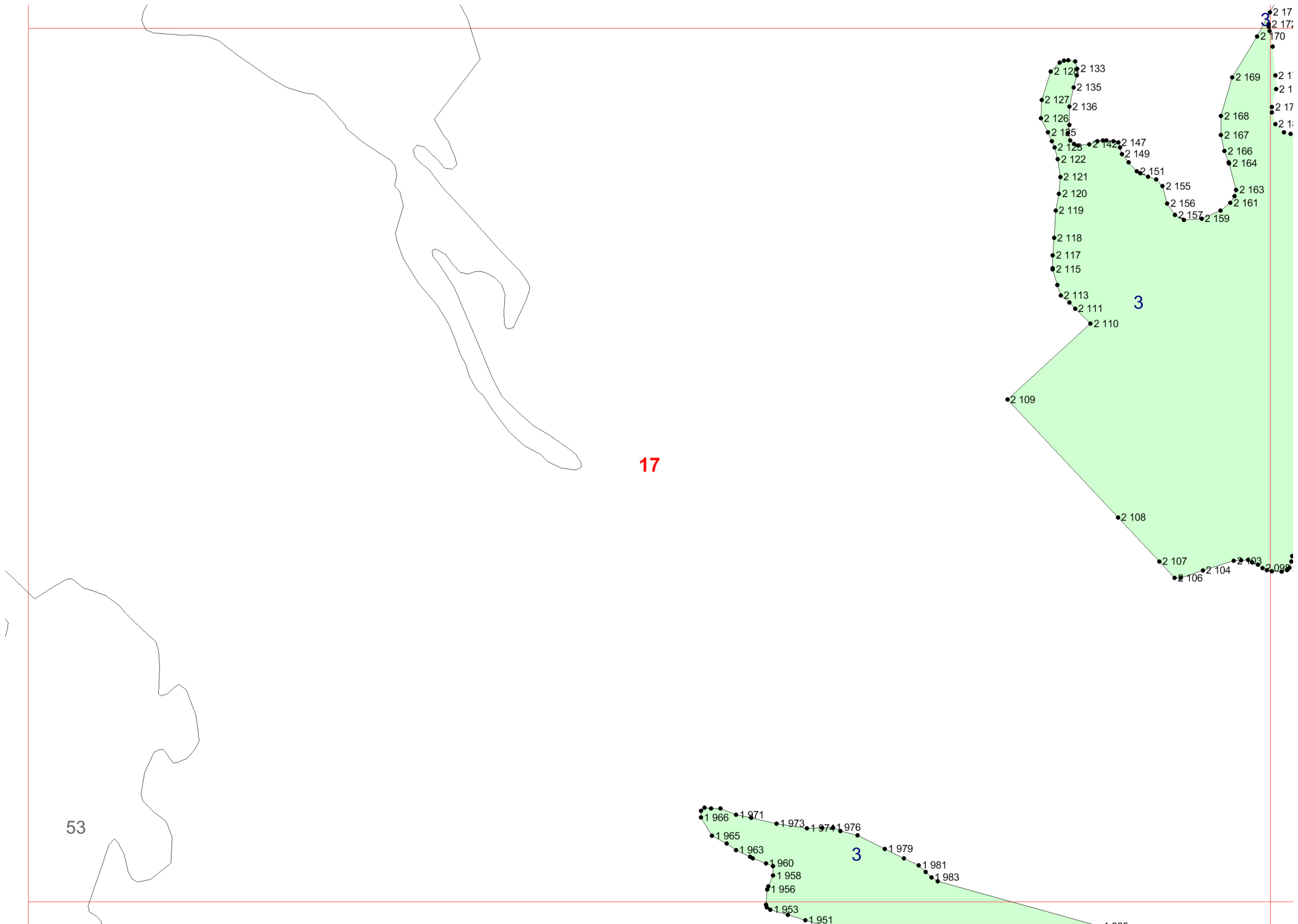

17

53

18

3

3

- 2 170
- 2 171
- 2 172
- 2 173
- 2 174
- 2 175
- 2 176
- 2 177
- 2 178
- 2 179
- 2 180
- 2 181
- 2 182
- 2 183
- 2 184
- 2 185
- 2 186
- 2 187
- 2 188
- 2 189
- 2 190
- 2 191
- 2 192
- 2 193
- 2 194
- 2 195
- 2 196
- 2 197
- 2 198
- 2 199
- 2 200
- 2 201
- 2 202
- 2 203
- 2 204
- 2 205
- 2 206
- 2 207
- 2 208
- 2 209
- 2 210
- 2 211
- 2 212
- 2 213
- 2 214
- 2 215
- 2 216
- 2 217
- 2 218
- 2 219
- 2 220
- 2 221
- 2 222
- 2 223
- 2 224
- 2 225
- 2 226
- 2 227
- 2 228
- 2 229
- 2 230
- 2 231
- 2 232
- 2 233
- 2 234
- 2 235
- 2 236
- 2 237
- 2 238
- 2 239
- 2 240
- 2 241
- 2 242
- 2 243
- 2 244
- 2 245
- 2 246
- 2 247
- 2 248
- 2 249
- 2 250
- 2 251
- 2 252
- 2 253
- 2 254
- 2 255
- 2 256
- 2 257
- 2 258
- 2 259
- 2 260
- 2 261
- 2 262
- 2 263
- 2 264
- 2 265
- 2 266
- 2 267
- 2 268
- 2 269
- 2 270
- 2 271
- 2 272
- 2 273
- 2 274
- 2 275
- 2 276
- 2 277
- 2 278
- 2 279
- 2 280
- 2 281
- 2 282
- 2 283
- 2 284
- 2 285
- 2 286
- 2 287
- 2 288
- 2 289
- 2 290
- 2 291
- 2 292
- 2 293
- 2 294
- 2 295
- 2 296
- 2 297
- 2 298
- 2 299
- 2 300

- 1 951
- 1 952
- 1 953
- 1 954
- 1 955
- 1 956
- 1 957
- 1 958
- 1 959
- 1 960
- 1 961
- 1 962
- 1 963
- 1 964
- 1 965
- 1 966
- 1 967
- 1 968
- 1 969
- 1 970
- 1 971
- 1 972
- 1 973
- 1 974
- 1 975
- 1 976
- 1 977
- 1 978
- 1 979
- 1 980
- 1 981
- 1 982
- 1 983
- 1 984
- 1 985
- 1 986
- 1 987
- 1 988
- 1 989
- 1 990
- 1 991
- 1 992
- 1 993
- 1 994
- 1 995
- 1 996
- 1 997
- 1 998
- 1 999
- 1 1000

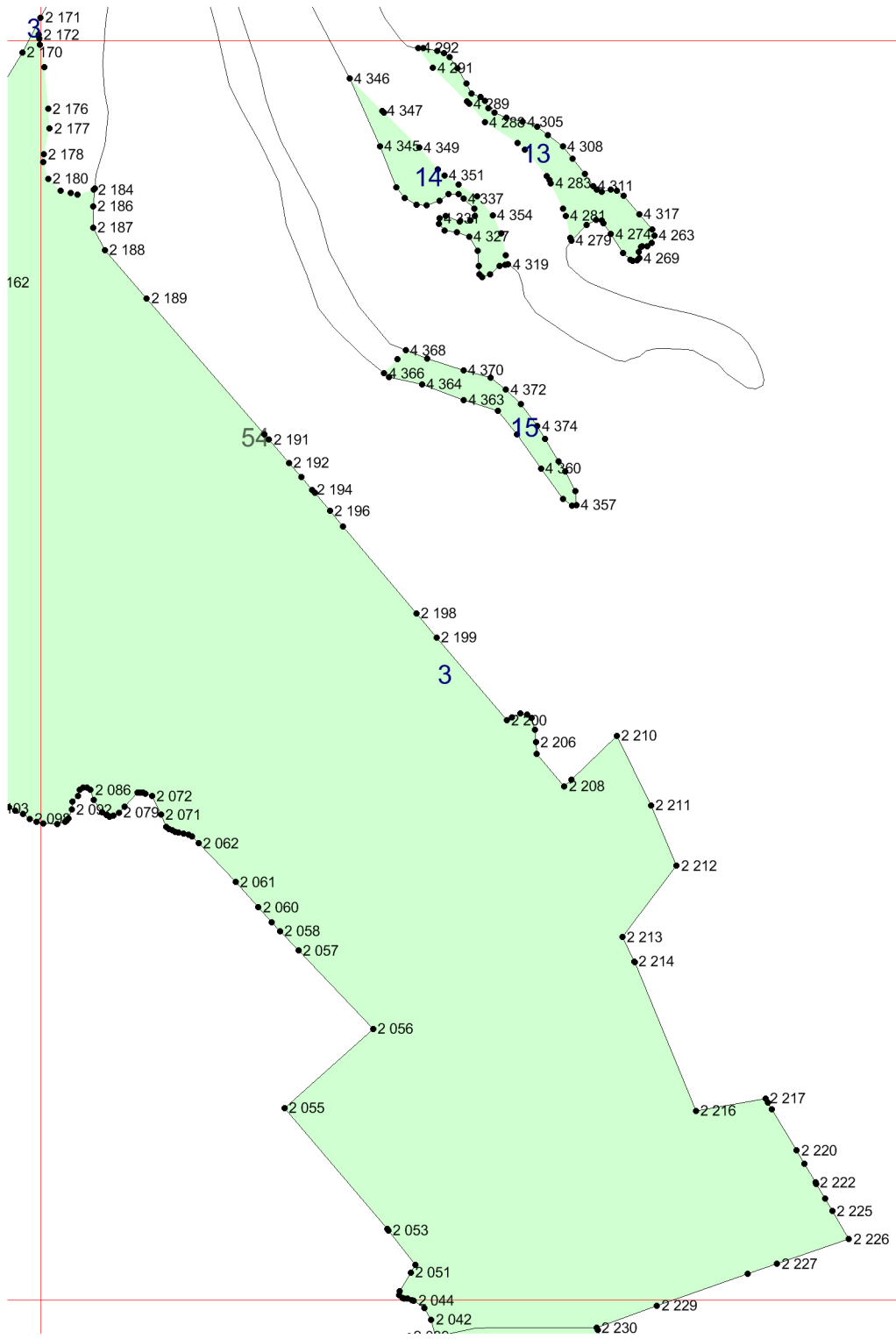

18

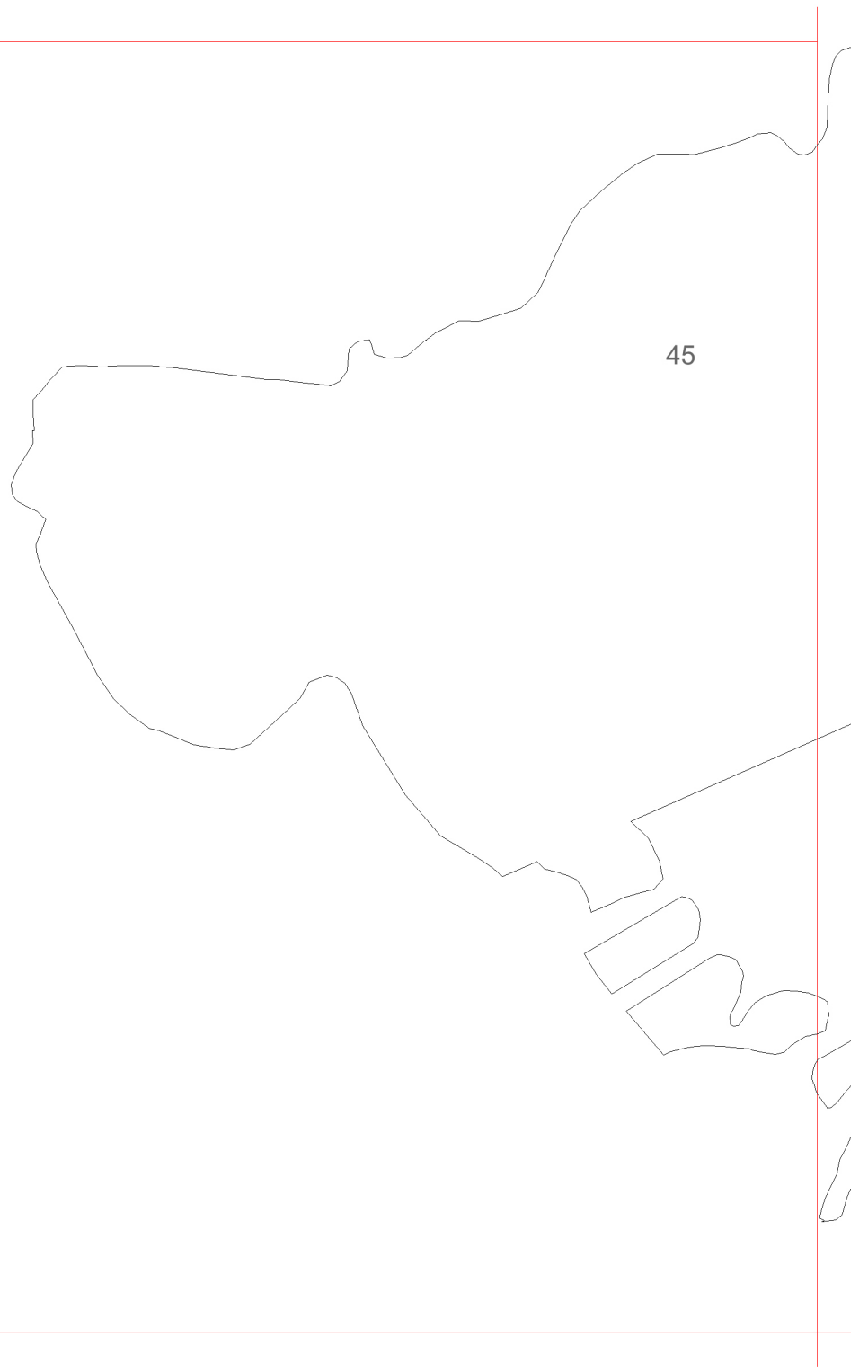

19



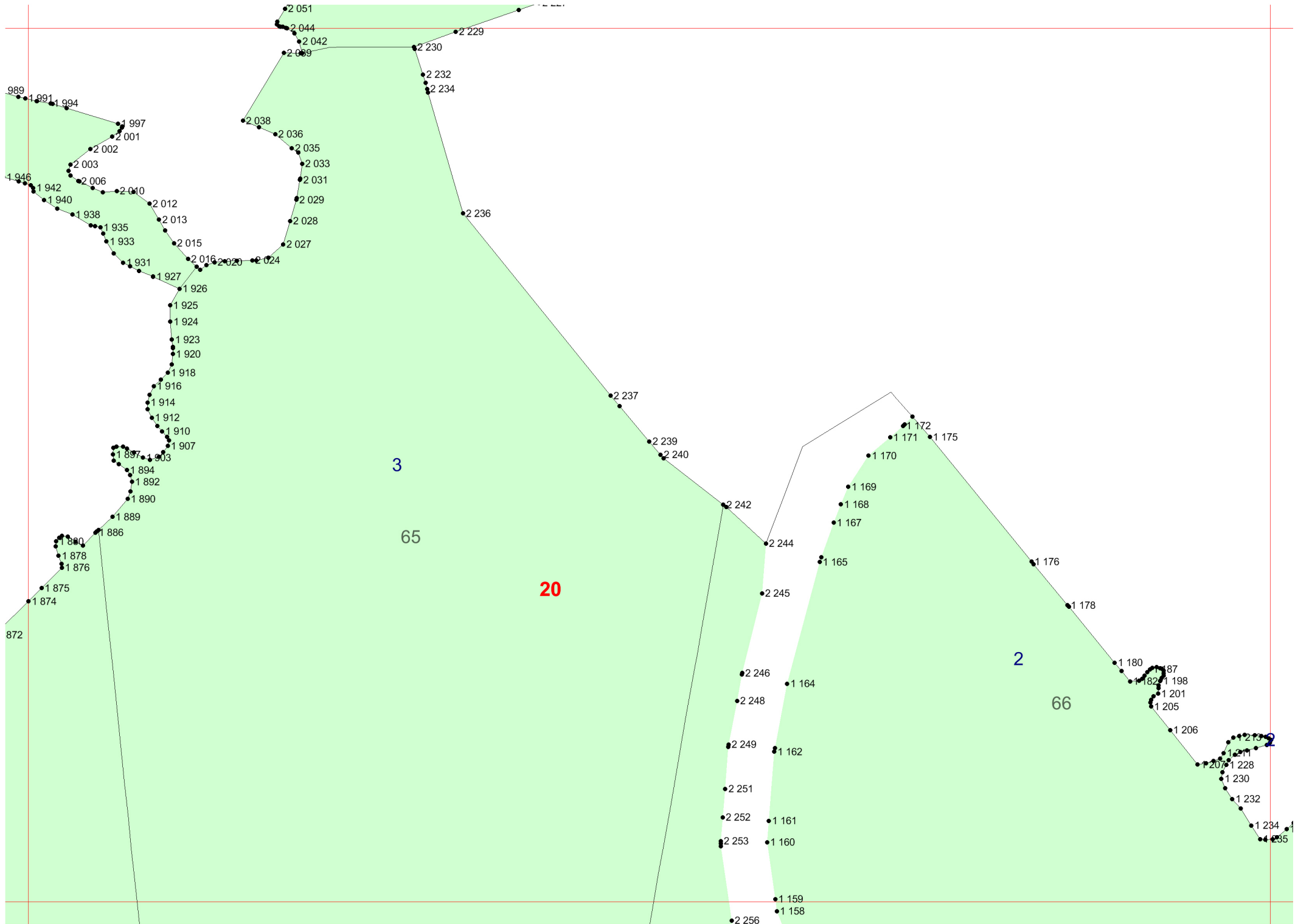

3

65

20

2

66

21

872

87

182

198

201

205

206

207

211

228

230

232

234

235

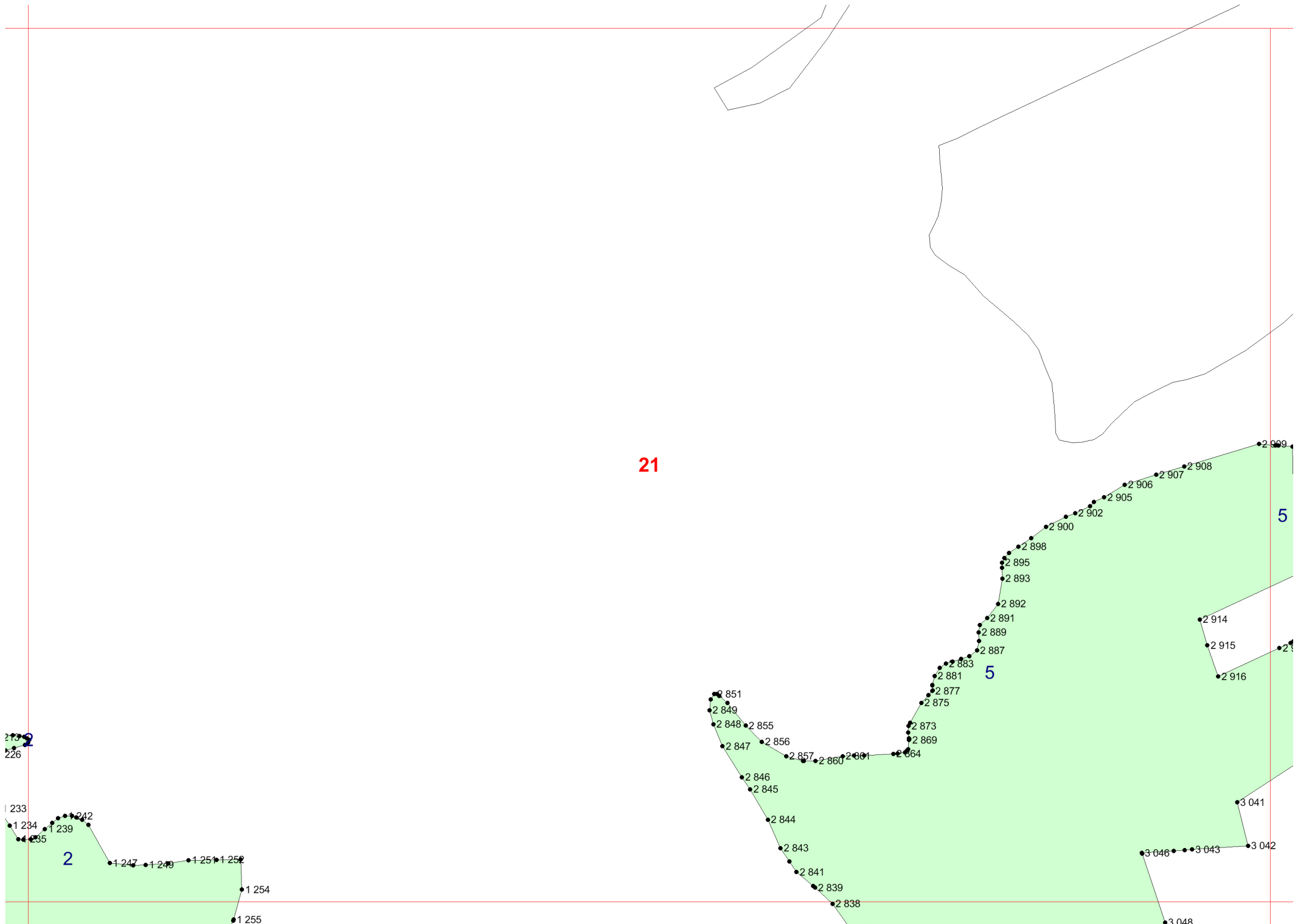

21

2

5

5

22



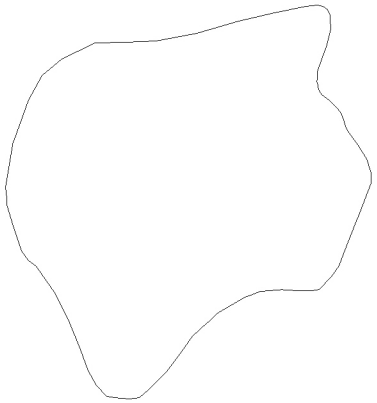

23

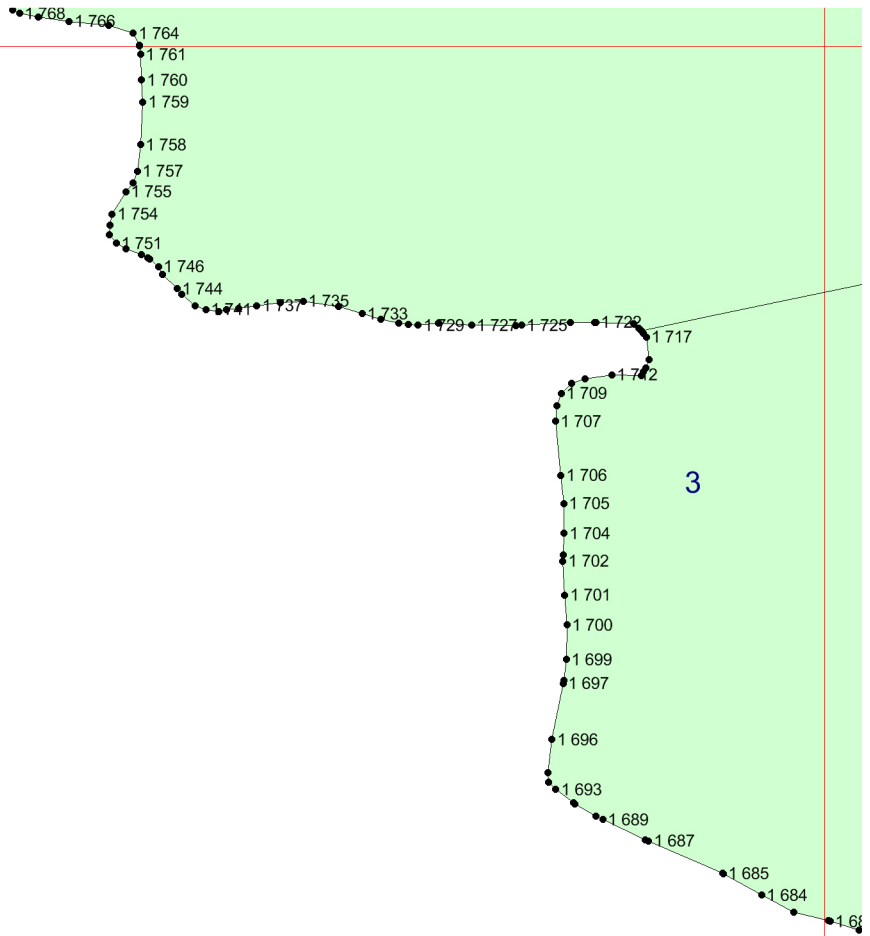



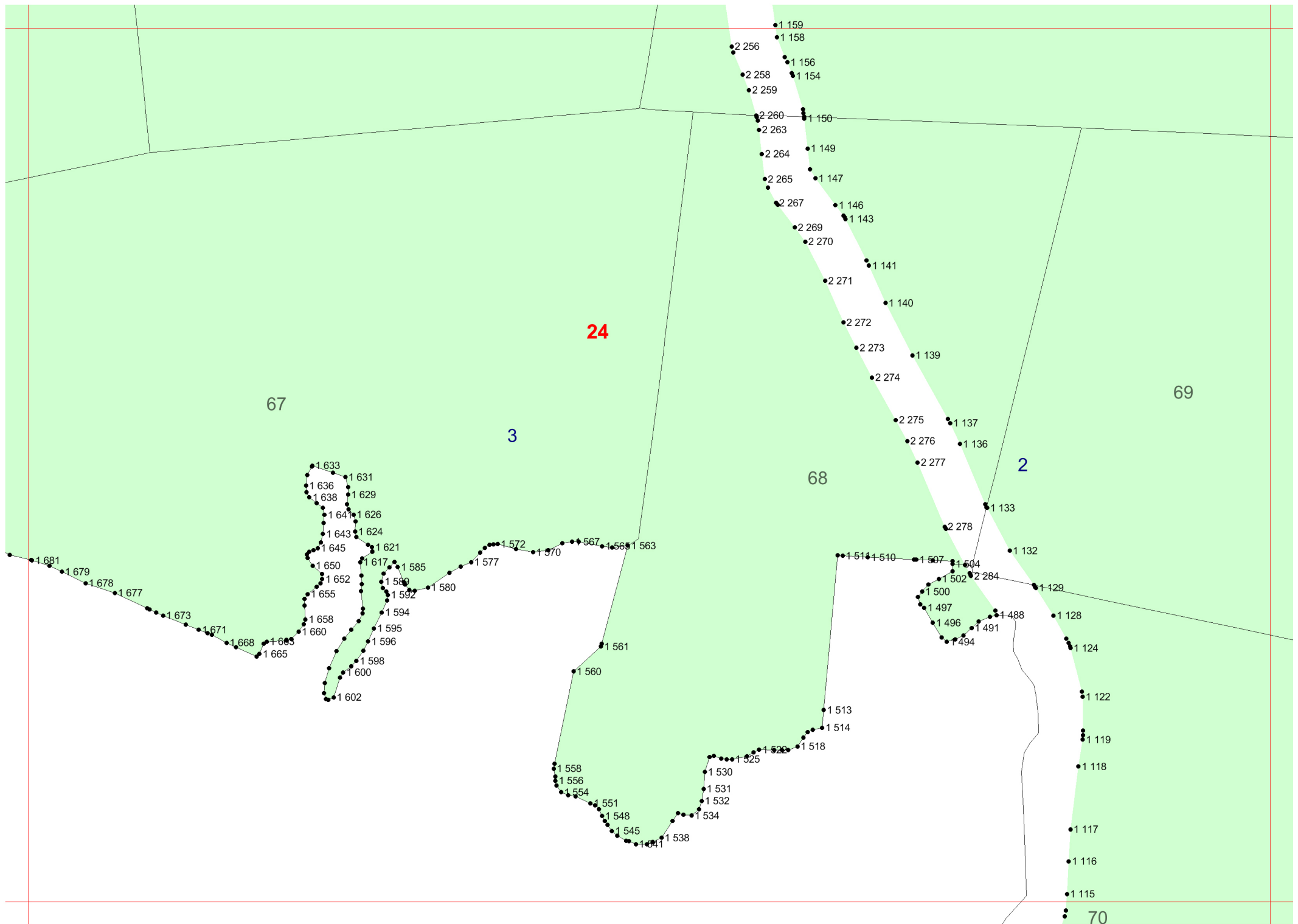

24

67

3

68

2

69

25

70

1 159  
1 158  
1 156  
1 154

2 256  
2 258  
2 259

2 260  
2 263  
2 264  
2 265  
2 267  
2 269  
2 270

1 149  
1 147  
1 146  
1 143

1 141  
1 140  
2 271  
2 272  
2 273

1 139  
2 274

2 275  
2 276  
2 277

1 137  
1 136

1 133

1 514  
1 510  
1 507  
1 504  
1 502  
2 284  
1 500  
1 497  
1 496  
1 494

1 132  
1 129

1 128  
1 124

1 122

1 119

1 118

1 117

1 116

1 115

1 633  
1 631  
1 636  
1 638  
1 629  
1 641  
1 626  
1 643  
1 624  
1 645  
1 621  
1 617  
1 585  
1 589  
1 592  
1 580  
1 594  
1 595  
1 596  
1 598  
1 600  
1 602

1 572  
1 570  
567  
1 568  
1 563

1 561

1 560

1 558  
1 556  
1 554

1 551  
1 548  
1 545

1 541

1 530  
1 531  
1 532

1 534  
1 538

1 525

1 518

1 513

1 514

1 115

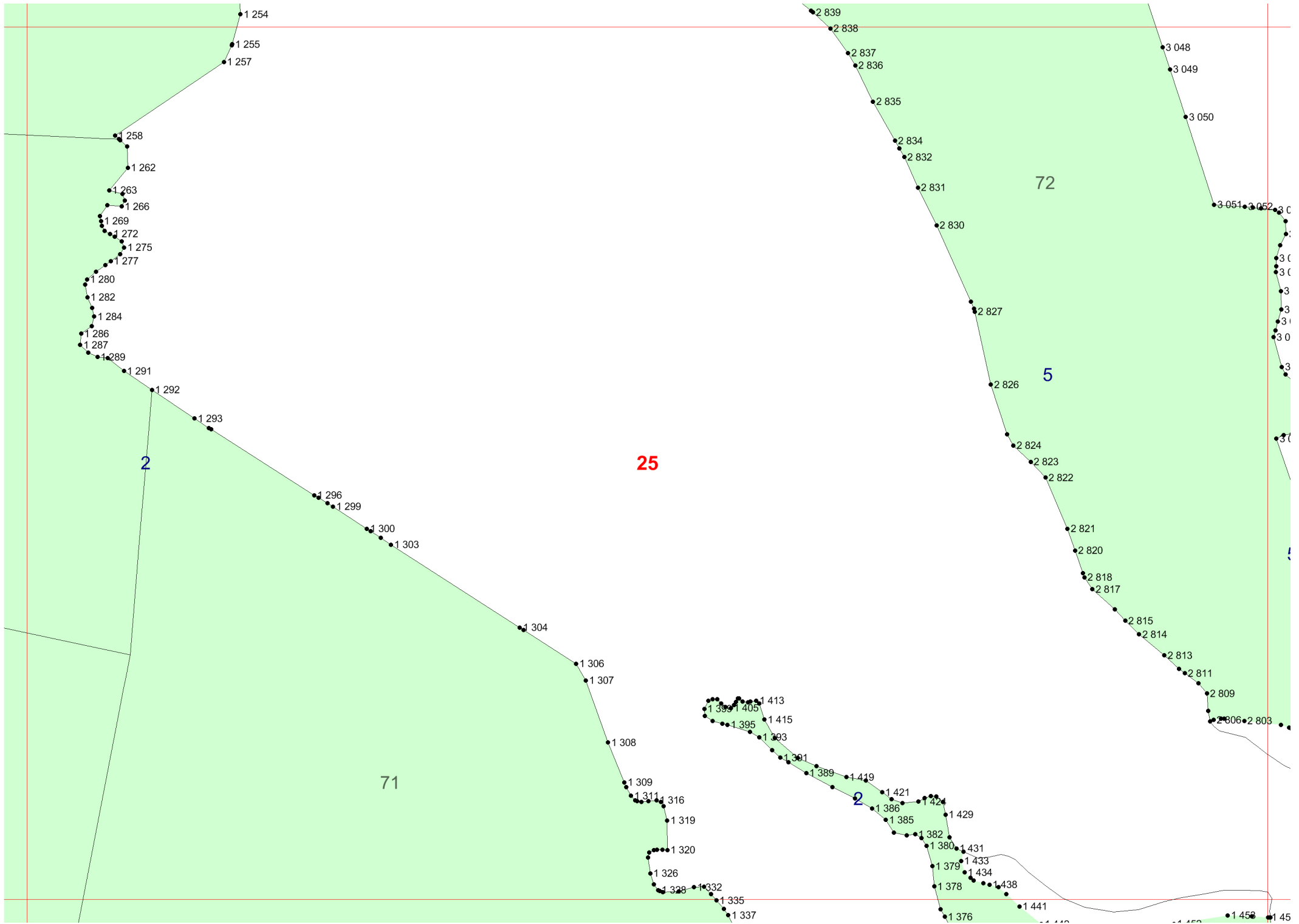

25

72

5

2

71

2

26

73

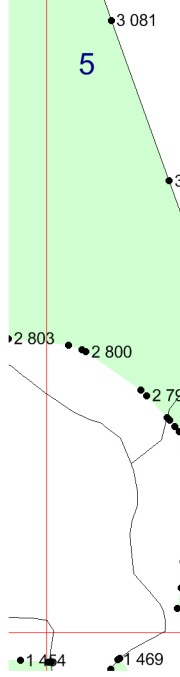
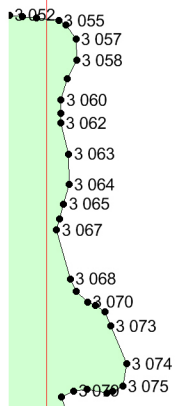
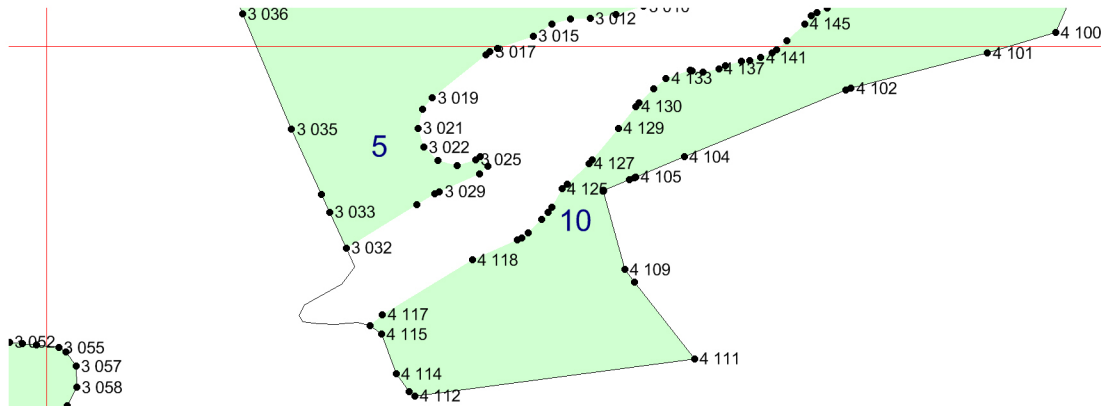

26

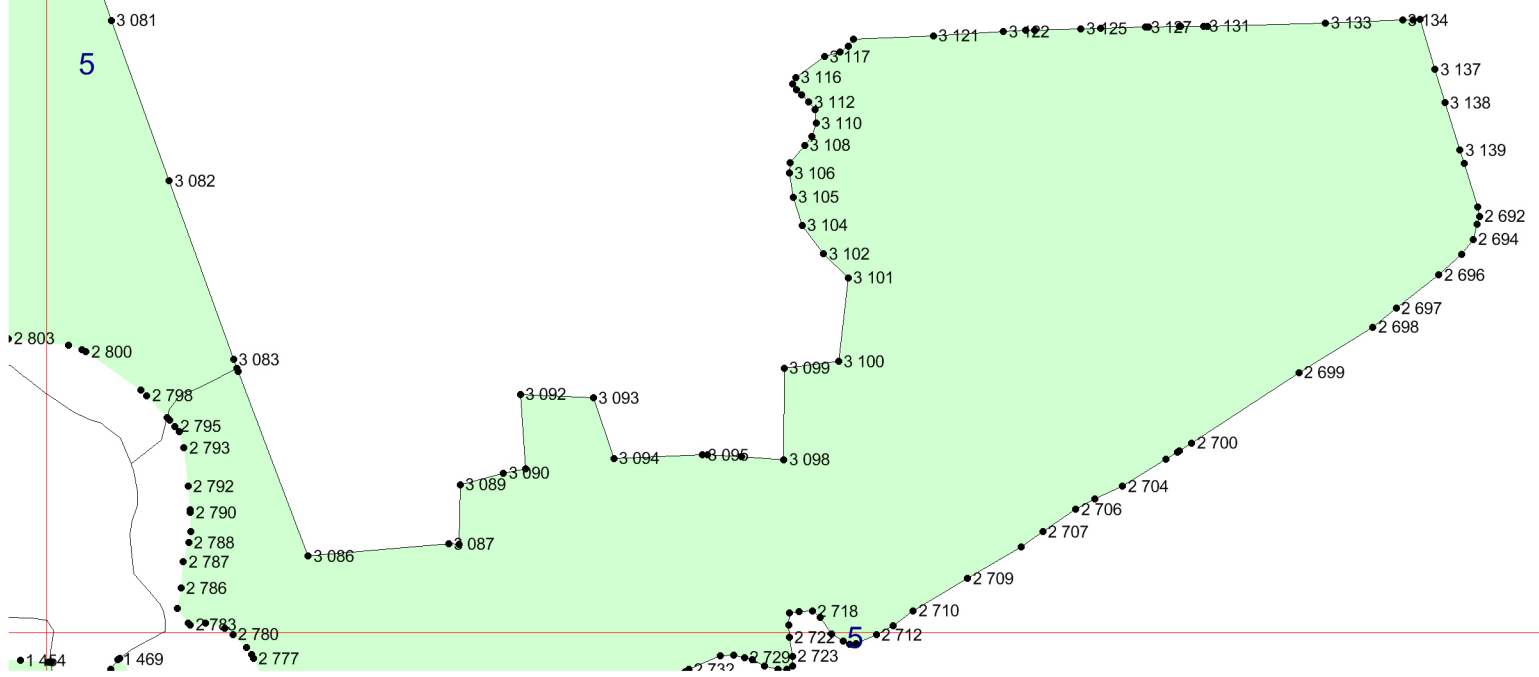

27

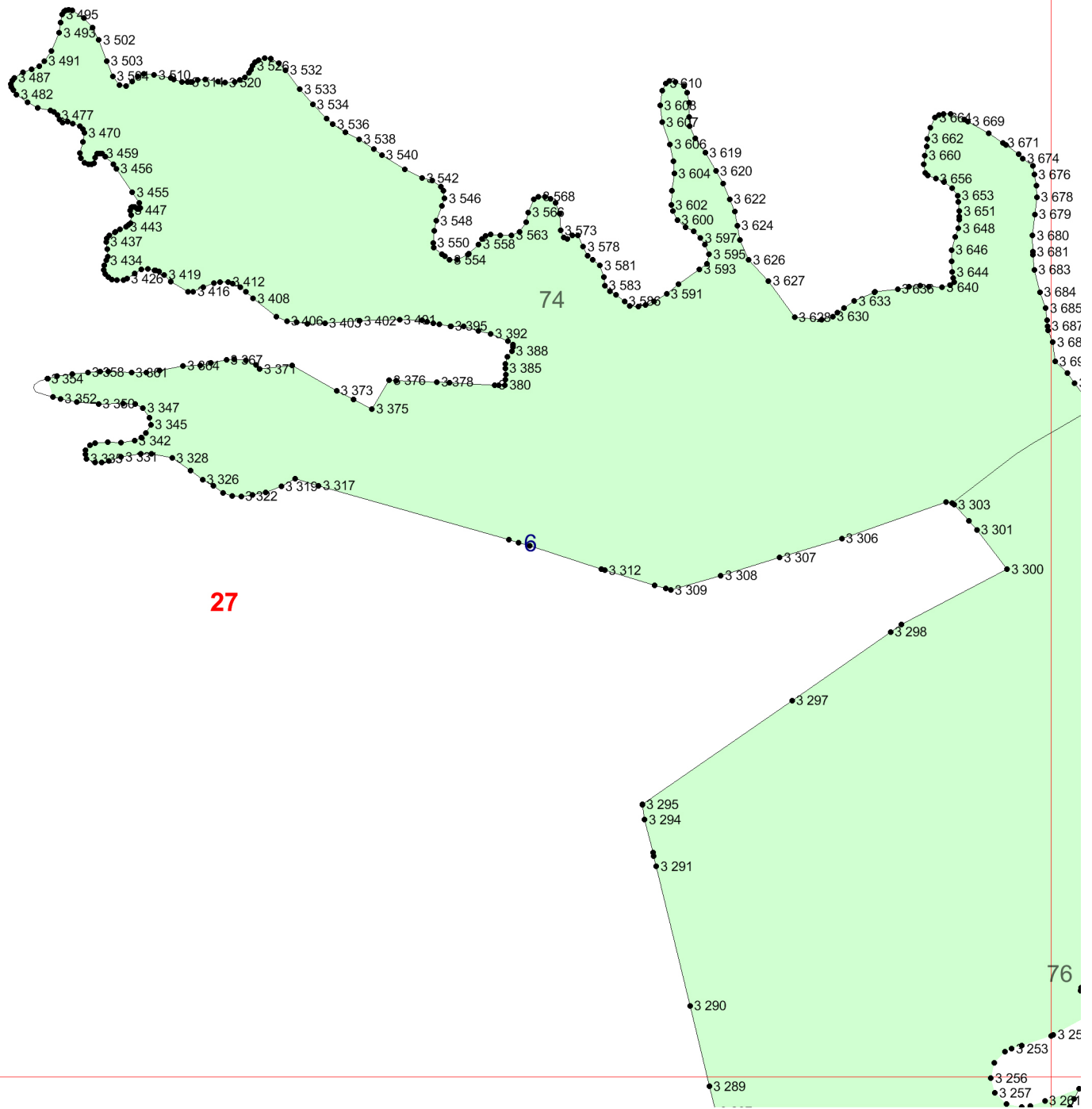

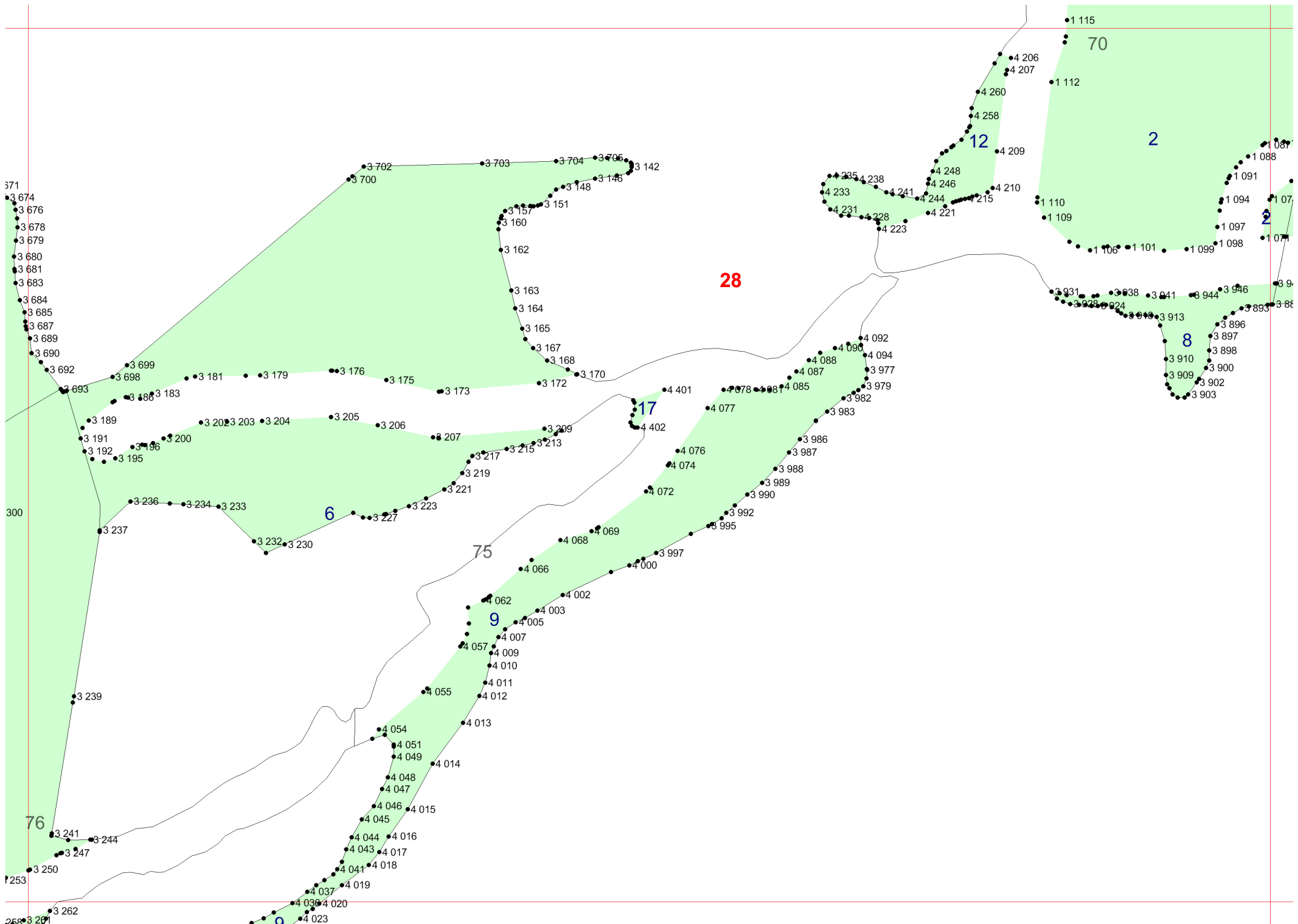



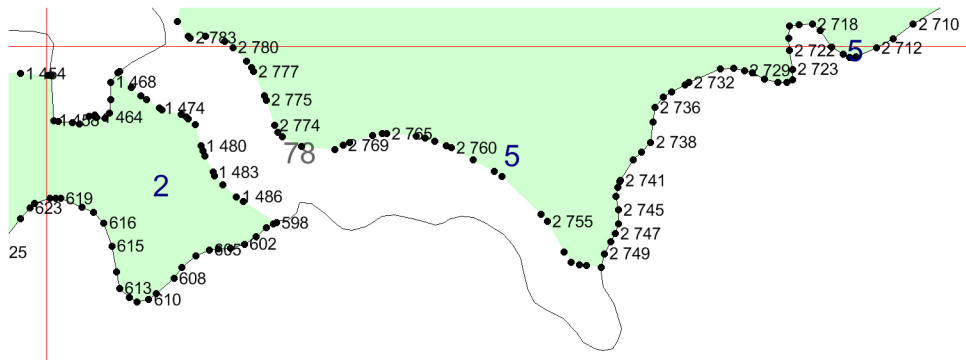

30

31

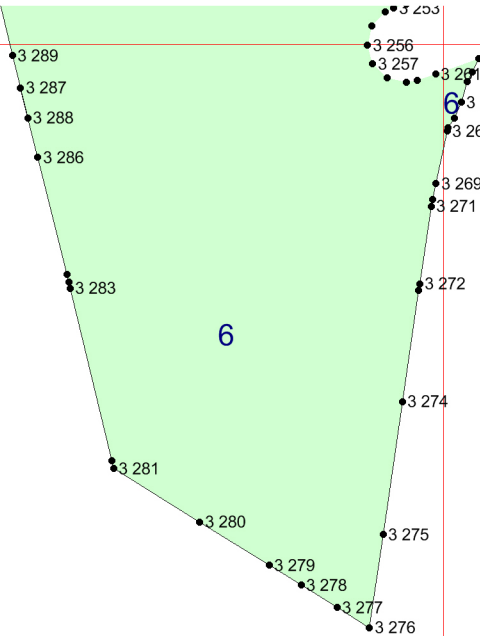

85

32



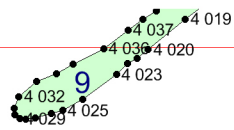
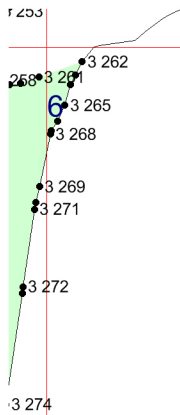

**32**

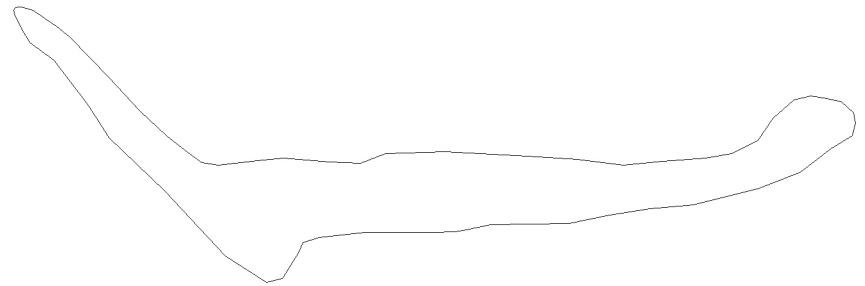

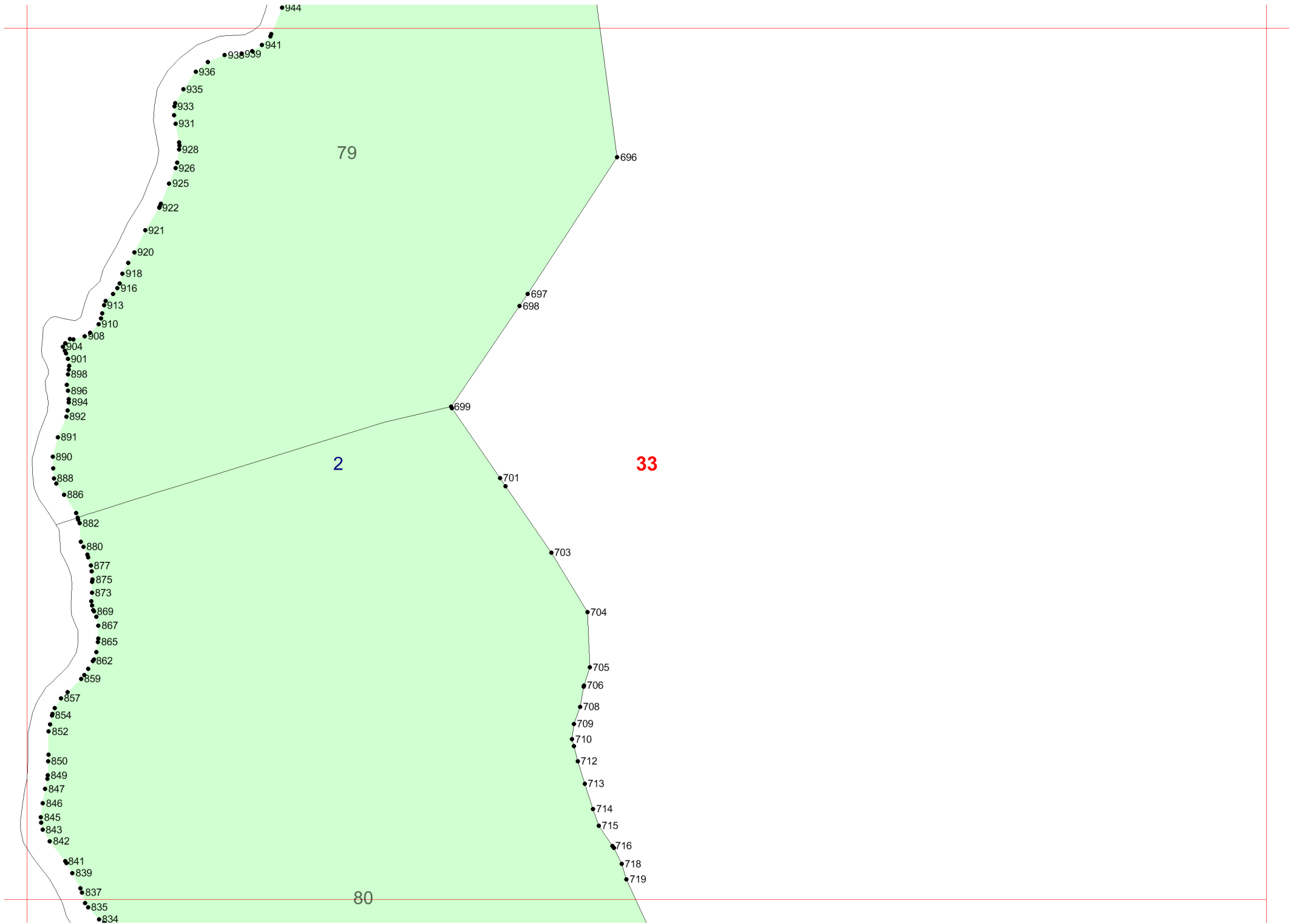

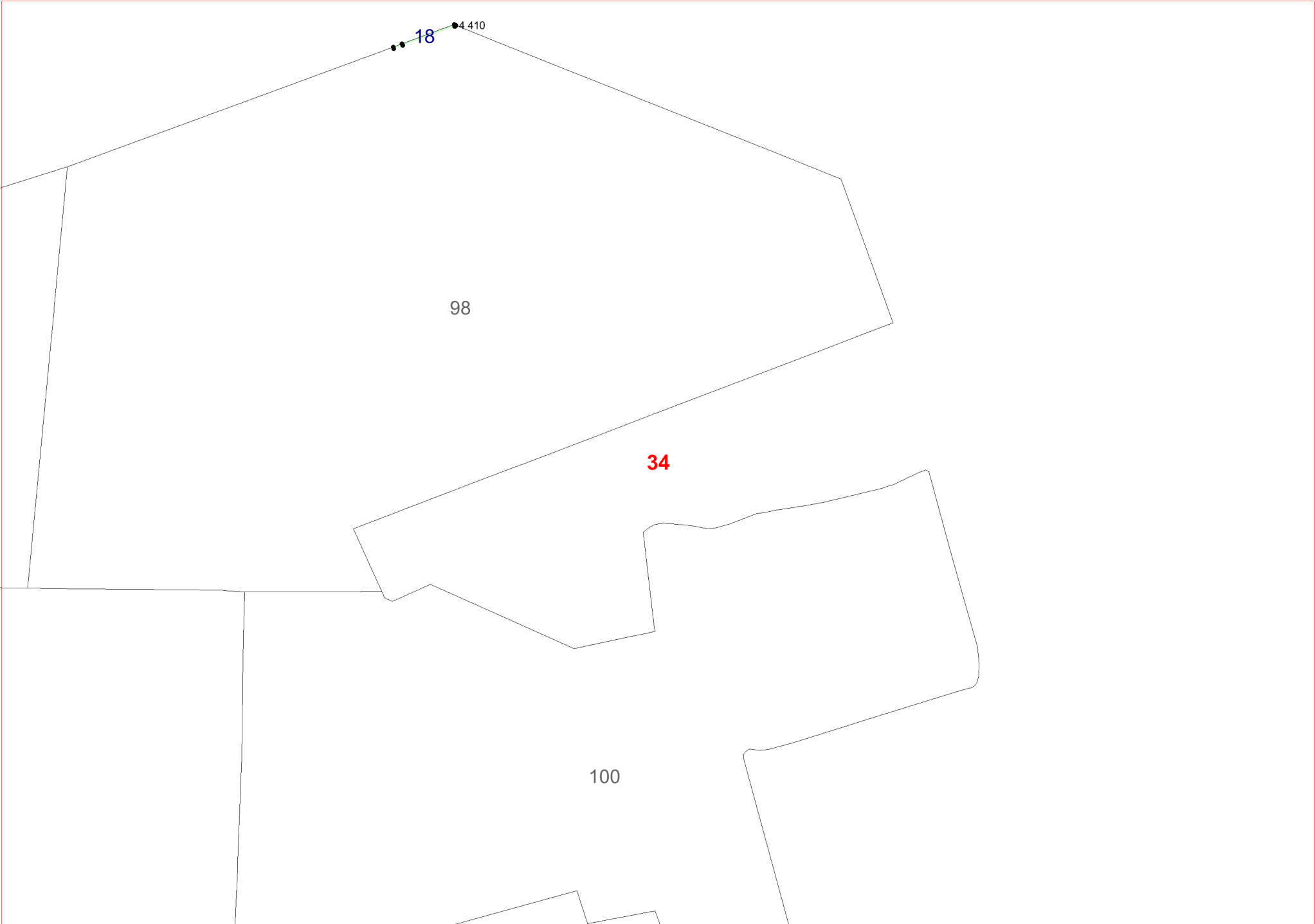

18

4.410

98

34

100

35

