

**Графическое описание местоположения границ земель,
на которых располагаются леса, расположенные в
водоохранных зонах,
на территории Куручевского участкового лесничества
Туймазинского лесничества
Республики Башкортостан**

Приложение № 96 к приказу Рослесхоза

от 27.02.2023

№ 201

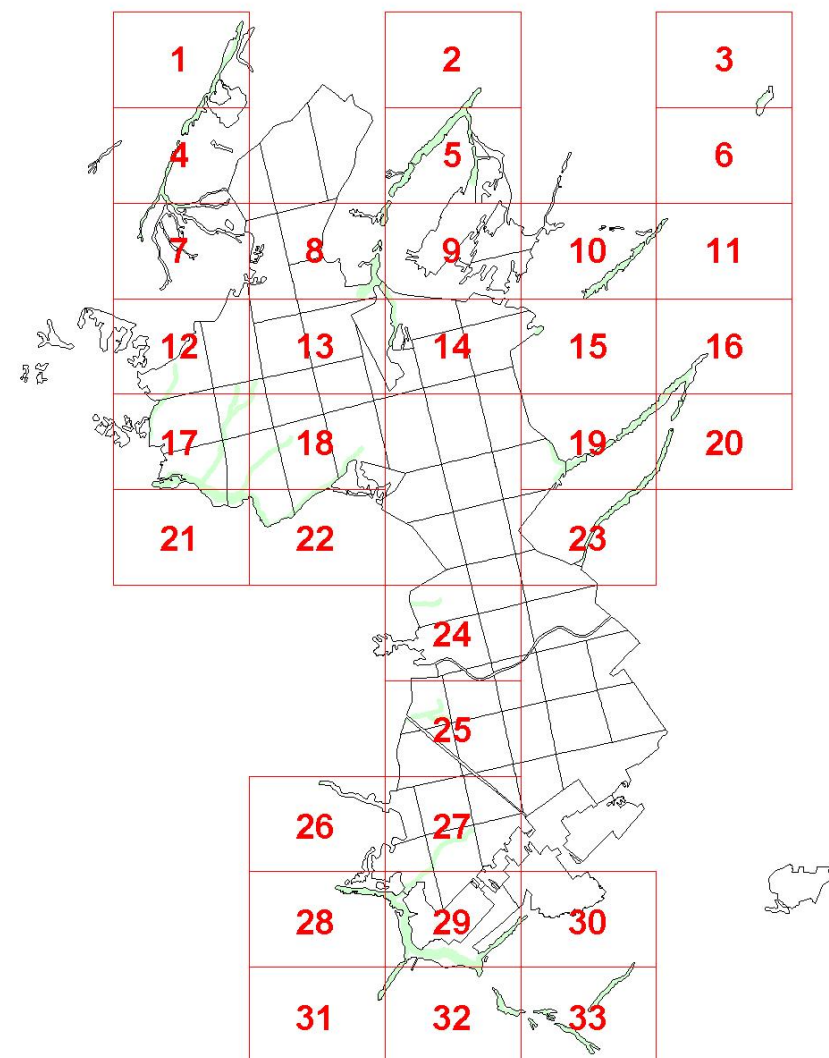

Условные обозначения:

1 номера листов

3 номера участков

61 номера лесных кварталов

— границы лесных кварталов

— границы листов

■ границы категорий защитных лесов

● 45 номера характерных точек границ объекта

1

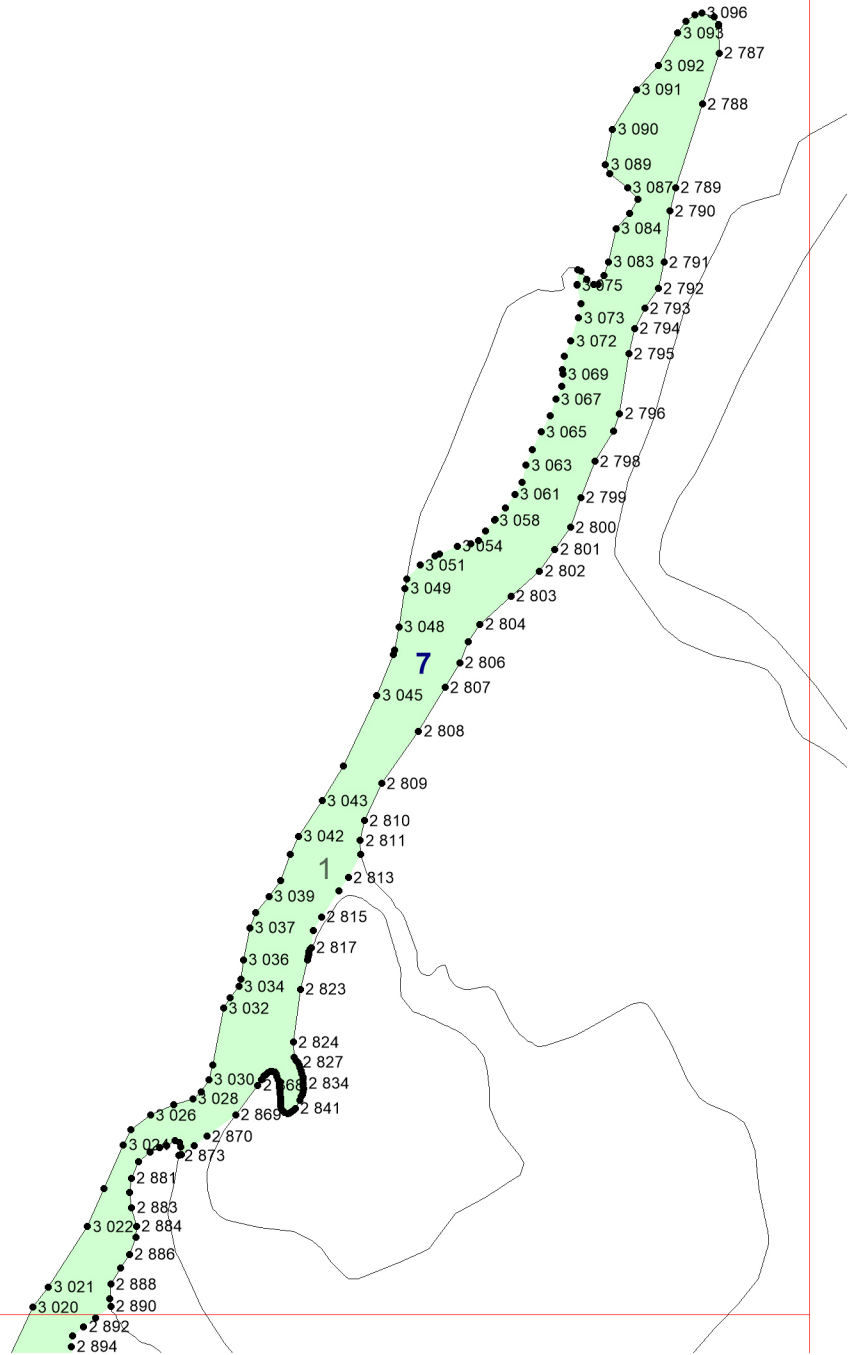

2

2

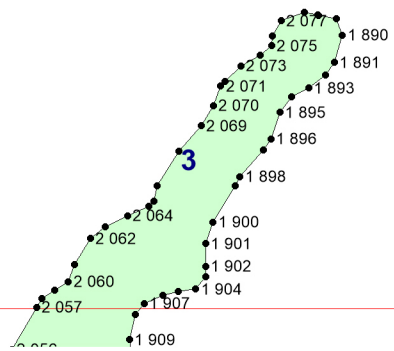

3

3

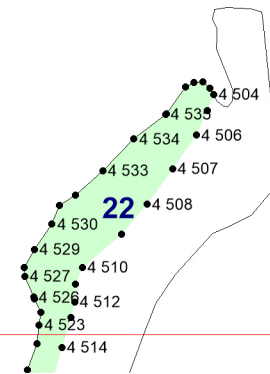

4

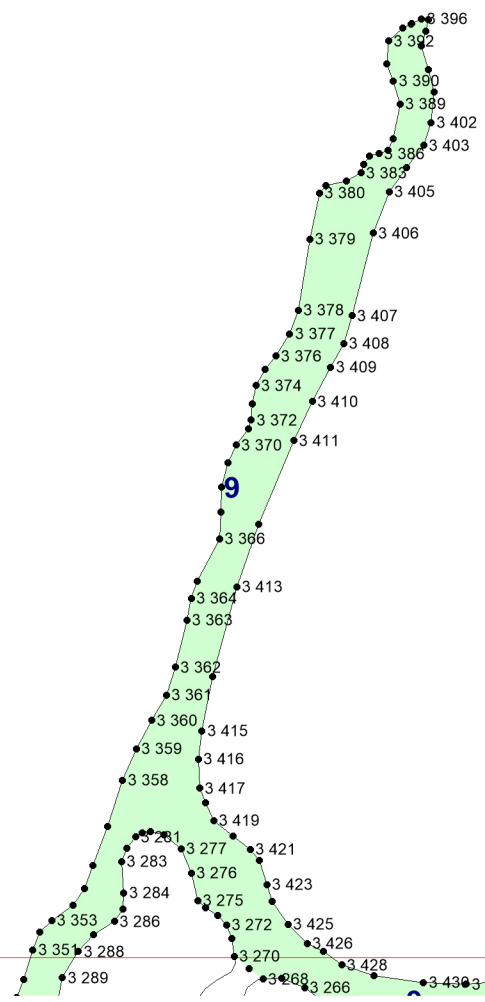
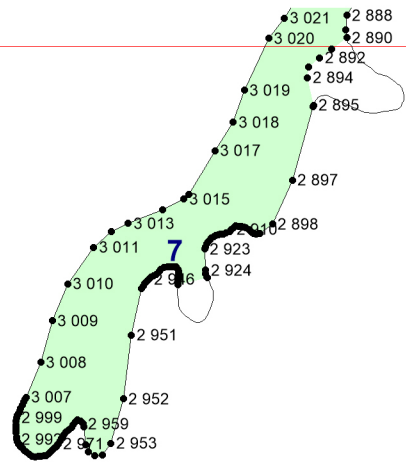

4

5

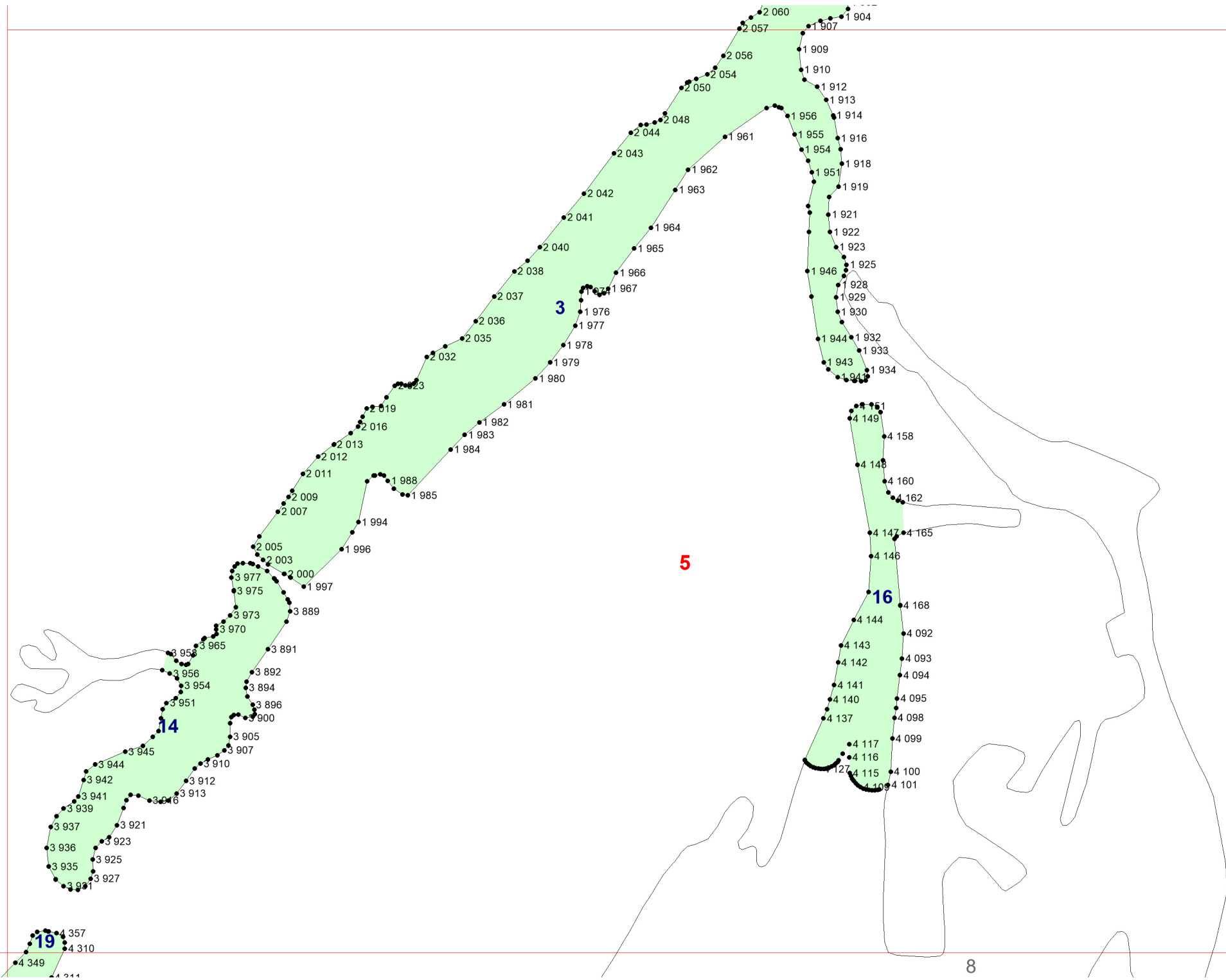

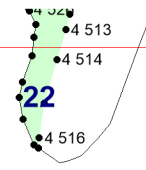

6

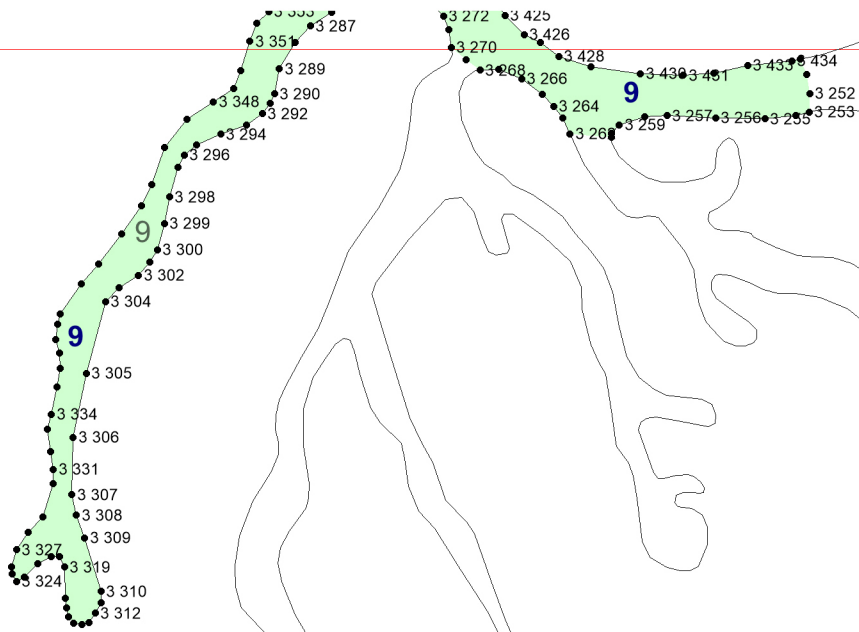

7

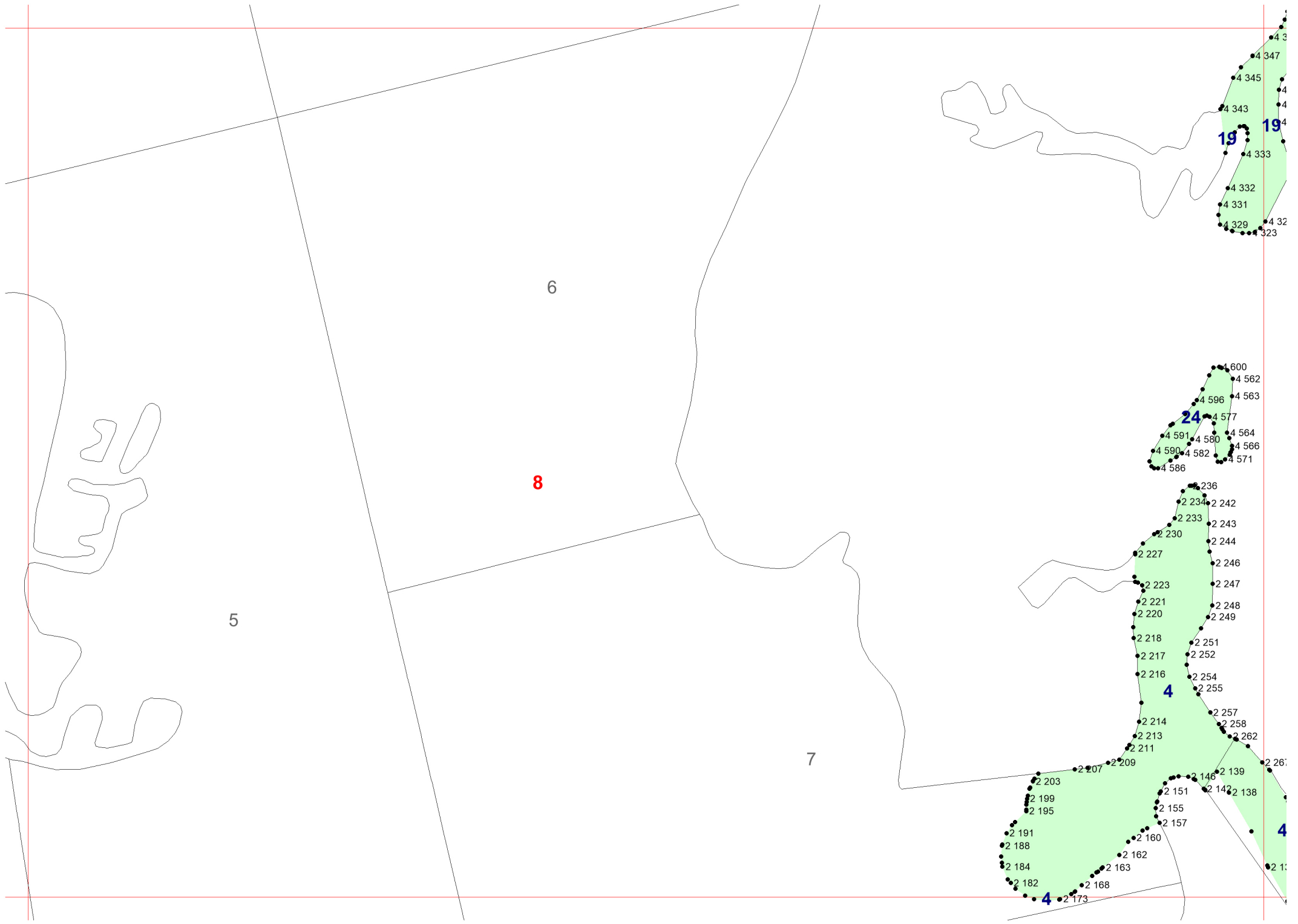

6

8

5

7

9

19

19

24

4

4

- 4 347
- 4 345
- 4 343
- 4 333
- 4 332
- 4 331
- 4 329
- 4 32
- 4 323

- 4 600
- 4 562
- 4 563
- 4 596
- 4 577
- 4 591
- 4 580
- 4 564
- 4 566
- 4 582
- 4 571
- 4 586

- 2 236
- 2 234
- 2 242
- 2 233
- 2 243
- 2 230
- 2 244
- 2 227
- 2 246
- 2 223
- 2 247
- 2 221
- 2 248
- 2 220
- 2 249
- 2 218
- 2 251
- 2 217
- 2 252
- 2 216
- 2 254
- 2 215
- 2 255
- 2 214
- 2 257
- 2 213
- 2 258
- 2 211
- 2 262

- 2 203
- 2 207
- 2 209
- 2 146
- 2 139
- 2 261
- 2 262
- 2 261
- 2 261
- 2 199
- 2 195
- 2 151
- 2 142
- 2 138
- 2 191
- 2 188
- 2 184
- 2 182
- 2 173
- 2 160
- 2 157
- 2 155
- 2 151
- 2 142
- 2 139
- 2 162
- 2 163
- 2 168
- 2 173

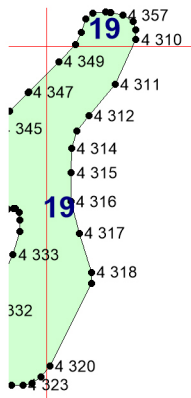

562
563
564
566

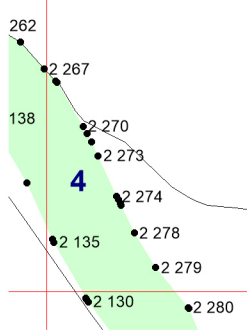

9

16

8

10

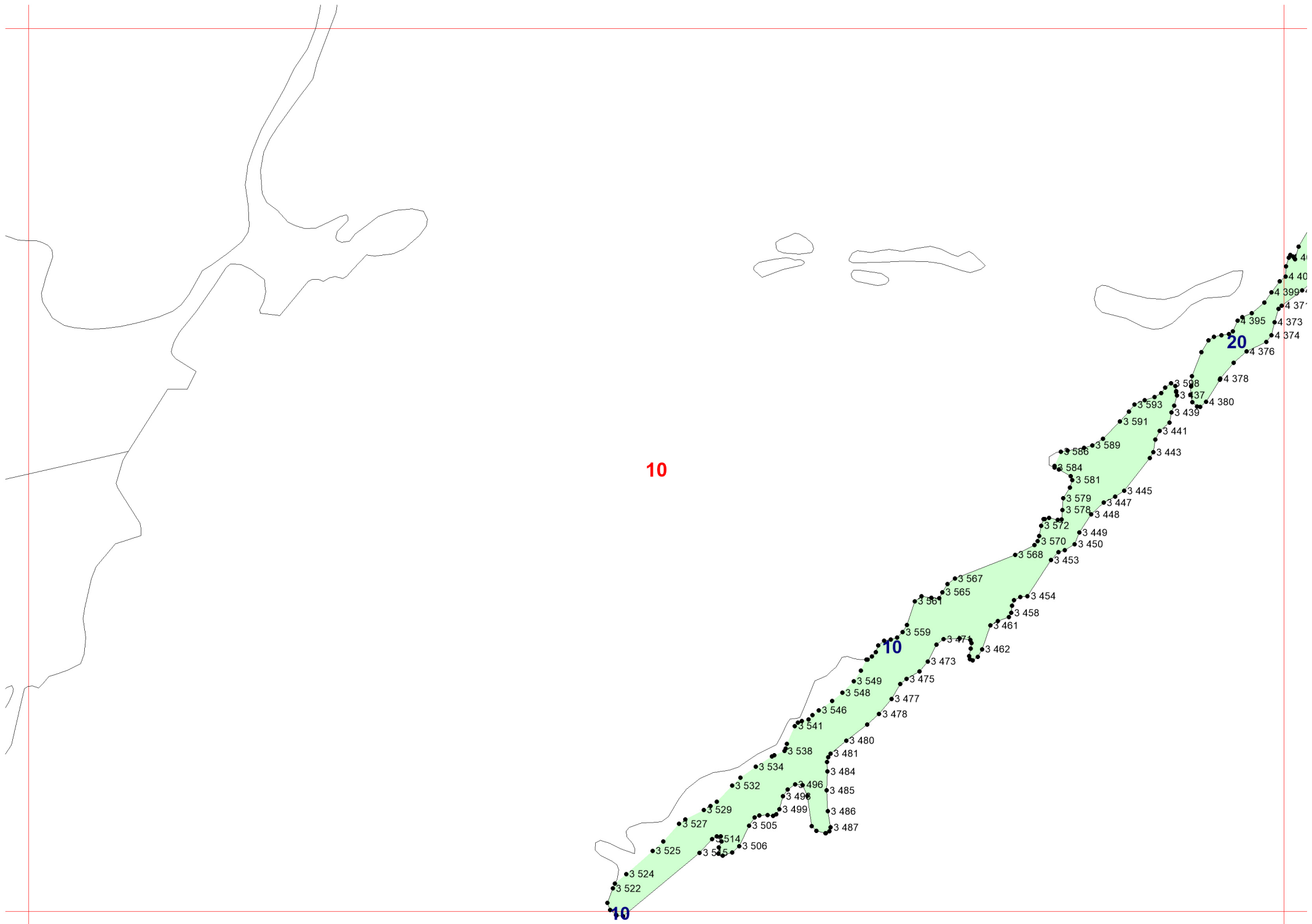

10

20

10

11

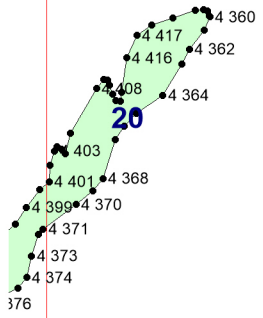

11

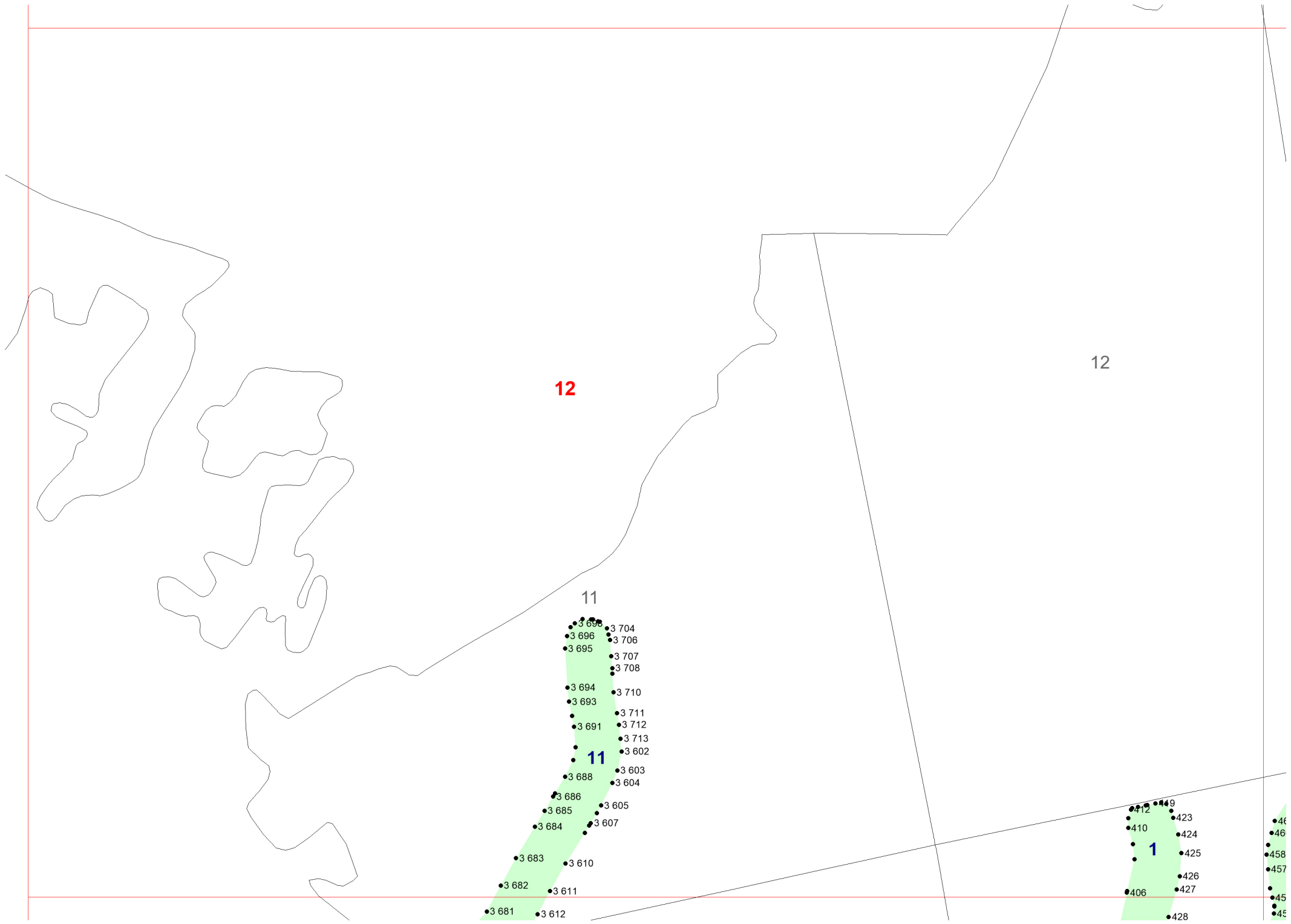

12

12

11

11

1

13

- 3 698
- 3 696
- 3 695
- 3 694
- 3 693
- 3 691
- 3 688
- 3 686
- 3 685
- 3 684
- 3 683
- 3 682
- 3 681
- 3 704
- 3 706
- 3 707
- 3 708
- 3 710
- 3 711
- 3 712
- 3 713
- 3 602
- 3 603
- 3 604
- 3 605
- 3 607
- 3 610
- 3 611
- 3 612

- 412
- 410
- 406
- 423
- 424
- 425
- 426
- 427
- 428

- 46
- 46
- 458
- 457
- 45
- 45

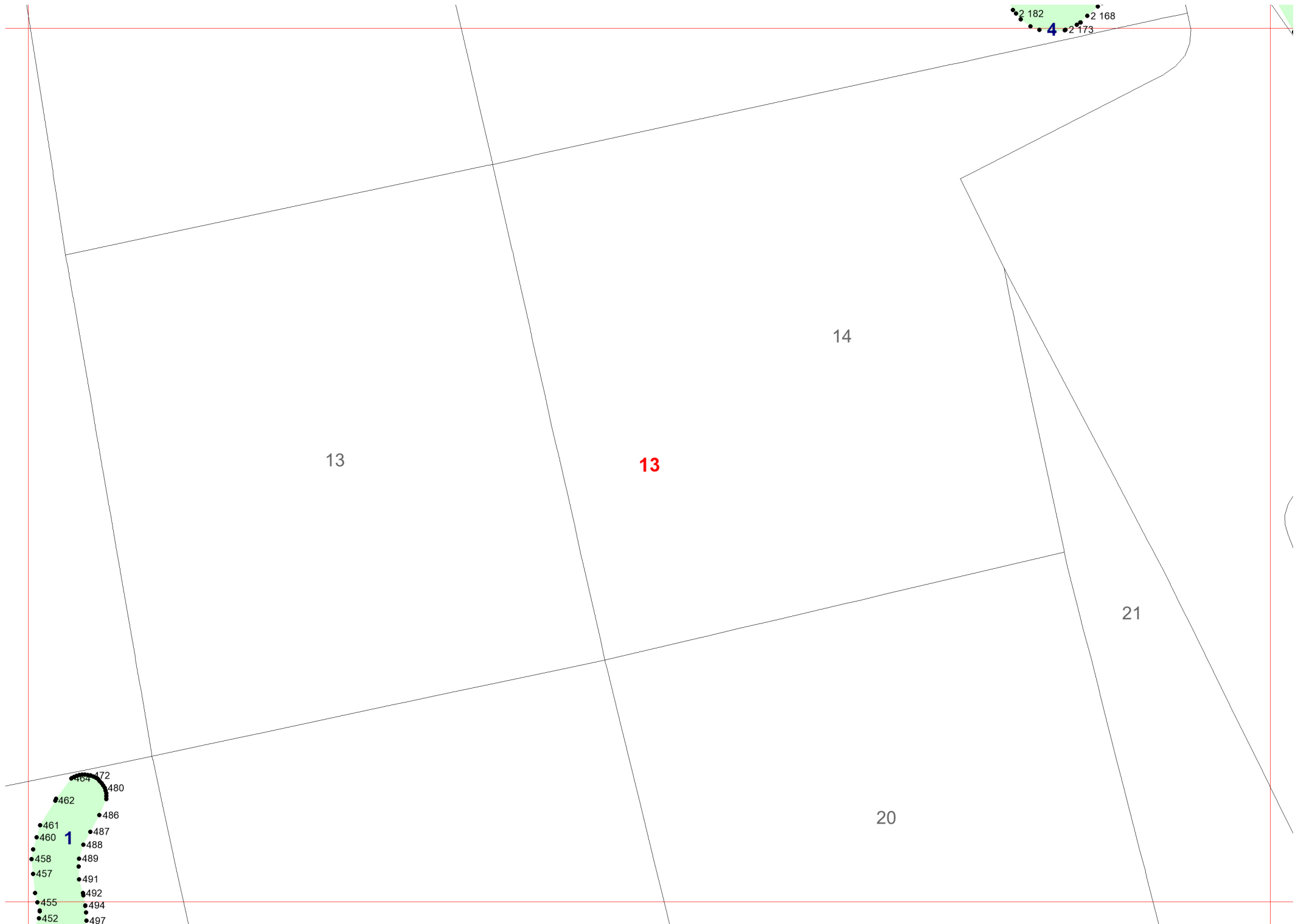

13

13

14

21

20

14

- 462
- 461
- 460
- 458
- 457
- 455
- 452
- 486
- 487
- 488
- 489
- 491
- 492
- 494
- 497

- 472
- 480

- 2 182
- 2 168
- 2 173

1

4

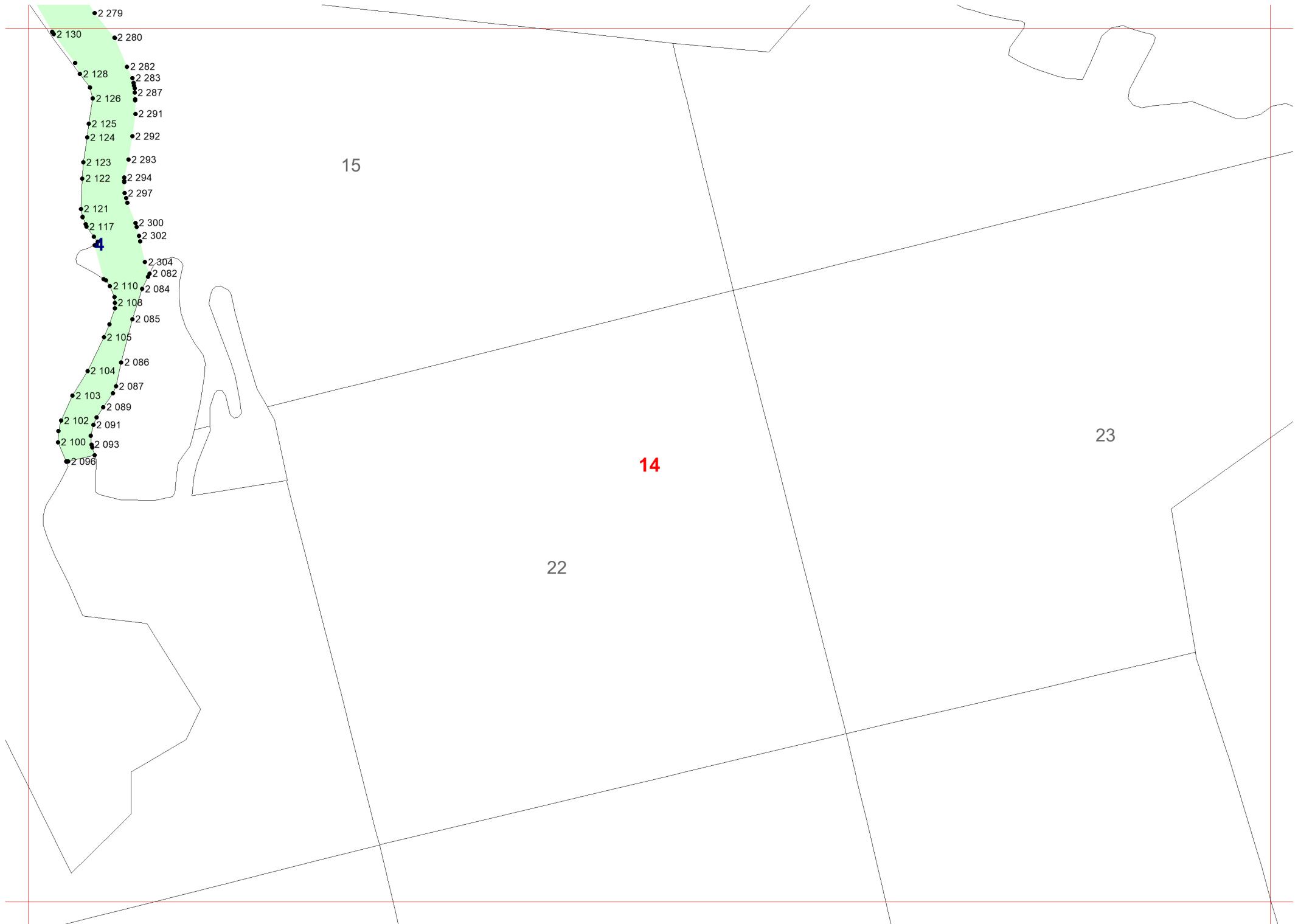

15

14

22

23

15

- 2 279
- 2 130
- 2 280
- 2 128
- 2 282
- 2 283
- 2 126
- 2 287
- 2 125
- 2 291
- 2 124
- 2 292
- 2 123
- 2 293
- 2 122
- 2 294
- 2 121
- 2 297
- 2 117
- 2 300
- 2 302
- 2 304
- 2 082
- 2 110
- 2 084
- 2 108
- 2 085
- 2 105
- 2 086
- 2 104
- 2 087
- 2 103
- 2 089
- 2 102
- 2 091
- 2 100
- 2 093
- 2 096

4

10

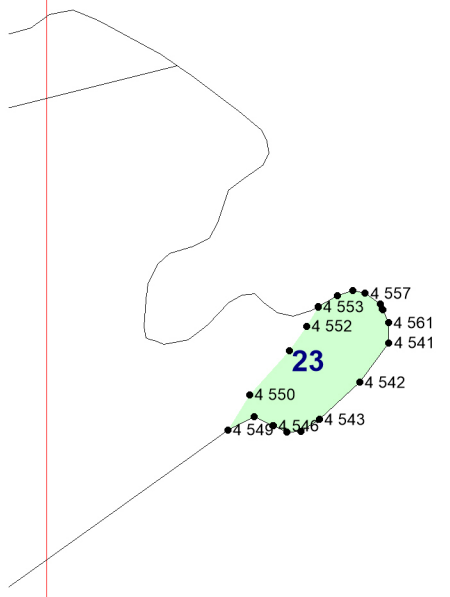

15

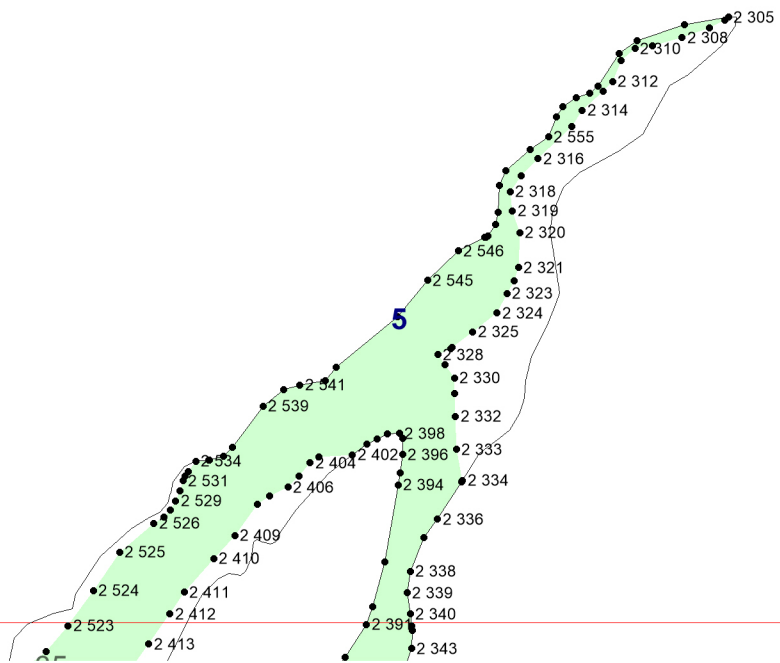

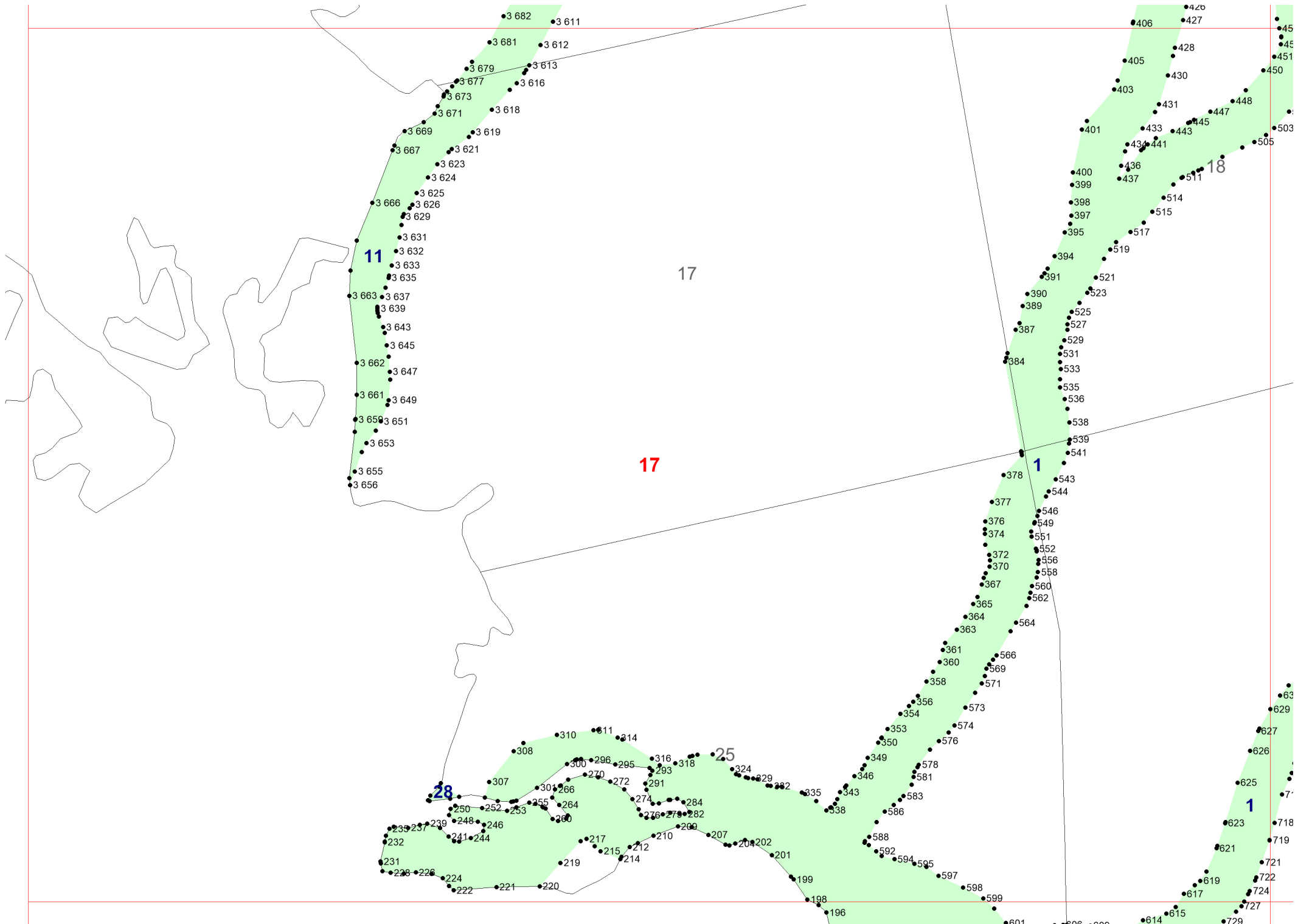

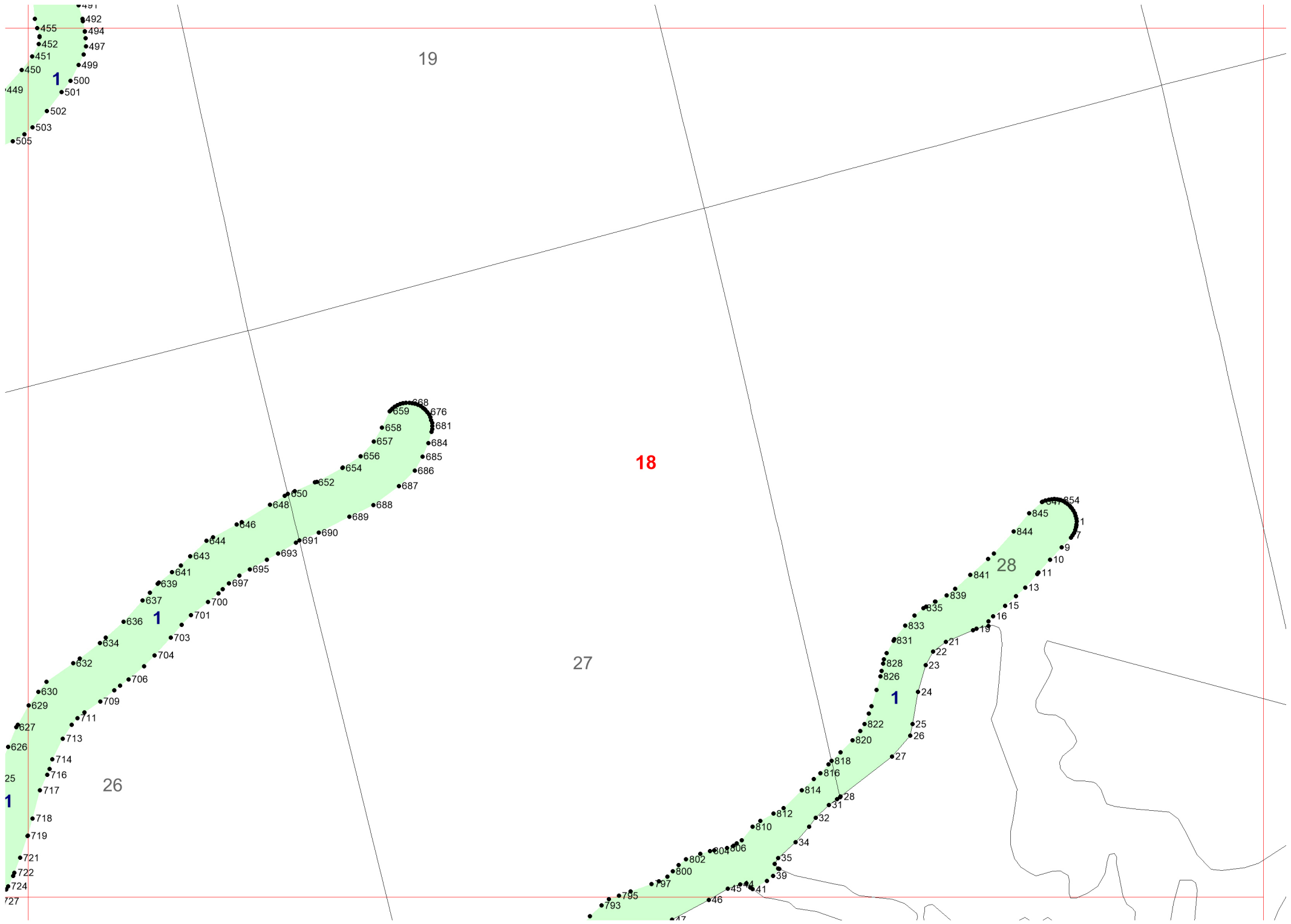

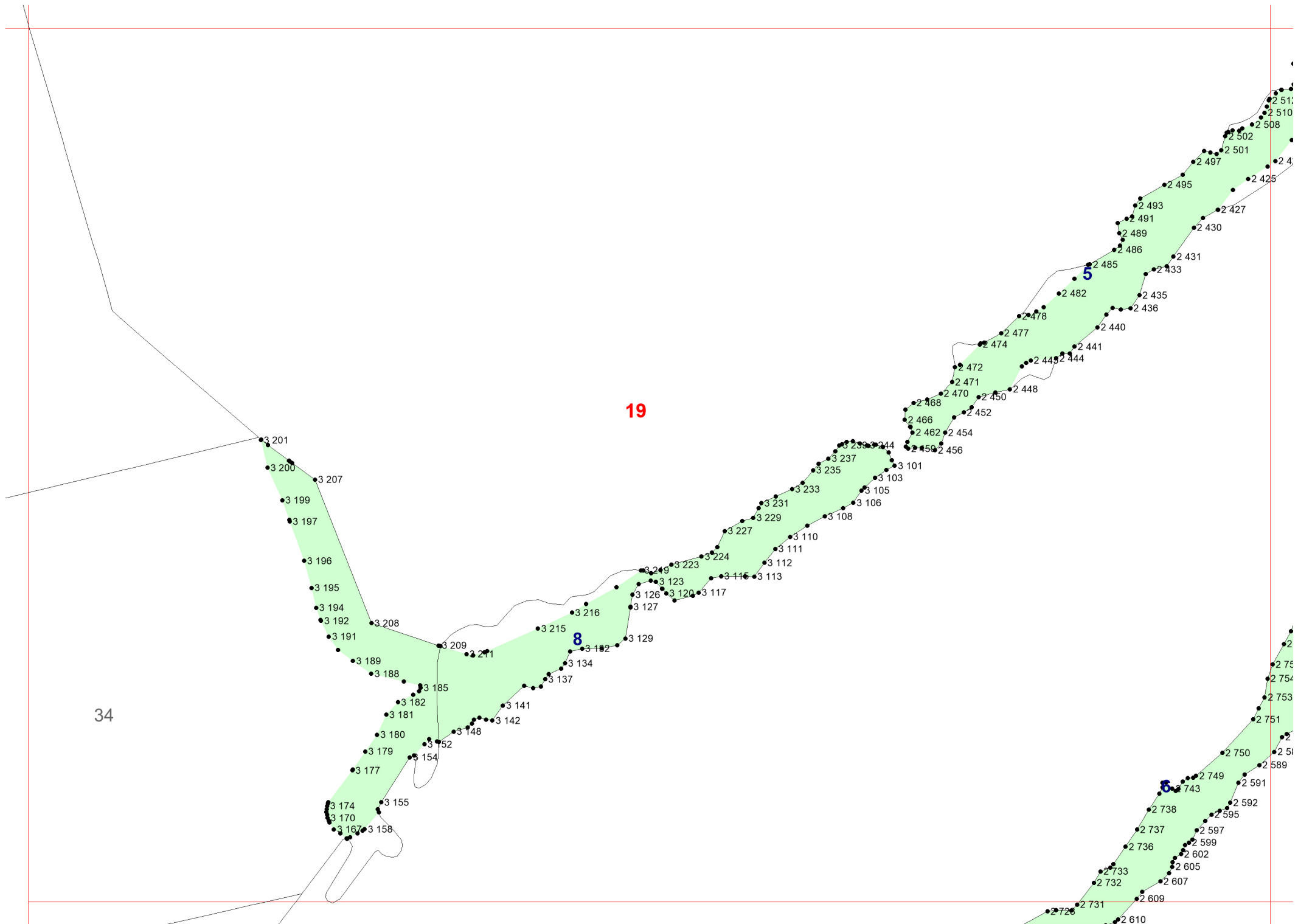

19

5

8

34

20

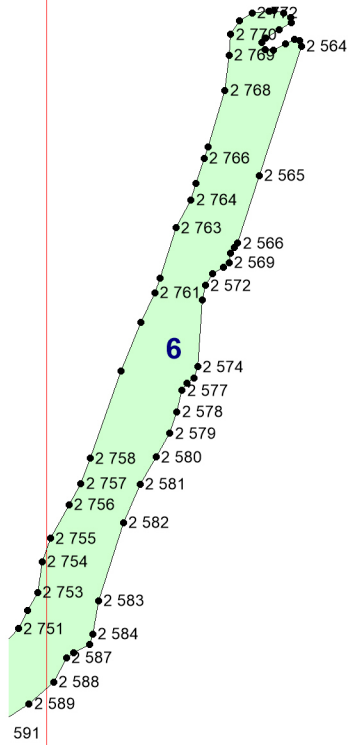
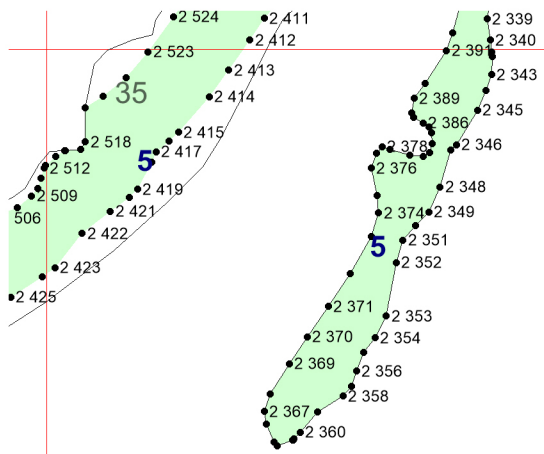

20

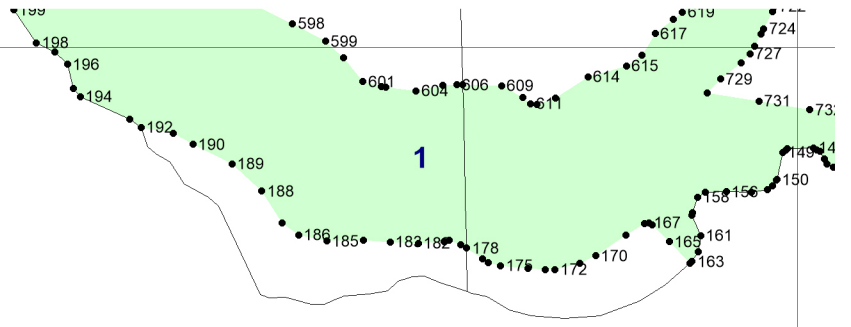
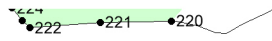

21

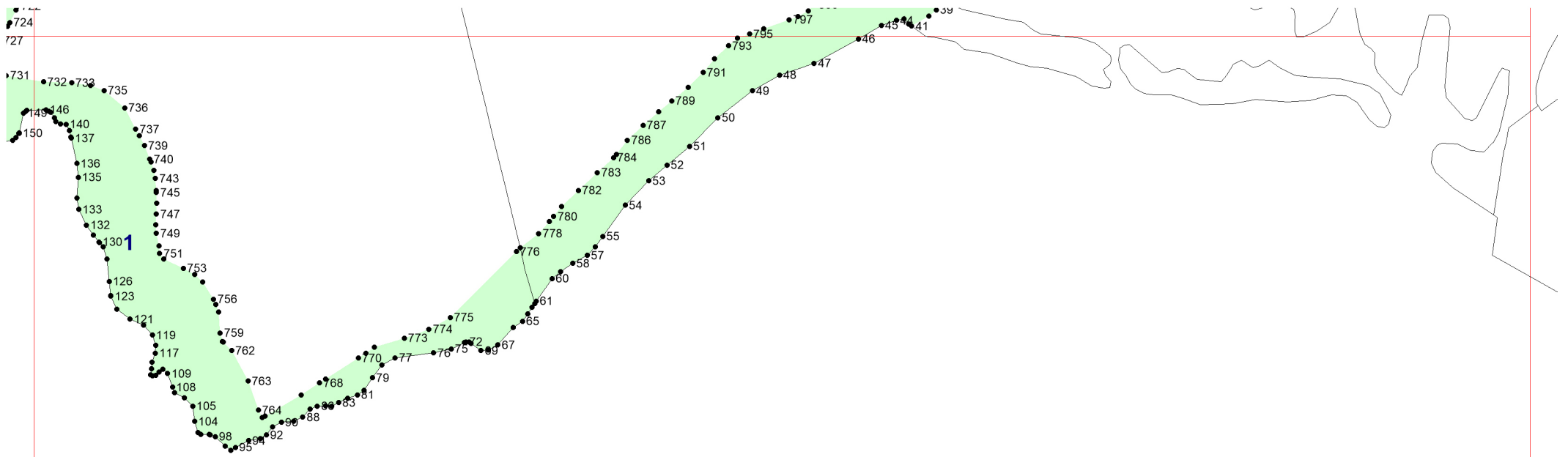

22

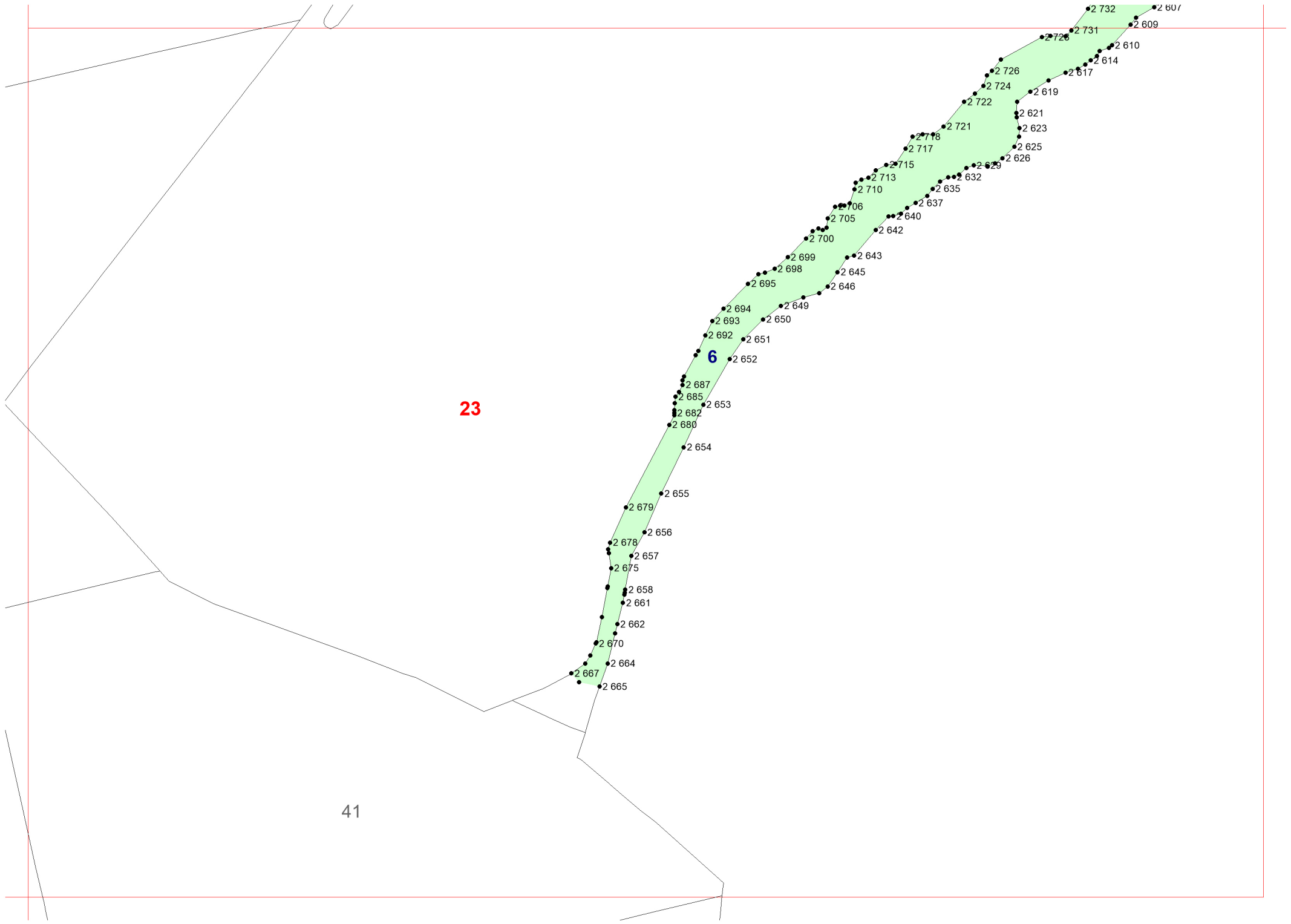

23

6

41

24

- 2732
- 2609
- 2731
- 2610
- 2728
- 2614
- 2726
- 2619
- 2724
- 2617
- 2722
- 2621
- 2721
- 2623
- 2718
- 2625
- 2717
- 2626
- 2715
- 2629
- 2713
- 2632
- 2710
- 2635
- 2706
- 2637
- 2705
- 2640
- 2700
- 2642
- 2699
- 2643
- 2698
- 2645
- 2695
- 2646
- 2694
- 2649
- 2693
- 2650
- 2692
- 2651
- 2687
- 2652
- 2685
- 2653
- 2682
- 2654
- 2680
- 2655
- 2679
- 2656
- 2678
- 2657
- 2675
- 2658
- 2661
- 2670
- 2662
- 2667
- 2664
- 2665

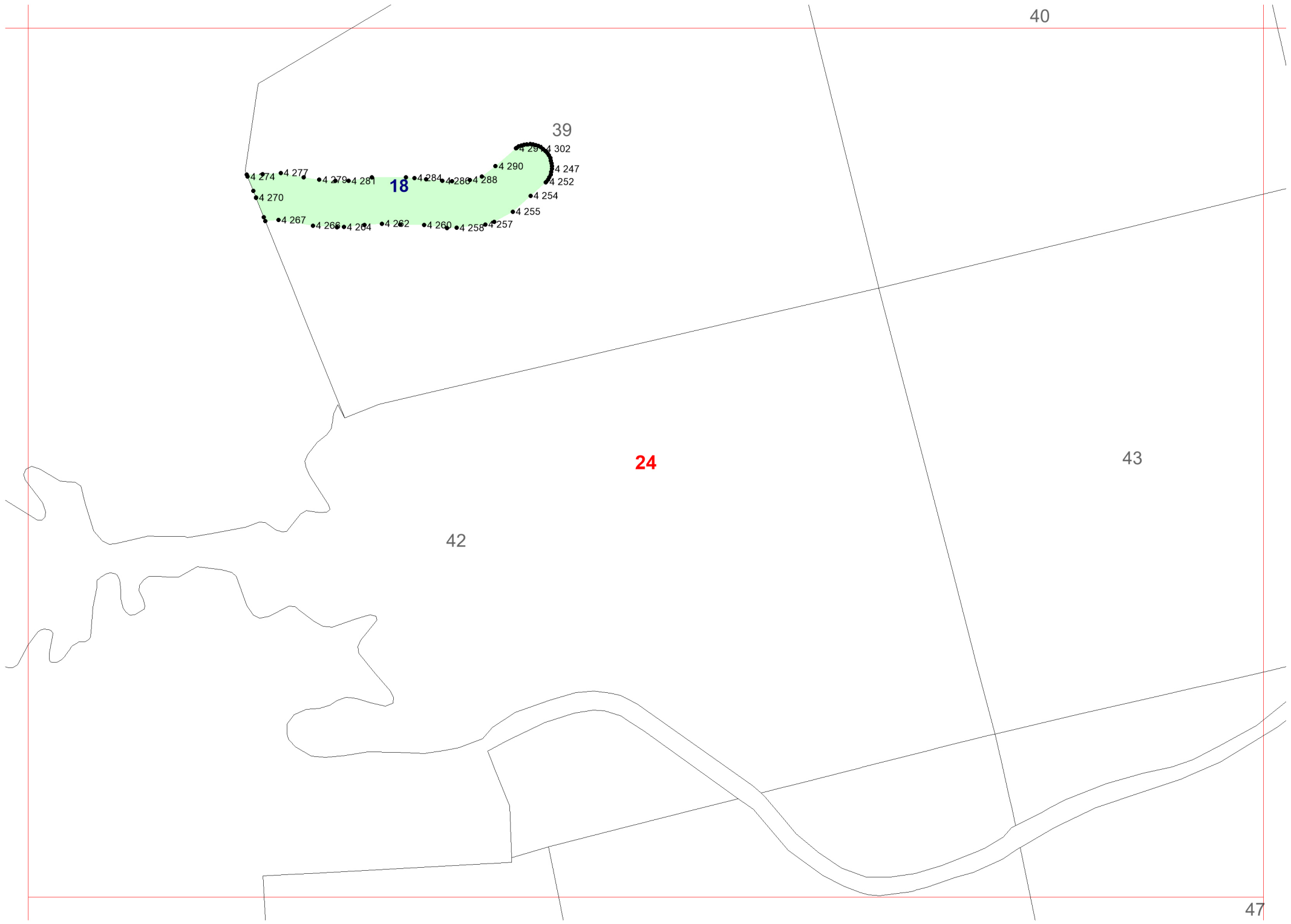

40

39

18

24

43

42

25

47

- 4 274
- 4 277
- 4 279
- 4 281
- 4 284
- 4 286
- 4 288
- 4 290
- 4 292
- 4 294
- 4 296
- 4 298
- 4 300
- 4 302
- 4 247
- 4 252
- 4 254
- 4 255
- 4 257
- 4 258
- 4 260
- 4 262
- 4 264
- 4 266
- 4 267
- 4 270

46

45

12

26

25

51

50

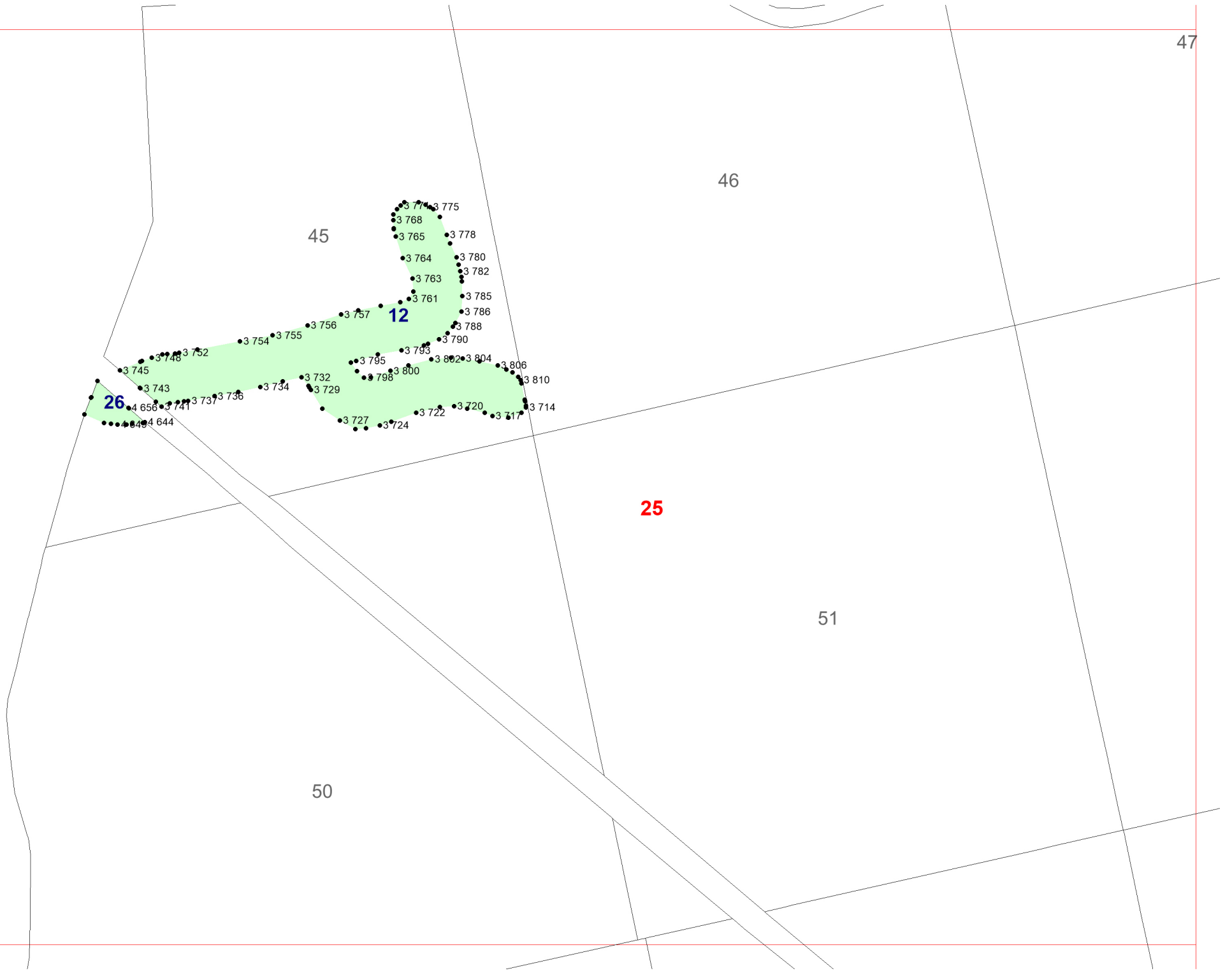

4 658
27
4 660

26

27

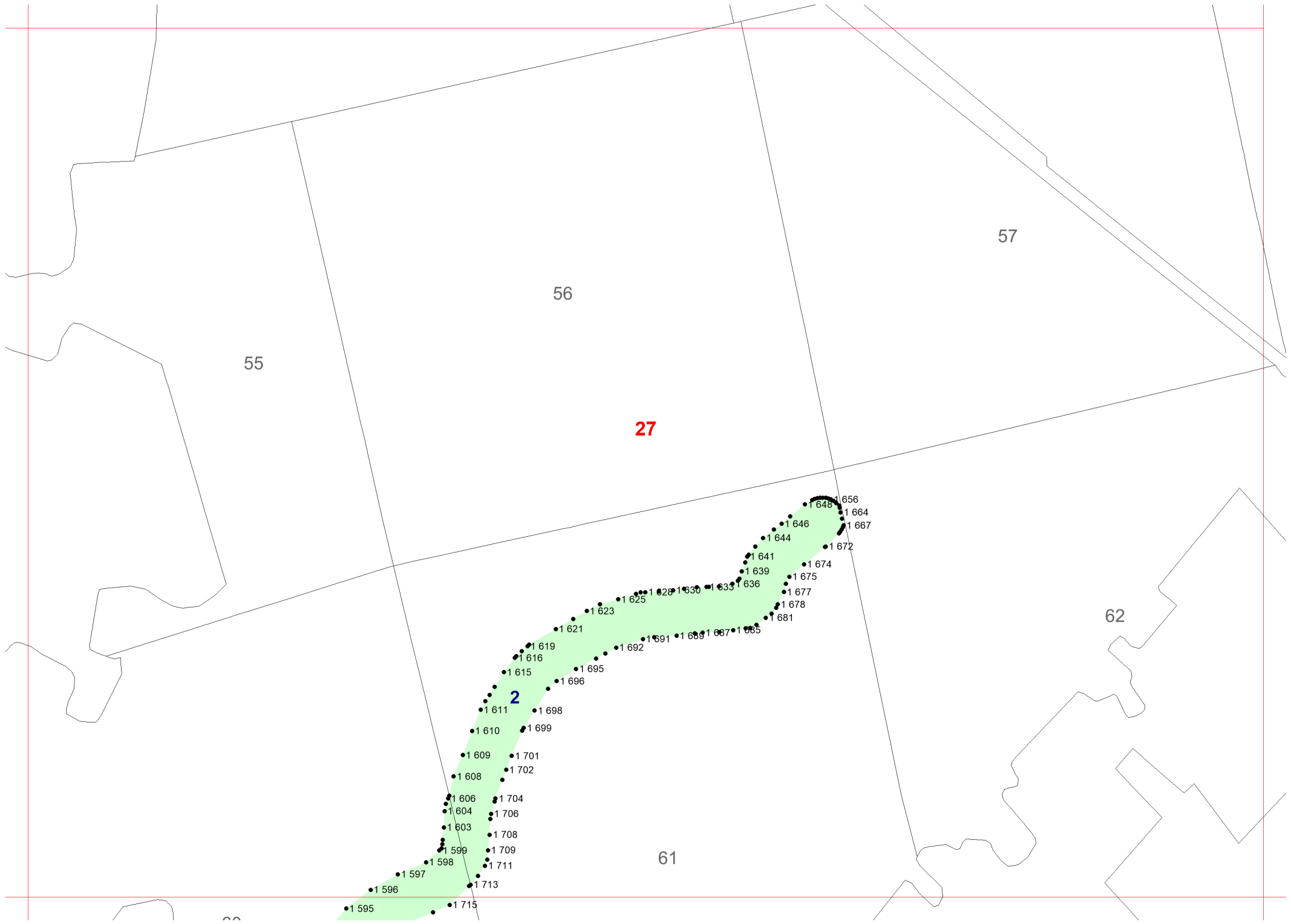

55

56

57

27

62

61

28

2

1 595

1 596

1 597

1 598

1 599

1 603

1 604

1 606

1 608

1 609

1 610

1 611

1 615

1 616

1 619

1 621

1 623

1 625

1 628

1 630

1 631

1 636

1 641

1 644

1 646

1 648

1 656

1 664

1 667

1 672

1 674

1 675

1 677

1 678

1 681

1 685

1 689

1 691

1 692

1 695

1 696

1 698

1 699

1 701

1 702

1 704

1 706

1 708

1 709

1 711

1 713

1 715

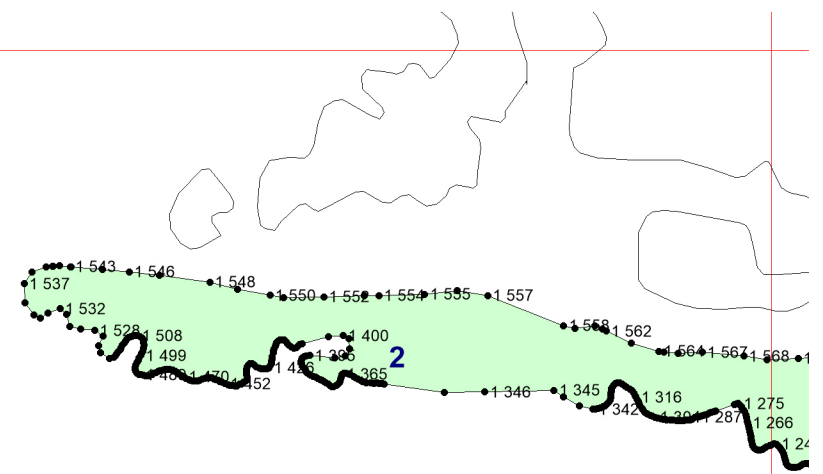

28

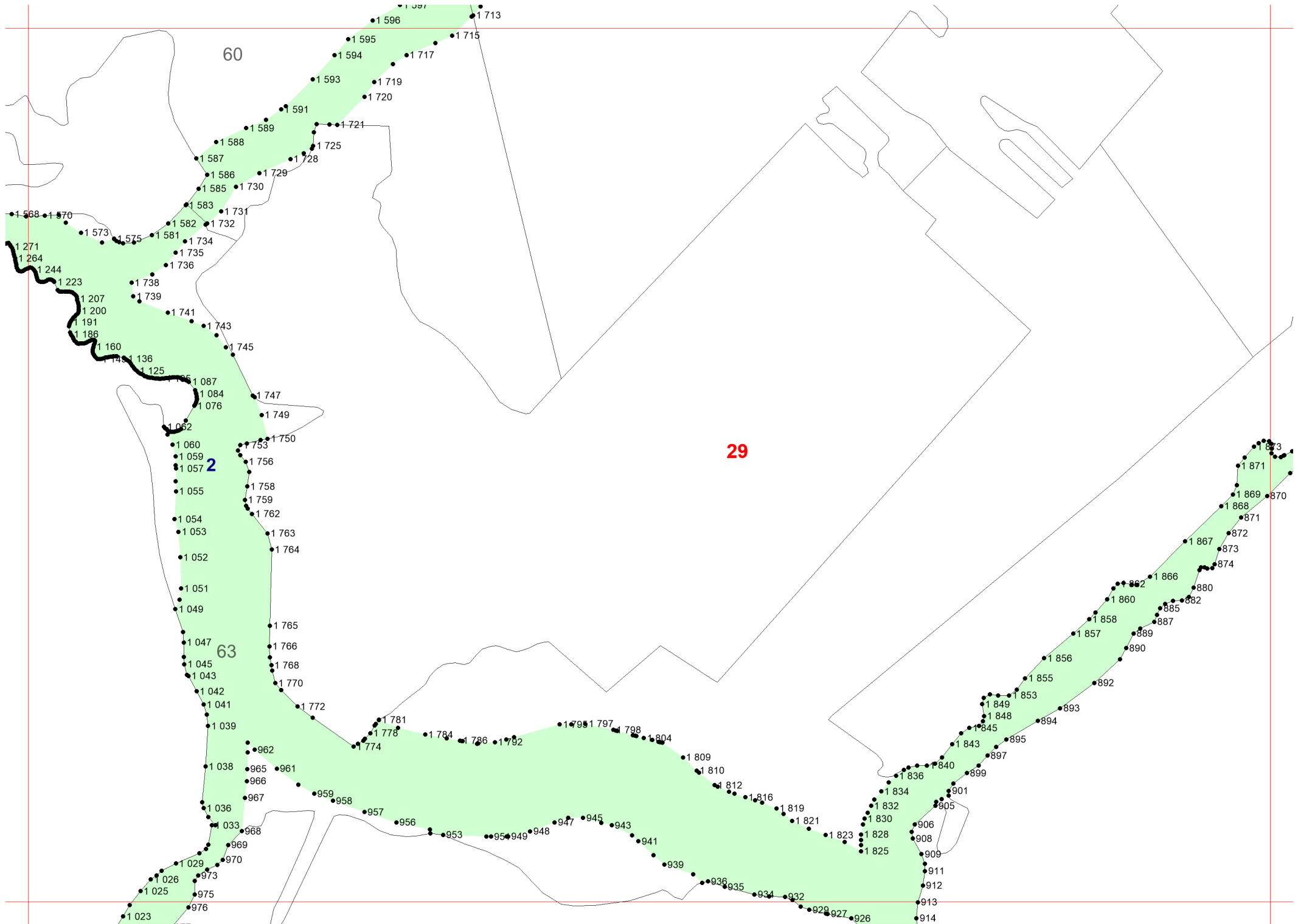

29

60

63

30

2

- 1 568
- 1 570
- 1 573
- 1 575
- 1 581
- 1 582
- 1 583
- 1 585
- 1 586
- 1 587
- 1 588
- 1 589
- 1 591
- 1 593
- 1 594
- 1 595
- 1 596
- 1 713
- 1 715
- 1 717
- 1 719
- 1 720
- 1 721
- 1 725
- 1 728
- 1 729
- 1 730
- 1 731
- 1 732
- 1 734
- 1 735
- 1 736
- 1 738
- 1 739
- 1 741
- 1 743
- 1 745
- 1 747
- 1 749
- 1 750
- 1 753
- 1 756
- 1 758
- 1 759
- 1 762
- 1 763
- 1 764
- 1 765
- 1 766
- 1 768
- 1 770
- 1 772
- 1 774
- 1 778
- 1 781
- 1 784
- 1 786
- 1 792
- 1 795
- 1 797
- 798
- 1 804
- 1 809
- 1 810
- 1 812
- 1 816
- 1 819
- 1 821
- 1 823
- 1 825
- 1 828
- 1 830
- 1 832
- 1 834
- 1 836
- 1 840
- 1 843
- 1 845
- 1 848
- 1 849
- 1 853
- 1 855
- 1 856
- 1 857
- 1 858
- 1 859
- 1 860
- 1 862
- 1 866
- 1 867
- 1 868
- 1 869
- 870
- 871
- 872
- 873
- 874
- 876
- 877
- 880
- 882
- 885
- 887
- 889
- 890
- 892
- 893
- 894
- 895
- 897
- 899
- 901
- 905
- 906
- 908
- 909
- 911
- 912
- 913
- 914
- 932
- 934
- 935
- 936
- 939
- 941
- 943
- 945
- 947
- 948
- 949
- 953
- 956
- 957
- 958
- 959
- 961
- 962
- 965
- 966
- 967
- 968
- 969
- 970
- 973
- 975
- 976
- 1 023
- 1 025
- 1 026
- 1 029
- 1 033
- 1 036
- 1 038
- 1 039
- 1 041
- 1 042
- 1 043
- 1 045
- 1 047
- 1 049
- 1 051
- 1 052
- 1 053
- 1 054
- 1 055
- 1 057
- 1 059
- 1 060
- 1 062
- 1 076
- 1 084
- 1 087
- 1 125
- 1 136
- 1 145
- 1 160
- 1 186
- 1 191
- 1 200
- 1 207
- 1 223
- 1 244
- 1 264
- 1 271

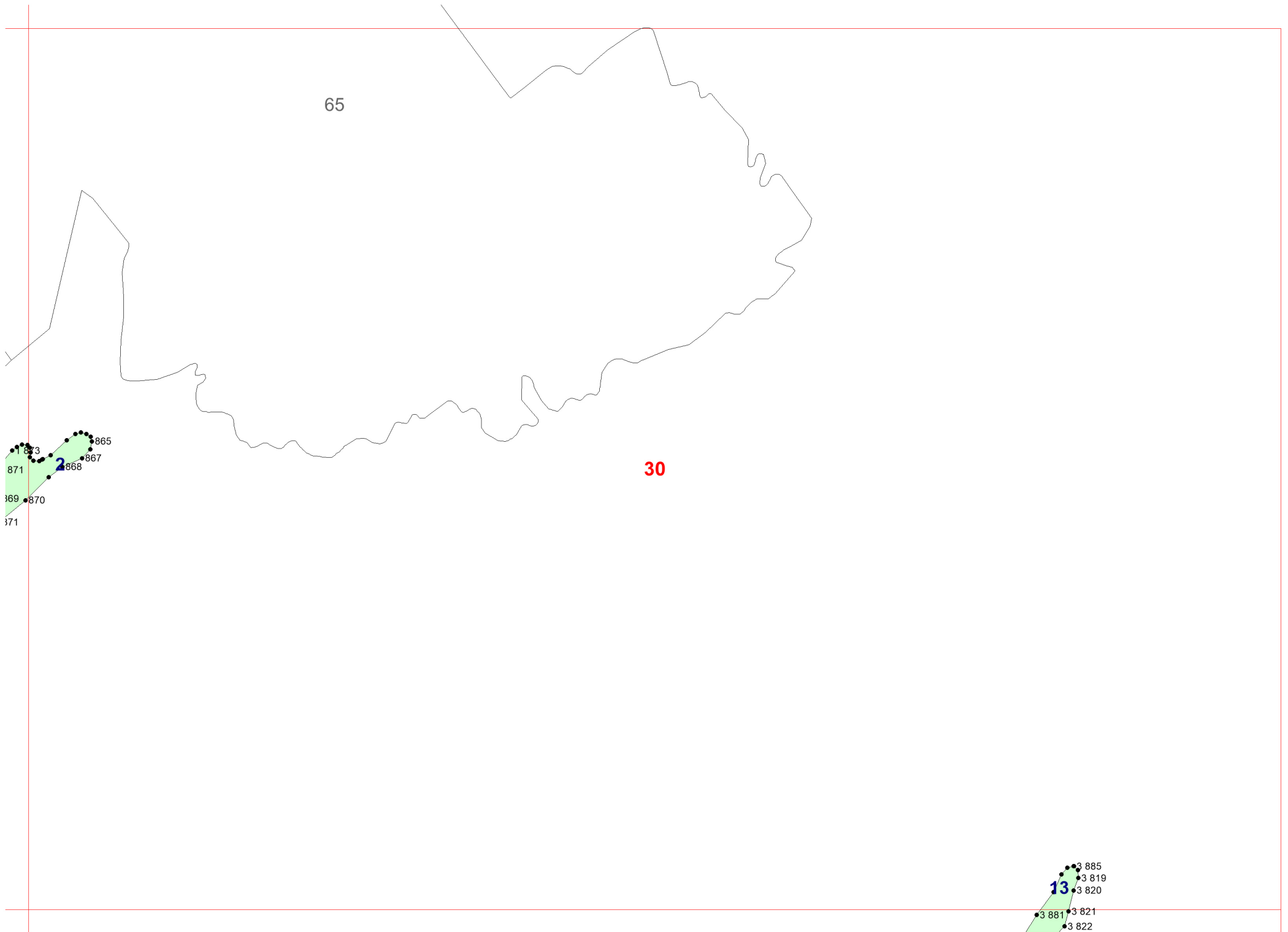

31

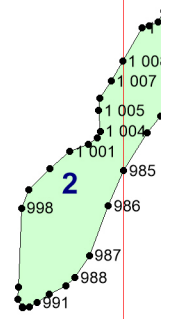

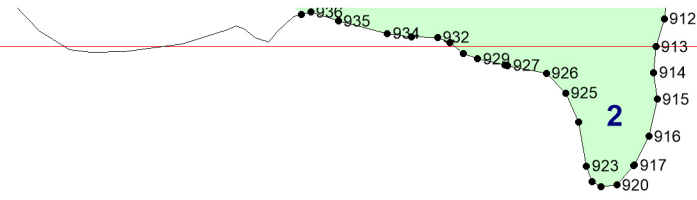
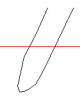
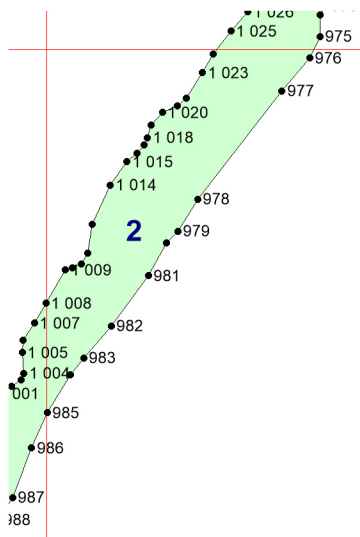

32

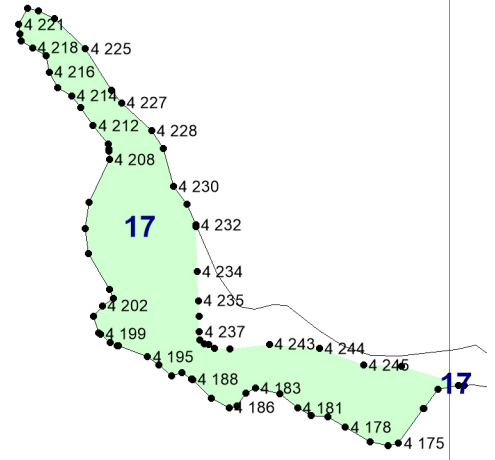

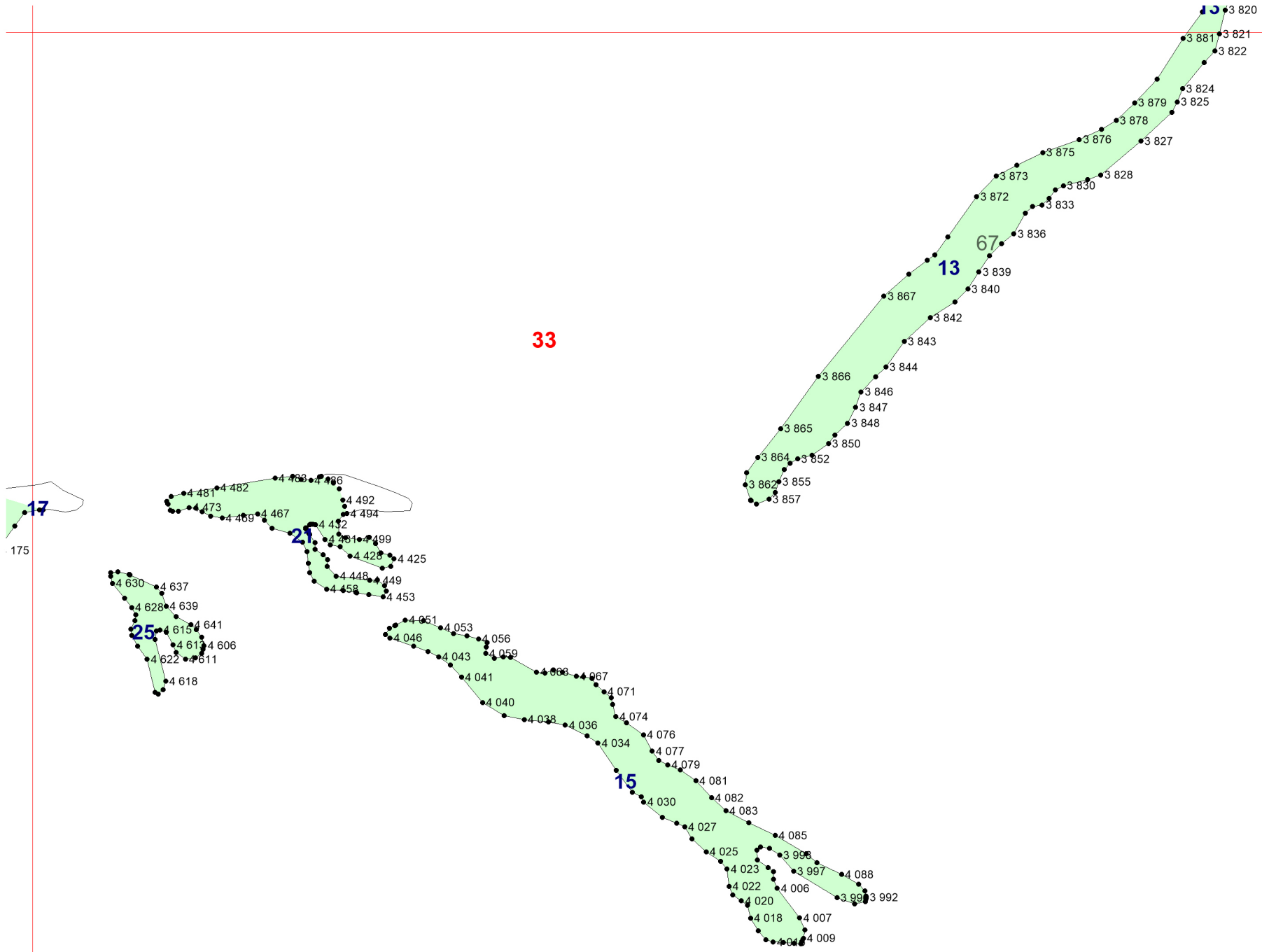

175