

**Графическое описание местоположения границ земель,
на которых располагаются особо защитные участки
лесов «участки лесов вокруг сельских населенных
пунктов и садовых товариществ»,
на территории
Резяповского участкового лесничества
Туймазинского лесничества
Республики Башкортостан**

Приложение № 359 к приказу Рослесхоза

от 27.02.2023

№ 201

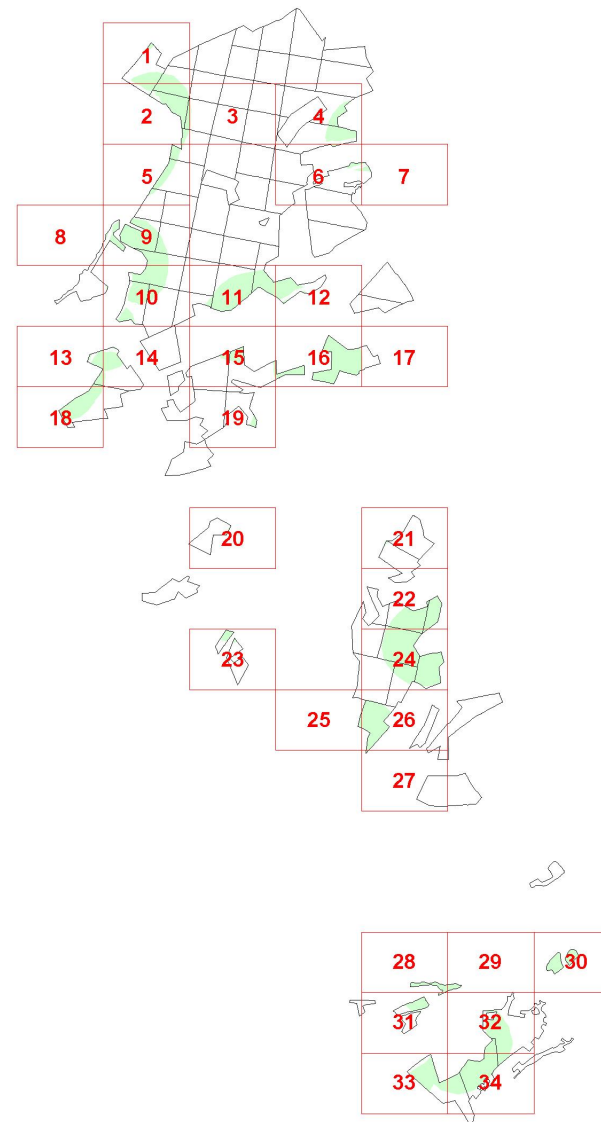

Условные обозначения:

- 1 номера листов
- 3 номера участков
- 61 номера лесных кварталов
- границы лесных кварталов
- границы листов
- границы особо защитных участков лесов
- 45 номера характерных точек границ объекта

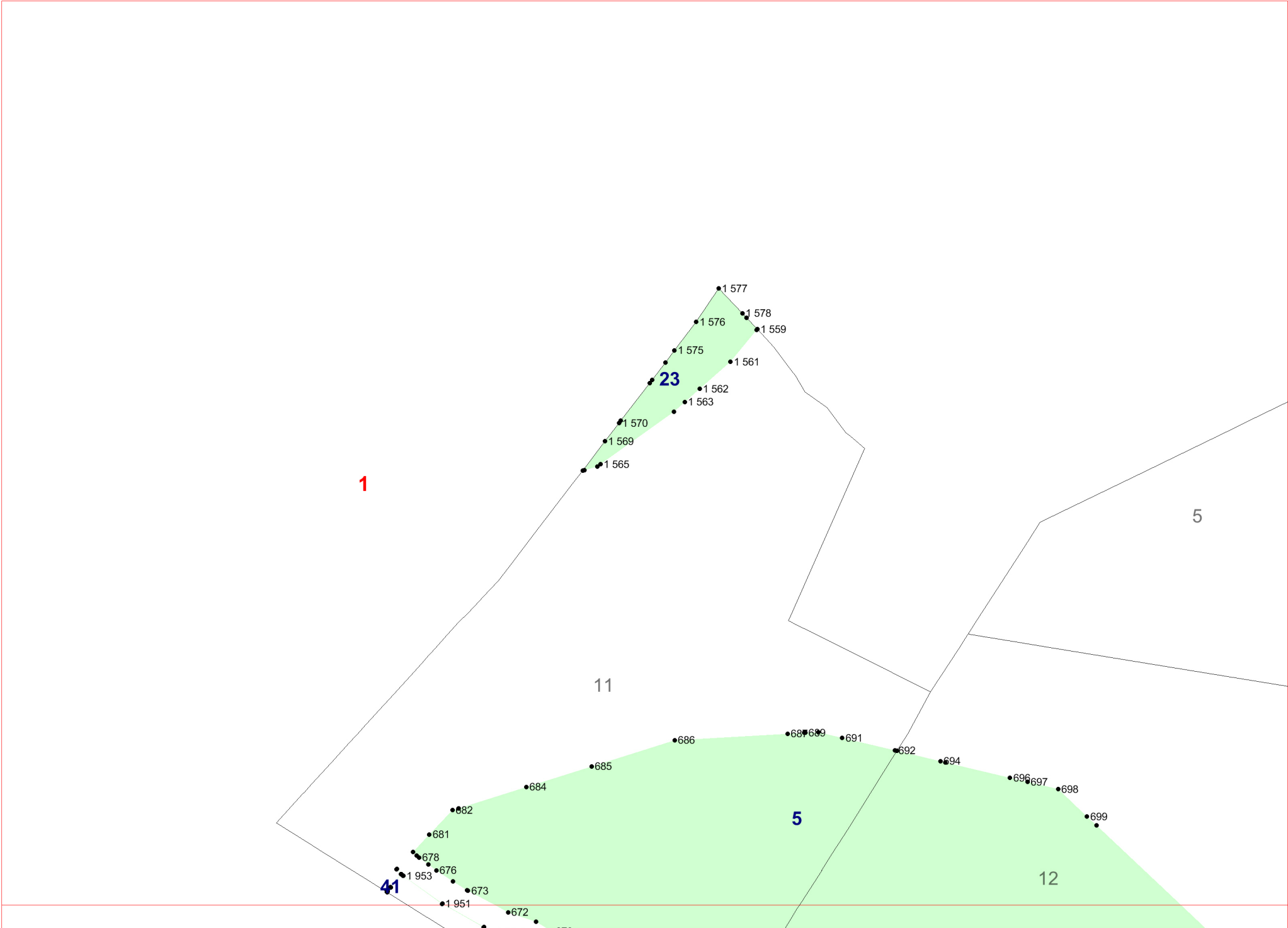

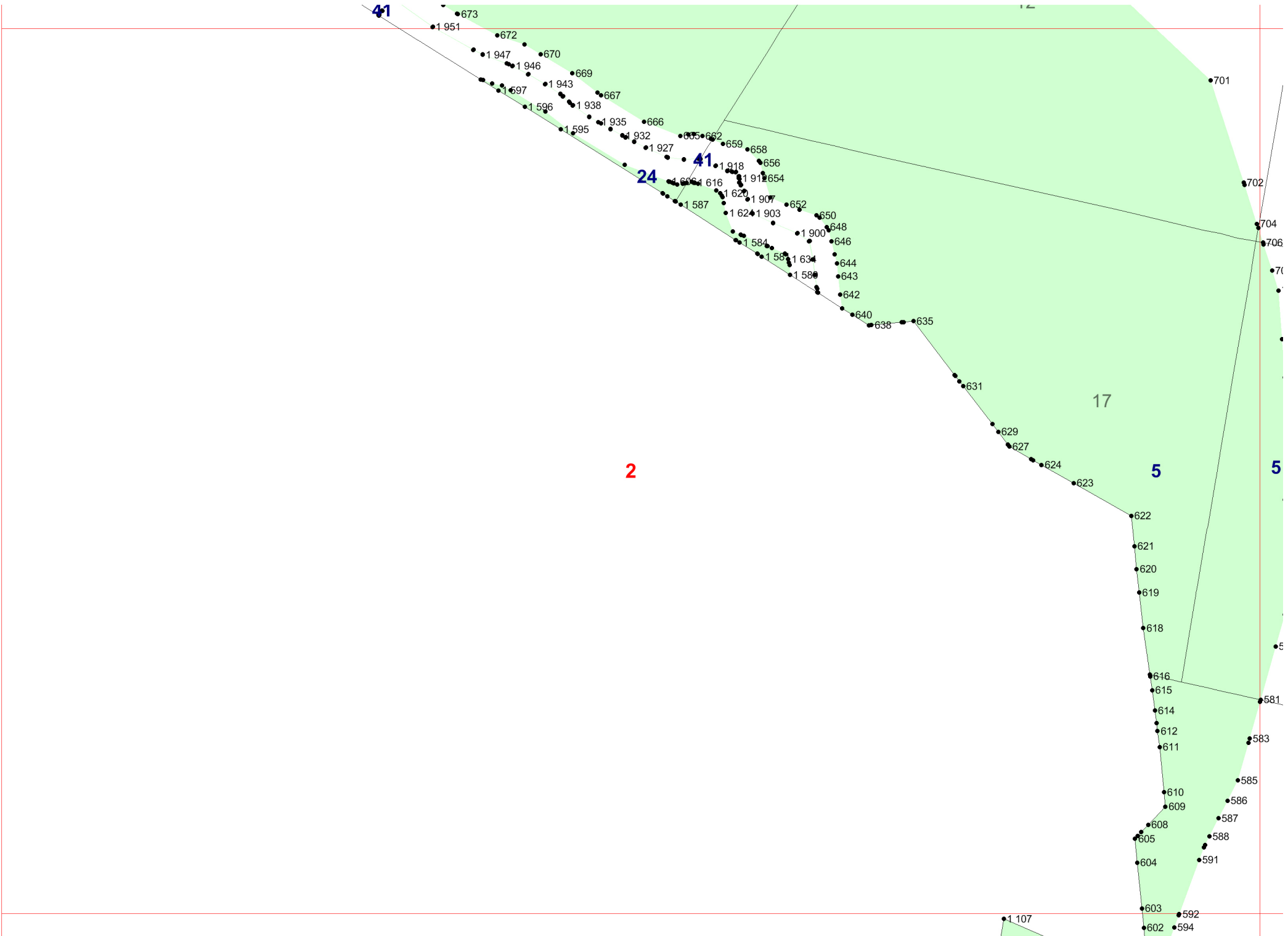

41

- 673
- 1951
- 672
- 1947
- 670
- 1946
- 669
- 1943
- 667
- 1938
- 666
- 1935
- 932
- 1927
- 659
- 658
- 656
- 1918
- 654
- 1916
- 616
- 1912
- 620
- 1907
- 652
- 650
- 648
- 646
- 1900
- 644
- 643
- 642
- 640
- 638
- 635
- 631
- 629
- 627
- 624
- 623
- 622
- 621
- 620
- 619
- 618
- 616
- 615
- 614
- 612
- 611
- 610
- 609
- 608
- 605
- 604
- 603
- 602
- 592
- 594
- 591
- 588
- 587
- 586
- 585
- 583
- 581
- 5
- 701
- 702
- 704
- 706
- 70

24

2

17

5

5

3

1 107

13

14

15

3

18

19

20

4

5

702

704

706

708

709

710

711

568

570

571

573

574

576

577

578

580

581

583

585

86

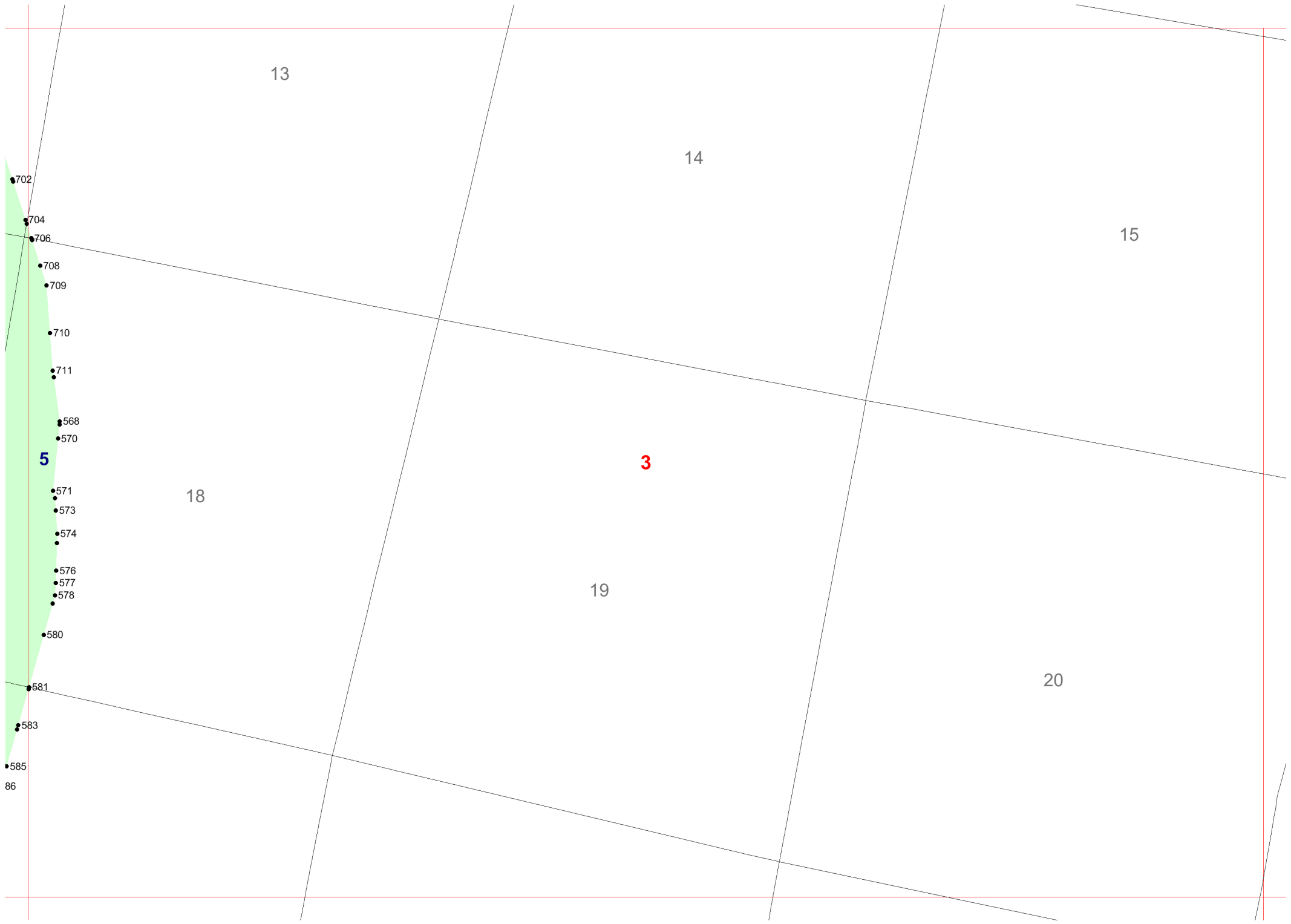
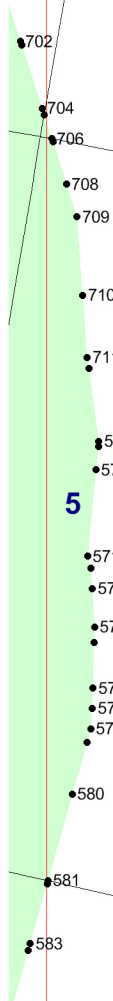

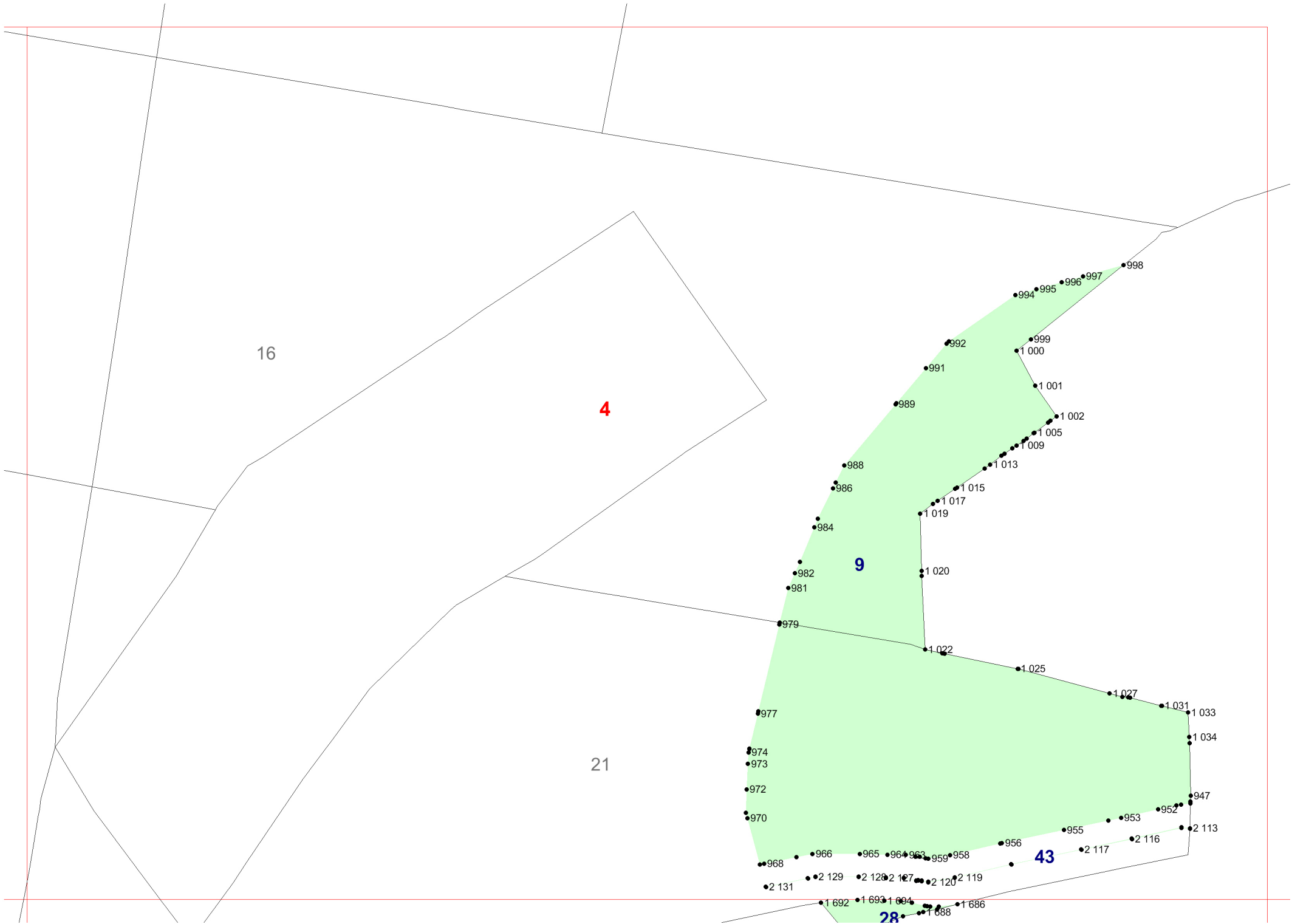

16

4

9

21

28

43

5

- 970
- 972
- 973
- 974
- 977
- 979
- 981
- 982
- 984
- 986
- 988
- 989
- 991
- 992
- 994
- 995
- 996
- 997
- 998
- 999
- 1000
- 1001
- 1002
- 1005
- 1009
- 1013
- 1015
- 1017
- 1019
- 1020
- 1022
- 1025
- 1027
- 1031
- 1033
- 1034
- 947
- 952
- 953
- 955
- 956
- 958
- 959
- 963
- 964
- 965
- 966
- 968
- 2113
- 2116
- 2117
- 2119
- 2120
- 2127
- 2128
- 2129
- 2131
- 1686
- 1688
- 1693
- 1694
- 1692

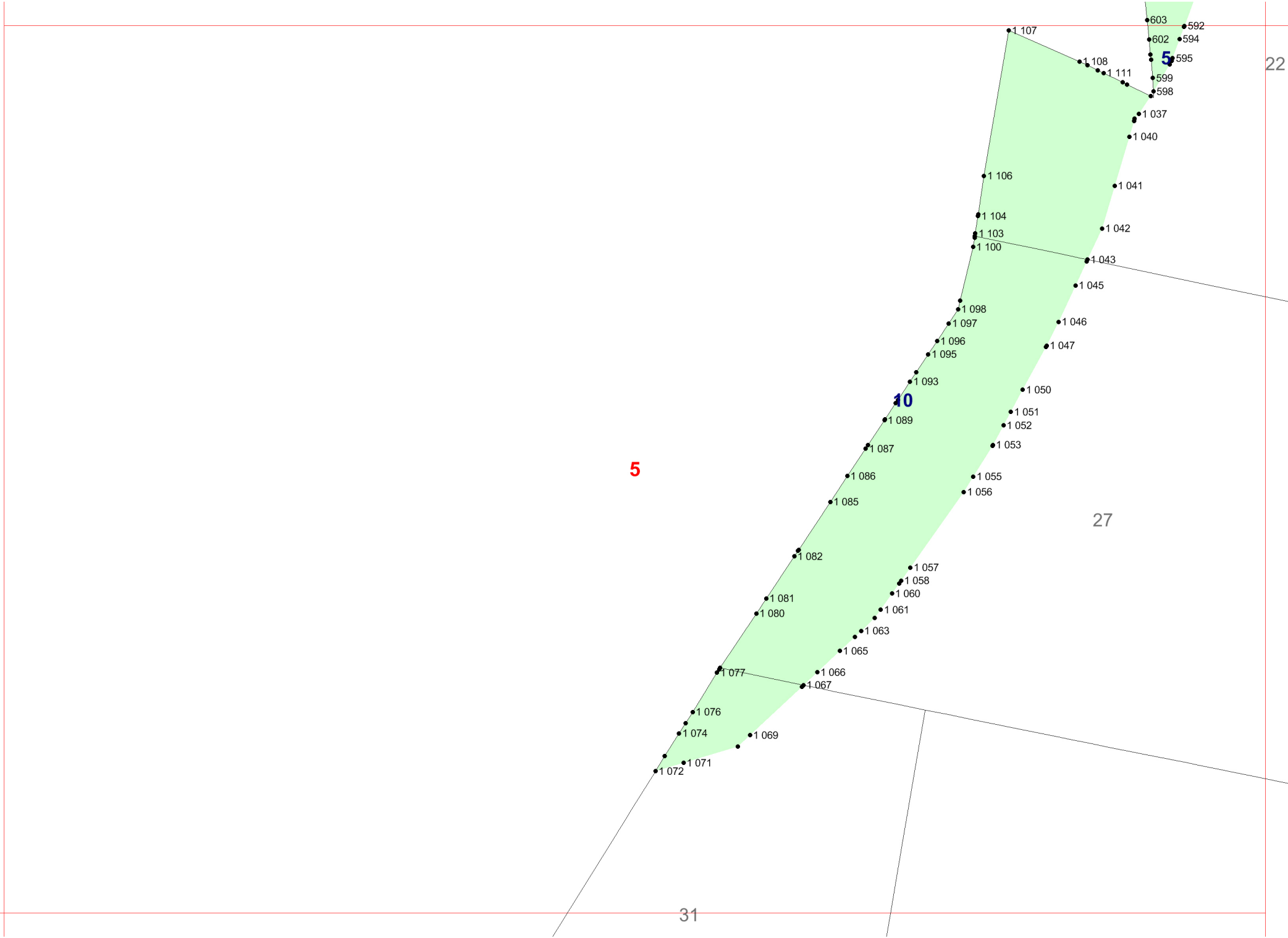

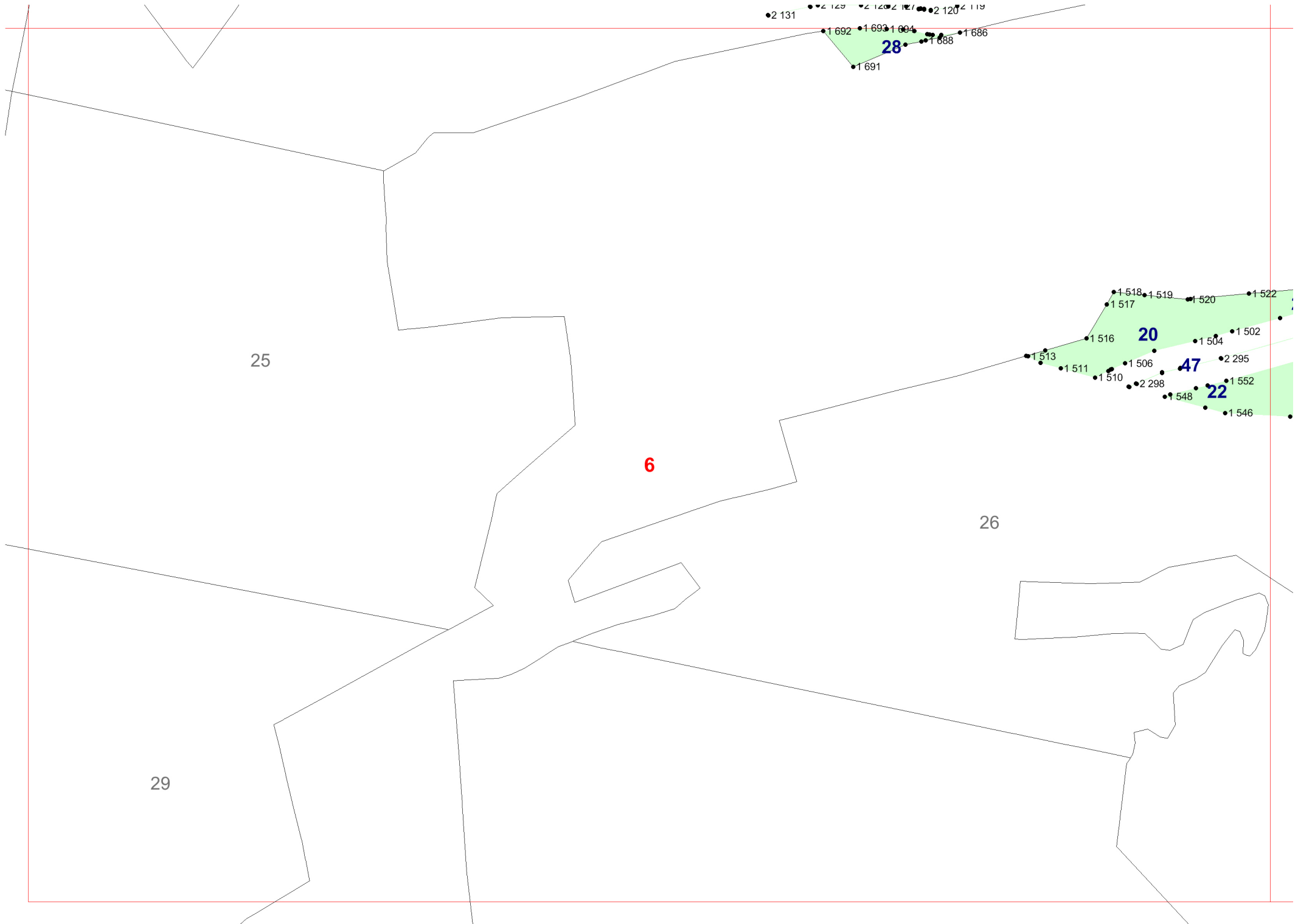



20

47

22

• 1 522

• 1 523

• 1 500

• 2 293

• 1 533

• 1 557

• 1 545

• 1 544

• 1 543

7

8

25

2

1.3

2.082

16

42

2.057

2.060

2.061

2.063

40

9

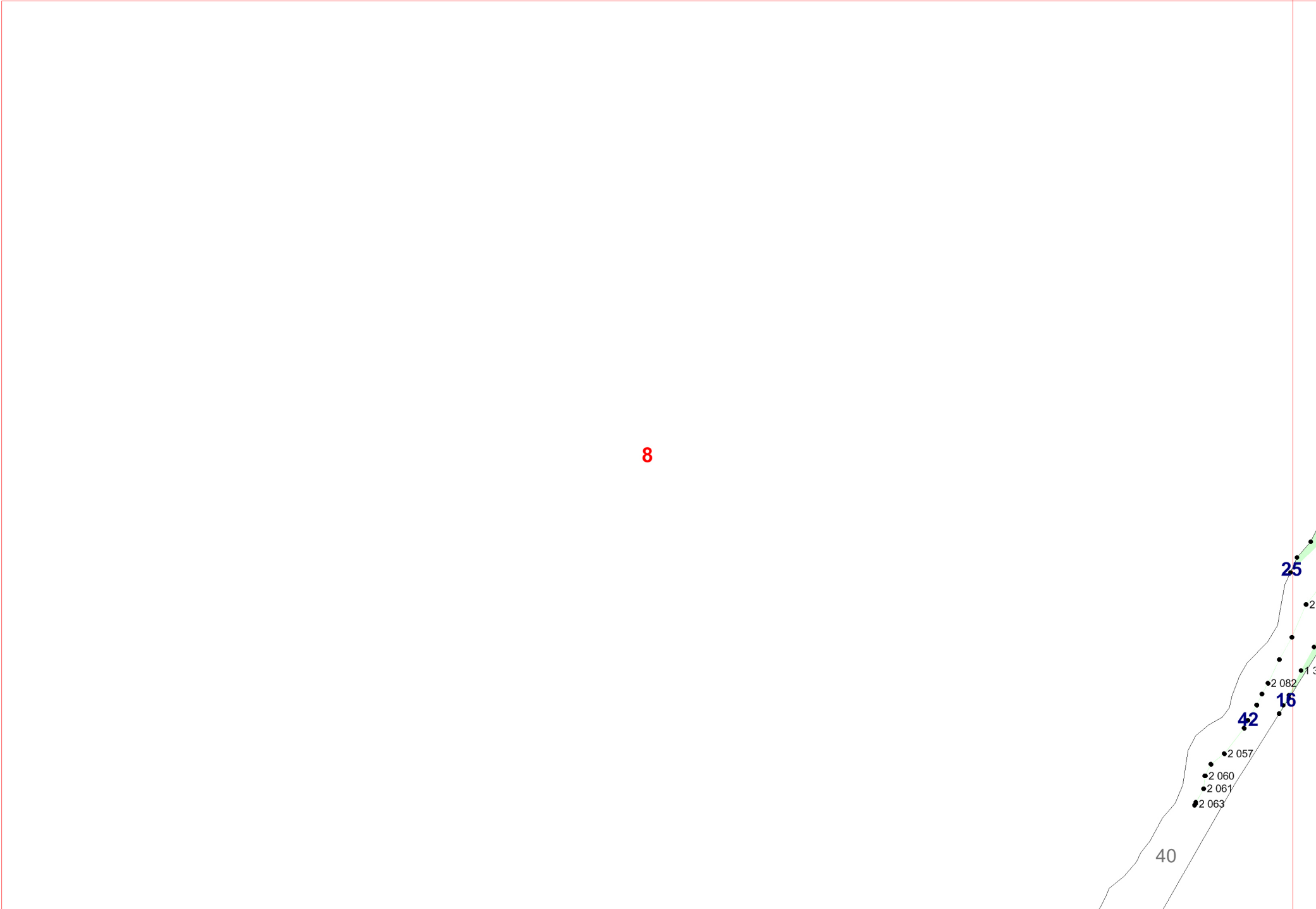

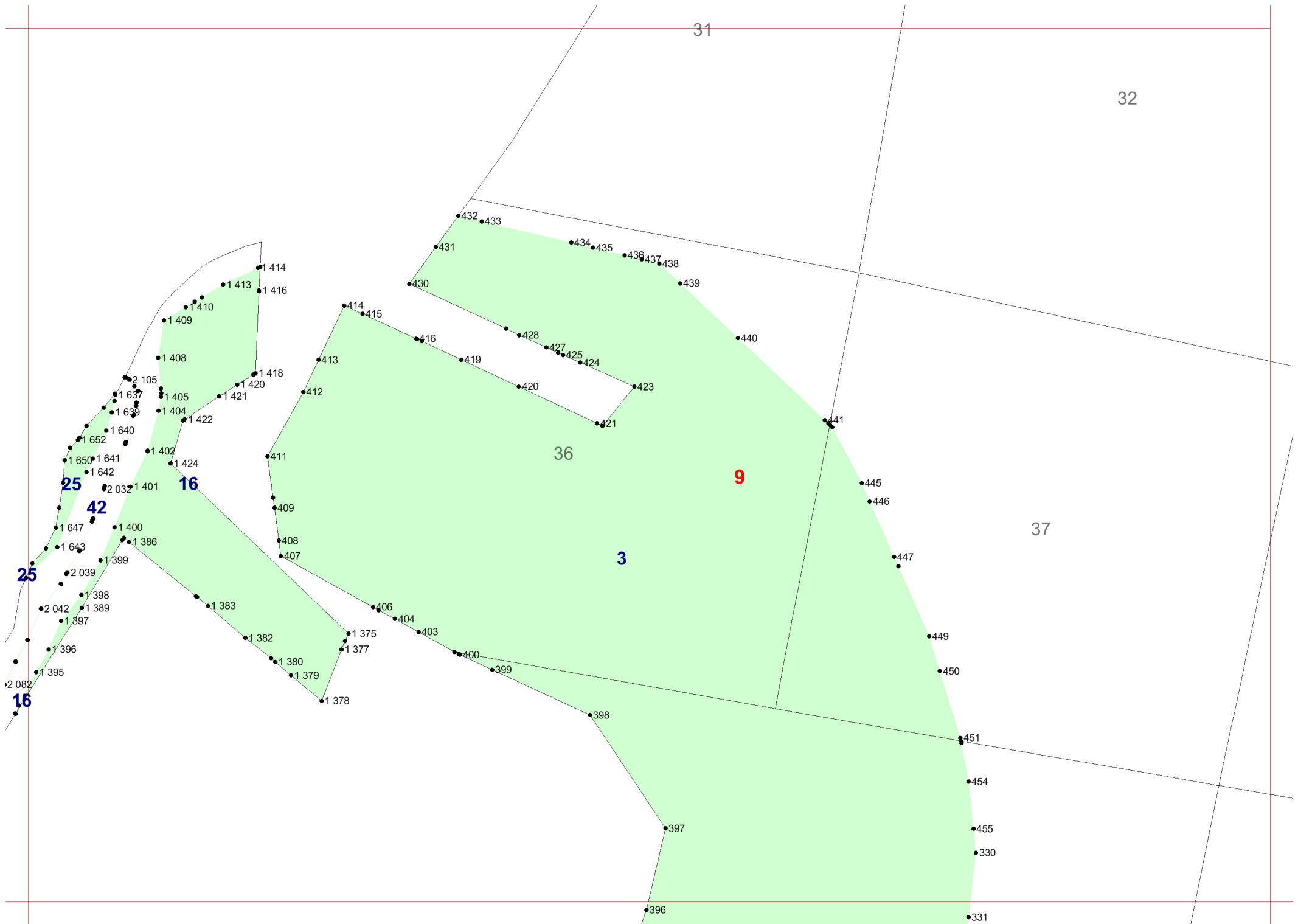

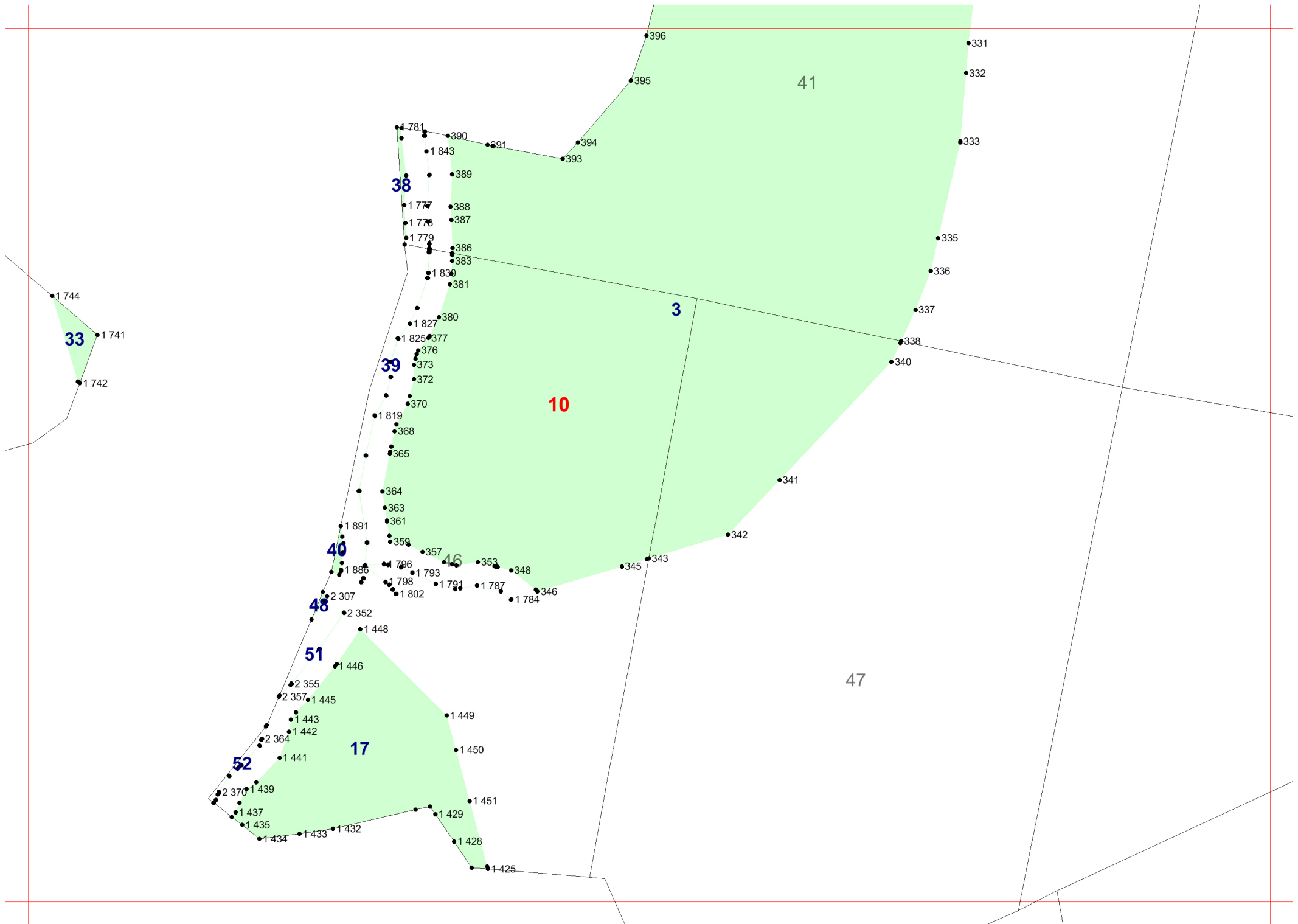

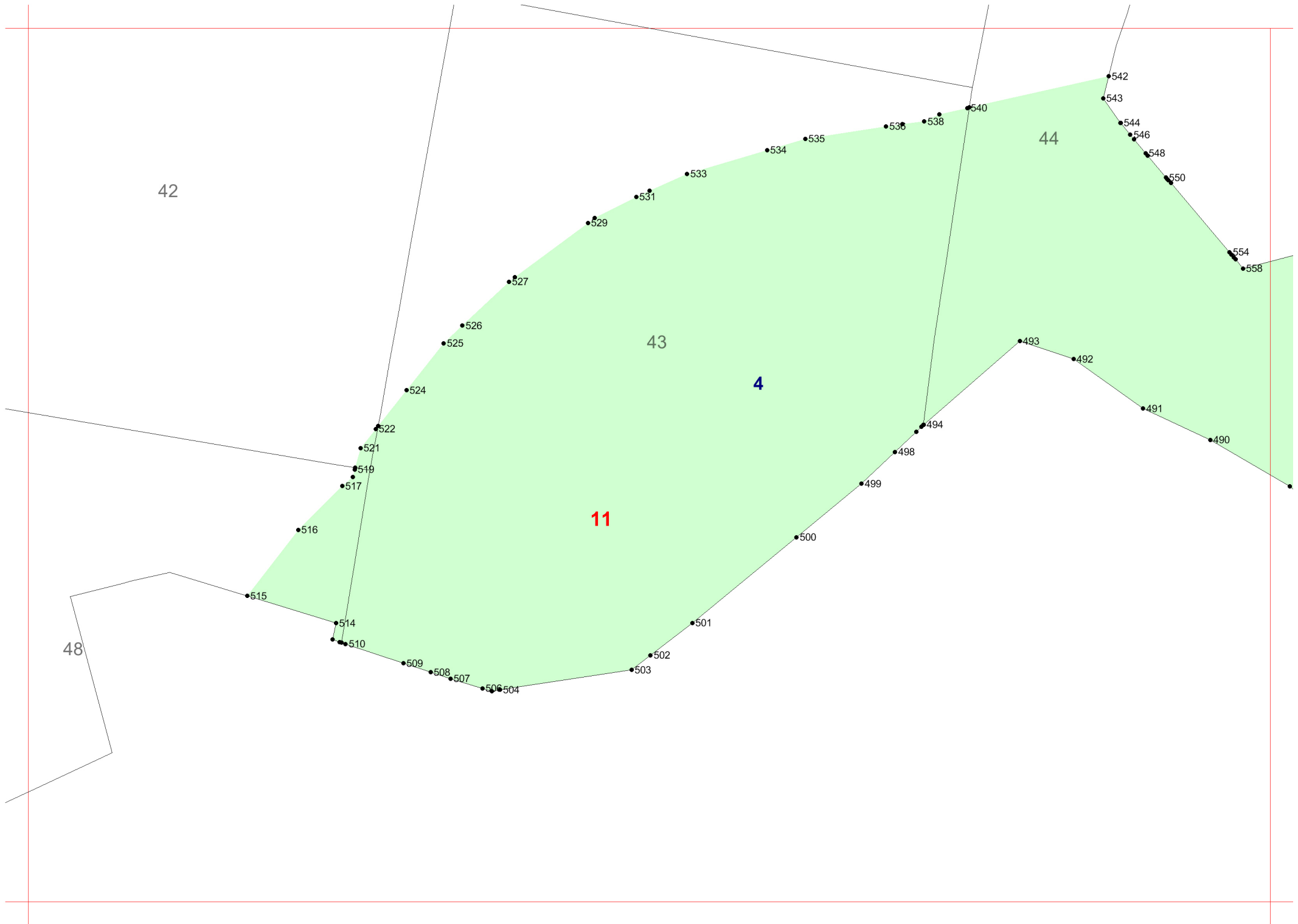

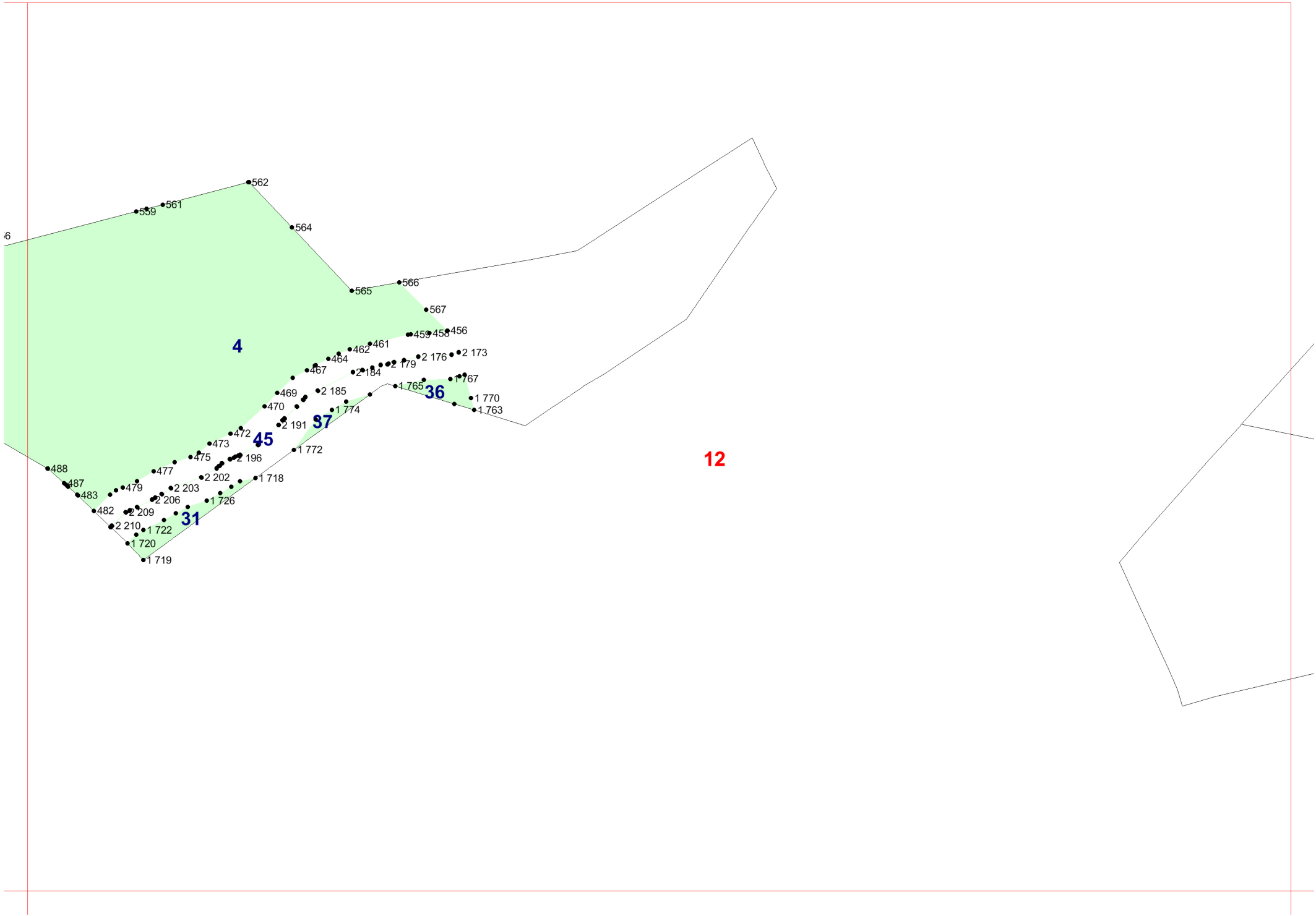

13

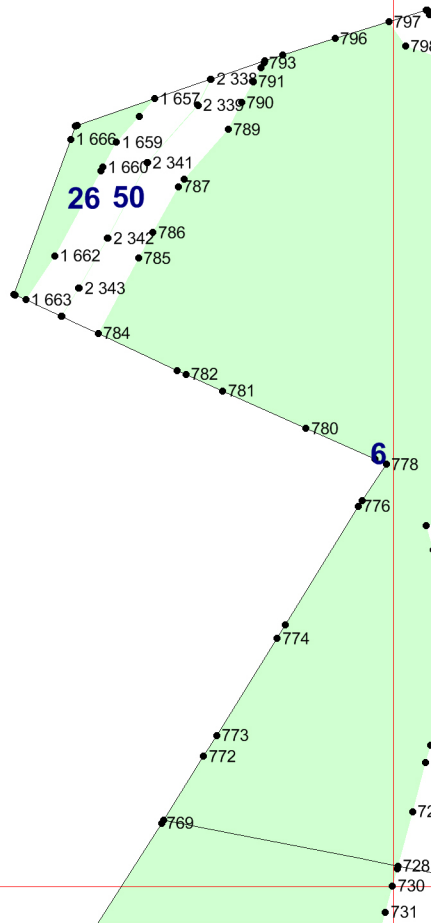

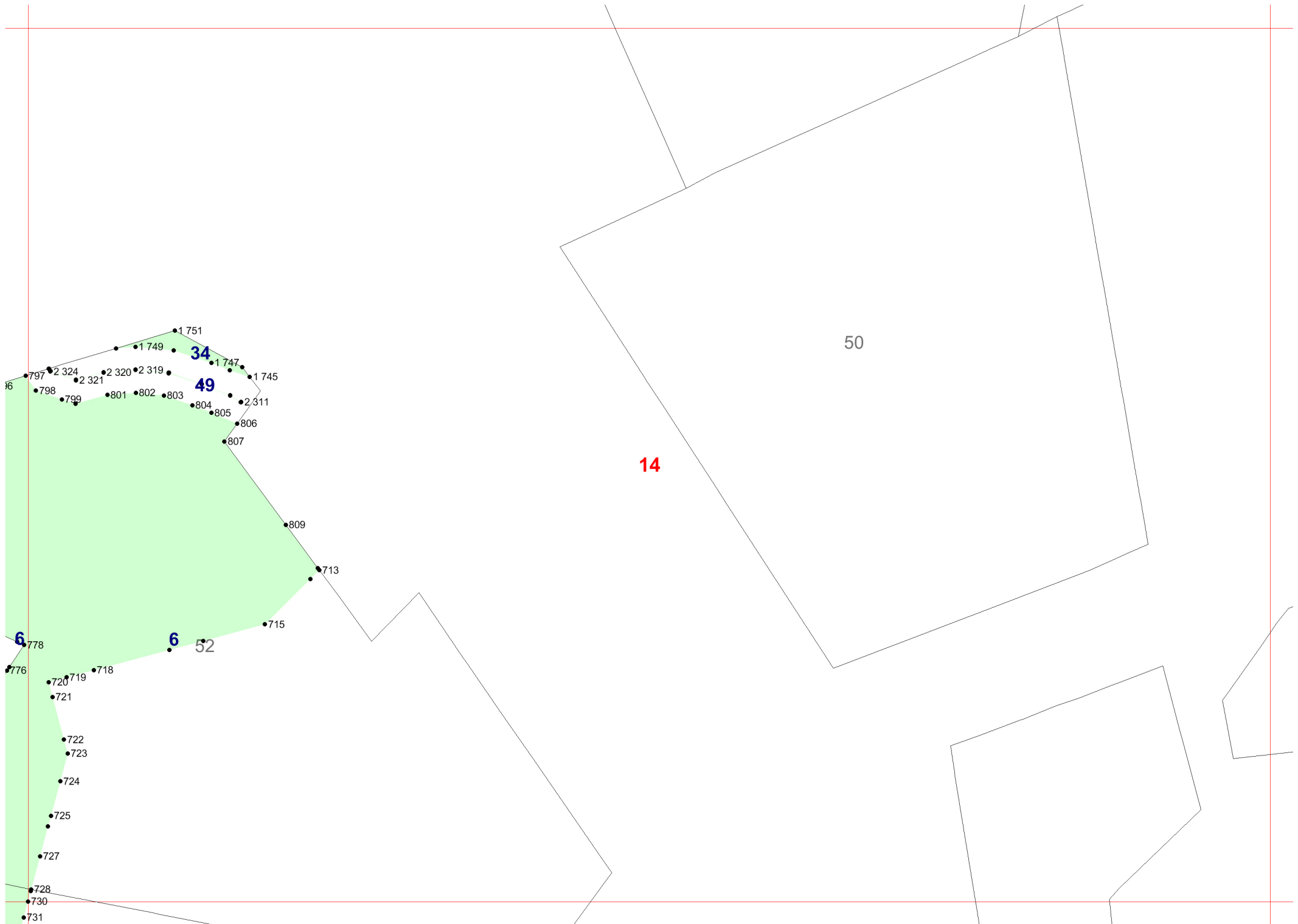

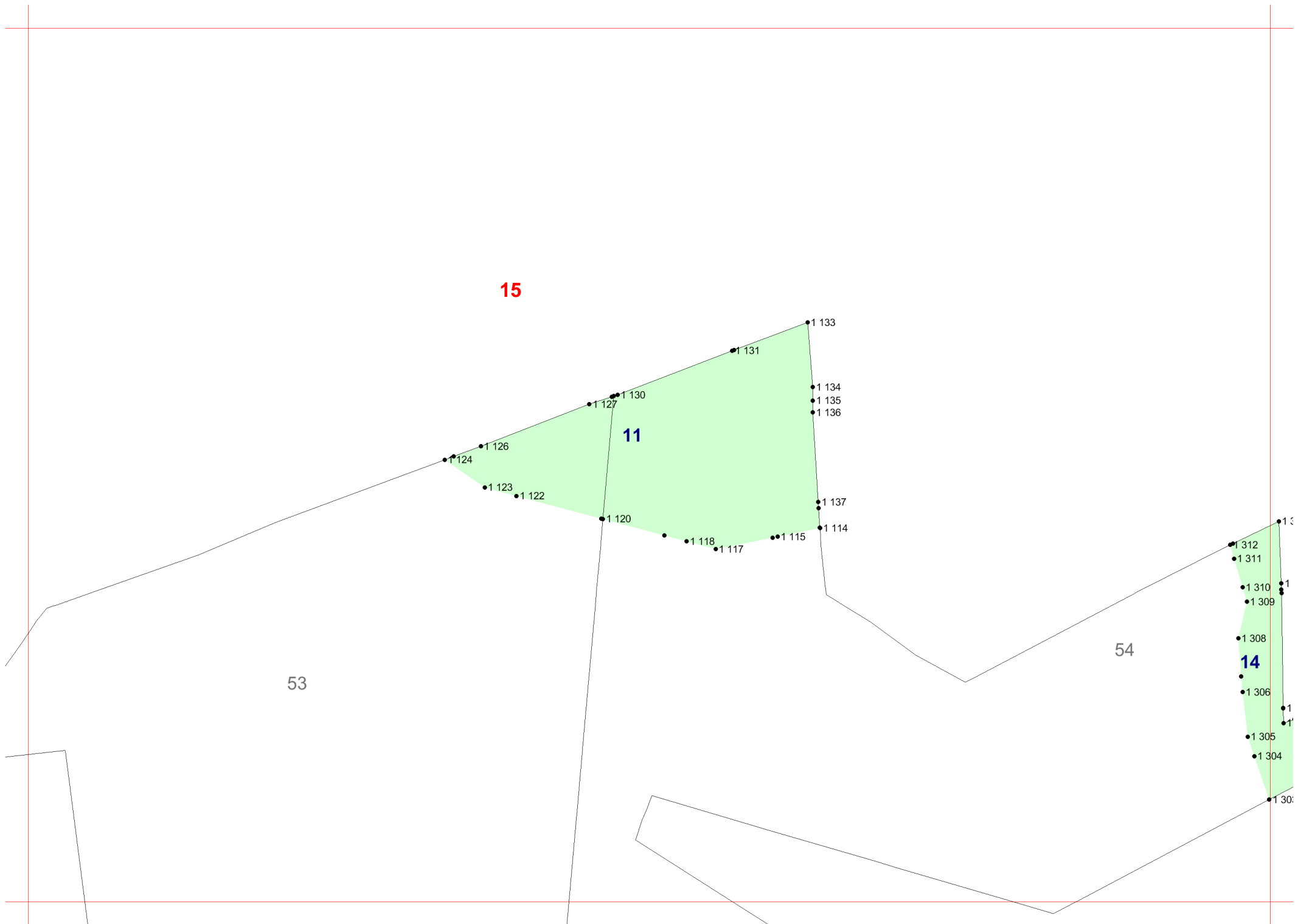

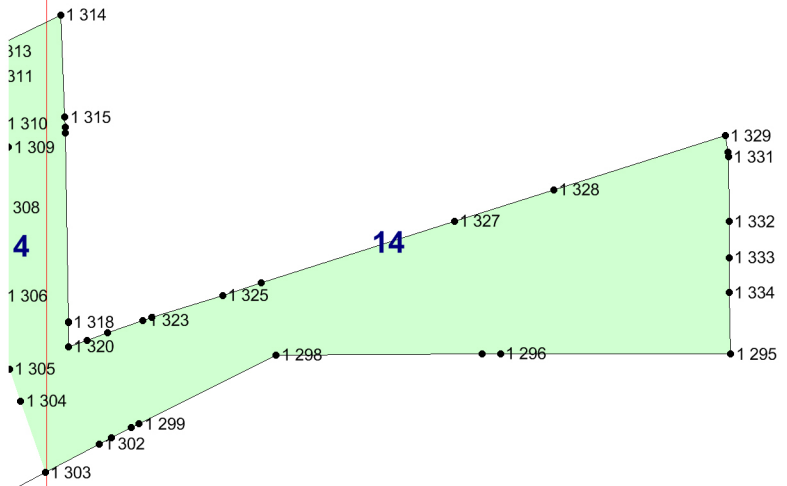

16

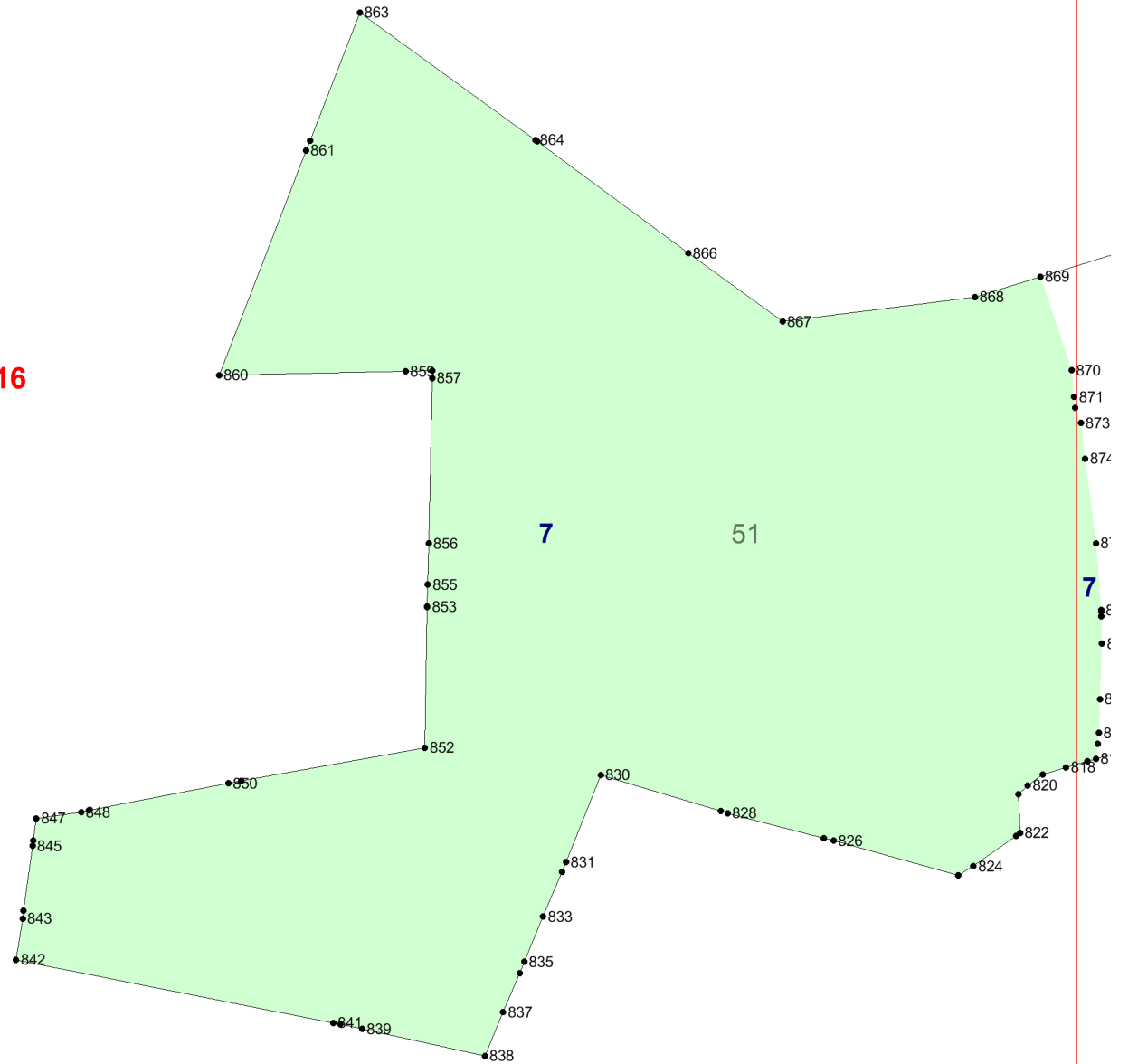

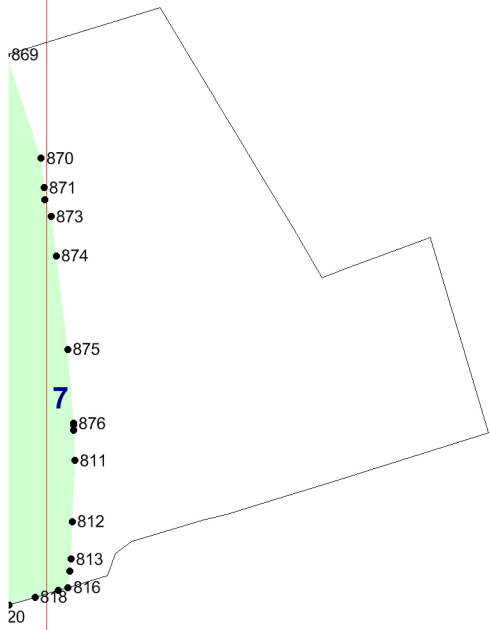

17

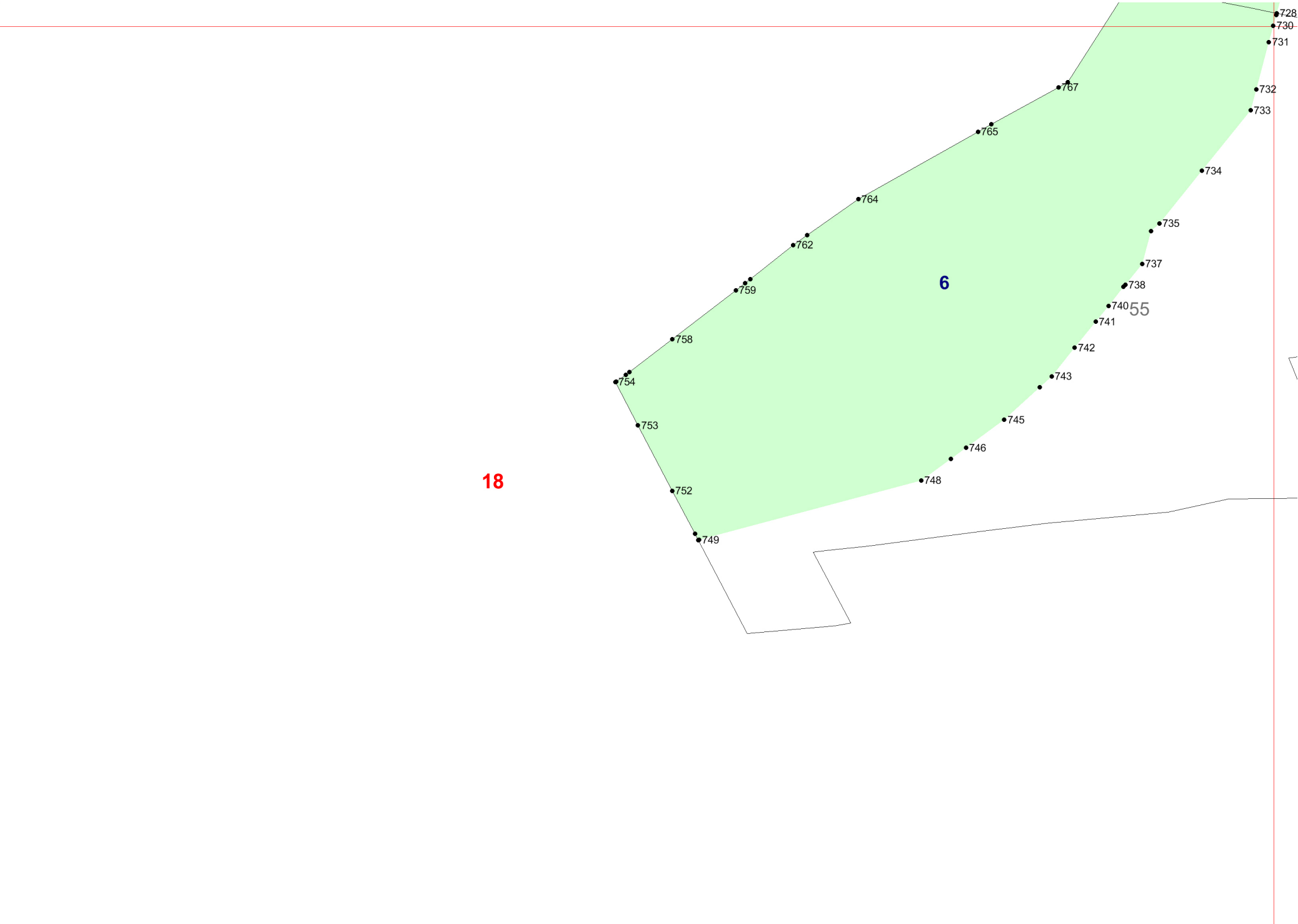

18

6

55

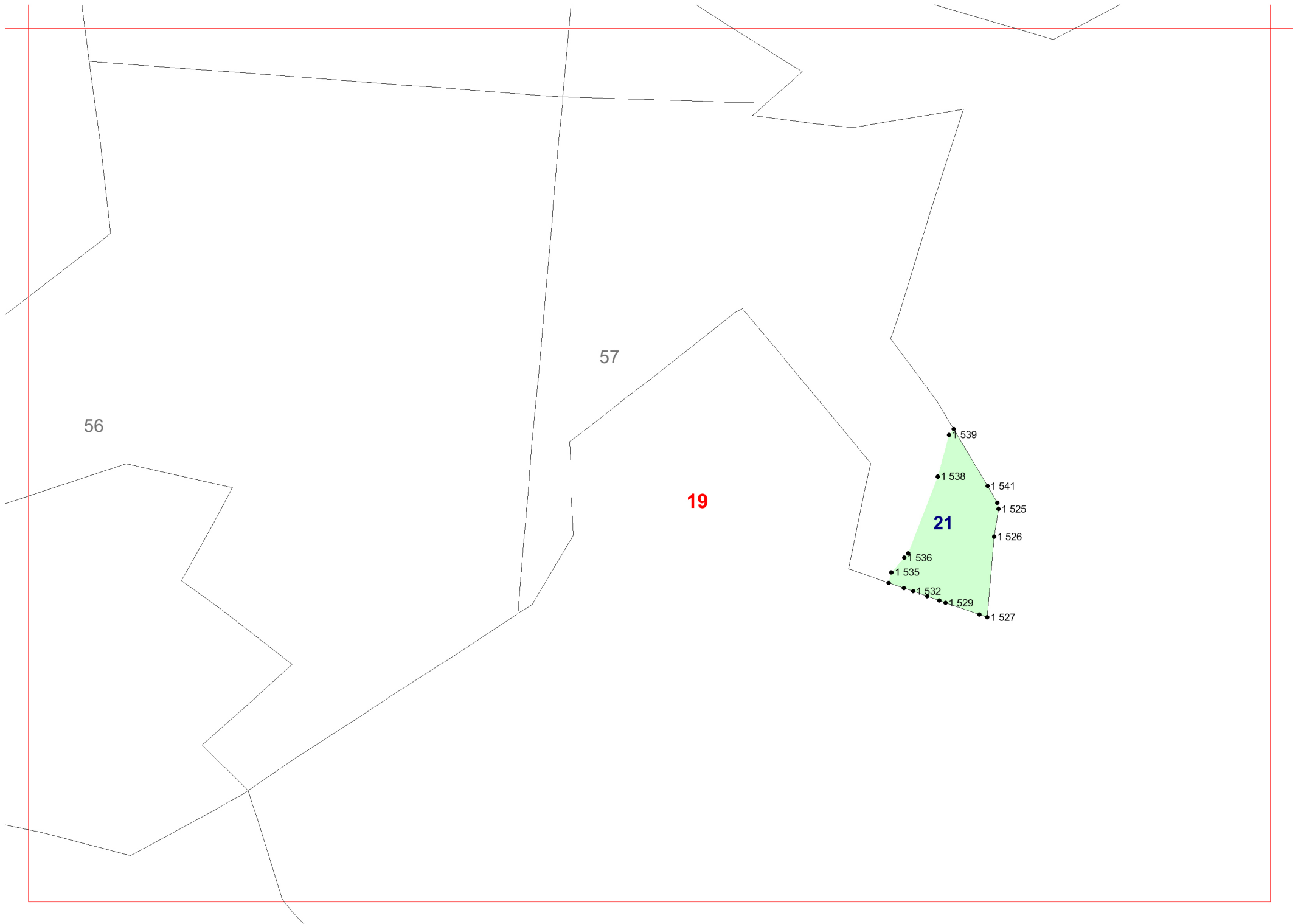

56

57

19

21

- 1 539
- 1 538
- 1 541
- 1 525
- 1 526
- 1 536
- 1 535
- 1 532
- 1 529
- 1 527

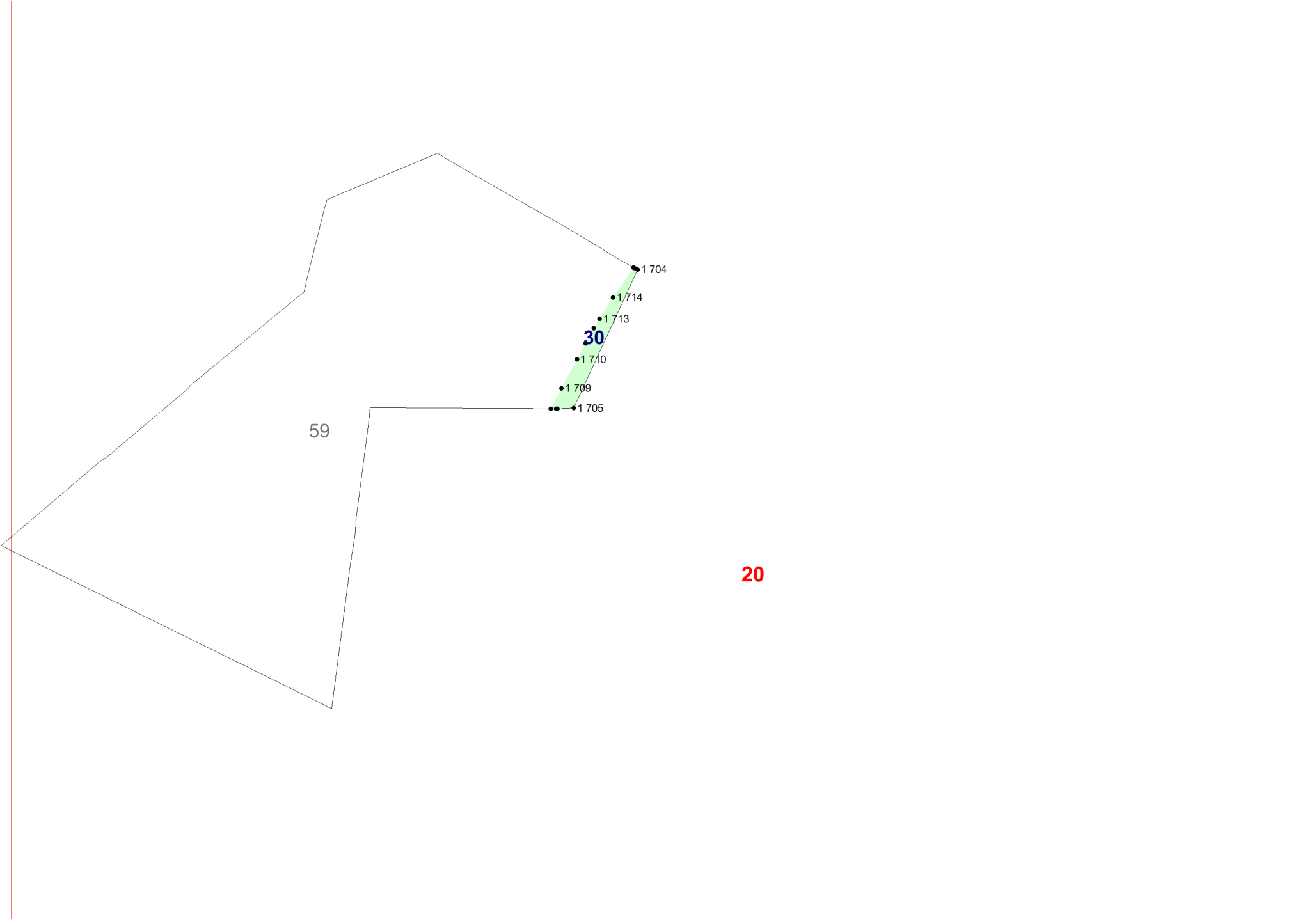

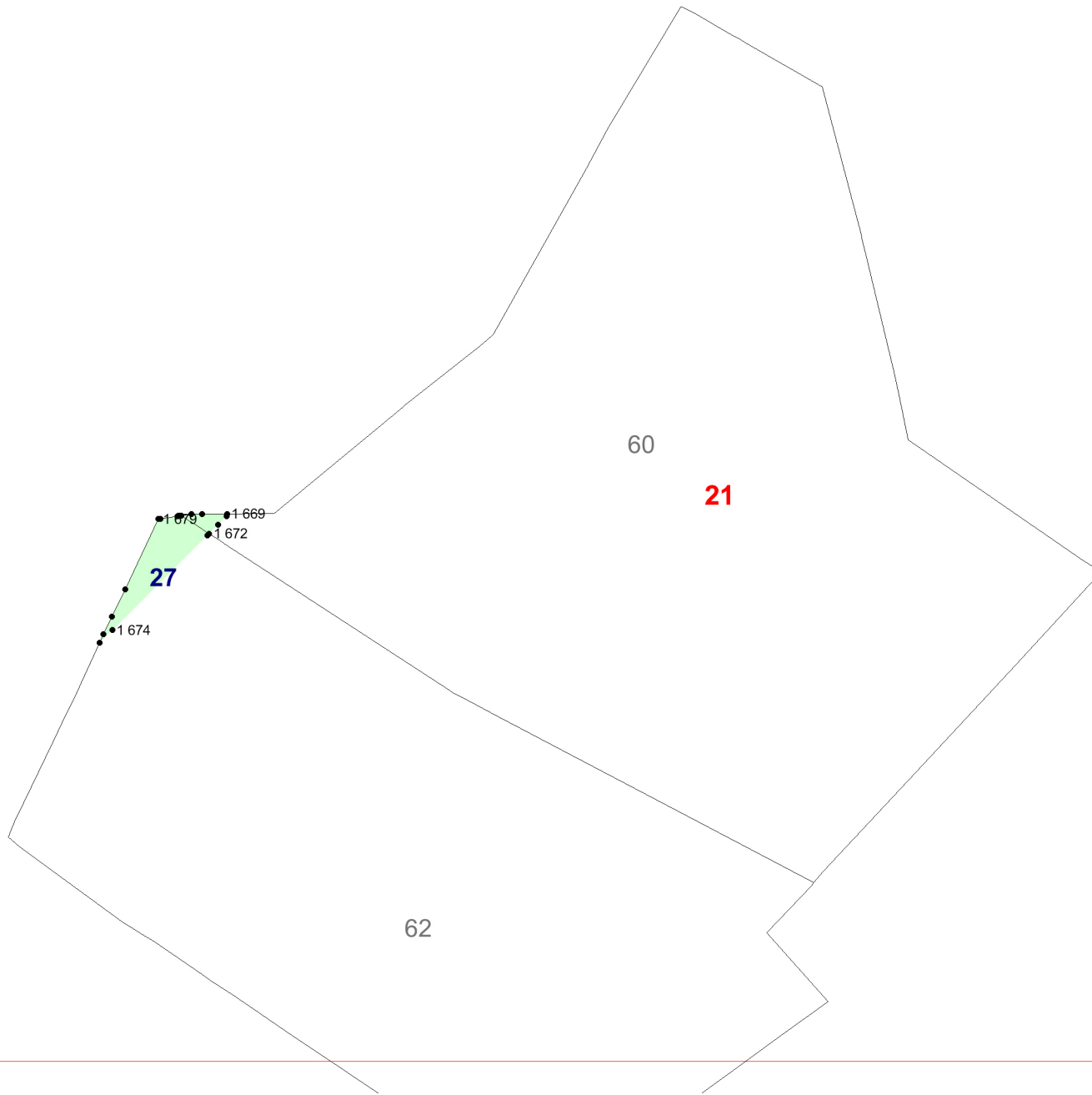

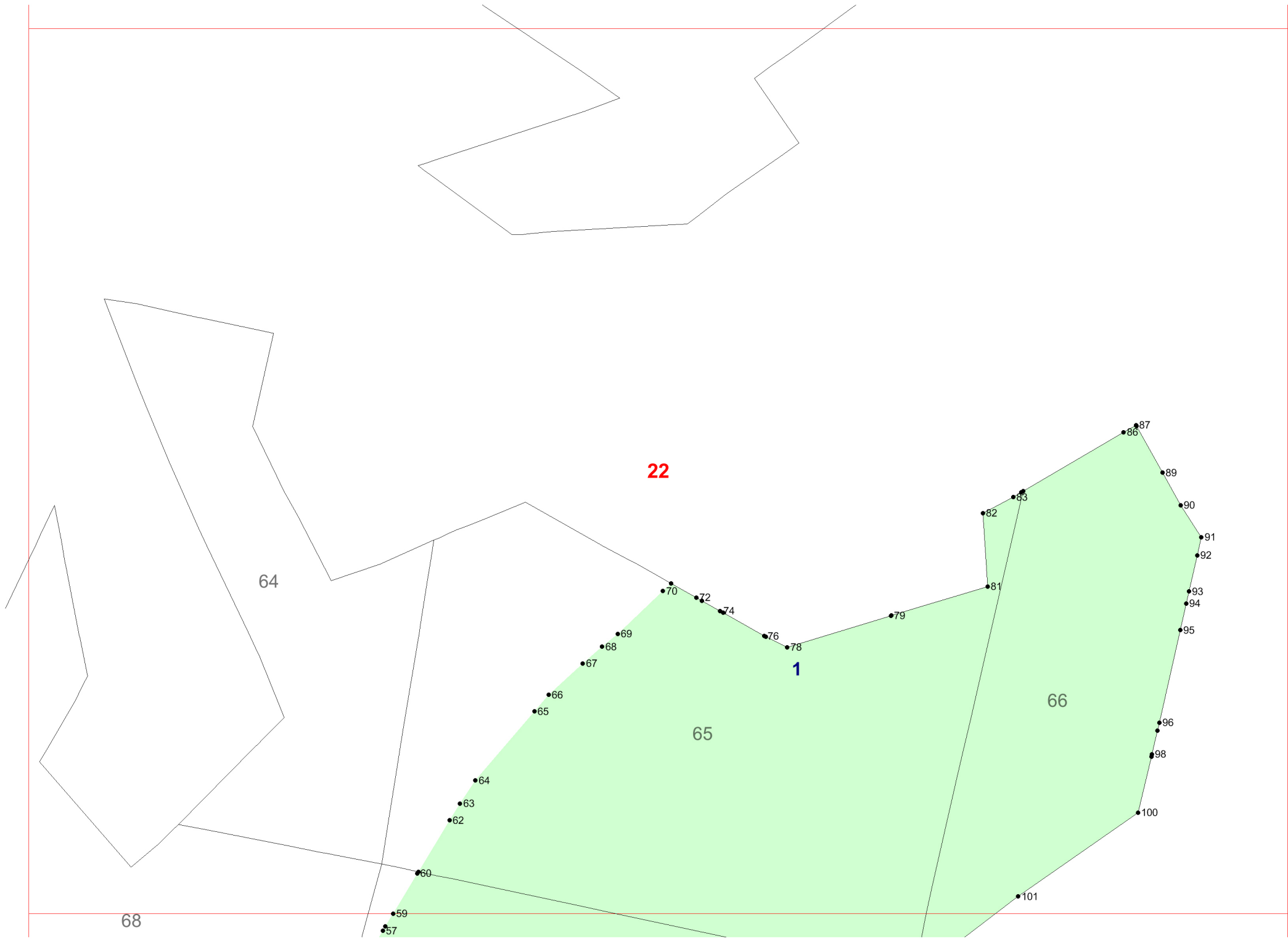

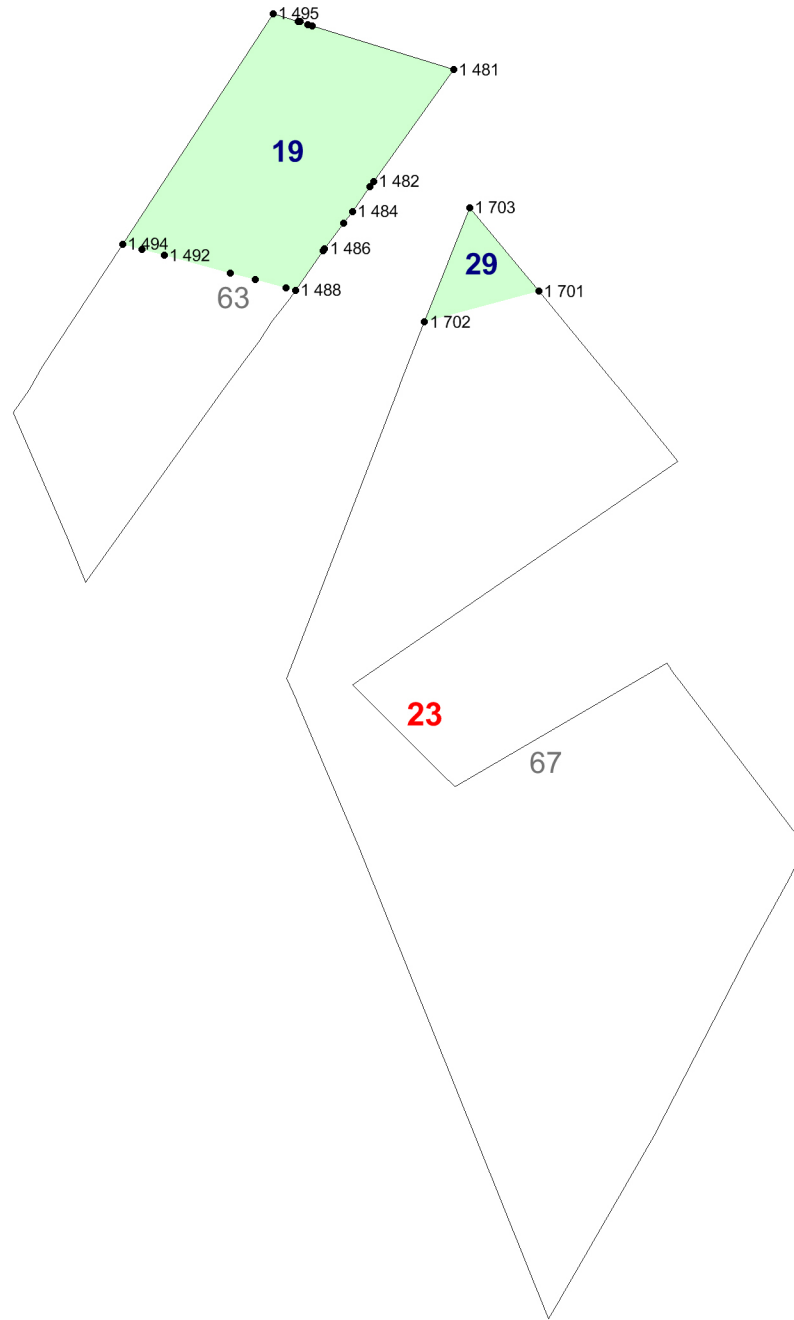

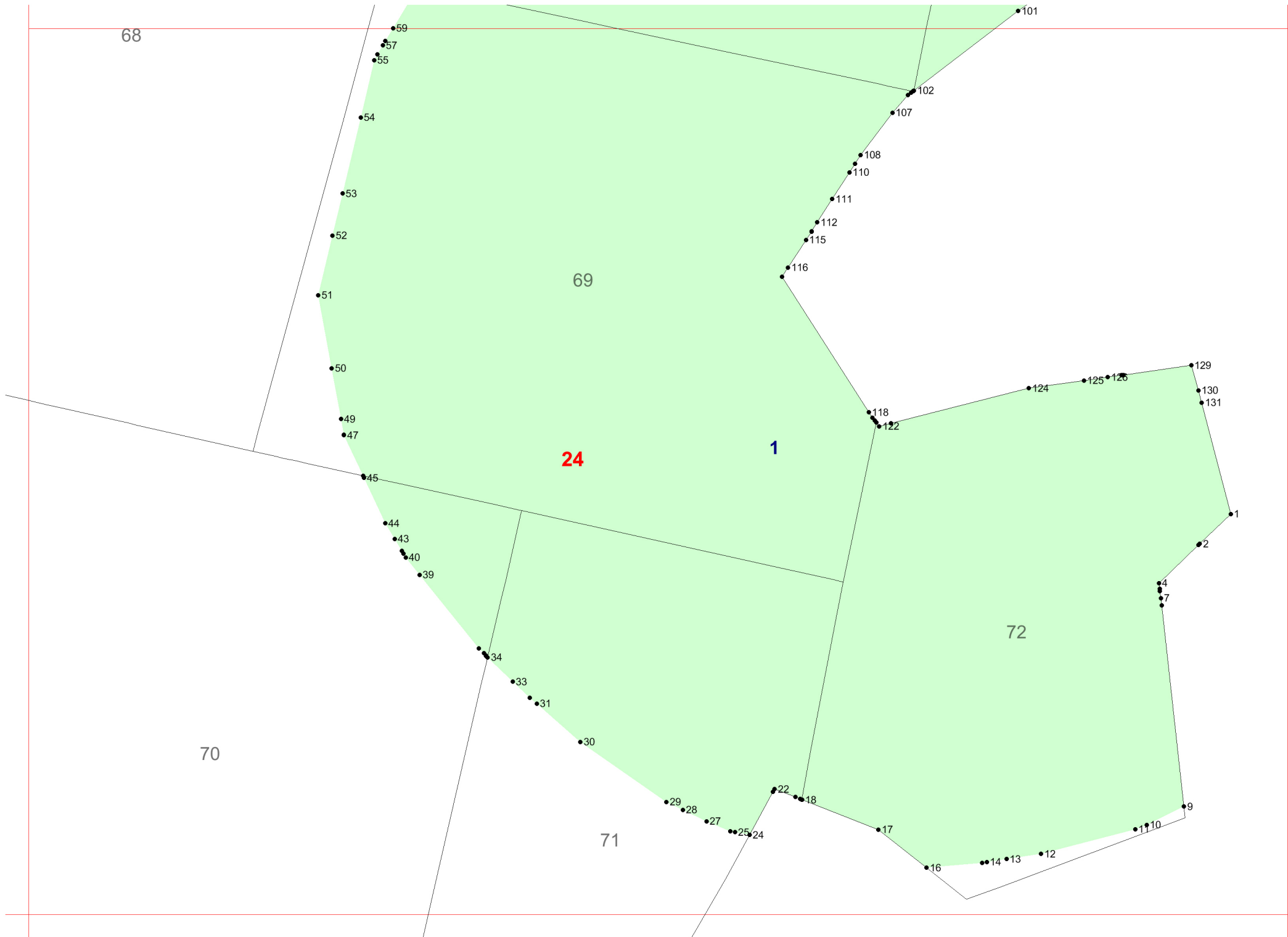

68

69

70

71

72

24

1

25

- 59
- 57
- 55
- 54
- 53
- 52
- 51
- 50
- 49
- 47
- 45
- 44
- 43
- 40
- 39
- 34
- 33
- 31
- 30
- 29
- 28
- 27
- 25
- 24

- 101
- 102
- 107
- 108
- 110
- 111
- 112
- 115
- 116
- 118
- 122

- 124
- 125
- 126
- 129
- 130
- 131
- 1
- 2
- 4
- 7
- 9
- 10
- 12
- 13
- 14
- 16
- 17
- 18
- 22

25

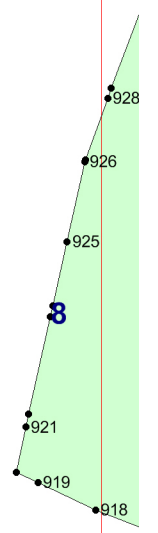

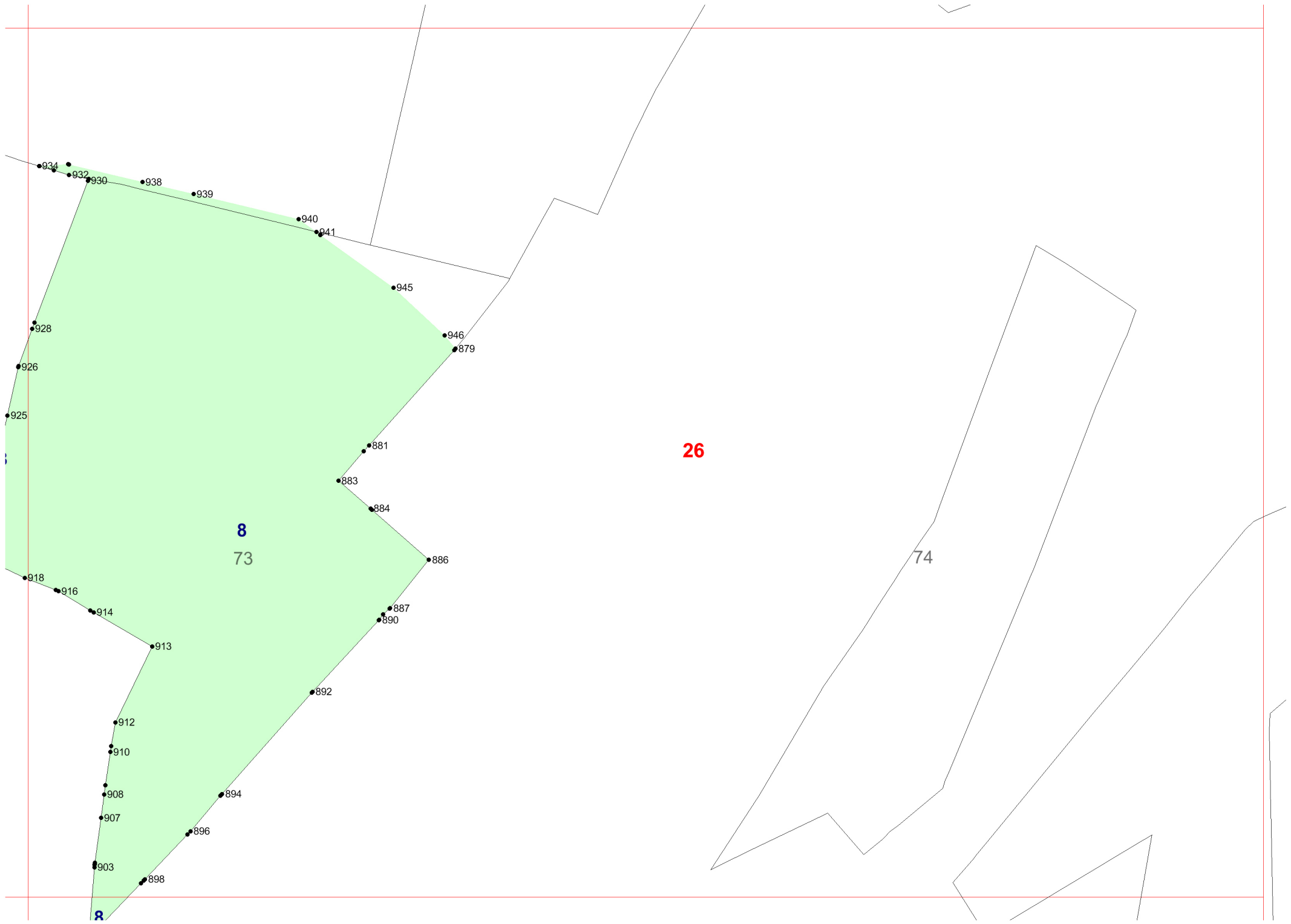

- 934
- 932
- 930
- 938
- 939
- 940
- 941
- 945
- 946
- 879
- 928
- 926
- 925
- 918
- 916
- 914
- 913
- 881
- 883
- 884
- 886
- 887
- 890
- 892
- 912
- 910
- 908
- 907
- 903
- 898
- 894
- 896

8
73

26

74

27

8

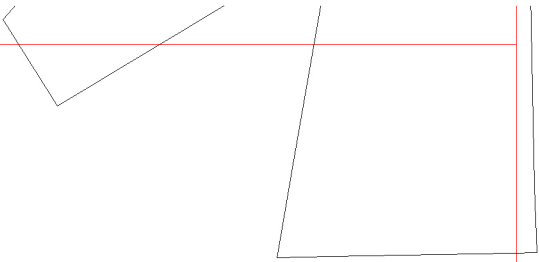
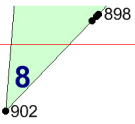

27

76

28

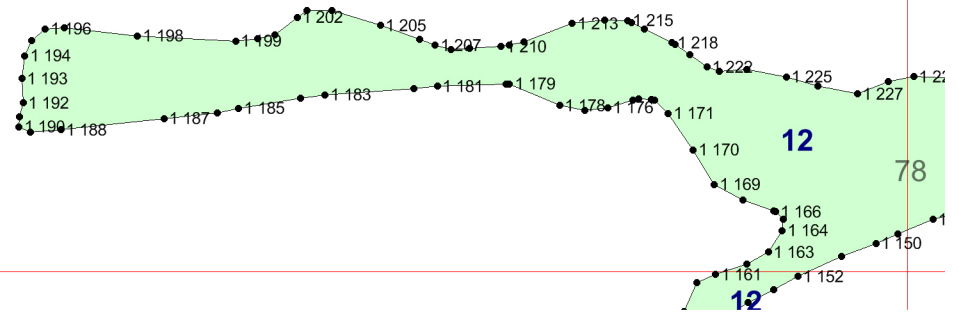

29

29

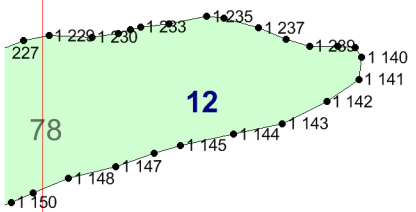

30



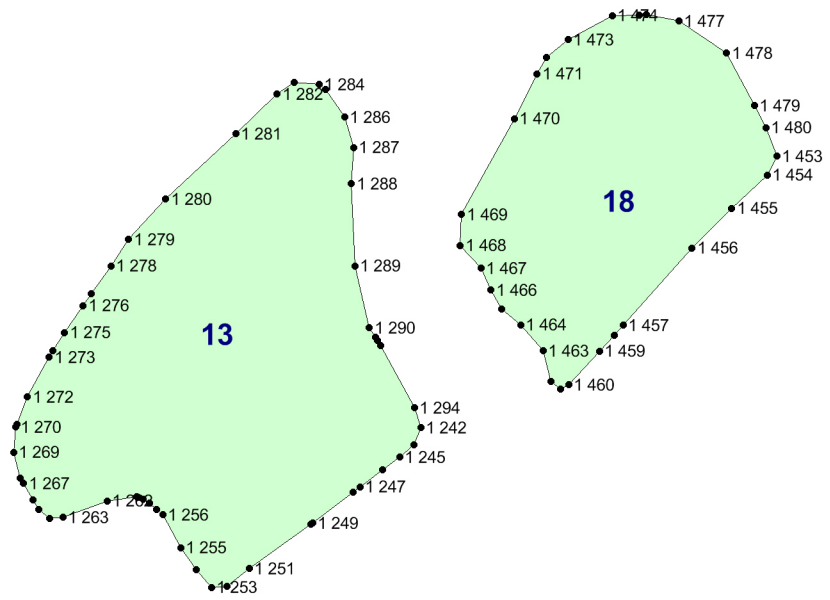

30

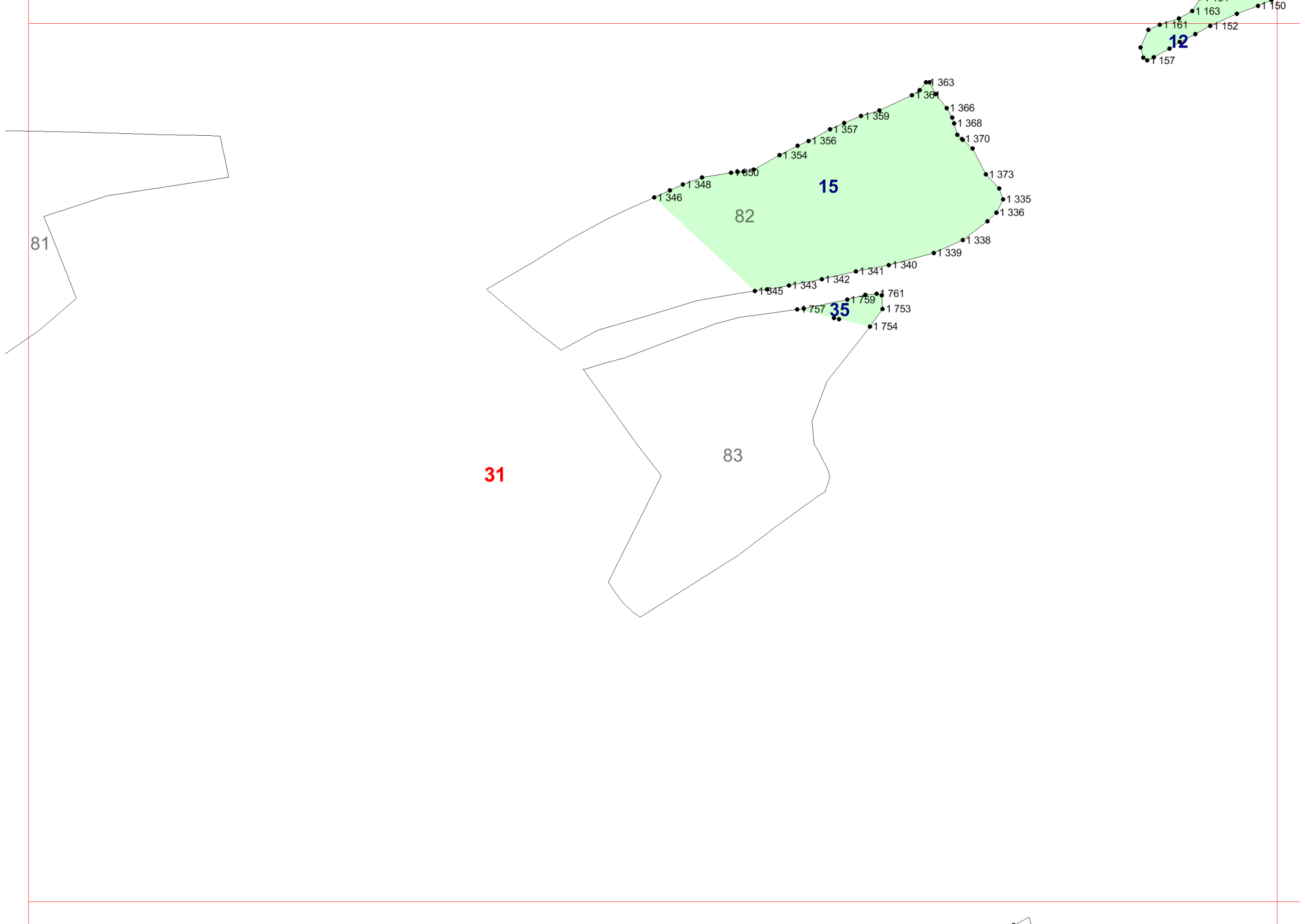

•1150

