

**Графическое описание местоположения границ земель,  
на которых располагаются особо защитные участки  
лесов «берегозащитные участки лесов»,  
на территории  
Мустафинского участкового лесничества  
Туймазинского лесничества  
Республики Башкортостан**

Приложение № 307 к приказу Рослесхоза  
от 27.02.2023 № 201

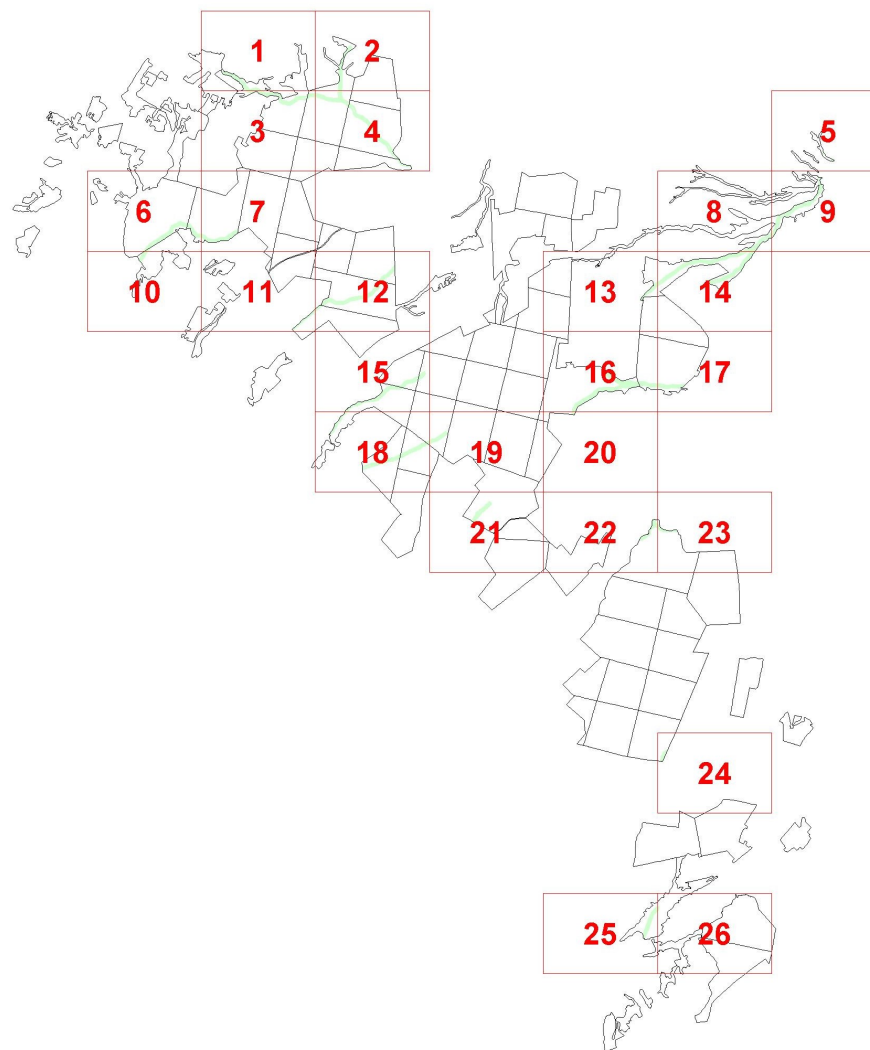

**Условные обозначения:**

- 1      номера листов
- 3      номера участков
- 61     номера лесных кварталов
- границы лесных кварталов
- границы листов
- границы особо защитных участков лесов
- 45   номера характерных точек границ объекта

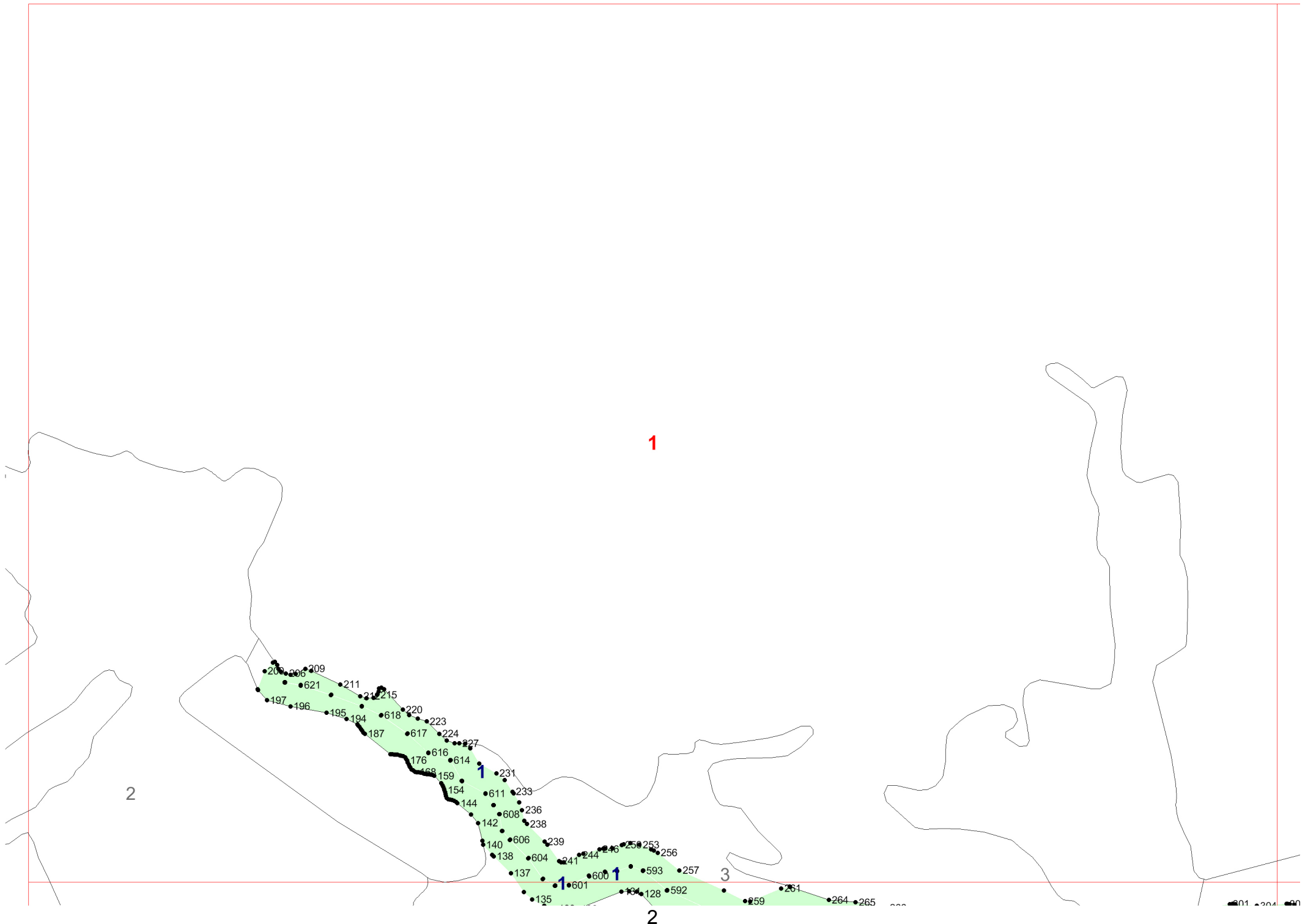

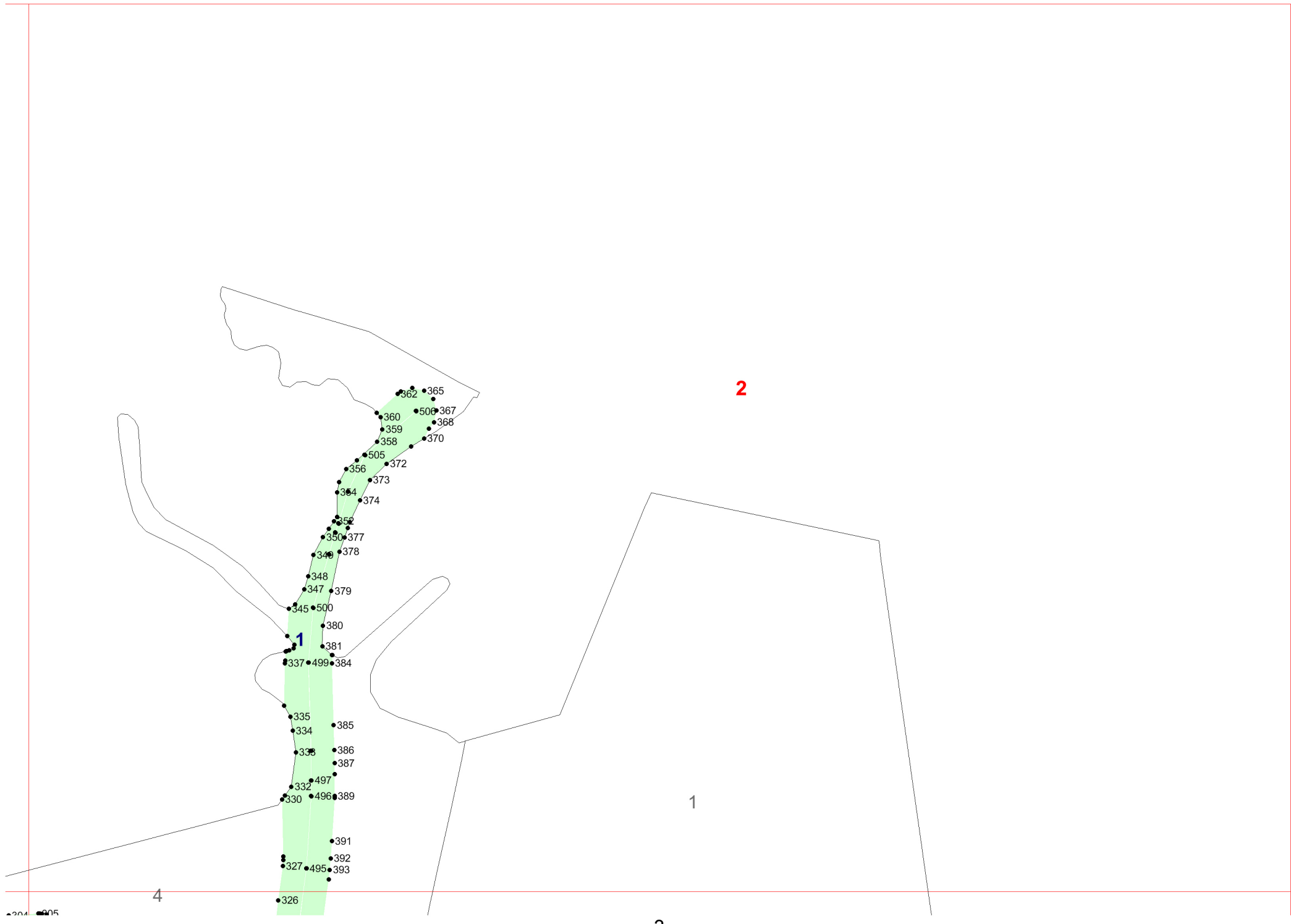

2

1

1

3

4

304 305

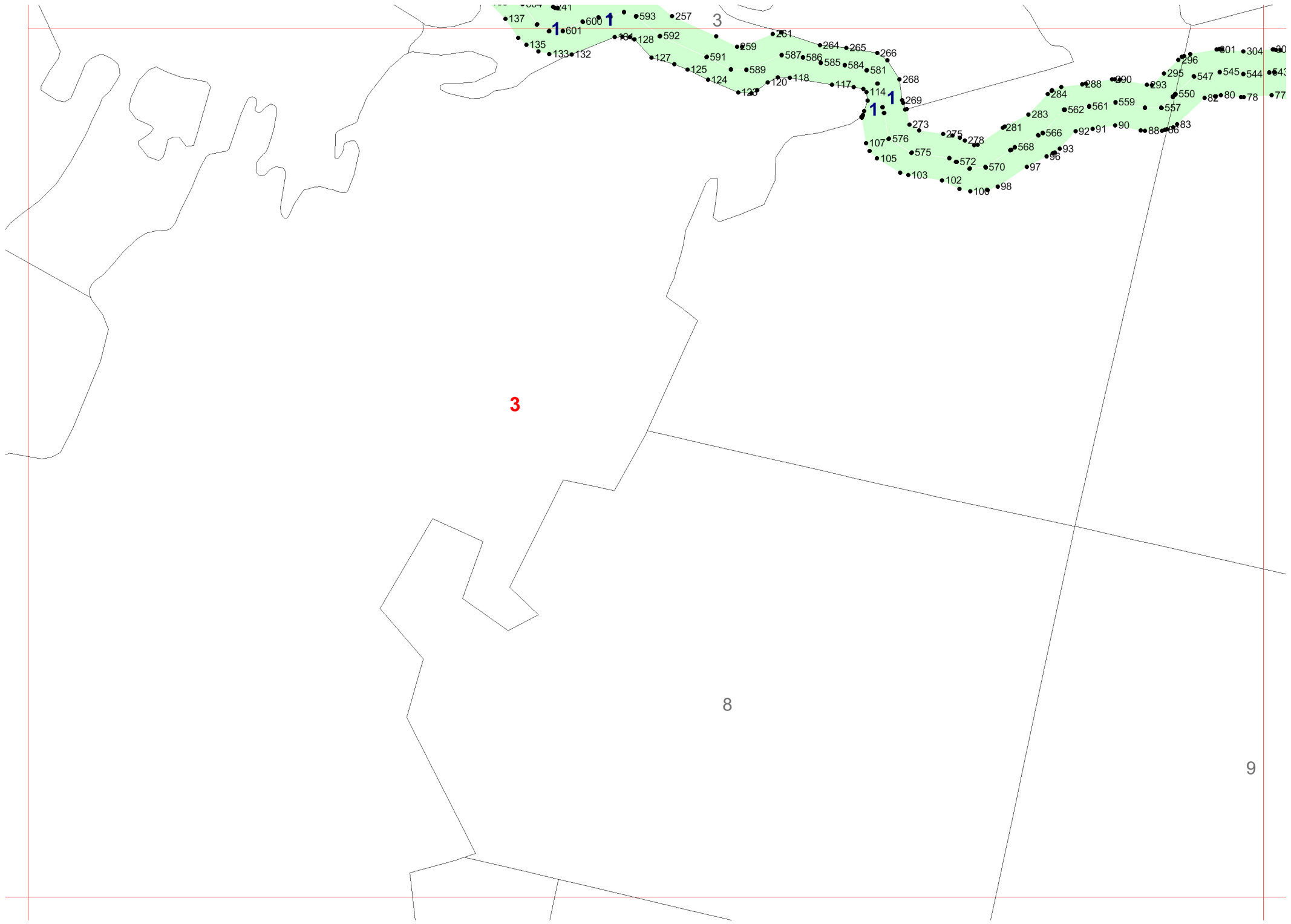

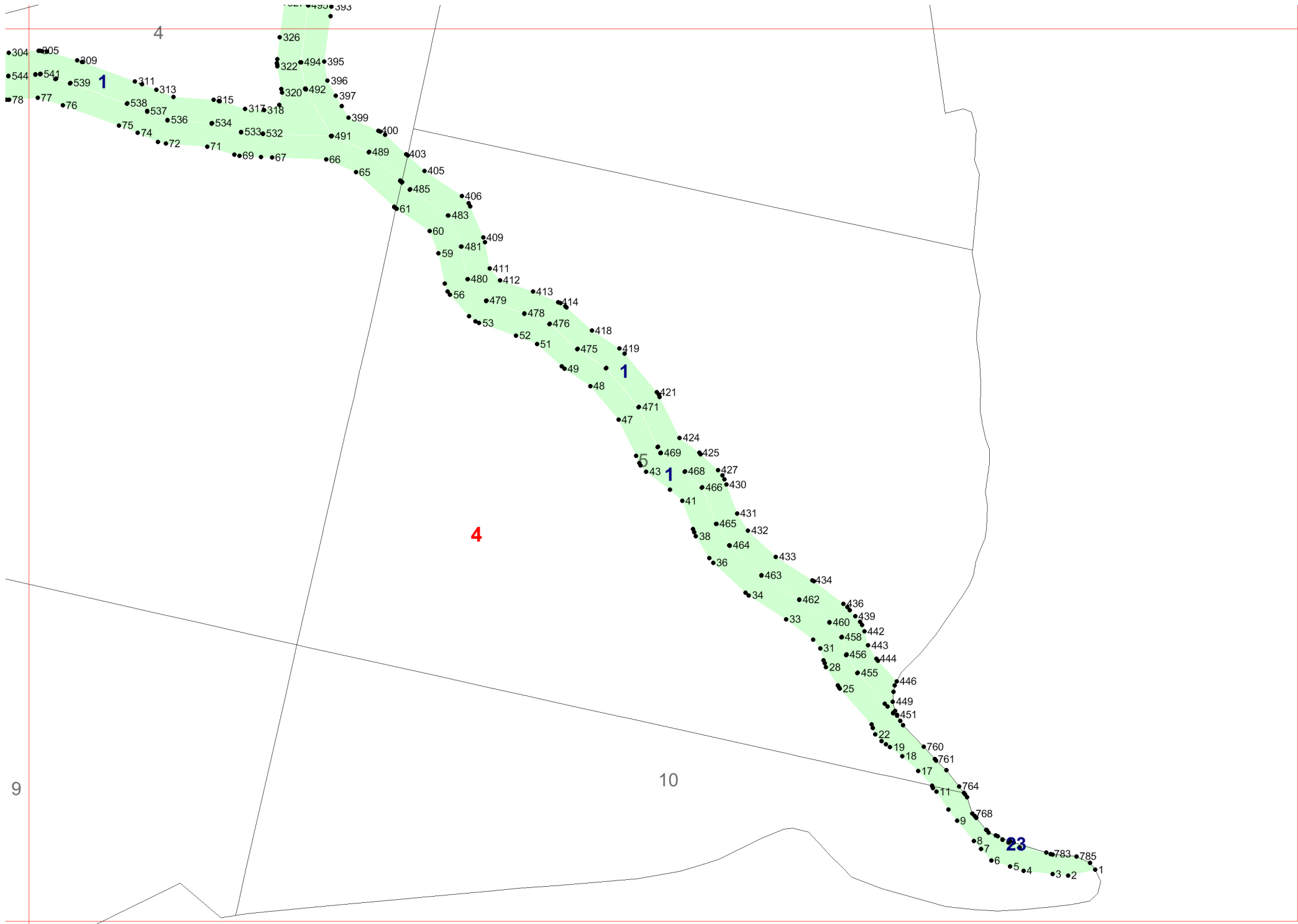

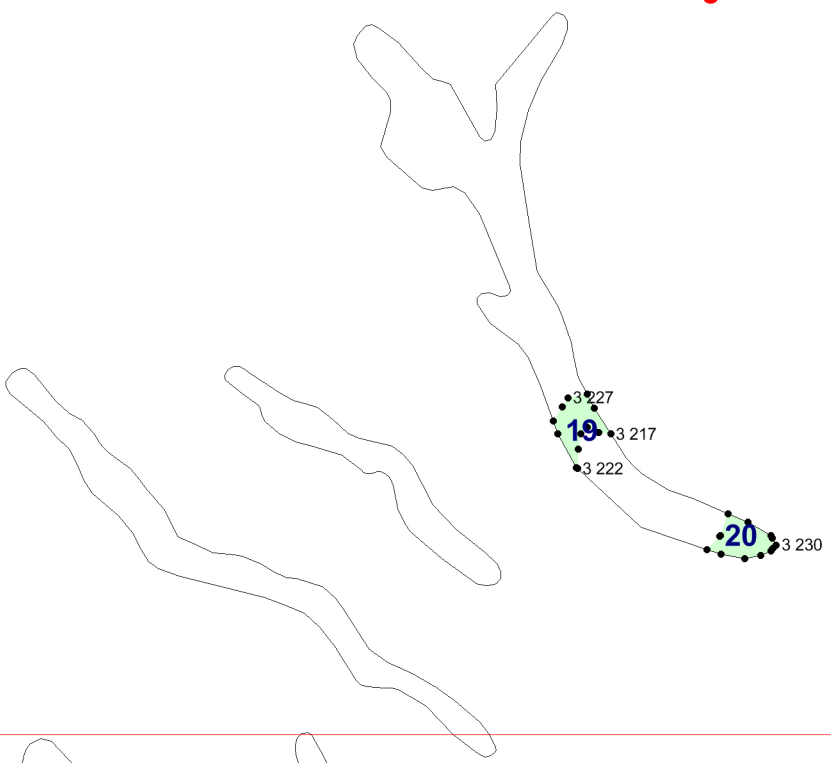

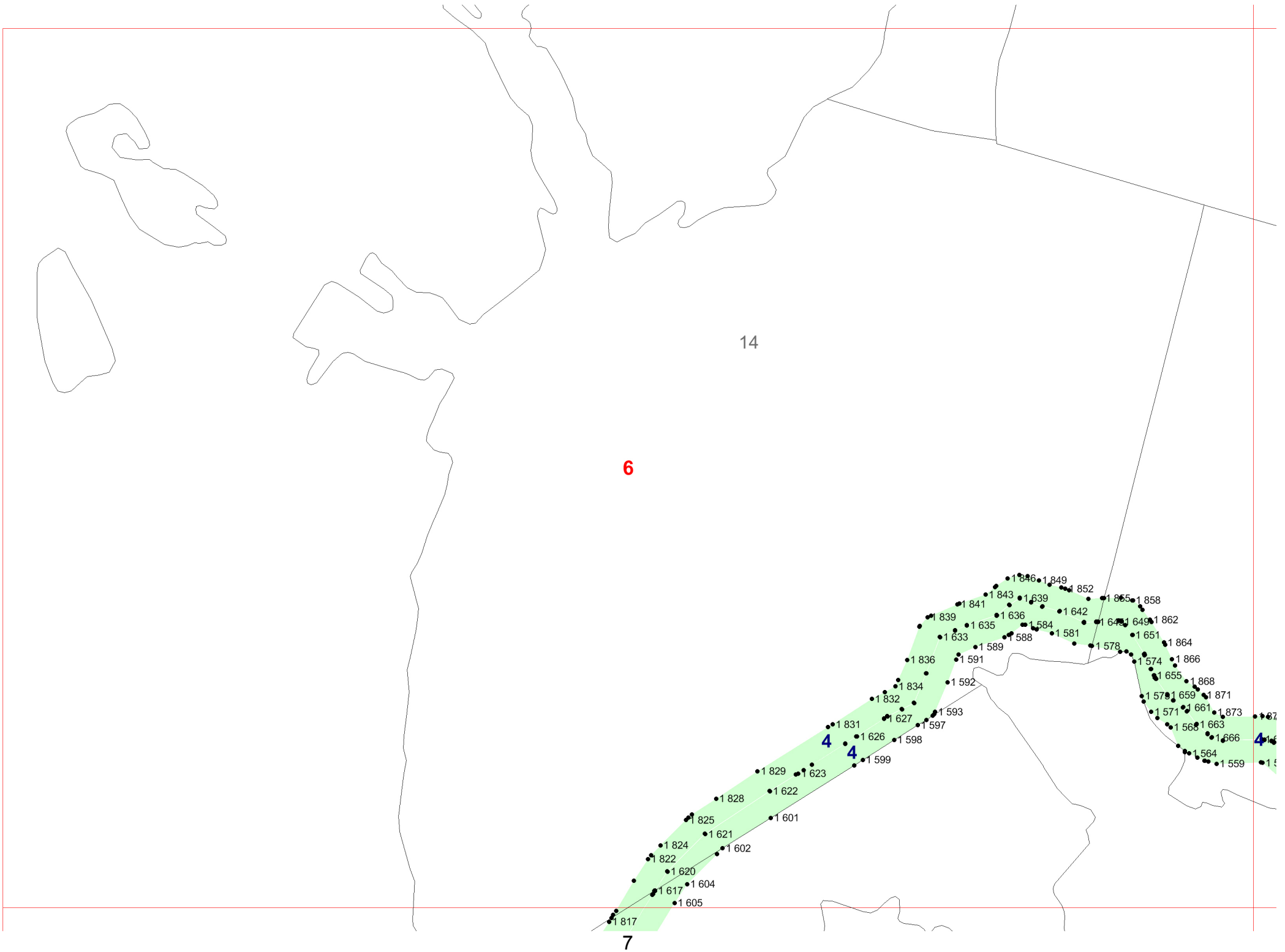

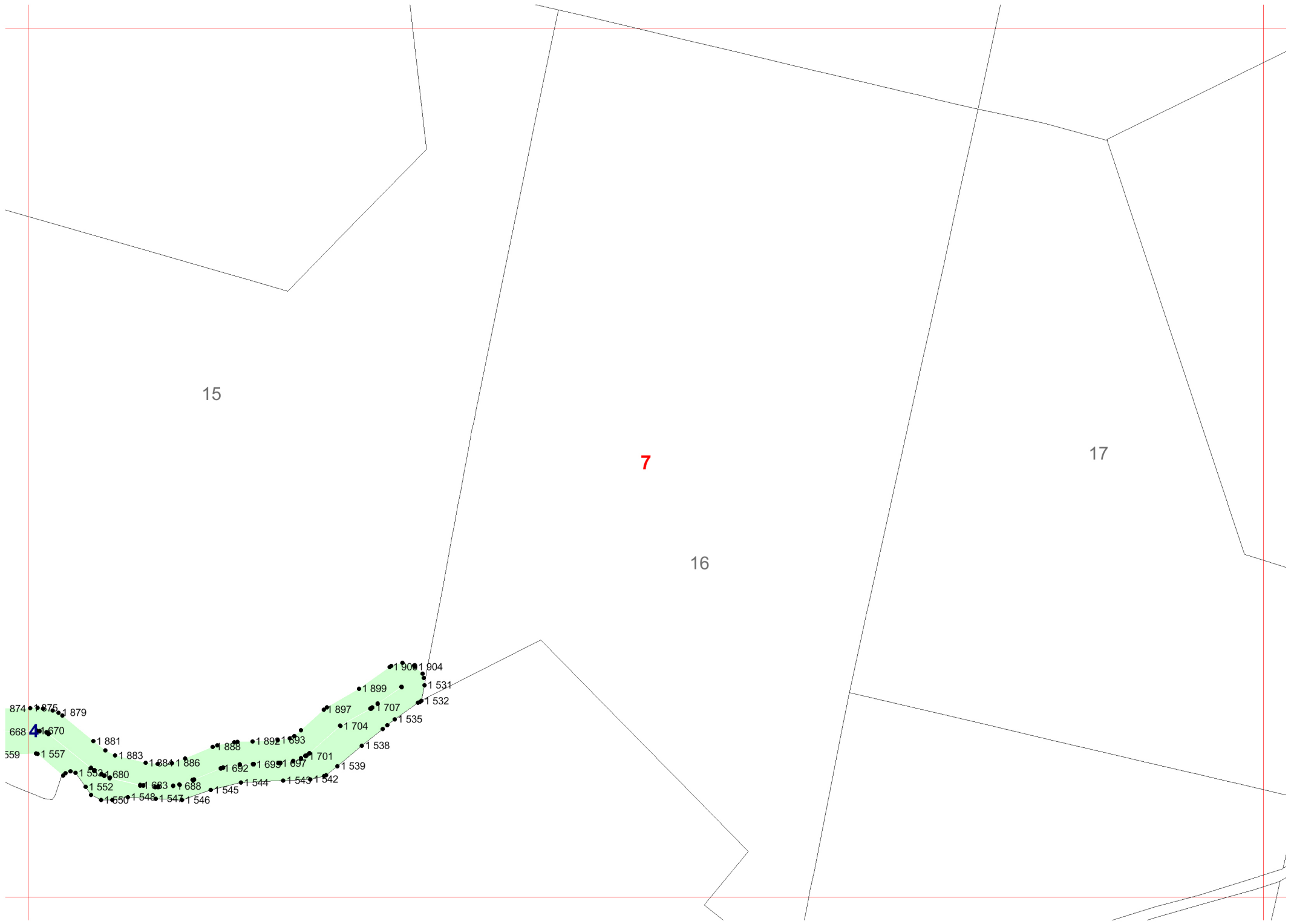

15

7

17

16

8

- 874
- 675
- 879
- 668
- 4
- 670
- 559
- 1 557
- 1 881
- 1 883
- 1 684
- 1 886
- 1 888
- 1 892
- 1 893
- 1 897
- 1 707
- 1 704
- 1 535
- 1 538
- 1 539
- 1 552
- 680
- 683
- 688
- 1 545
- 1 544
- 1 543
- 1 542
- 1 550
- 1 548
- 1 547
- 1 546
- 1 900
- 1 904
- 1 531
- 1 532



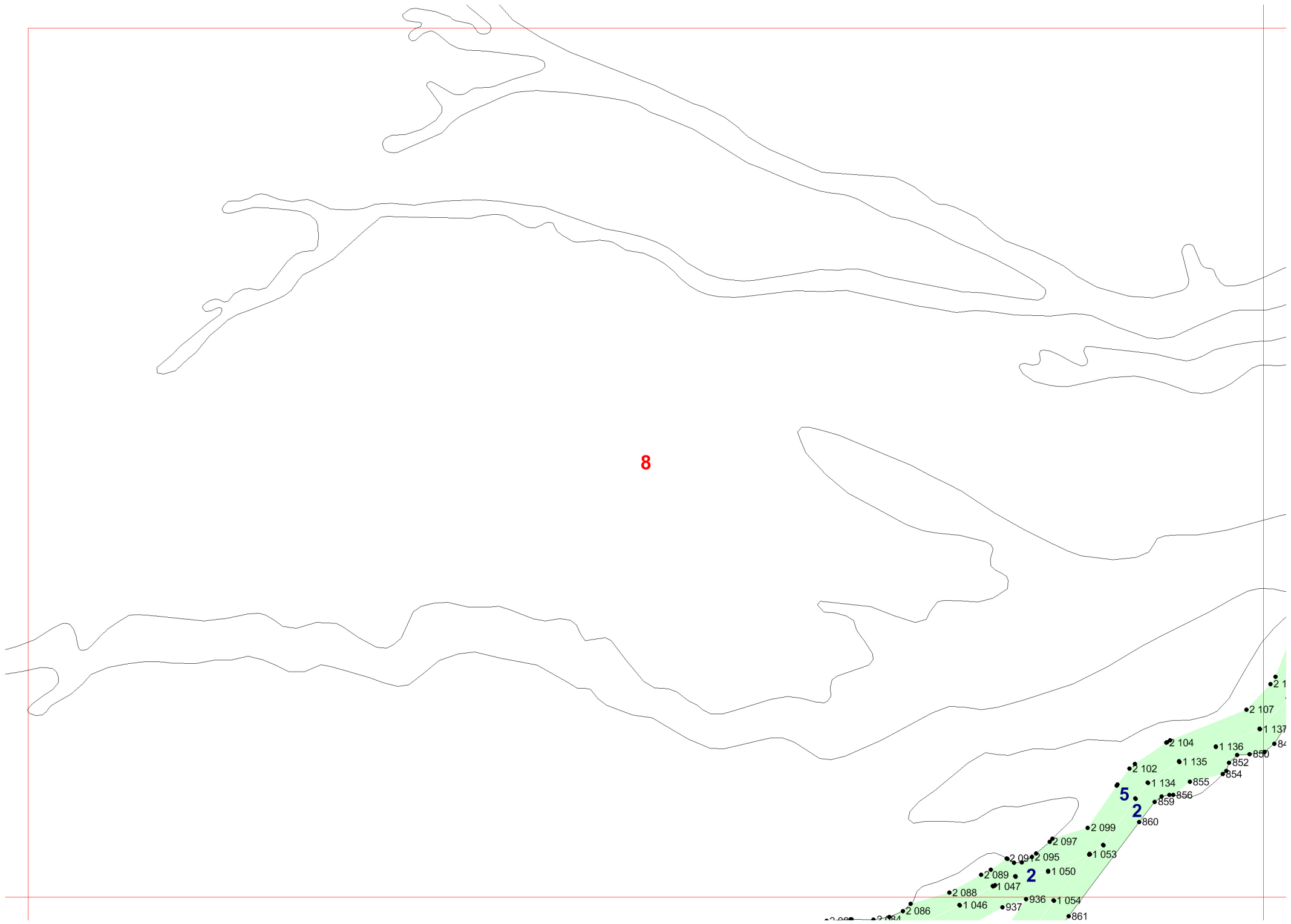

8

9

- 2 088
- 2 089
- 2 086
- 1 046
- 937
- 1 047
- 2 09
- 2 095
- 2 097
- 2 099
- 1 053
- 1 050
- 1 054
- 861
- 860
- 859
- 856
- 855
- 854
- 852
- 850
- 84
- 1 134
- 1 135
- 1 136
- 2 102
- 2 104
- 2 107
- 1 137
- 2 1

5

2

2

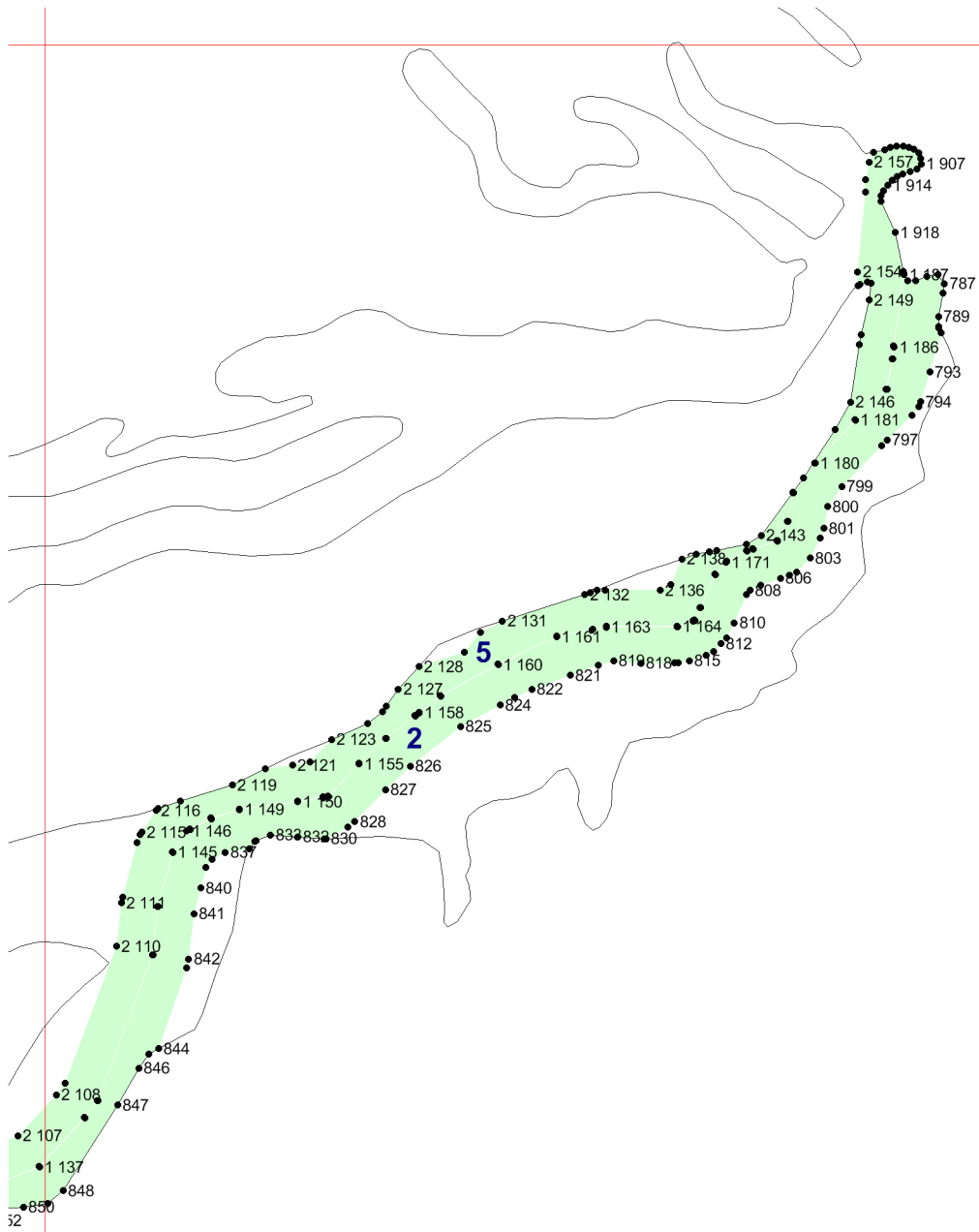

9

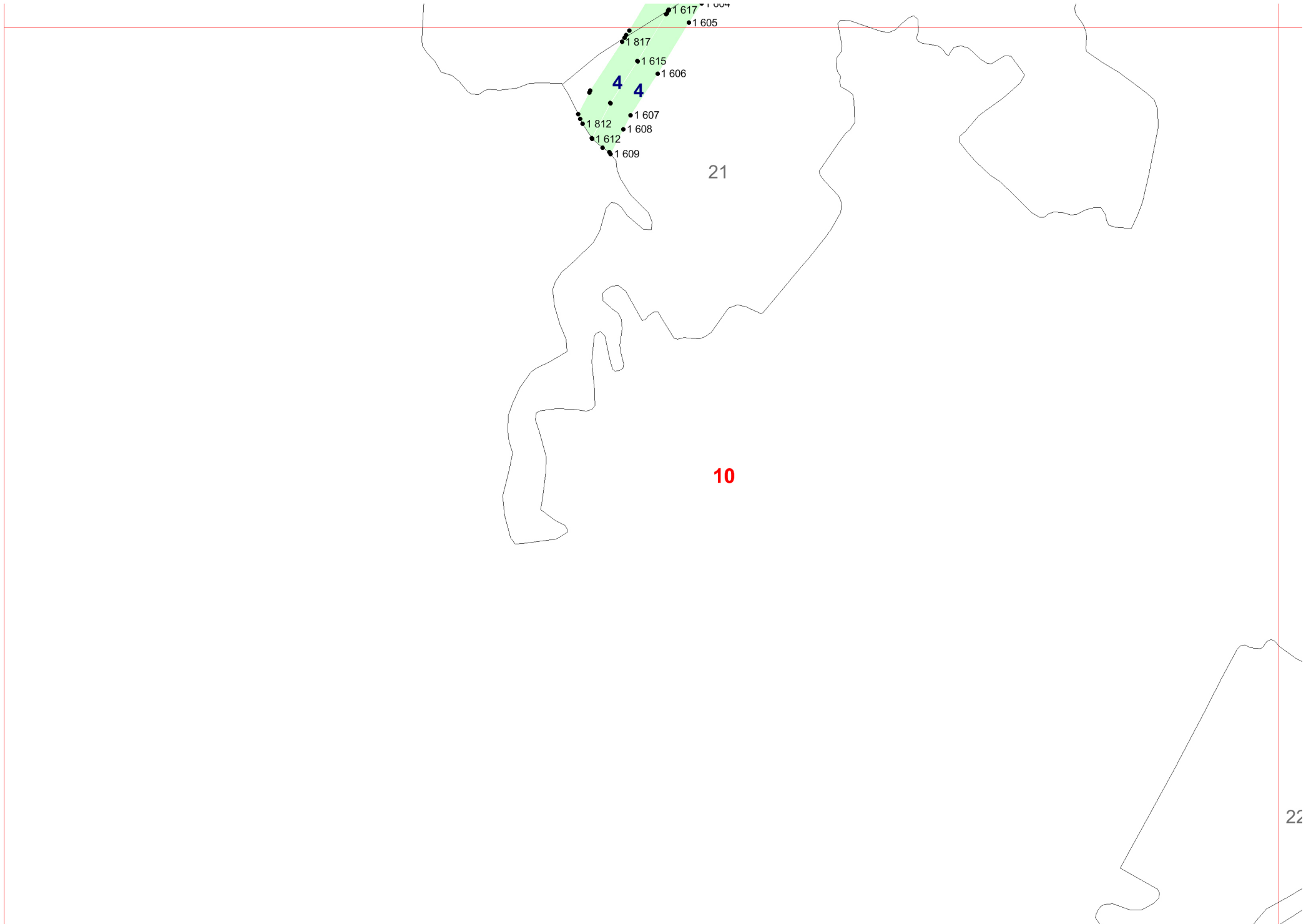

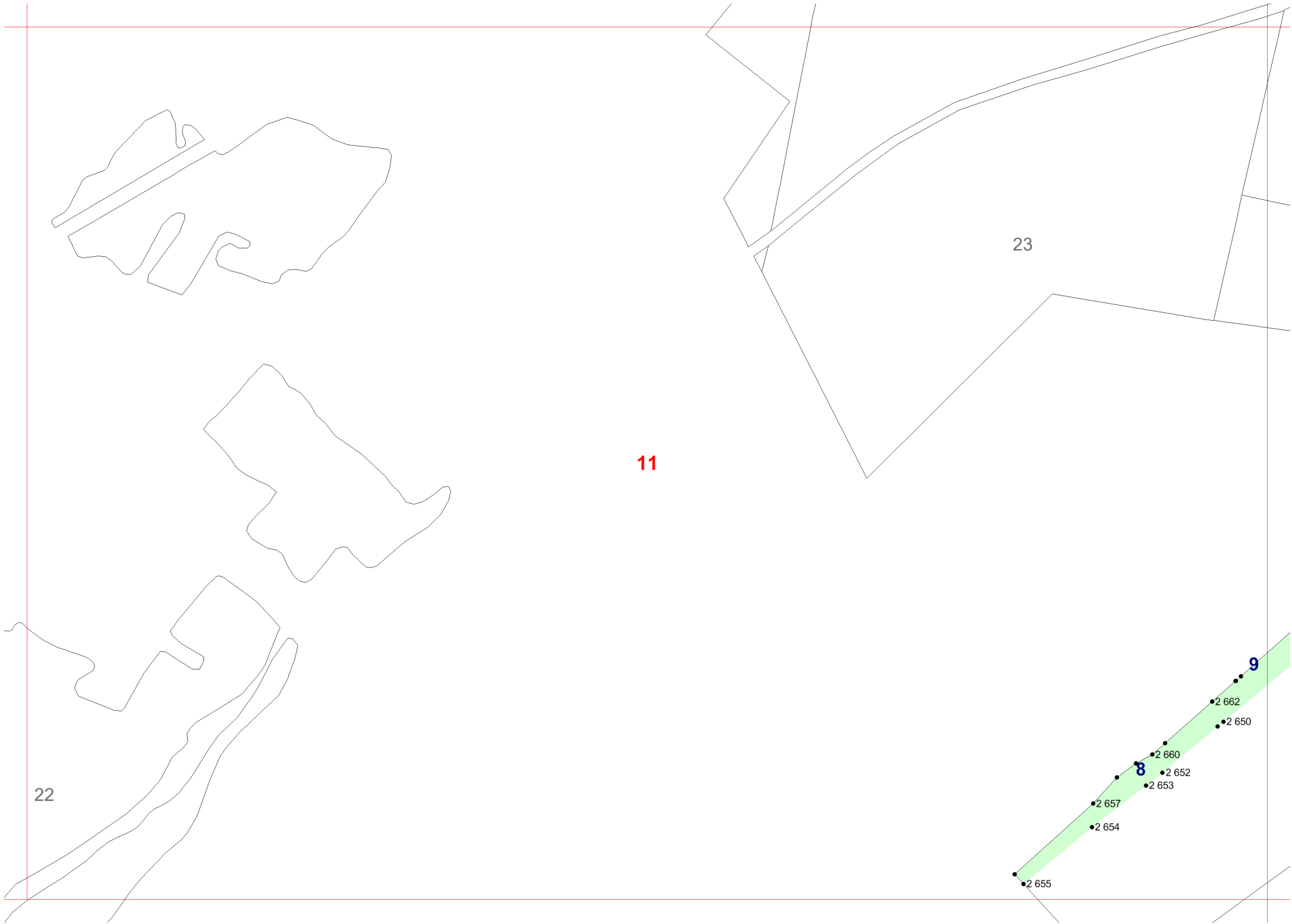

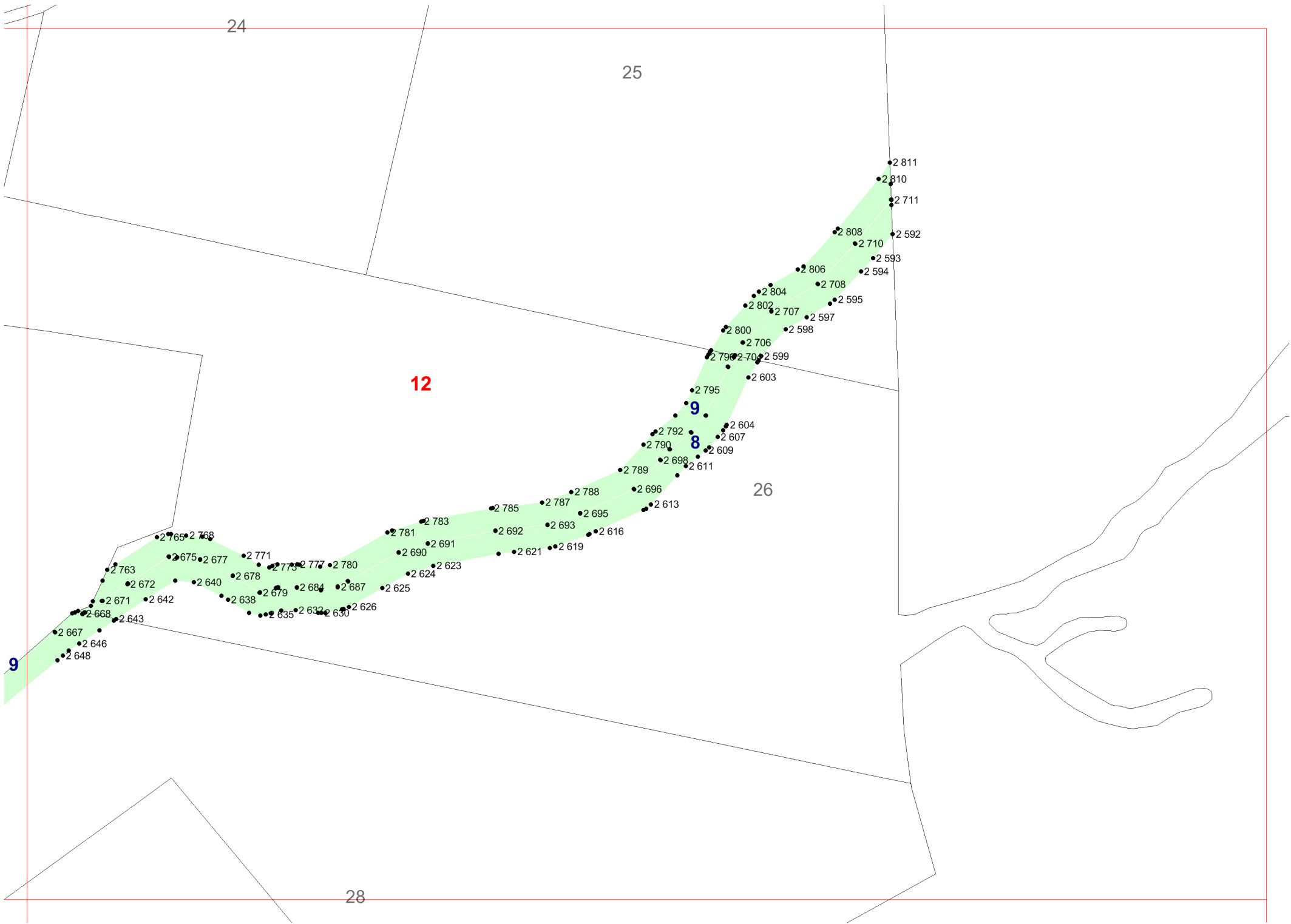

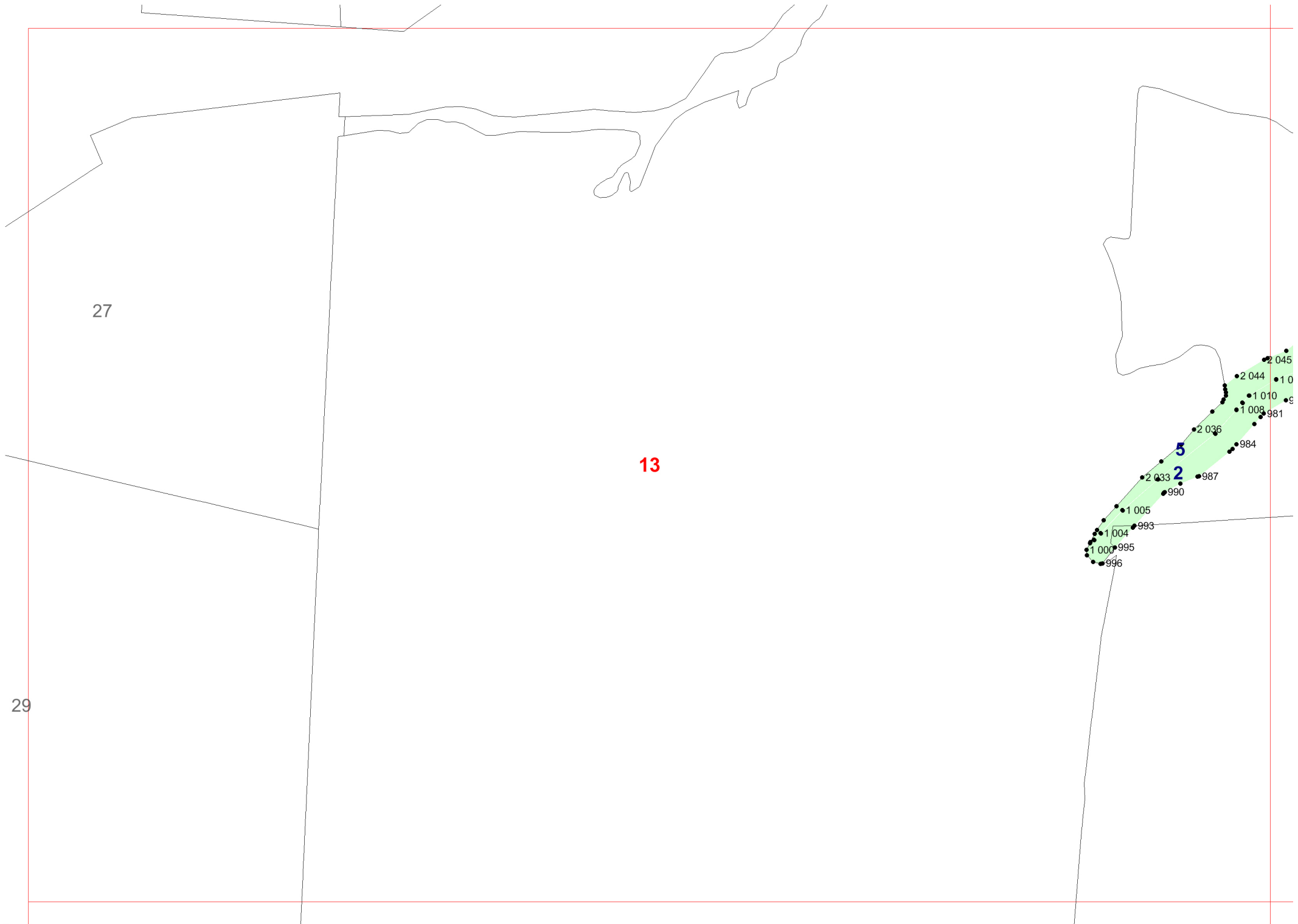

27

13

29

14

- 2045
- 2044
- 1010
- 1010
- 1003
- 981
- 2036
- 984
- 2033
- 987
- 990
- 1005
- 993
- 1004
- 995
- 1000
- 996
- 5
- 2
- 1

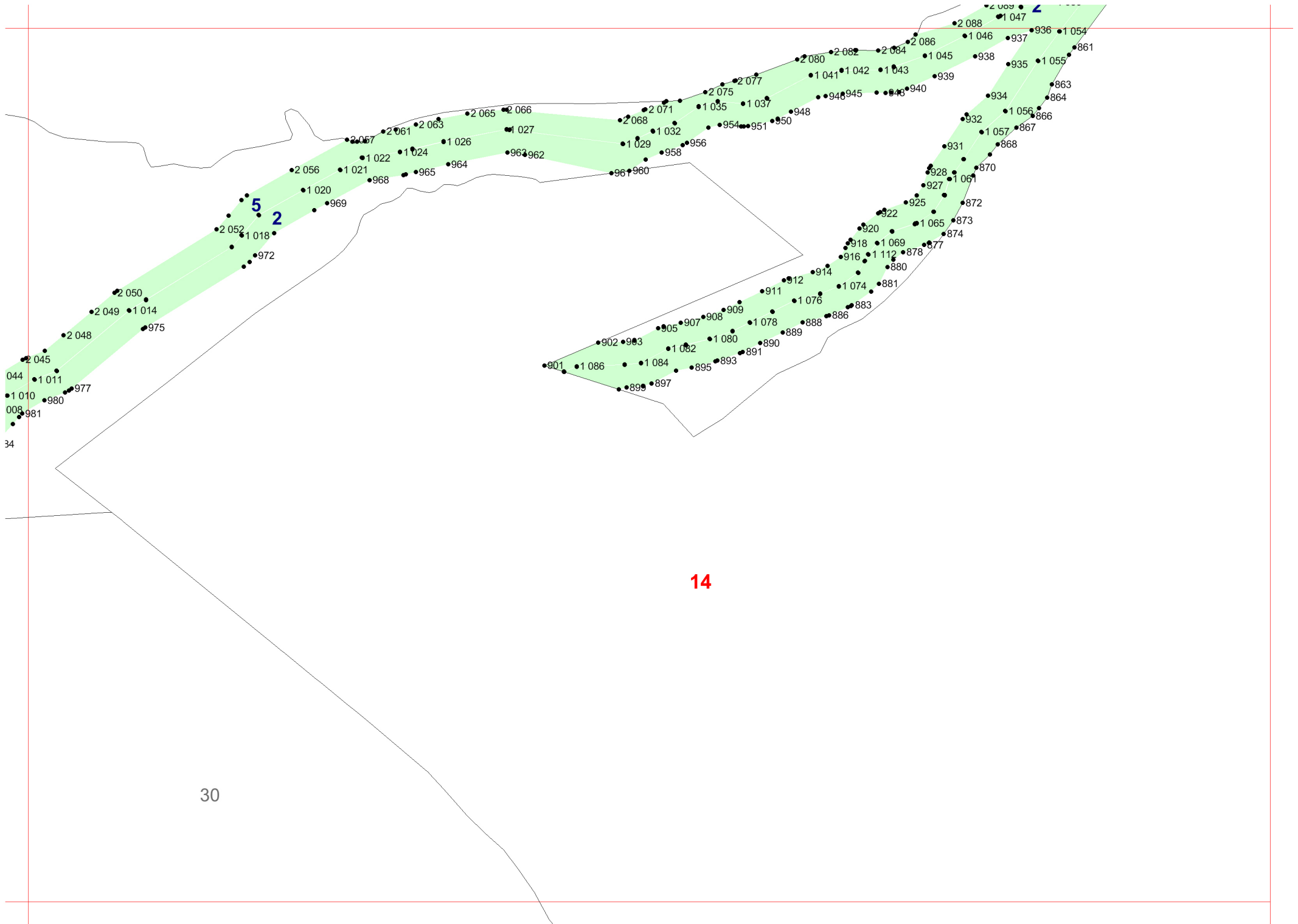

34

30

14

15

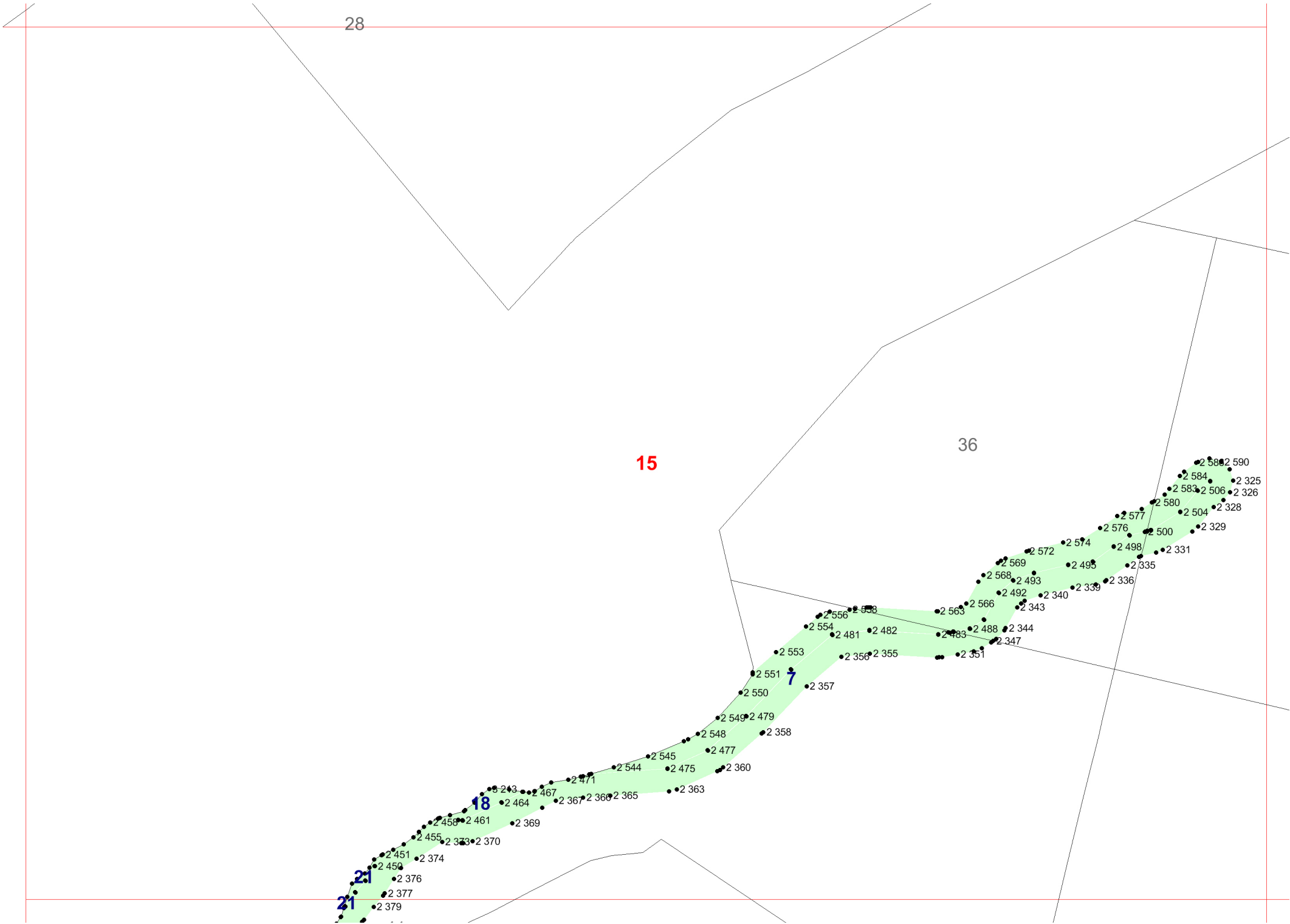



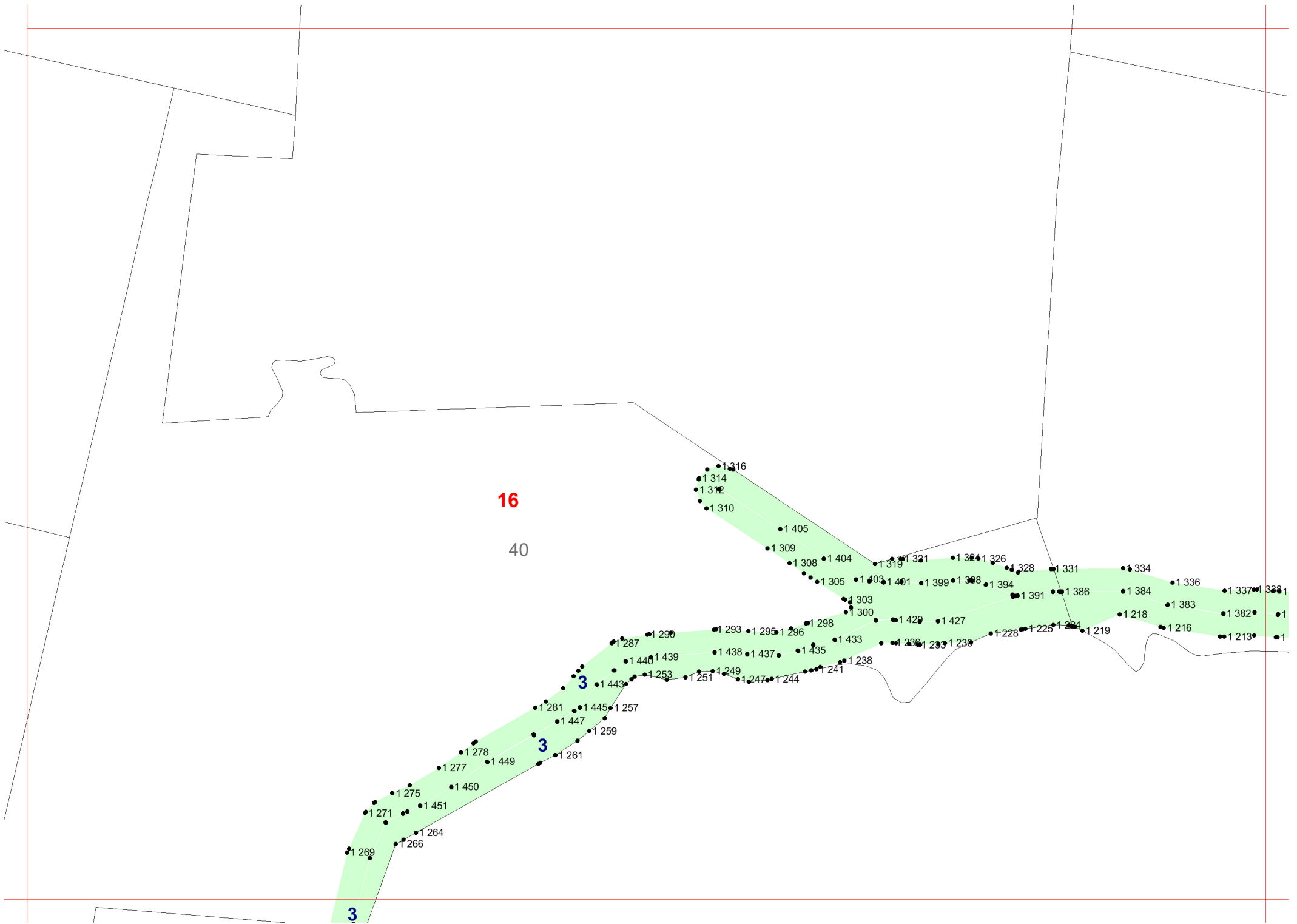

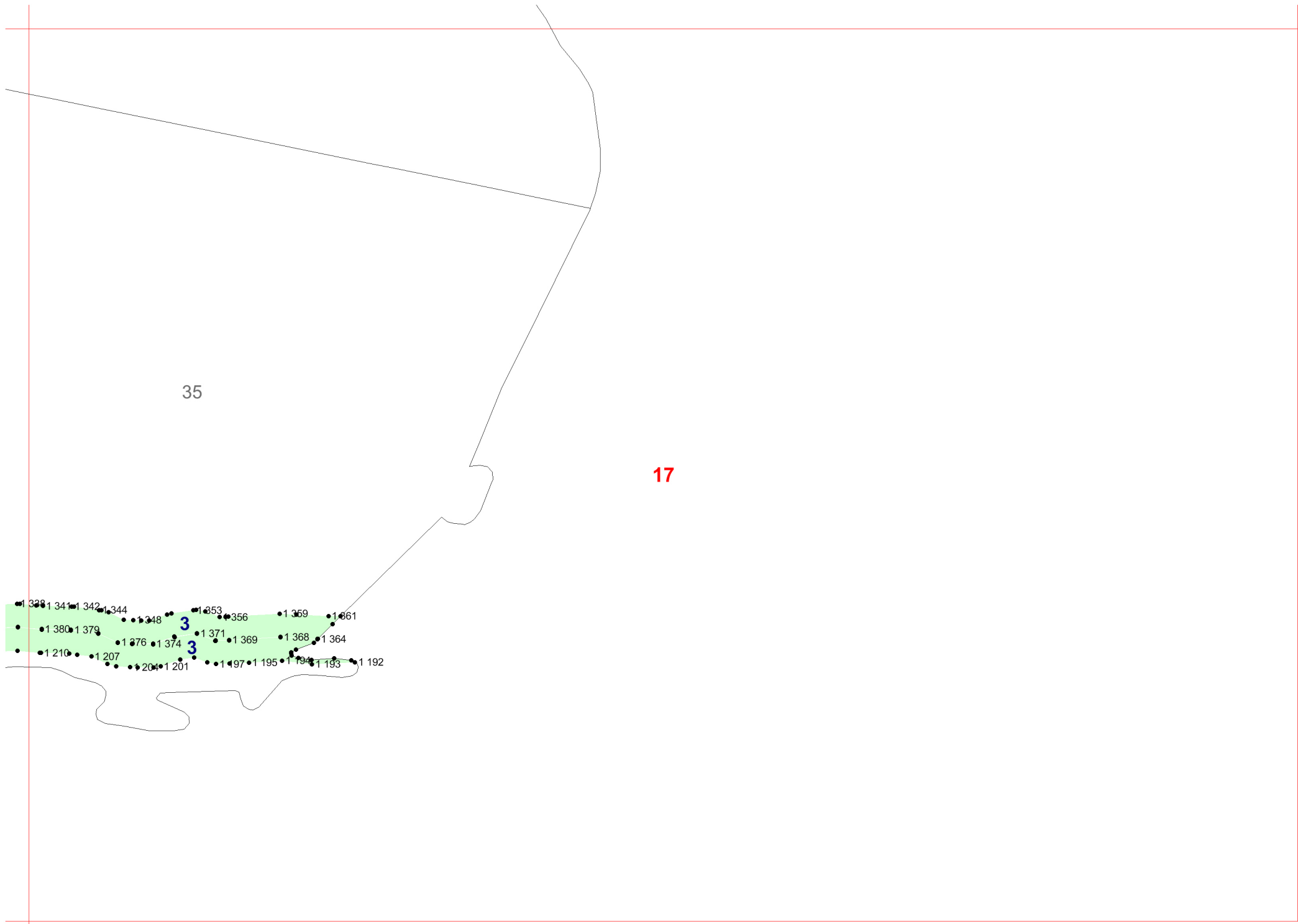

35

17

3

3

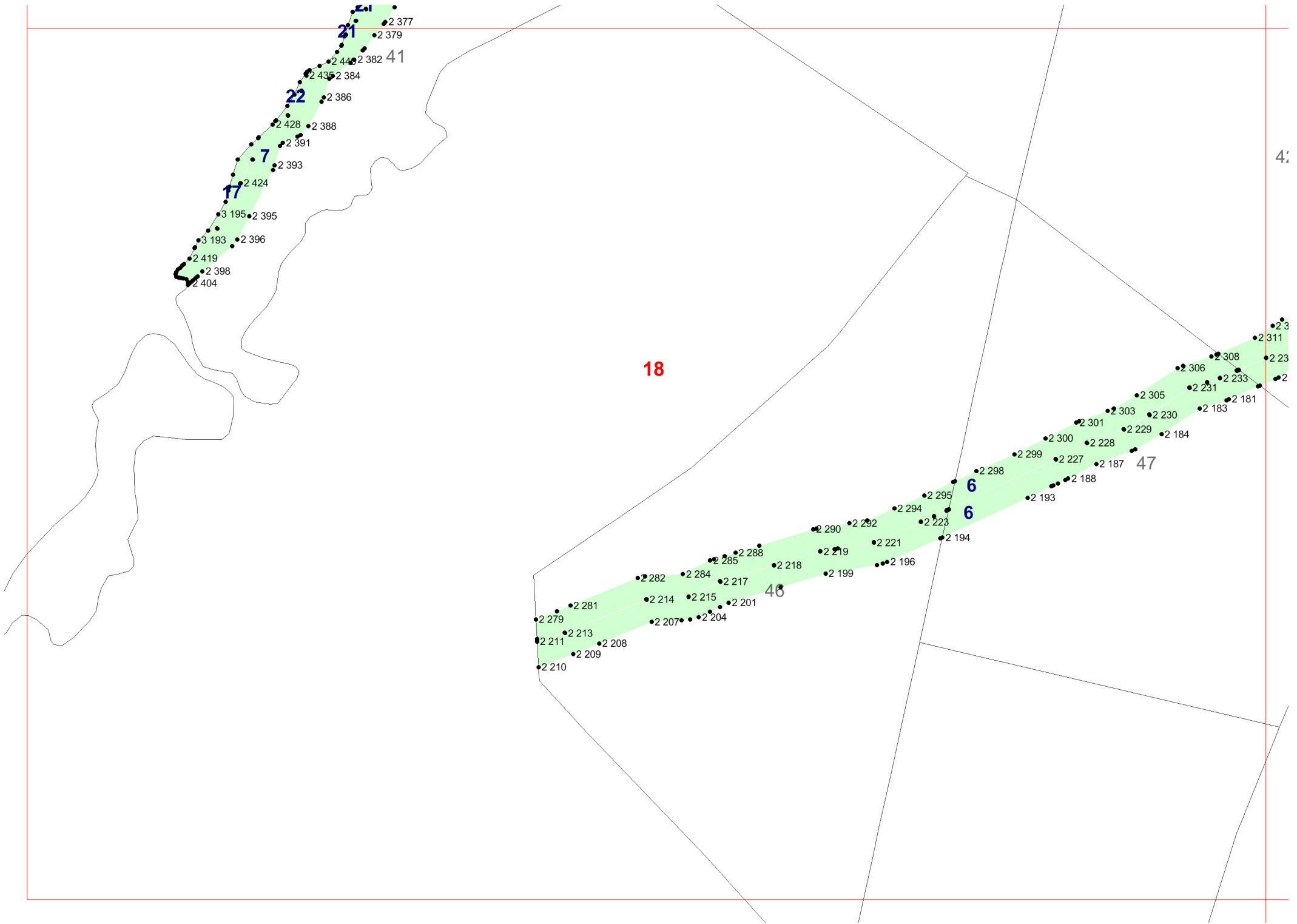

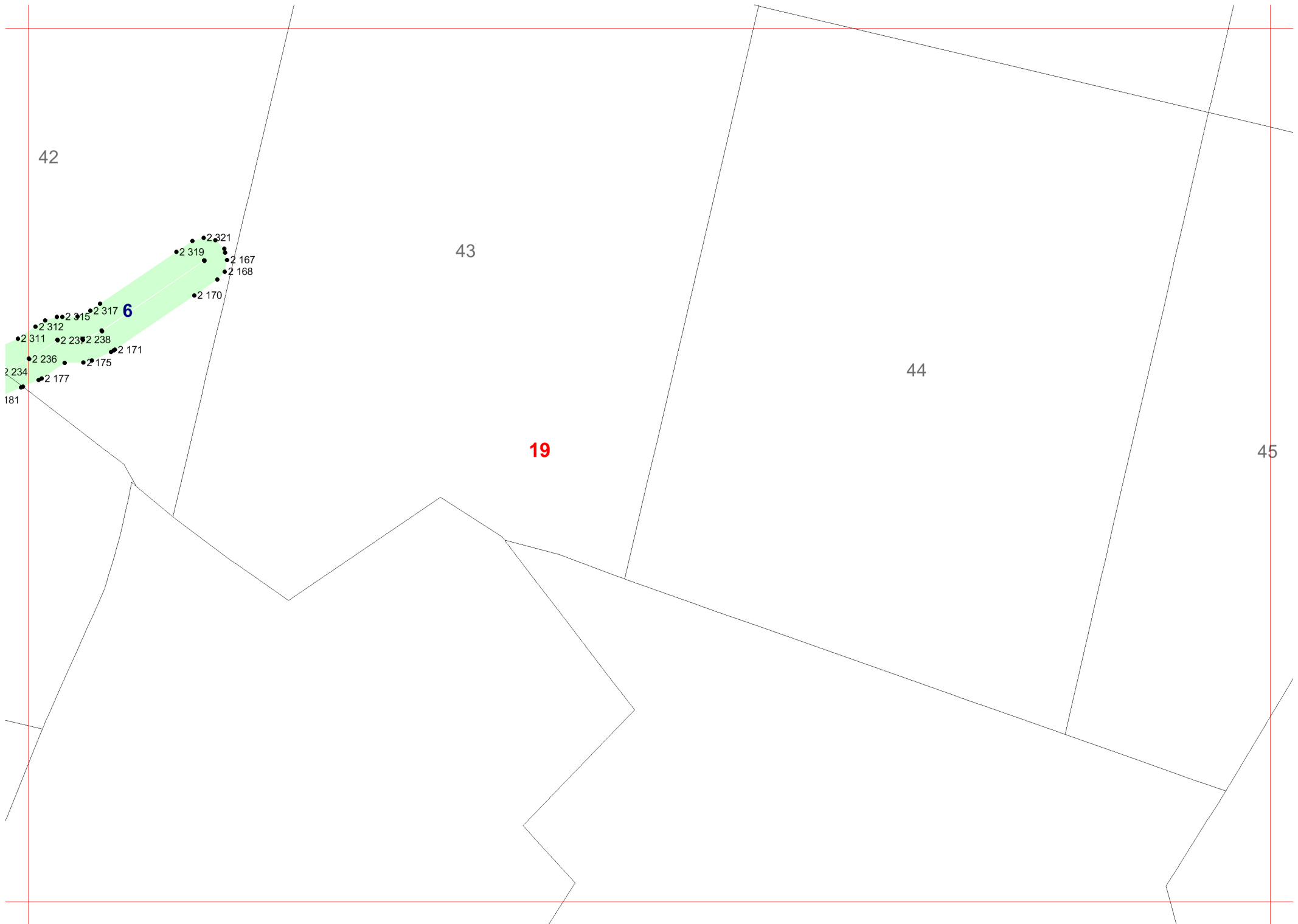

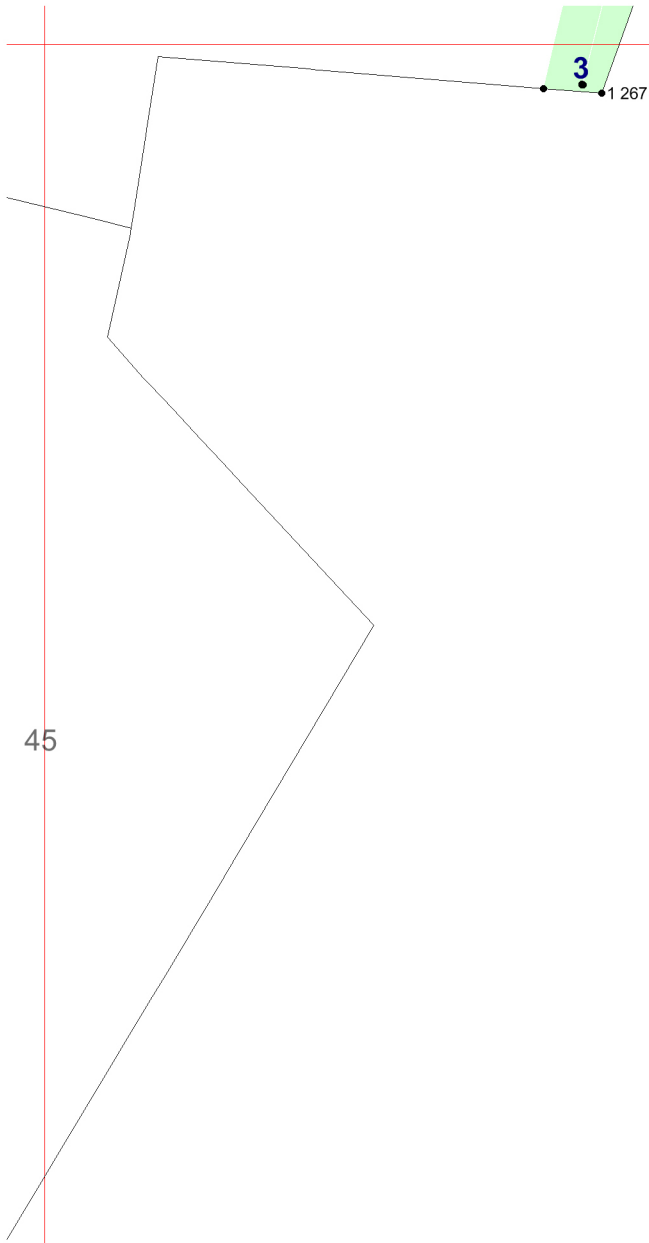

3

1 267

45

20

21

49

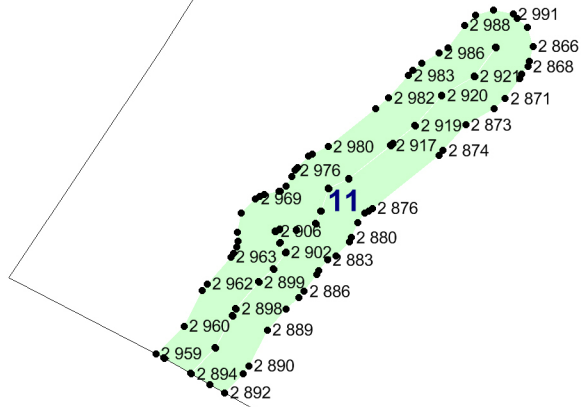

21

22

50

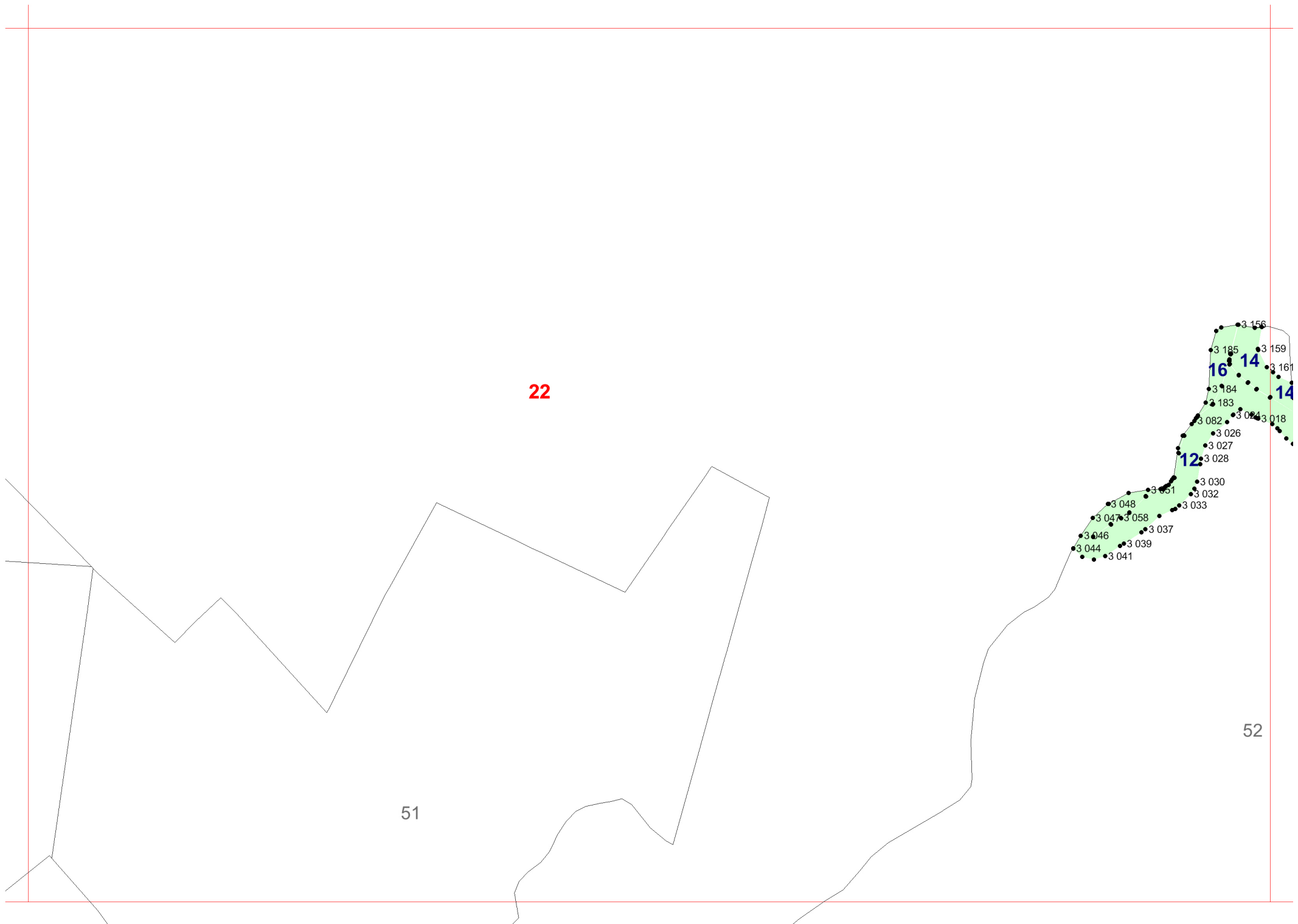

22

51

23

52

- 3 156
- 3 159
- 3 161
- 3 184
- 3 183
- 3 082
- 3 026
- 3 027
- 3 028
- 3 030
- 3 032
- 3 033
- 3 048
- 3 051
- 3 047
- 3 058
- 3 046
- 3 037
- 3 044
- 3 039
- 3 041

16

14

14

12

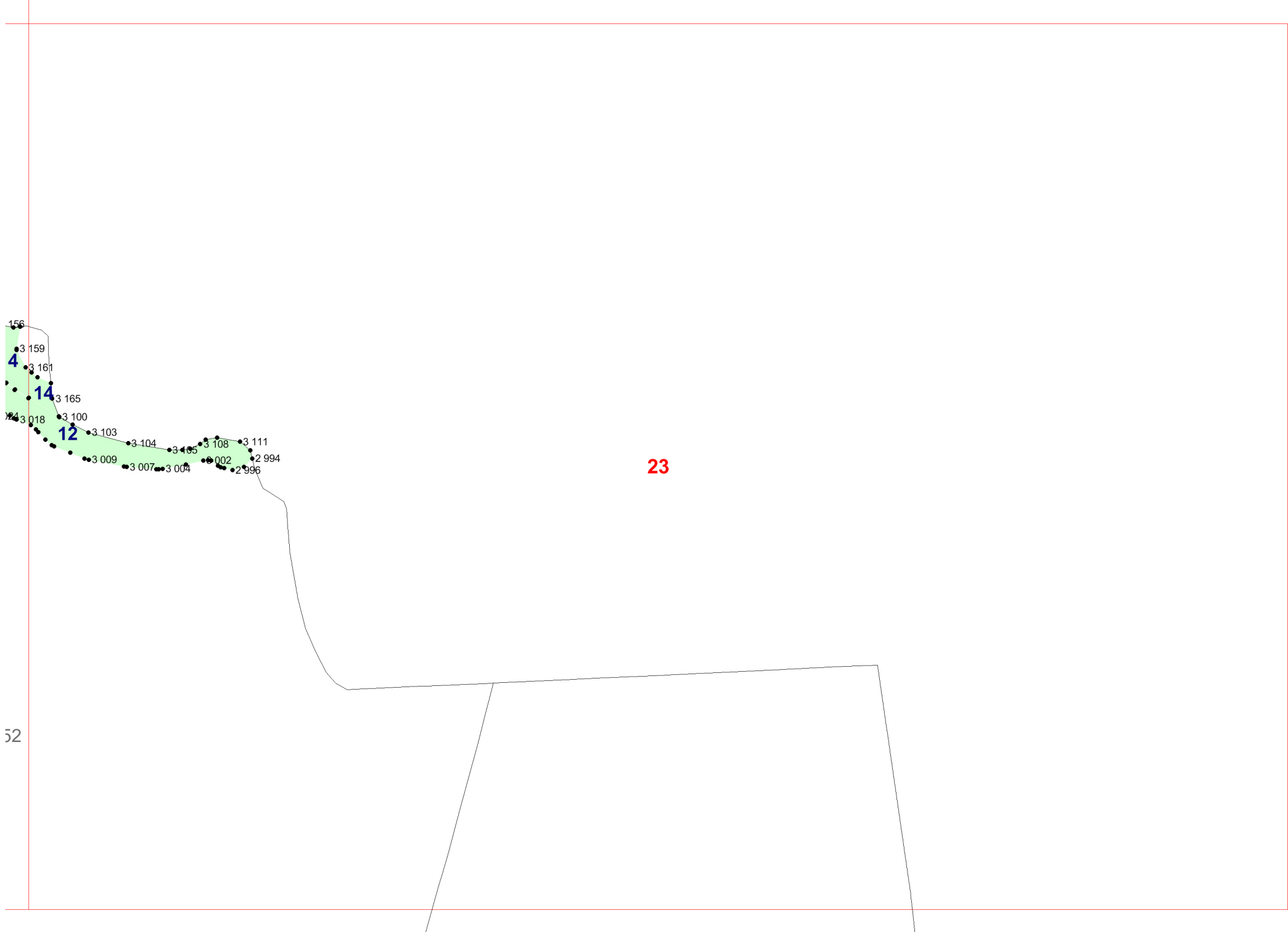

156  
3 159  
3 161  
3 165  
3 108  
3 111  
3 102  
2 994  
3 009  
3 007  
3 004  
3 104  
3 103  
3 100  
3 018  
3 005  
3 002  
2 996  
3 111

4  
14  
12

23

52

24



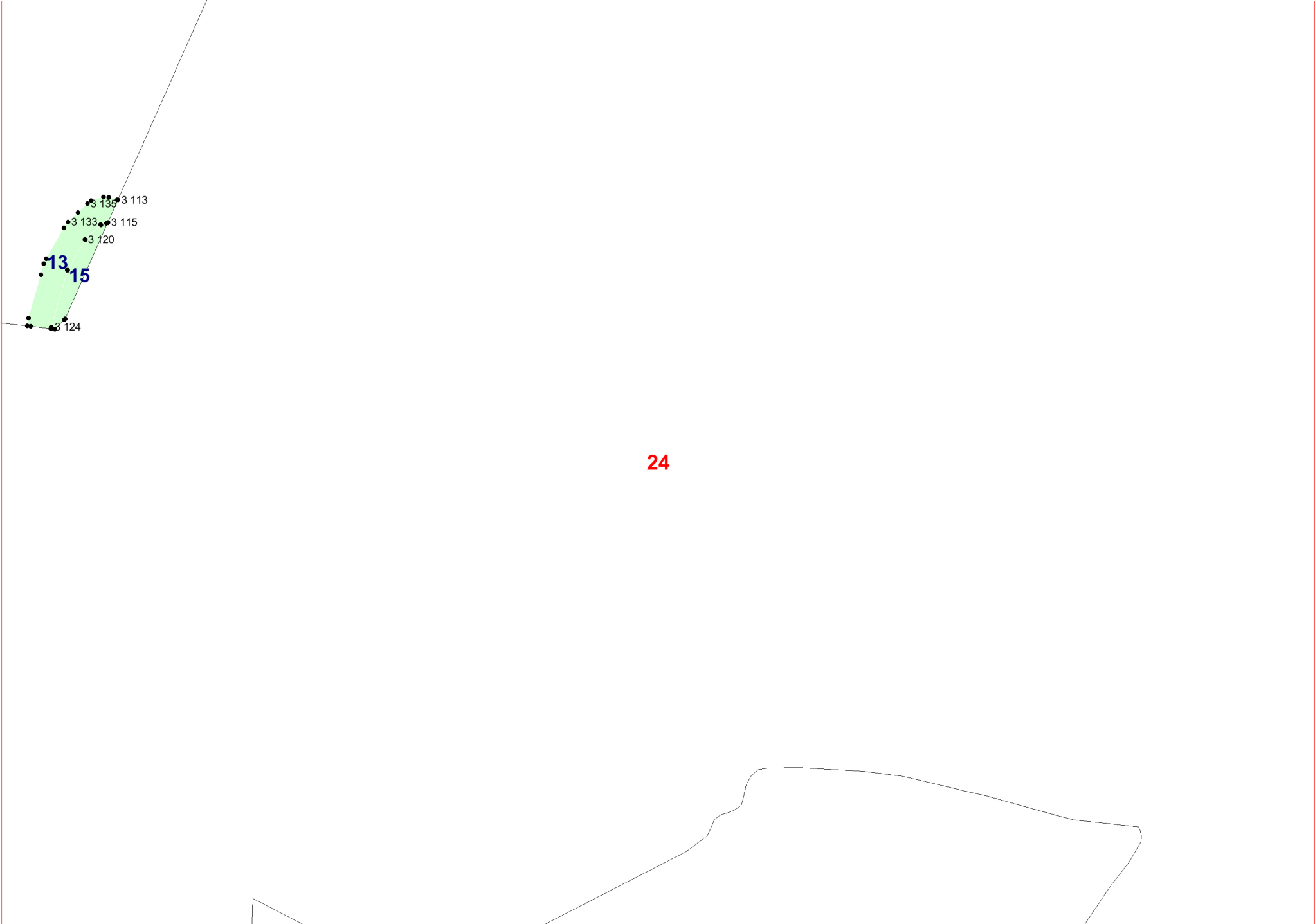

24

25

25

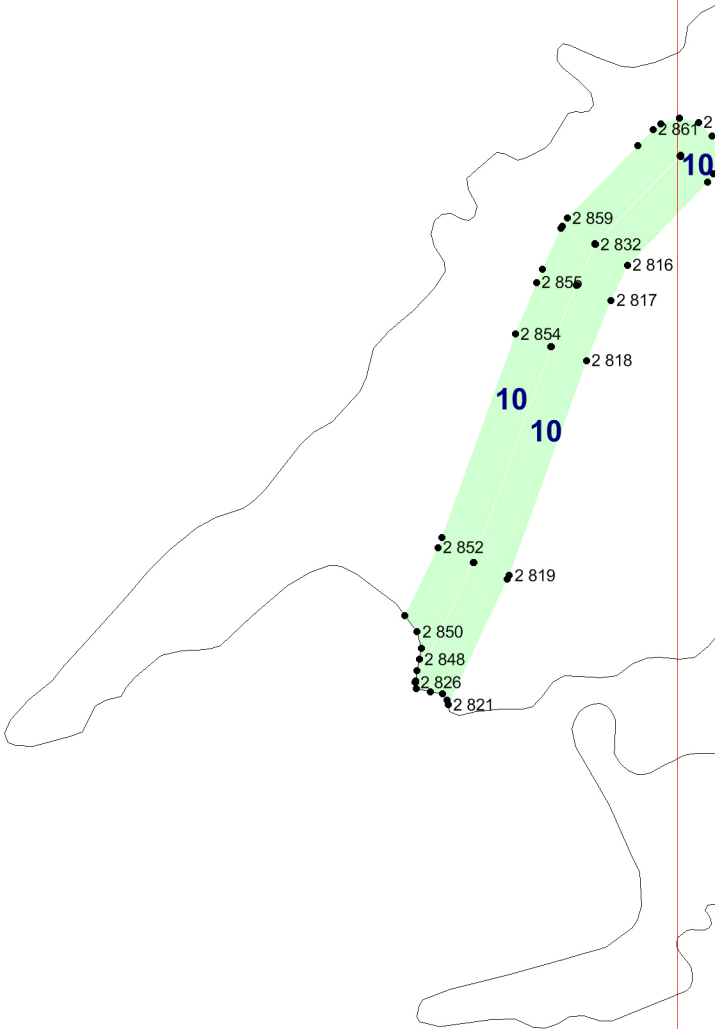

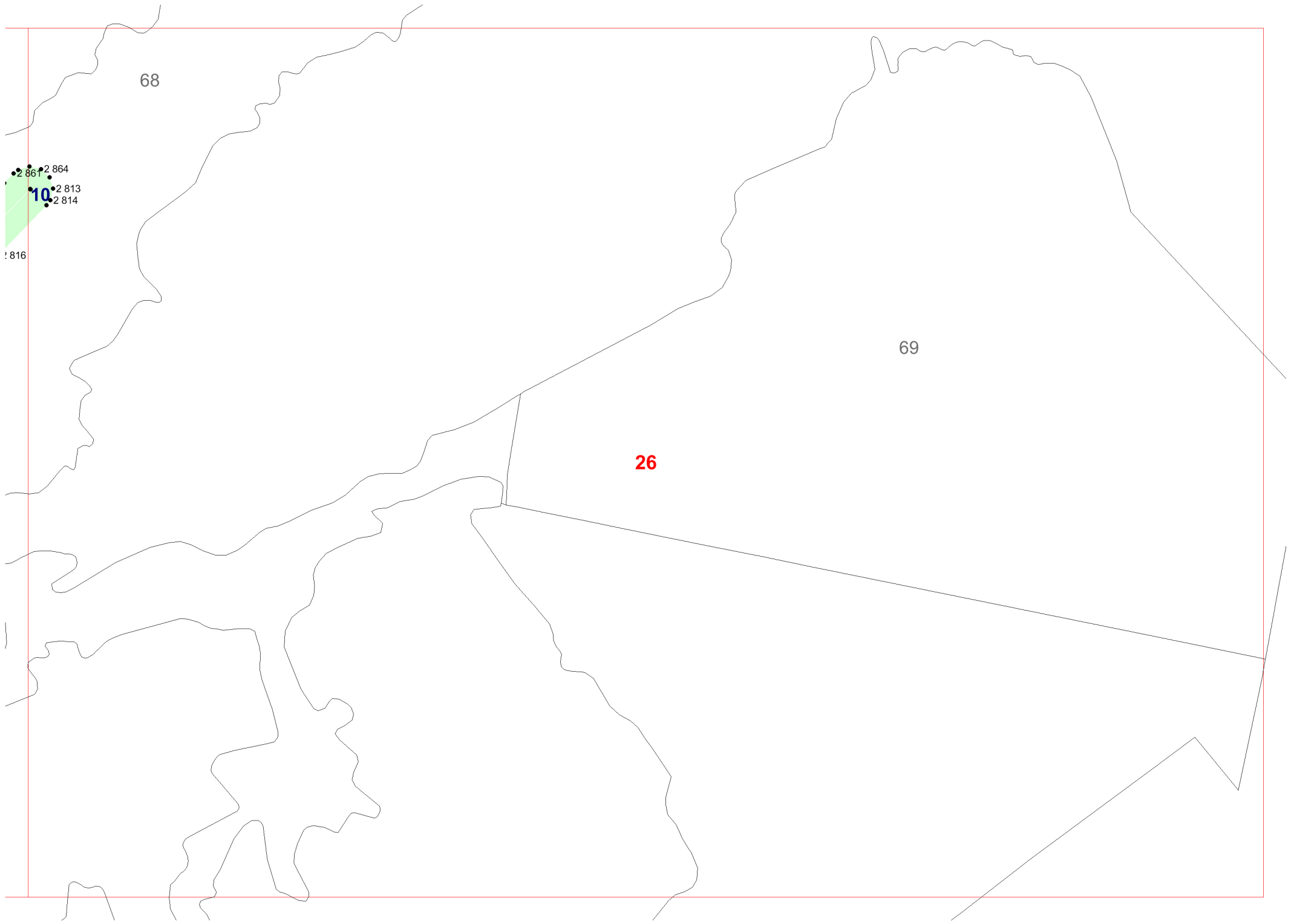

68

69

**26**

27

2861 2864  
2813 2814  
10

:816