

**Графическое описание местоположения границ земель,
на которых располагаются особо защитные участки
лесов «берегозащитные участки лесов»,
на территории
Бишиндинского участкового лесничества
Туймазинского лесничества
Республики Башкортостан**

Приложение № 213 к приказу Рослесхоза

от 27.02.2023

№ 201

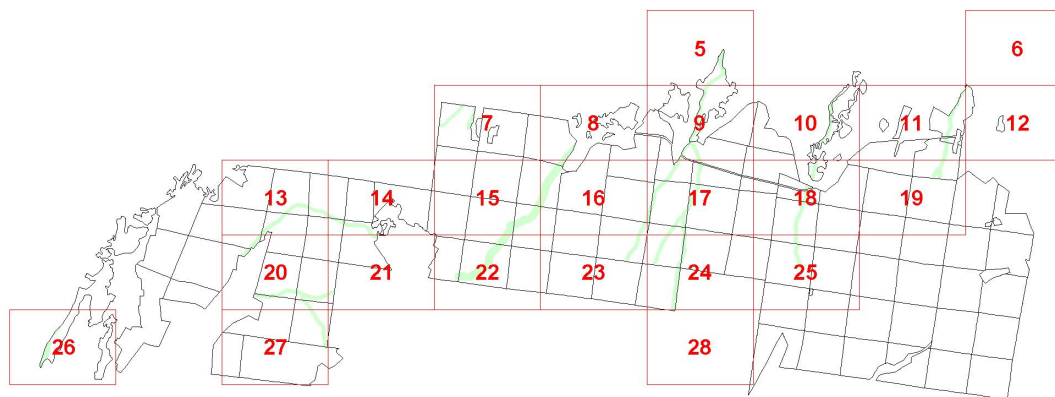

Условные обозначения:

- 1 номера листов
- 3 номера участков
- 61 номера лесных кварталов
- границы лесных кварталов
- границы листов
- границы особо защитных участков лесов
- 45 номера характерных точек границ объекта

1

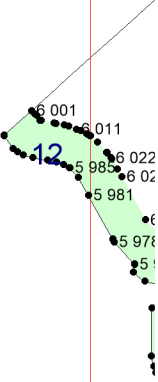

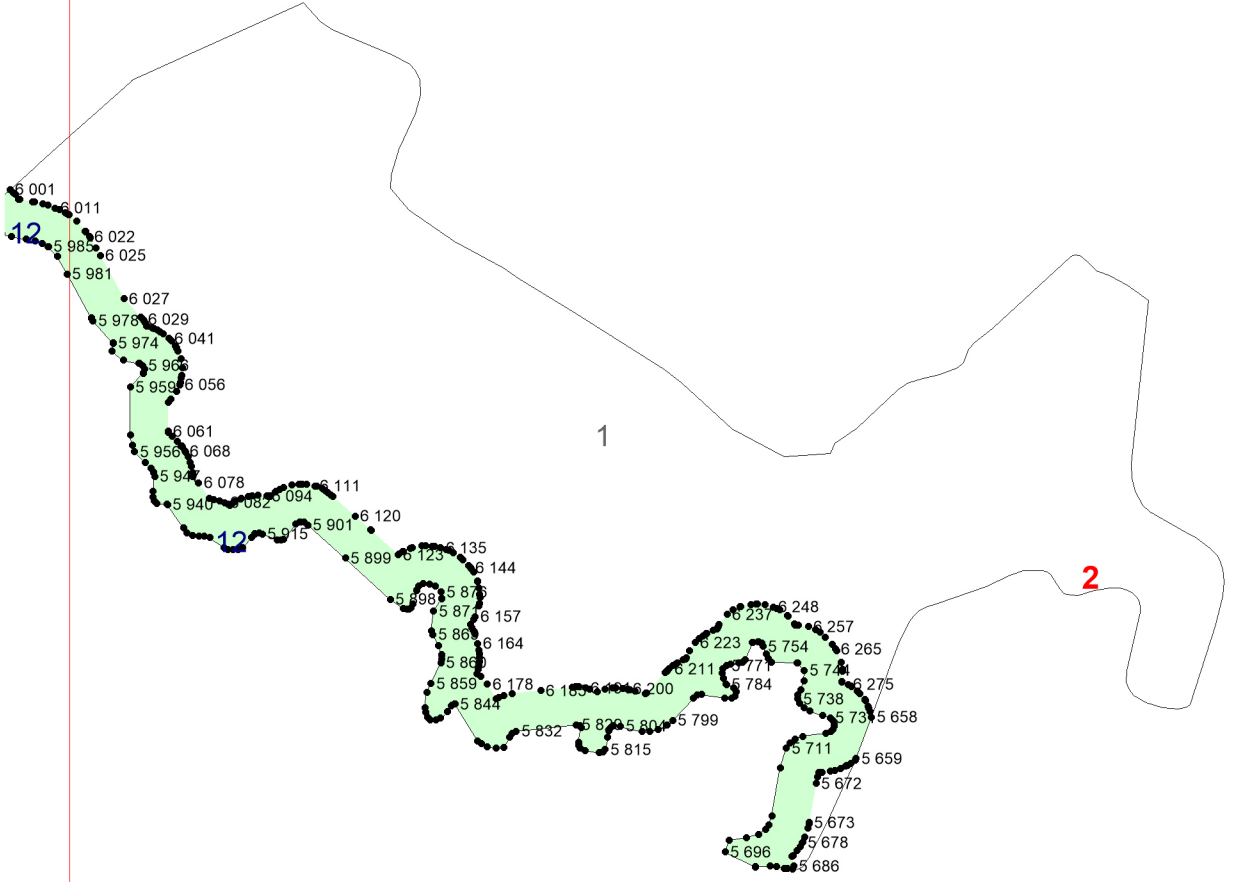

3

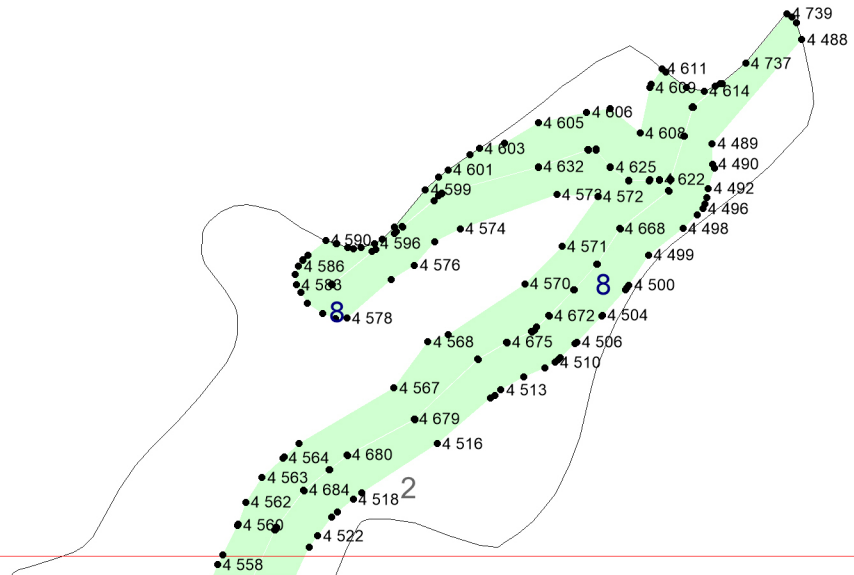

4

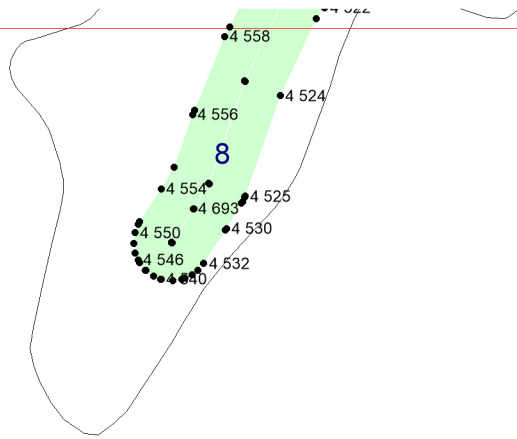

4

5

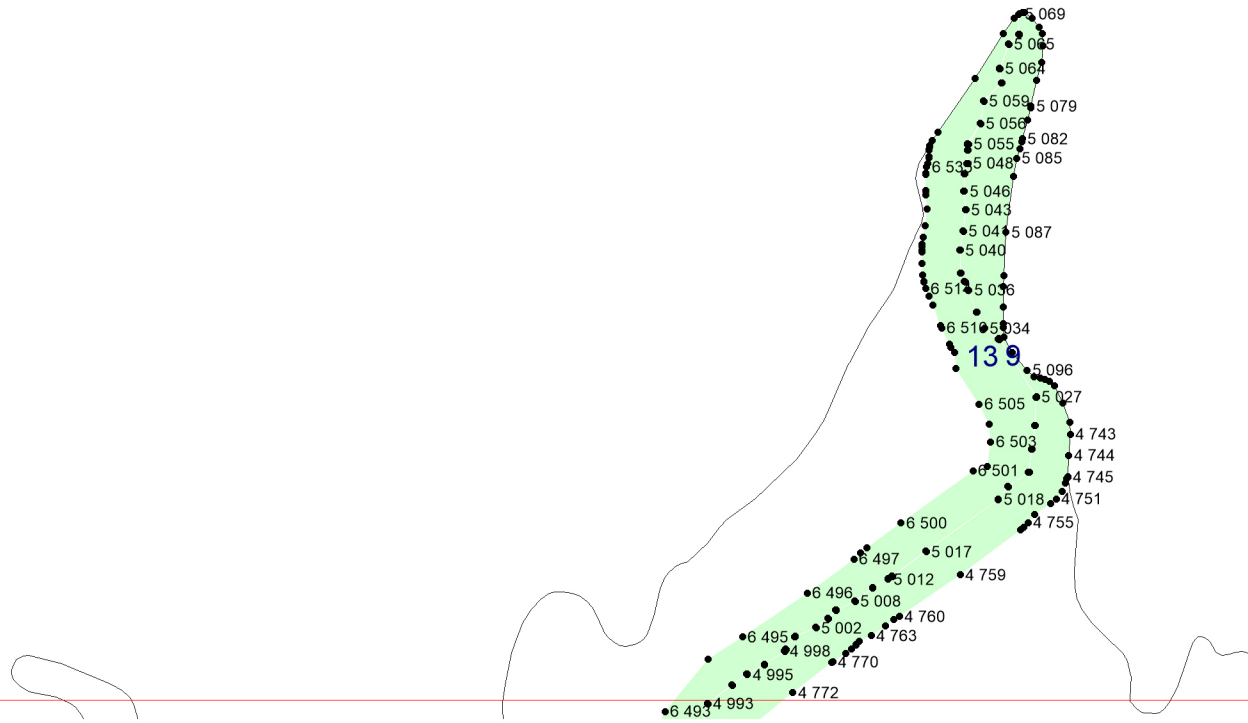

6

6

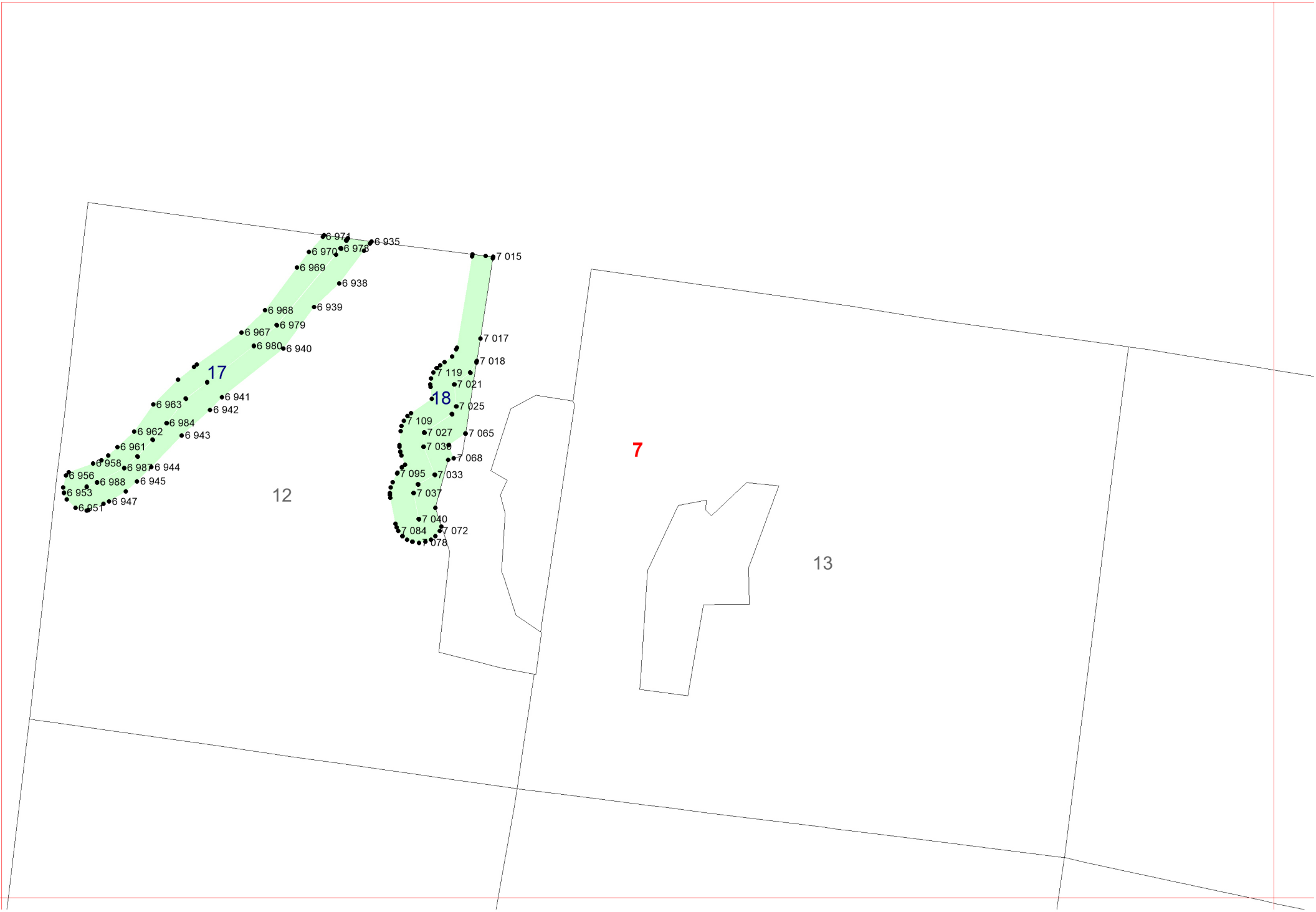

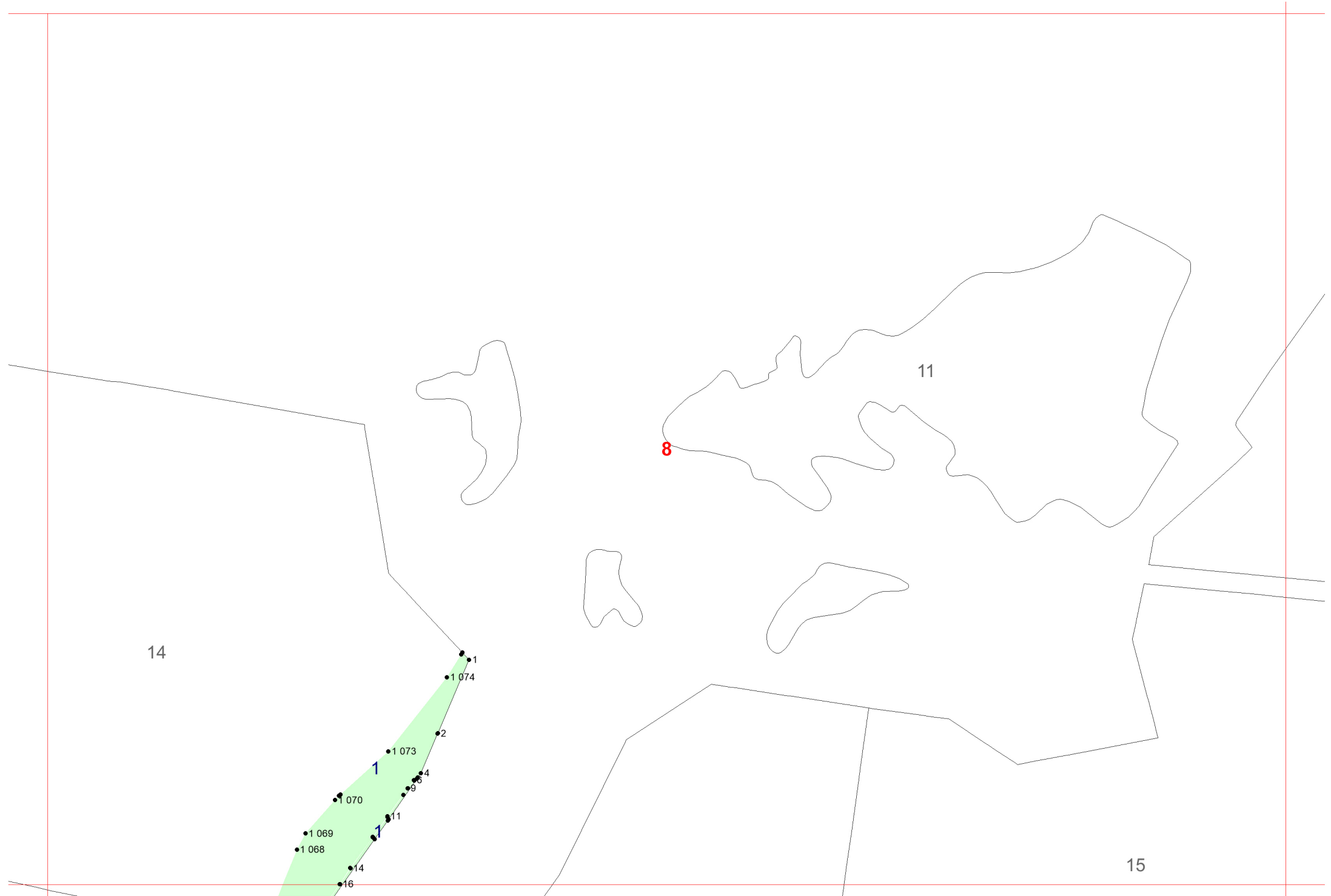

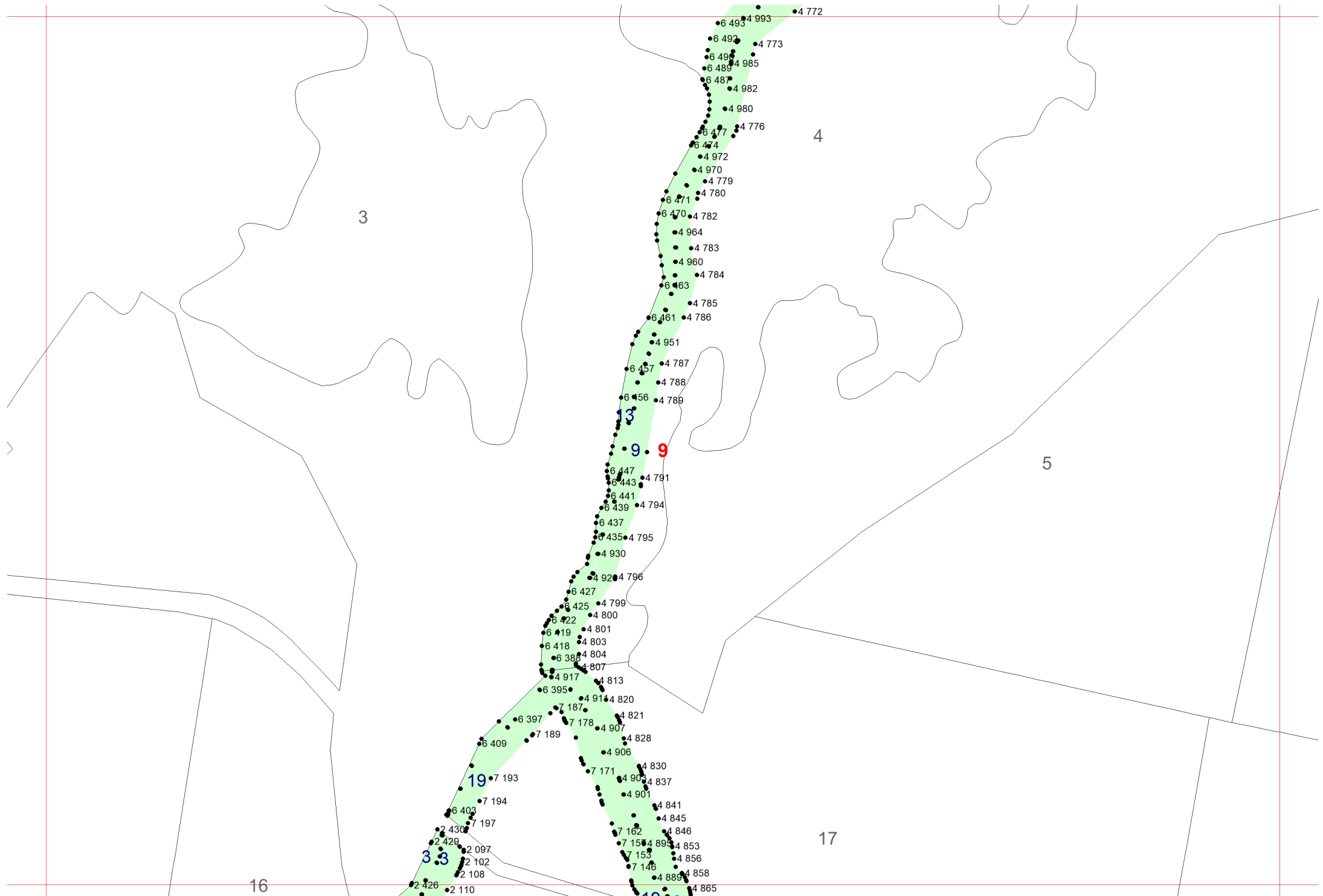

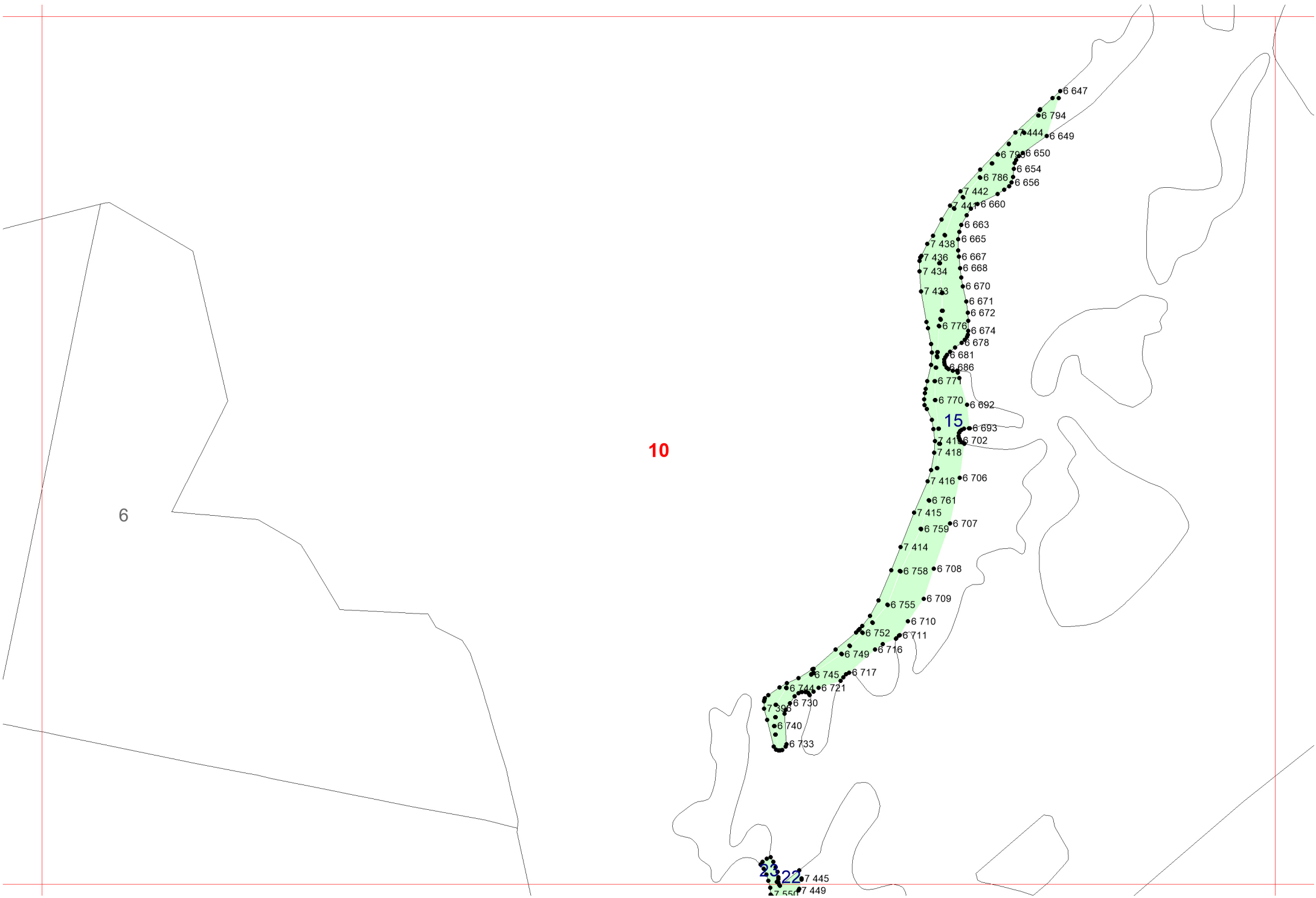

10

6

15

23
22
21

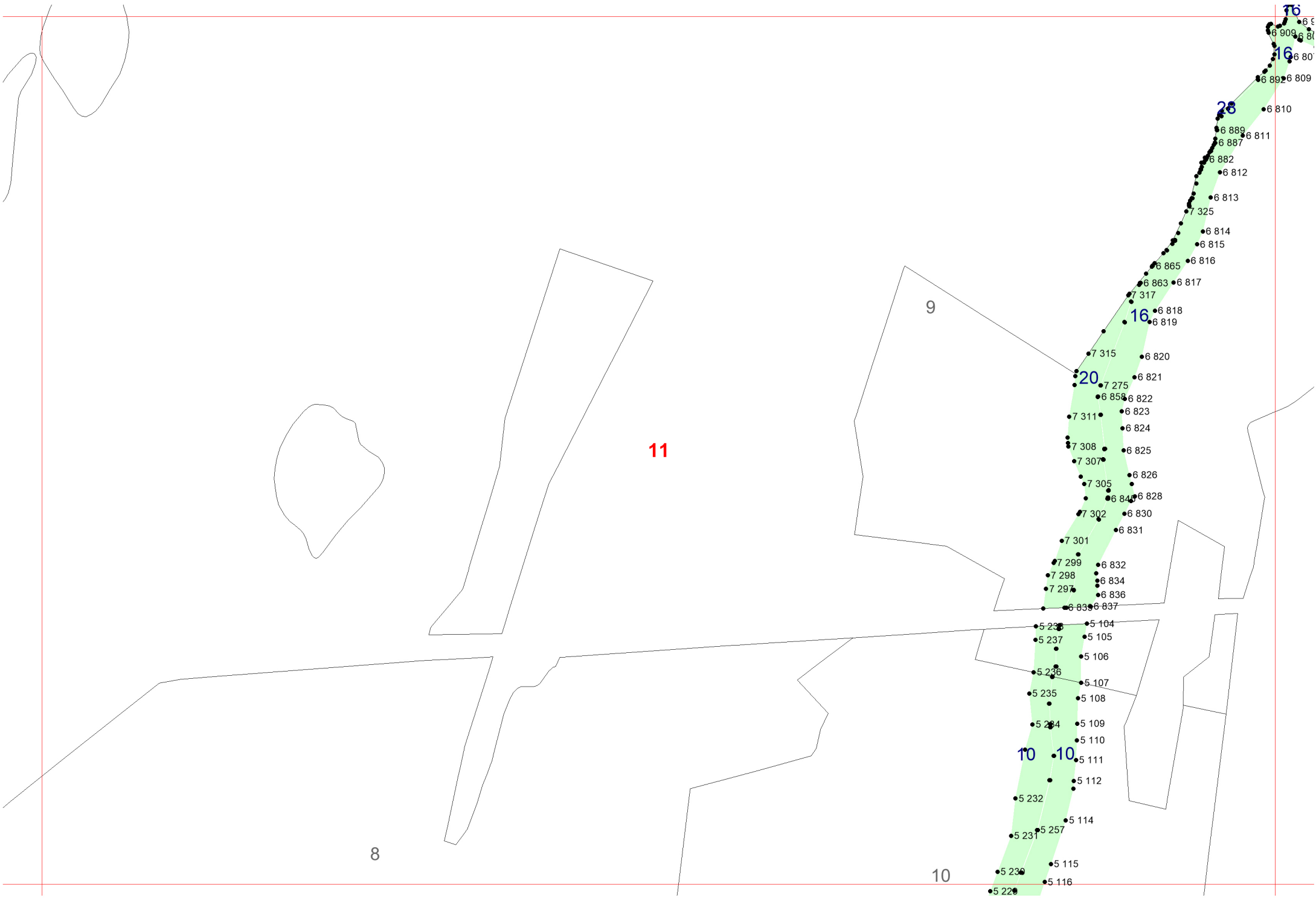

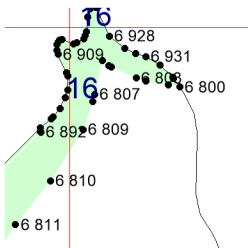

12

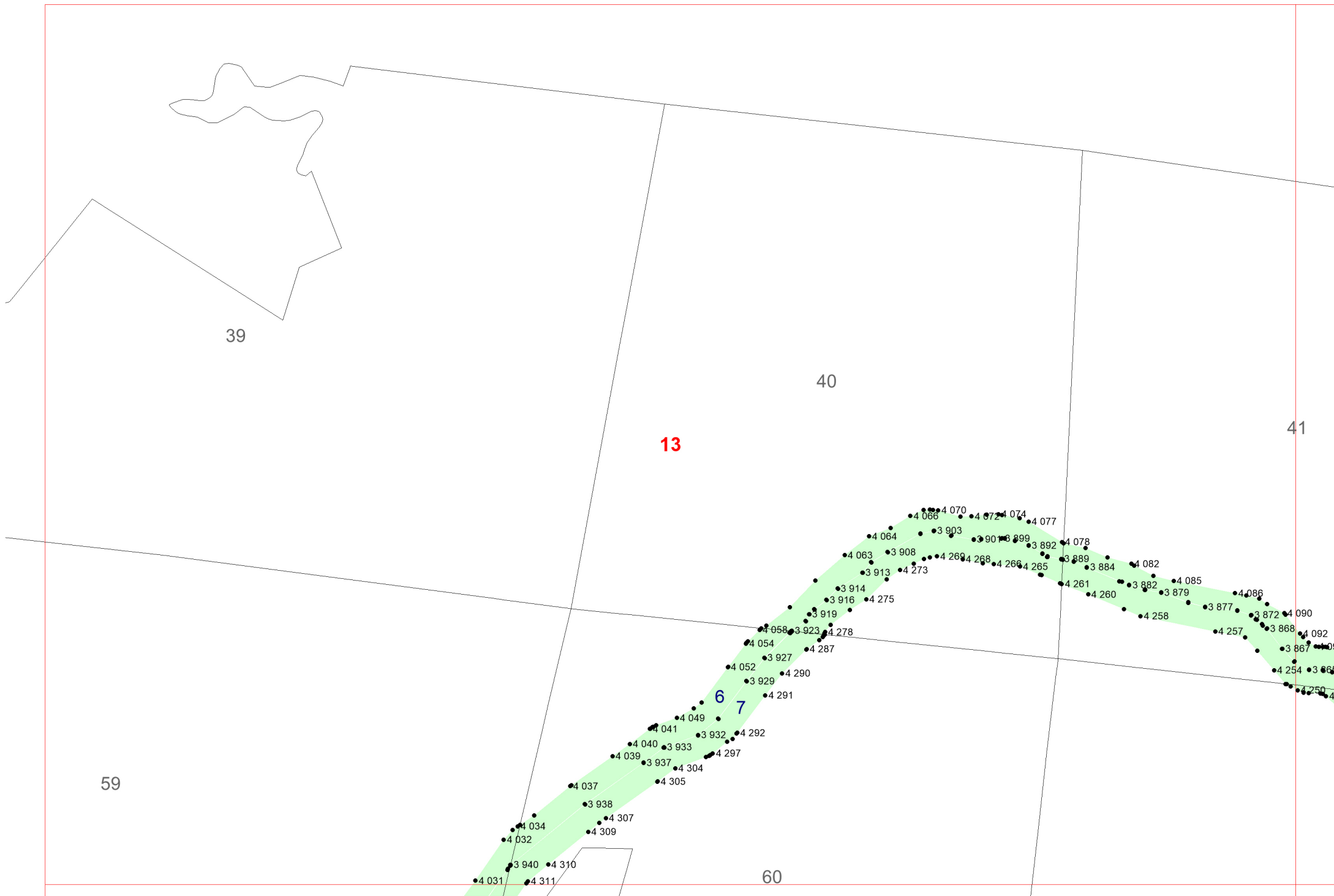

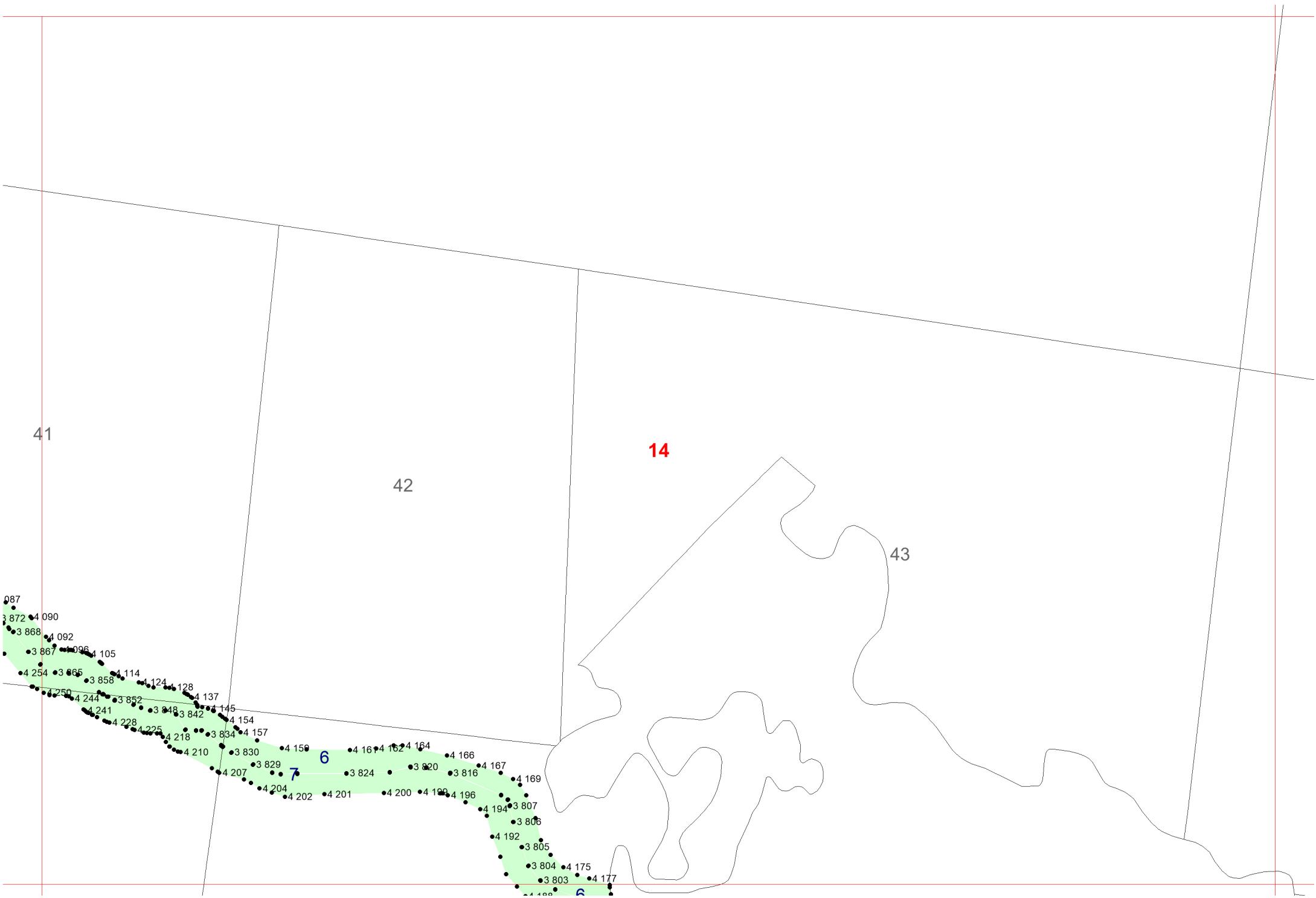

41

42

14

43

- 3872
- 4090
- 3868
- 4092
- 3867
- 4096
- 4105
- 4254
- 3865
- 3858
- 4114
- 4124
- 4128
- 4250
- 4244
- 3852
- 3848
- 3842
- 4137
- 4145
- 4154
- 4241
- 4228
- 4225
- 4218
- 4210
- 3834
- 4157
- 4150
- 3829
- 4207
- 4204
- 4202
- 4201
- 4200
- 4196
- 4196
- 4196
- 4167
- 4169
- 3807
- 3806
- 4192
- 3805
- 3804
- 4175
- 3803
- 4177
- 4188
- 4188

6

7

6

15

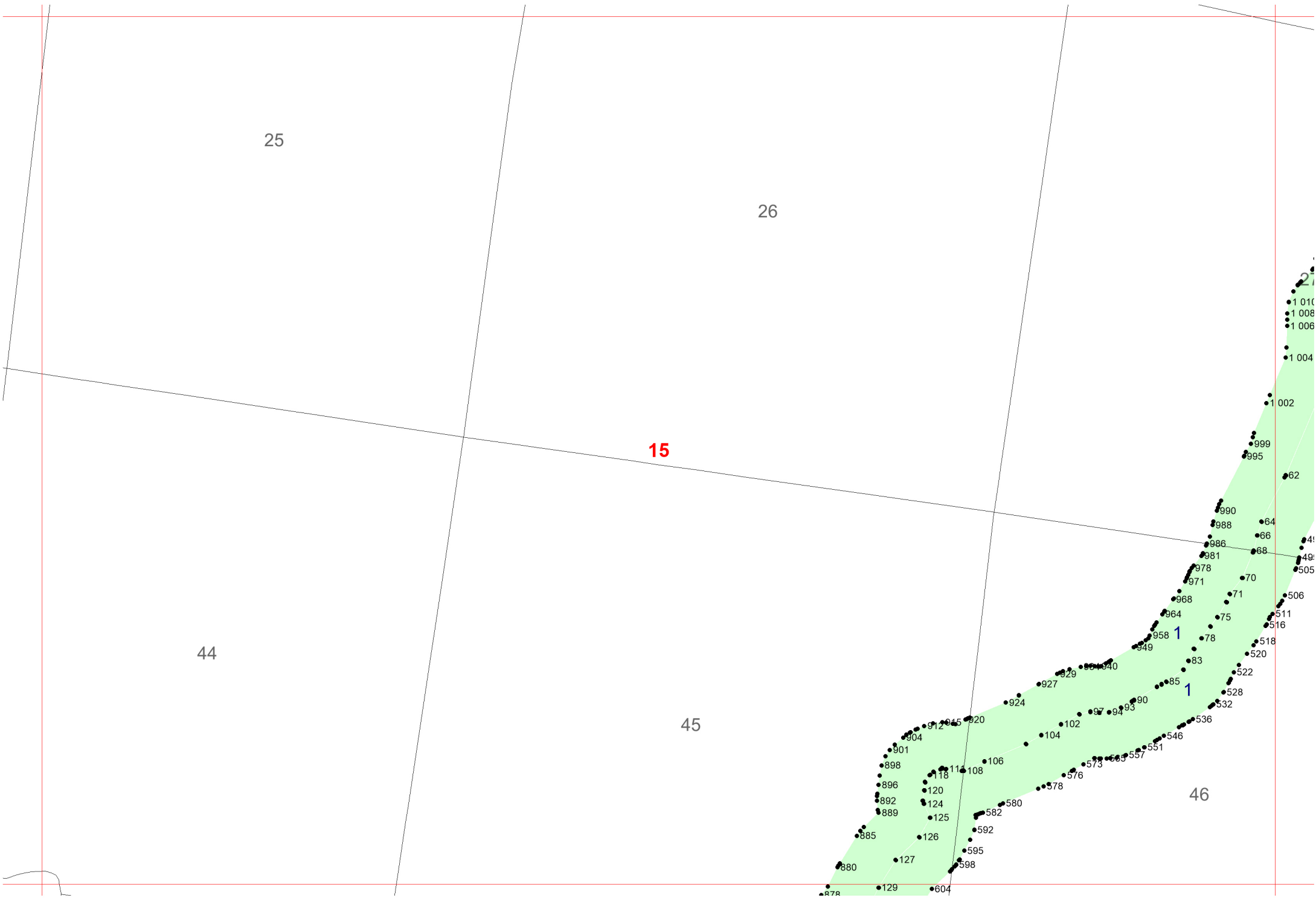

25

26

15

44

45

46

16

1010
1008
1006

1004

1002

999

995

62

990

988

64

66

41

49

505

506

511

516

518

520

522

528

532

536

546

551

557

563

573

576

578

580

582

592

595

598

604

129

880

127

885

889

892

896

898

901

904

912

915

920

924

927

929

940

945

949

958

964

968

971

978

981

986

990

999

1002

1004

1006

1008

1010

1

1

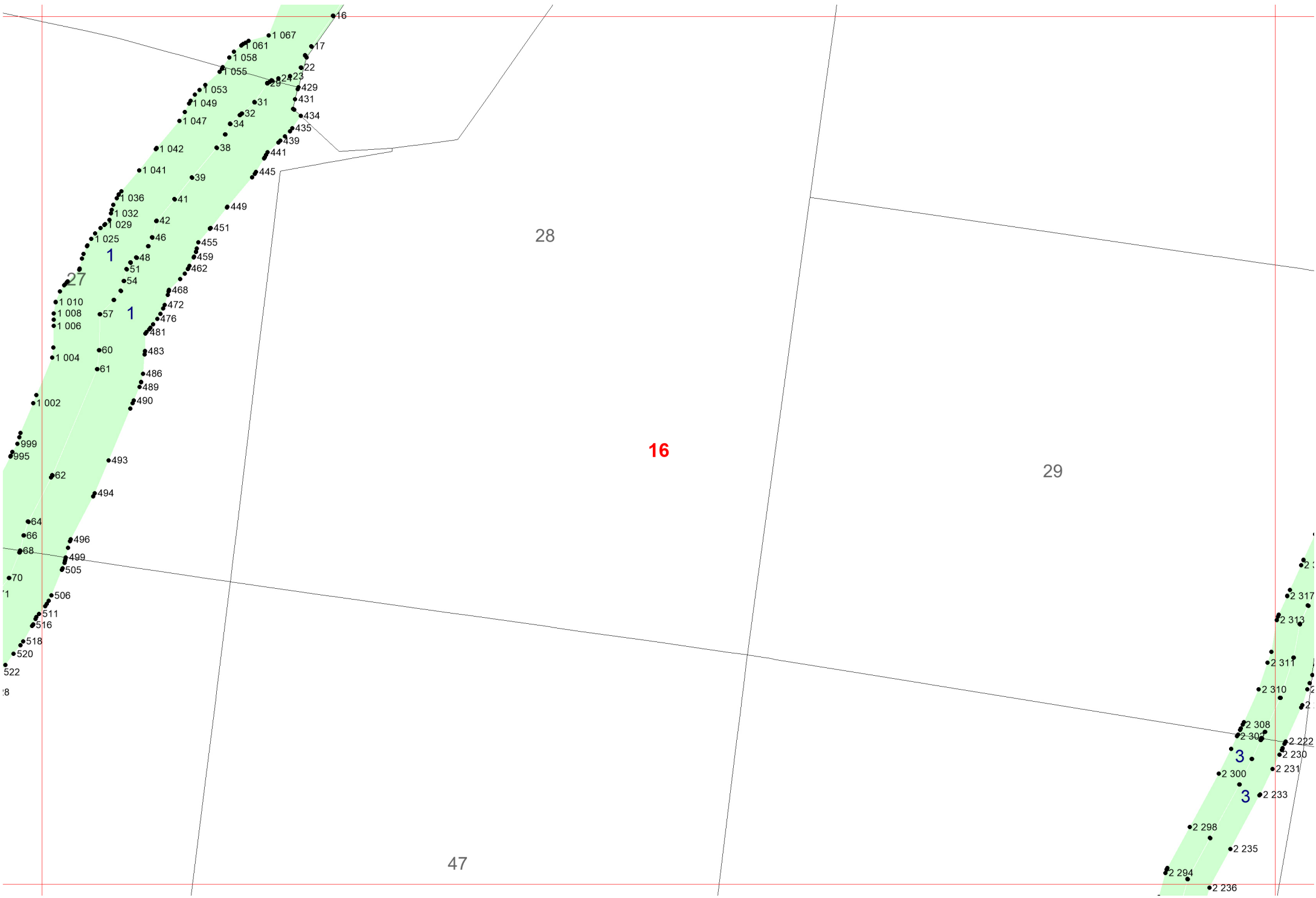

28

16

29

47

17

1

27

1

1

3

3

1

8

2

2

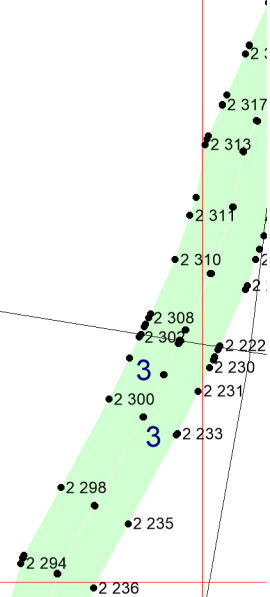
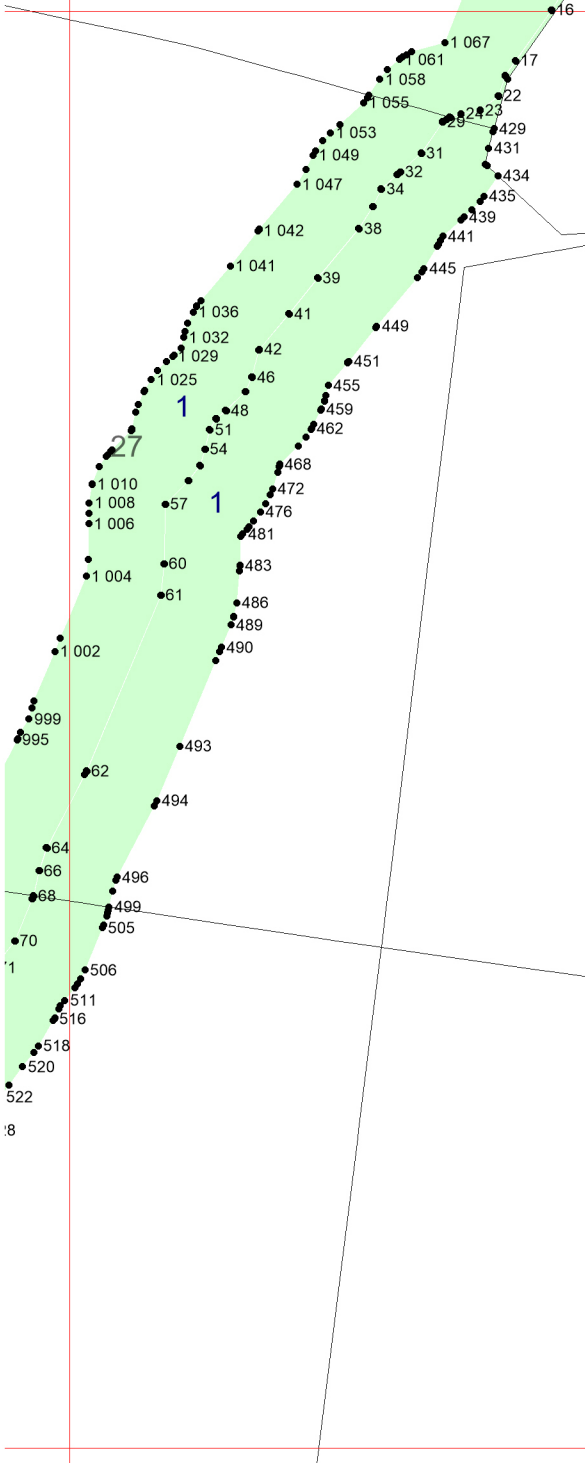

16

19

32

31

30

17

2

3

235

18

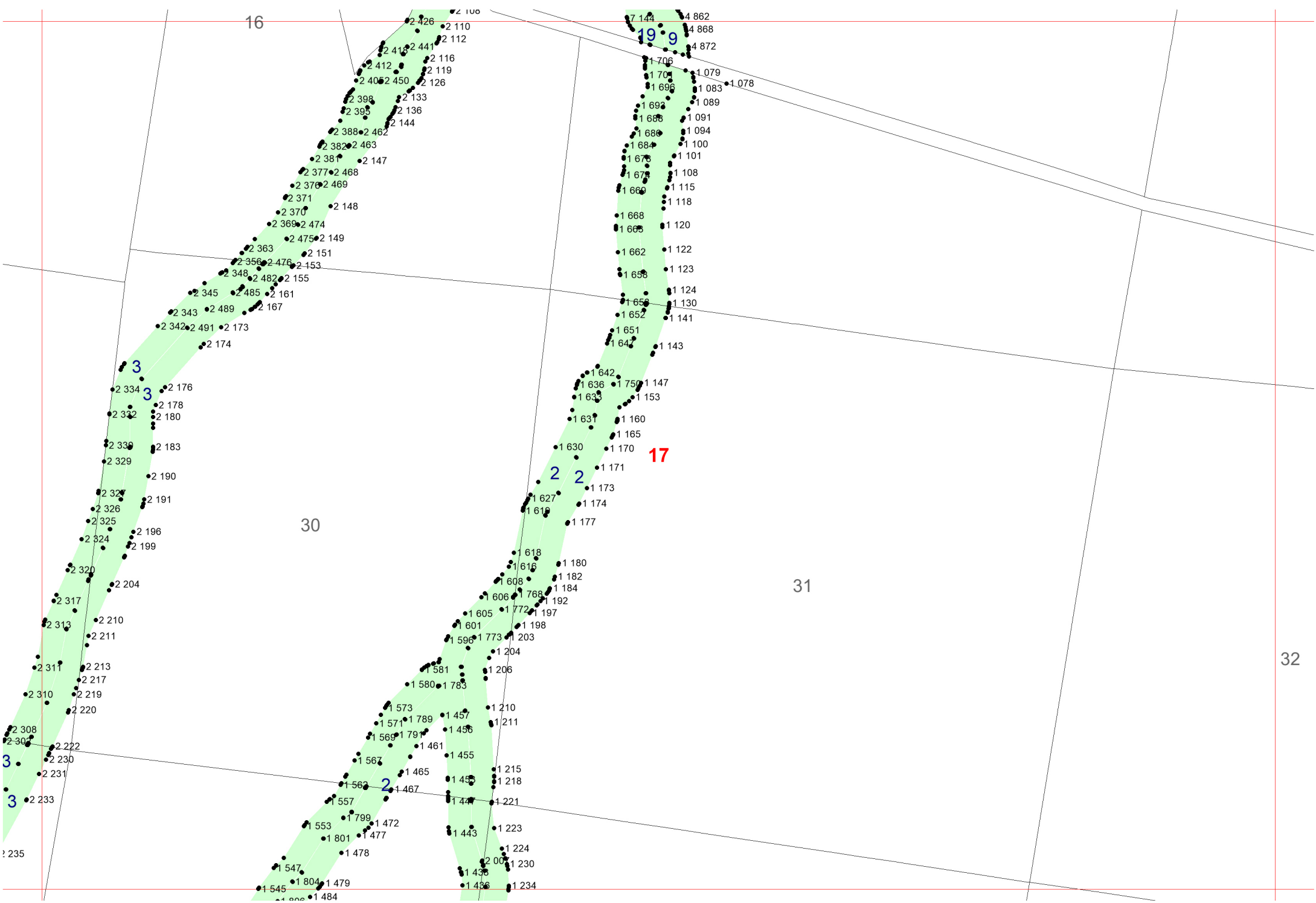

18

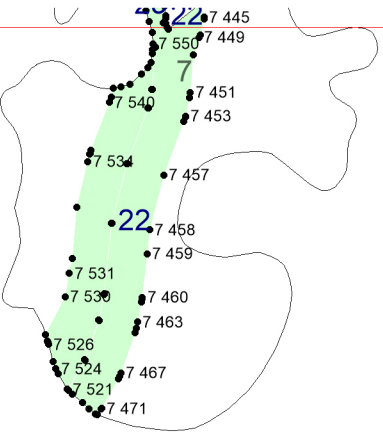

20

19

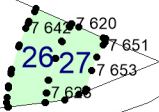

18

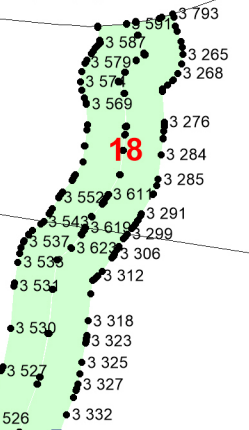

32

34

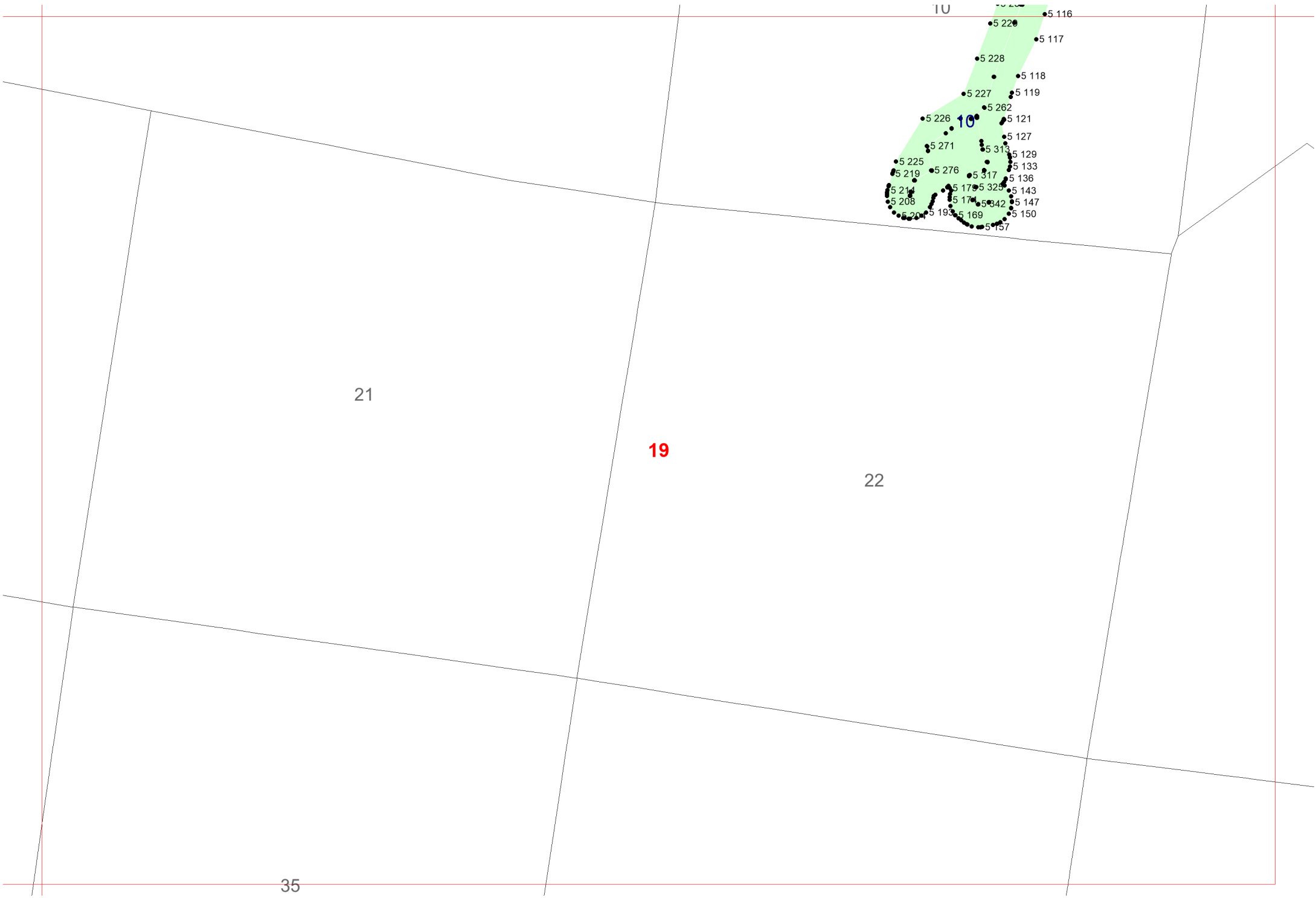

21

19

22

35

20

10

10

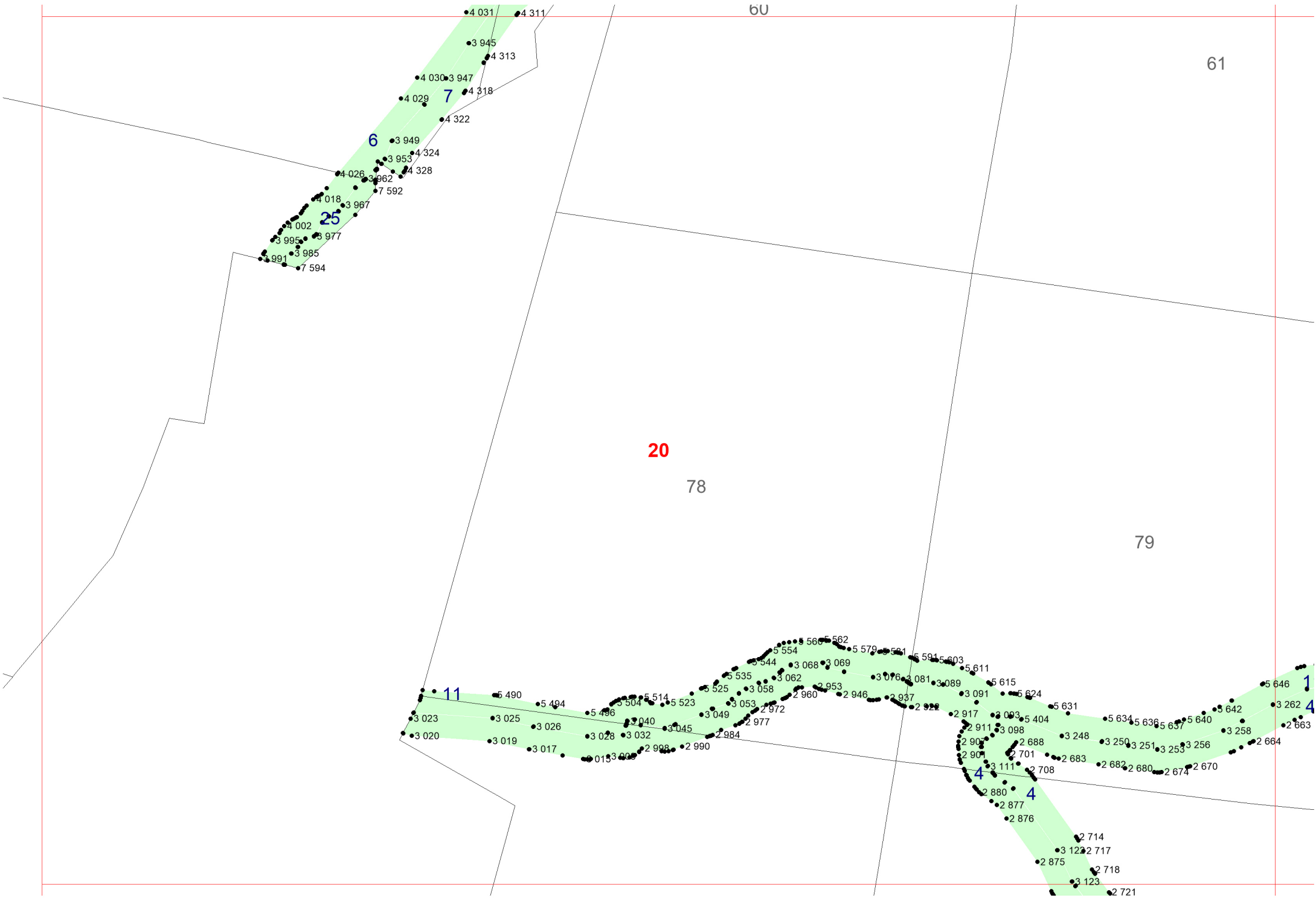

20

78

60

61

79

11

4

4

1

4

21

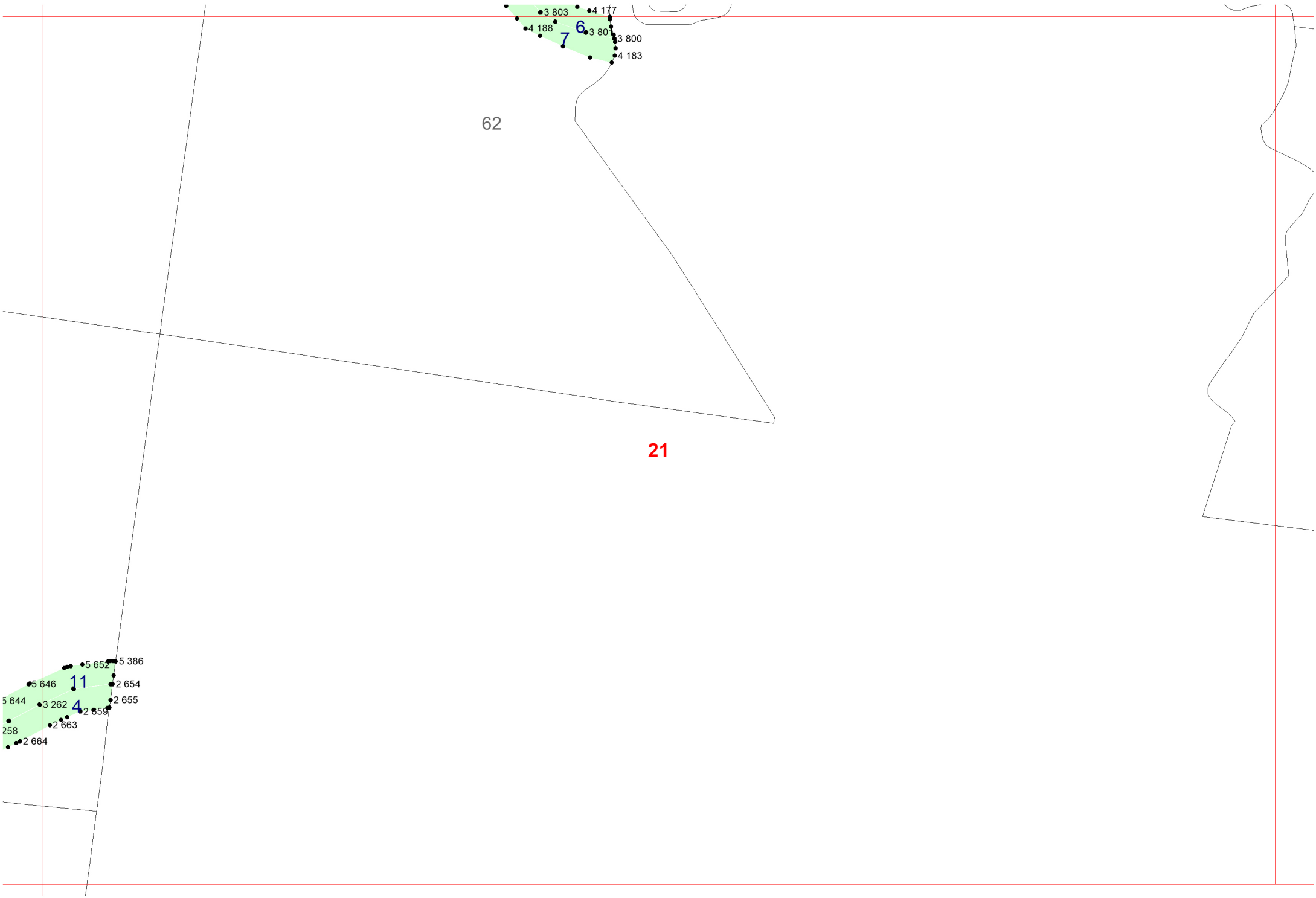

62

21

6

7

11

4

3 803

4 177

4 188

3 801

3 800

4 183

5 644

5 646

258

2 664

3 262

2 663

5 652

5 386

2 654

2 655

2 659

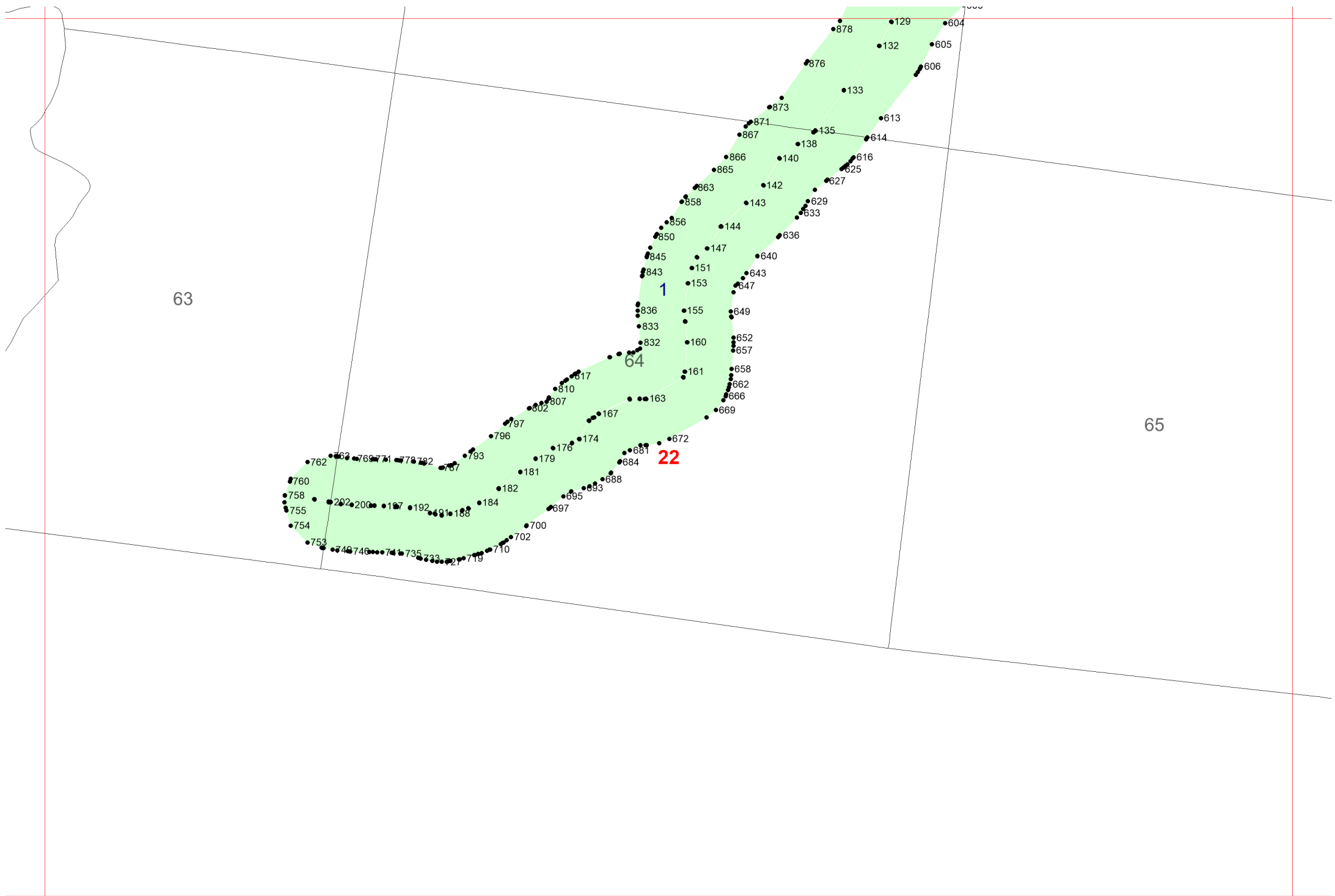

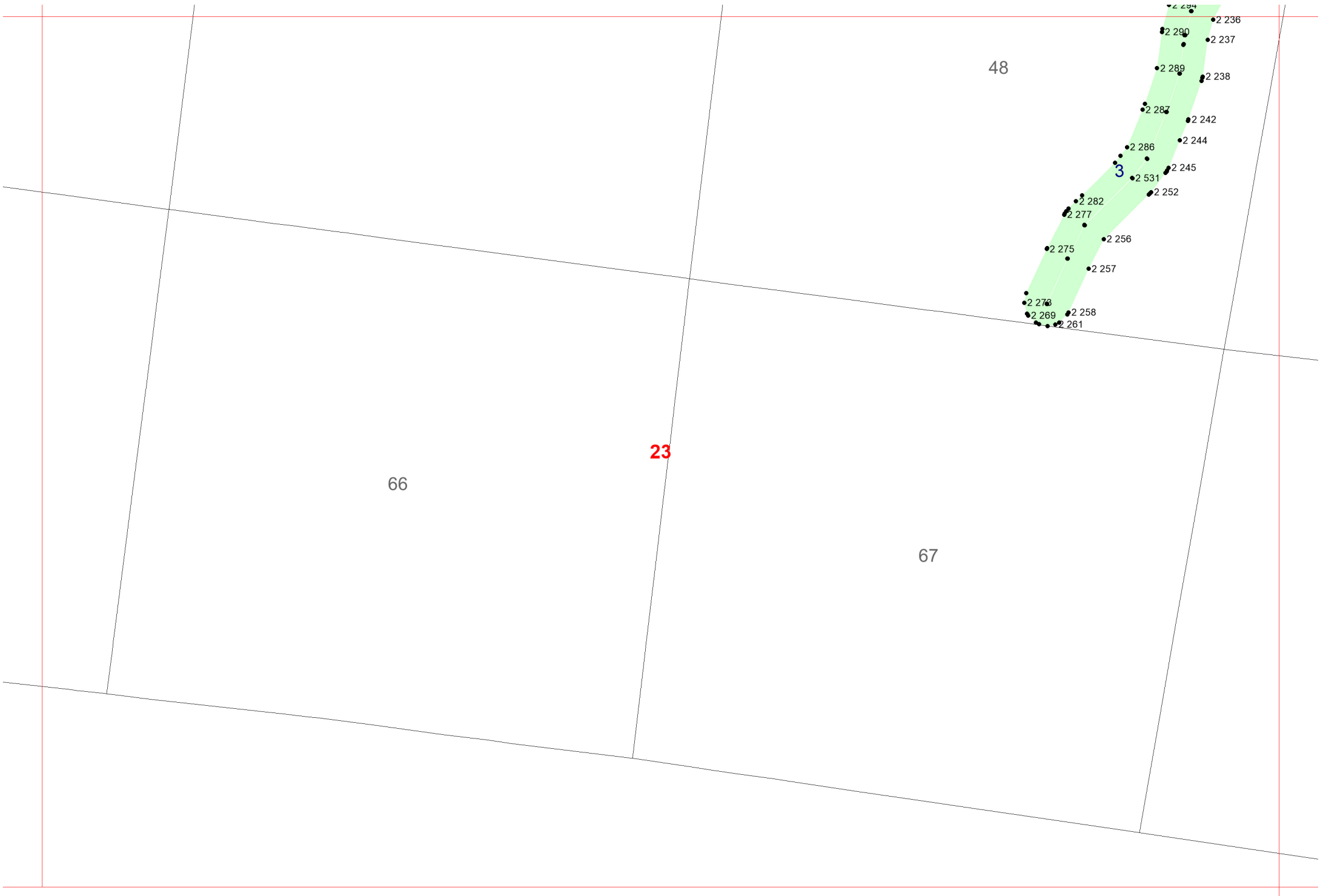

48

66

23

67

24

3

- 2 294
- 2 290
- 2 237
- 2 289
- 2 238
- 2 287
- 2 242
- 2 286
- 2 244
- 2 531
- 2 245
- 2 252
- 2 282
- 2 277
- 2 275
- 2 256
- 2 257
- 2 276
- 2 269
- 2 258
- 2 261

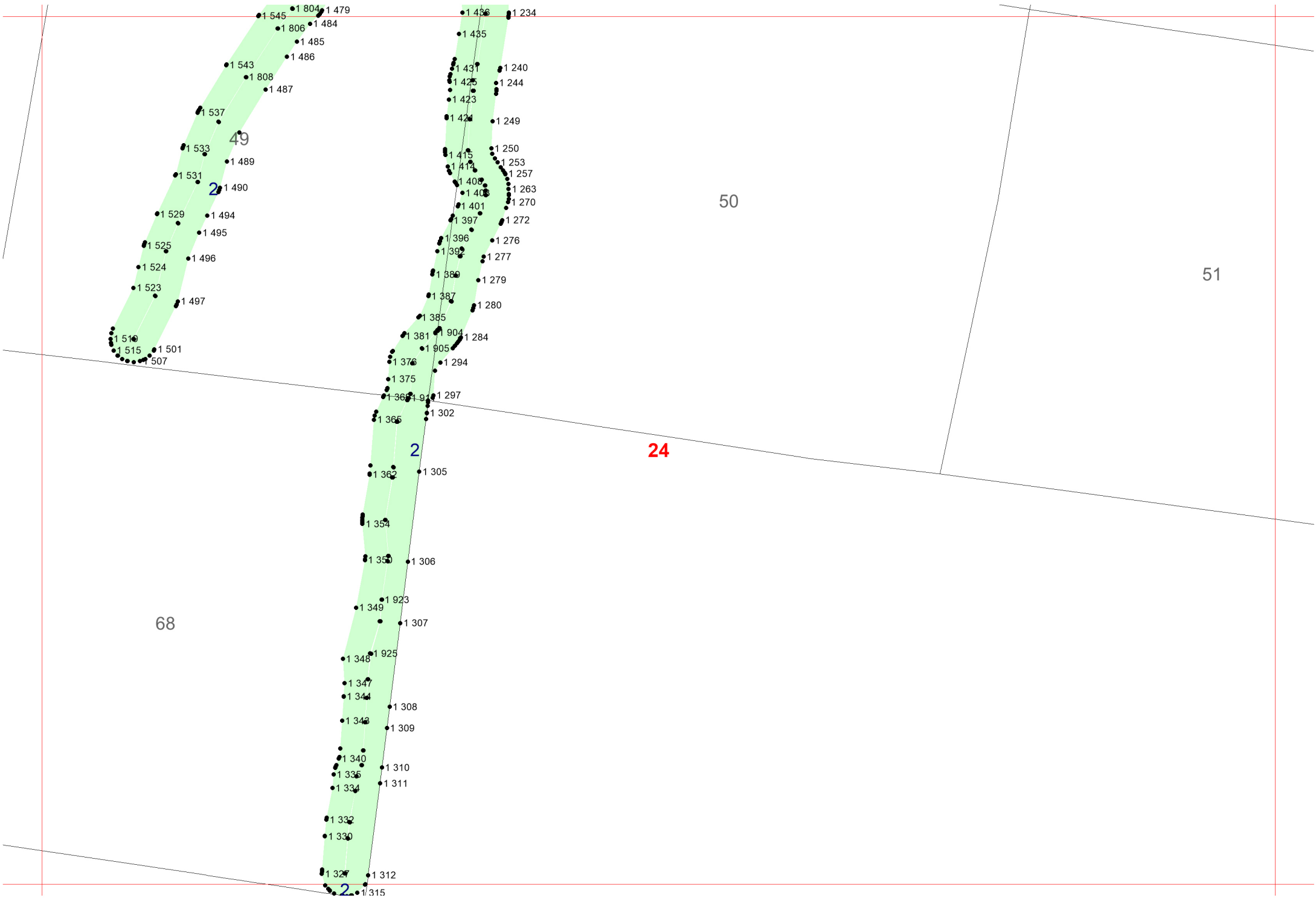

68

49

50

51

24

2

2

2

25

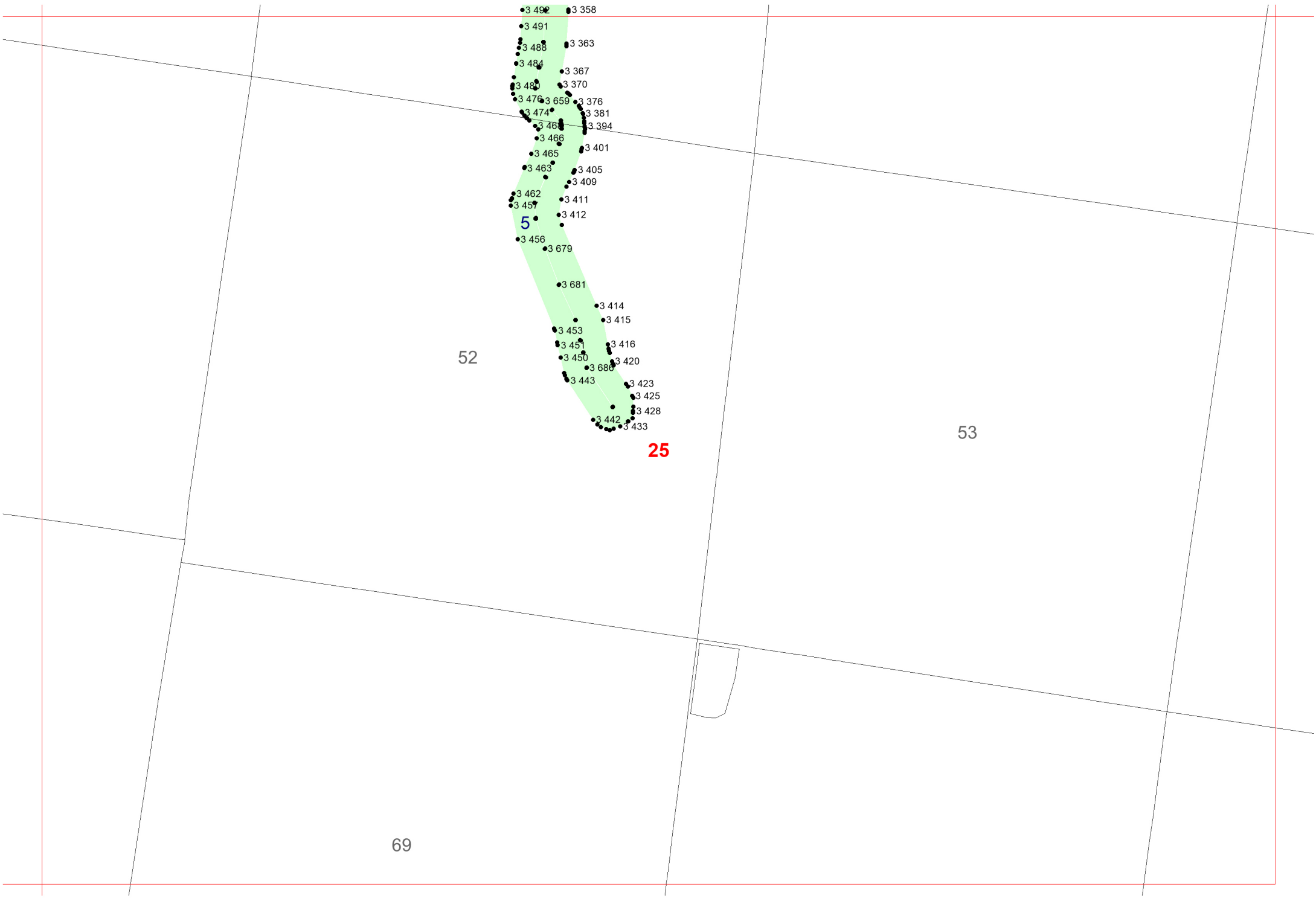

5

25

52

53

69

26

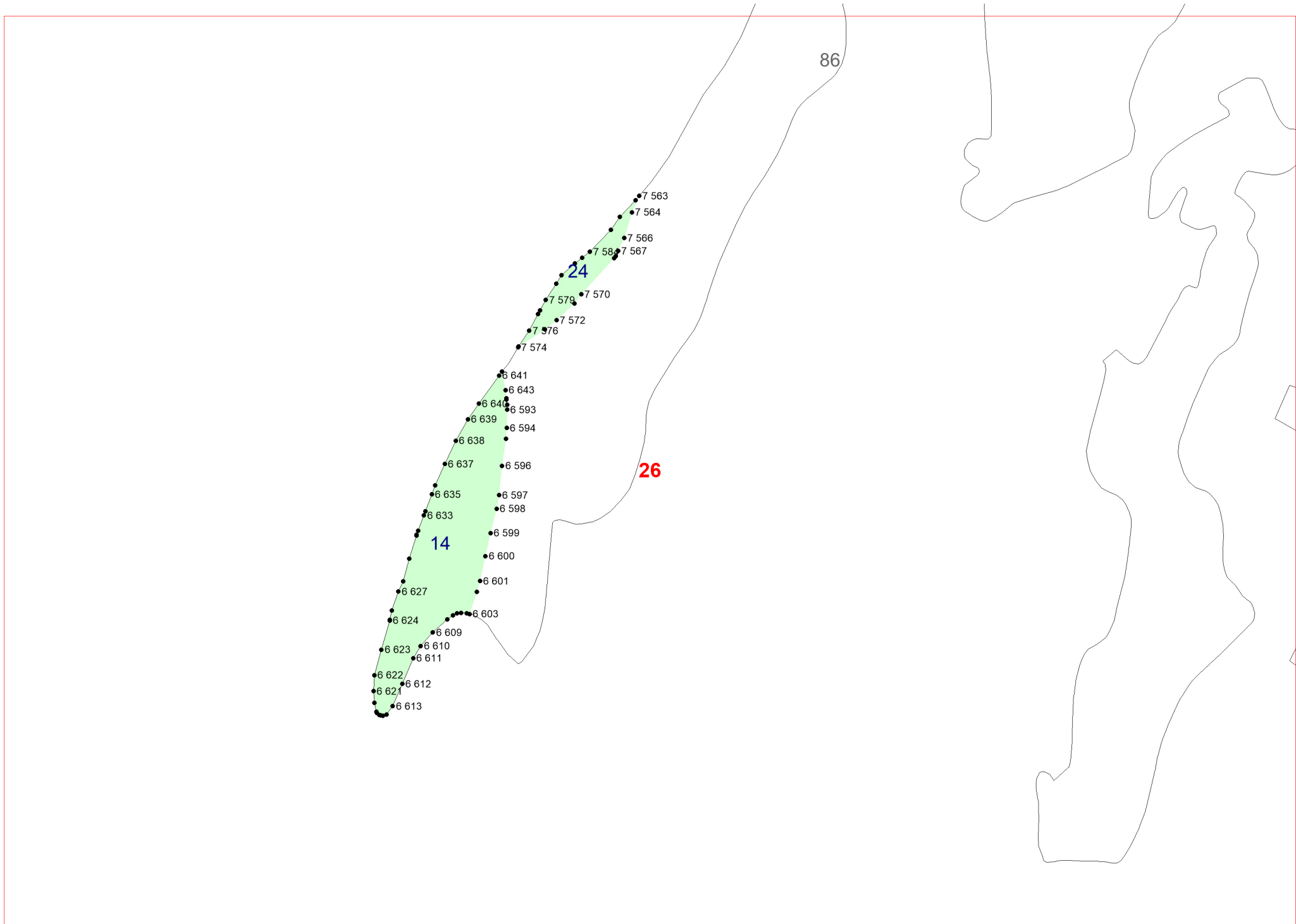

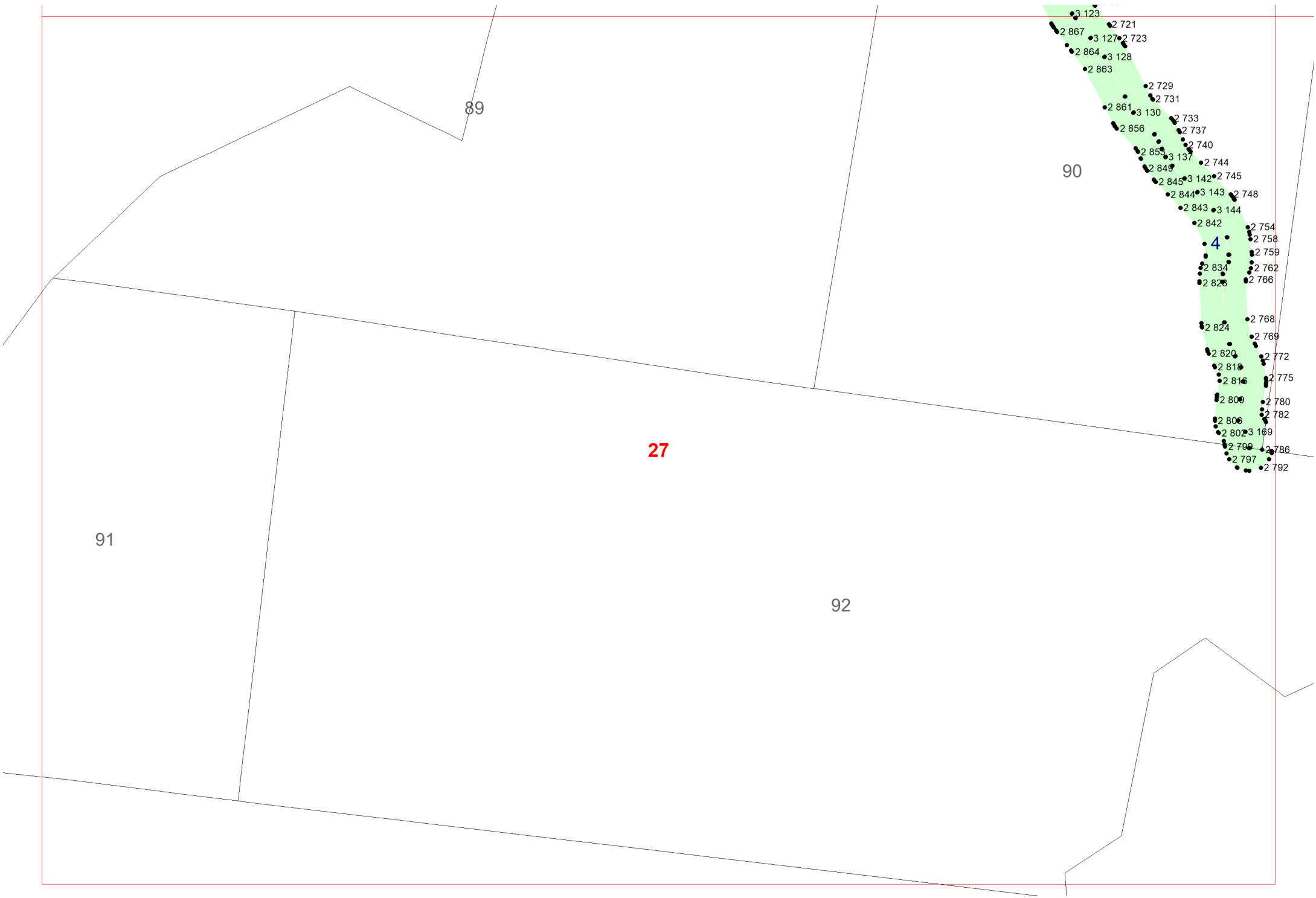

1 312
1 315
2

28